

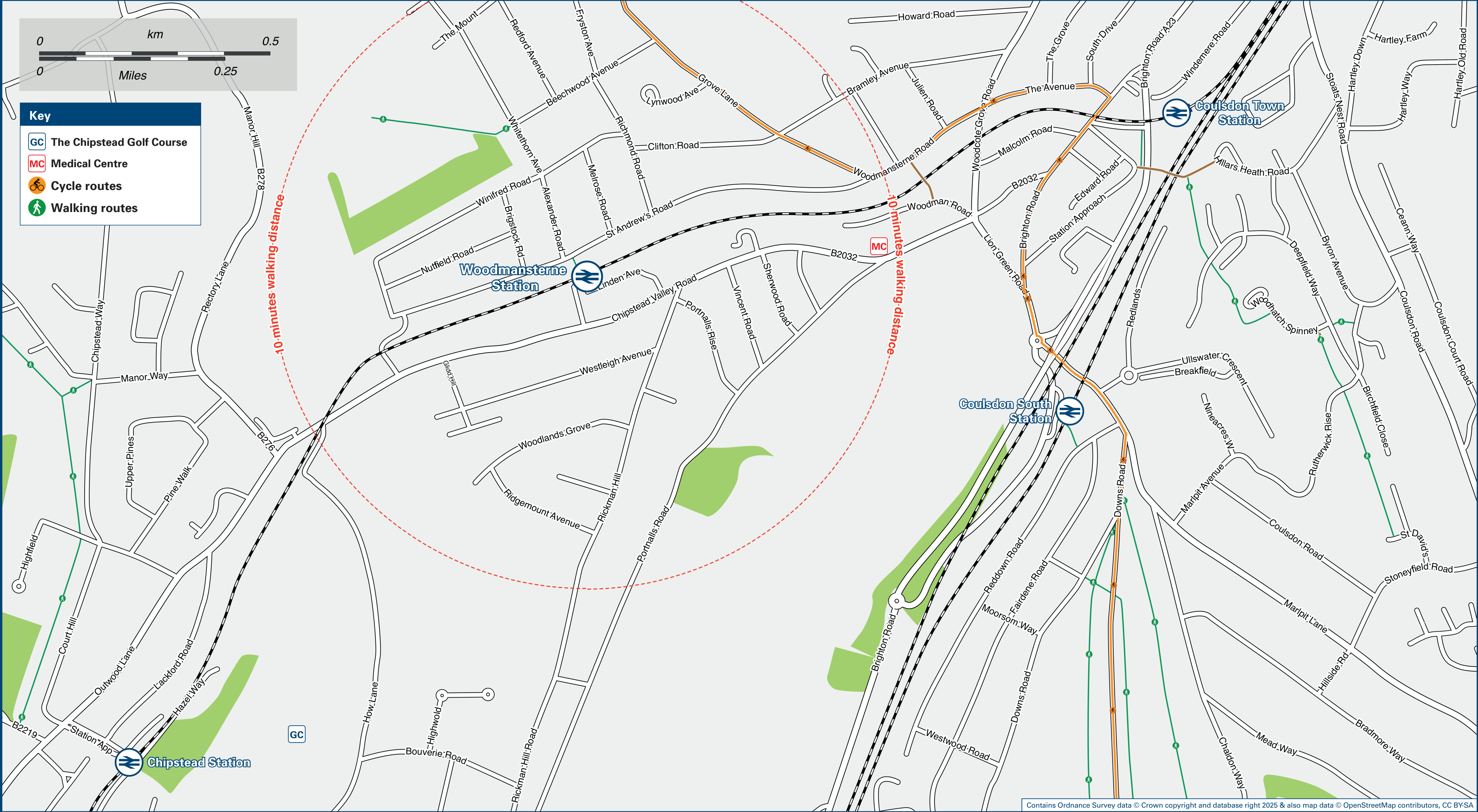

Woodmansterne Station

Onward Travel Information

Local area map



Buses

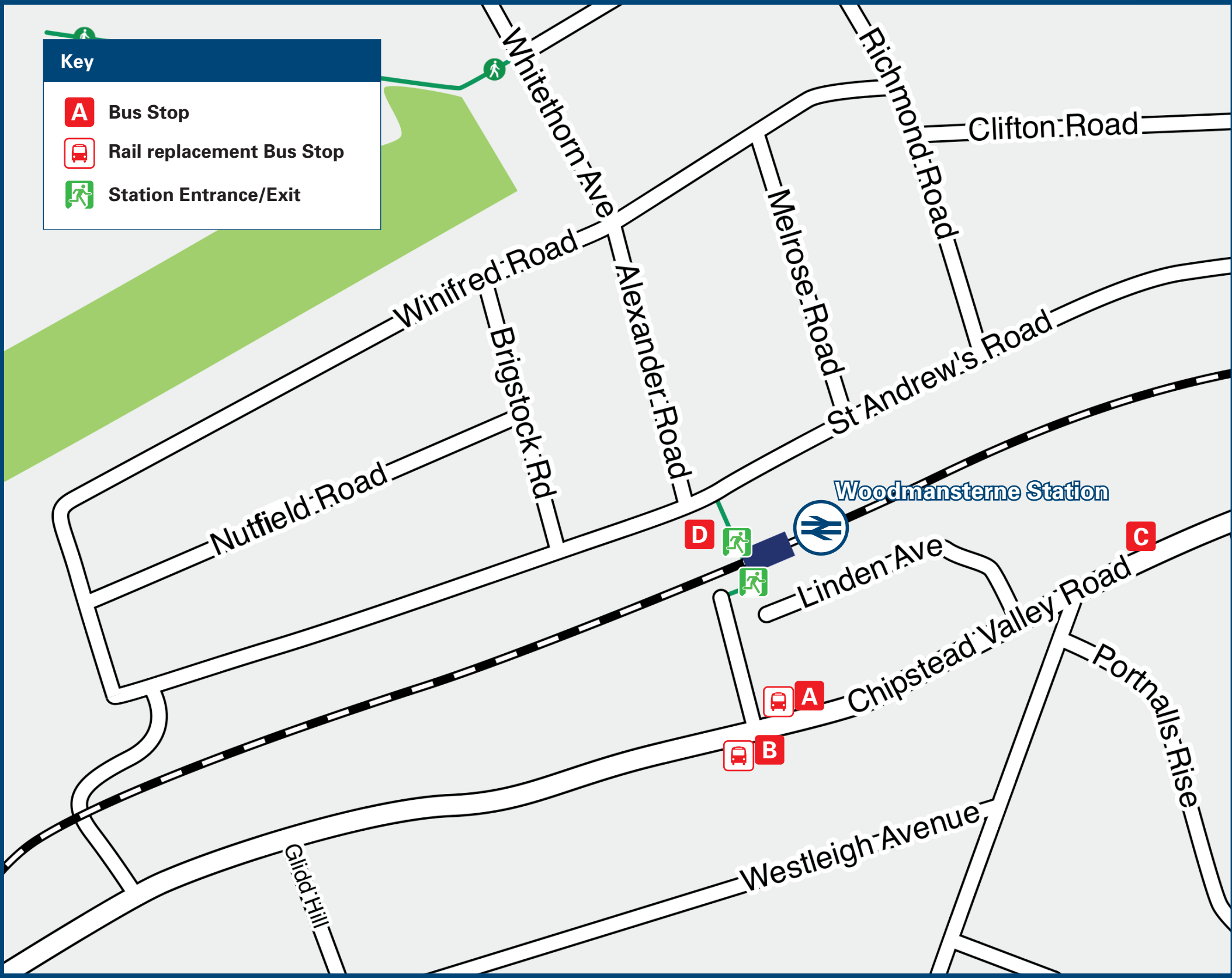

Rail replacement buses depart from bus stops on Chipstead Valley Road: Stop **A** towards Coulsdon Town and Purley and from Stop **B** towards Tattenham Corner.

Main destinations by bus

(Data correct at July 2025)

DESTINATION	BUS ROUTES	BUS STOP
Banstead (High Street)	166	B
Beddington (Village & Valley Retail Park)	463	D #
Caterham (Town Centre & Station)	434	C
Chipstead Valley	166	B
Coulsdon Town Station	166	A
	166, 434	C
Croydon (Town Centre for East Croydon Station)	166	A
Epsom Hospital	166*	B
Epsom (Town Centre / Clock Tower)	166*	B
Kenley Station	434	C
Mitcham Eastfields Station	463	D #
Nork	166*	B
Pollards Hill	463	D #
Purley (Town Centre, Tesco)	166	A
	434	C
South Croydon	166	A
Wallington Station	463	D #
West Croydon (For West Croydon Station)	166	A
Whyteleafe and Upper Warlingham Stations	434	C
Whyteleafe South Station	434	C
Woodcote Green	463	D #
Woodcote Valley Road	434	C

Notes

Bus route 166 operates a daily service.
Bus route 434 and 463 operate daily services.
For bus times and days of operation please contact Traveline on www.traveline.info or call: 0871 200 22 33

Direct trains operate to this destination from this station

Bus Stop (D) on the map has no bus stop post & flag, this is a "Hail-&-Ride" section of the bus route, please signal clearly at this point for the bus to stop.

* To this destination bus route 166 operates Mondays to Saturdays, only.

Taxis

Woodmansterne Station has no taxi rank or cab office. Advance booking is essential, please consider using the following local operators: (Inclusion of this number doesn't represent any endorsement of the taxi firm)

Admiral Mini Cabs
020 8668 8888

Orange Cars
020 8663 0000

Ridii Taxis
01883 776 000

Further information about all onward travel

Local Cycle Info

croydon.gov.uk
For more information about cycle routes.

National Cycle Info

sustrans.org.uk
Sustrans is the UK's leading sustainable transport charity.

Bus Times

See timetable displays at bus stops.

www.traveline.info
0871 200 22 33
calls cost 15p per minute plus your phone company's access charge

NextBuses

Find the bus times for your stop.
Search for a bus stop by entering a postcode, street & town or a stop name & town.

PlusBus

plusbus.info
A discount price 'bus pass' that you buy with your train ticket. It gives you unlimited bus travel around your chosen town, on participating buses.

National Rail Enquiries

Online

nationalrail.co.uk

NRE App

Free National Rail Enquiries app for iOS and Android

Social Media

[facebook.com/nationalrailenq](https://www.facebook.com/nationalrailenq)
[@nationalrailenq](https://twitter.com/nationalrailenq)

Alert Me

You can sign up to Alert Me messages on the National Rail Enquiries website where you can receive train and platform notifications directly to your smart phone.
nationalrail.co.uk/alertme

Contact Centre

03457 48 49 50
Calls cost no more than calls to geographic numbers (01 or 02) and may be recorded.

PlusBike

nationalrail.co.uk/plusbike
For more information.



National Rail
Britain's train companies working together

