

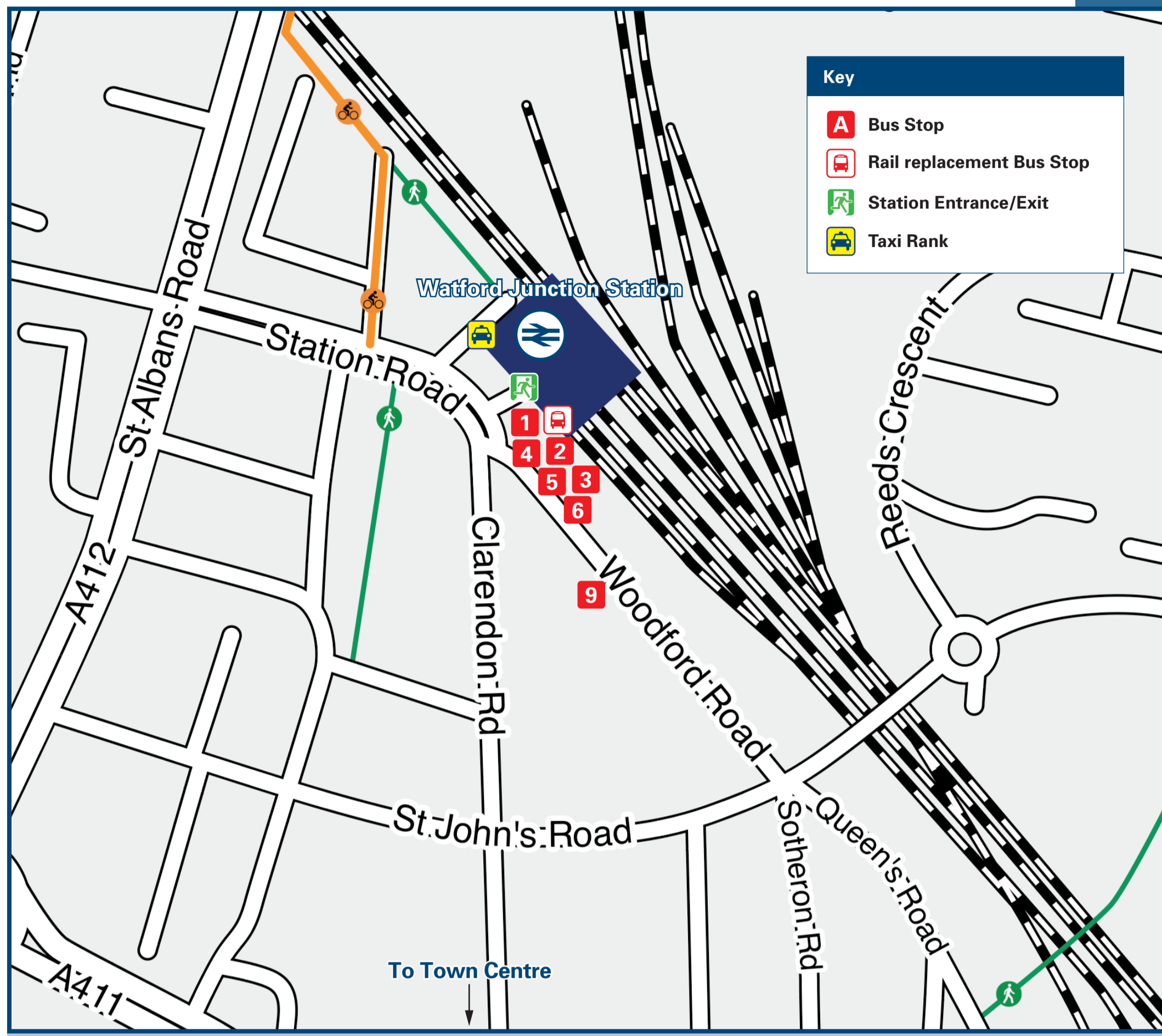

# Watford Junction Station

## Onward Travel Information

### Buses and Taxis



Rail replacement buses and coaches depart from Stand 1 at the bus station by the side of this railway station.

### Local area map

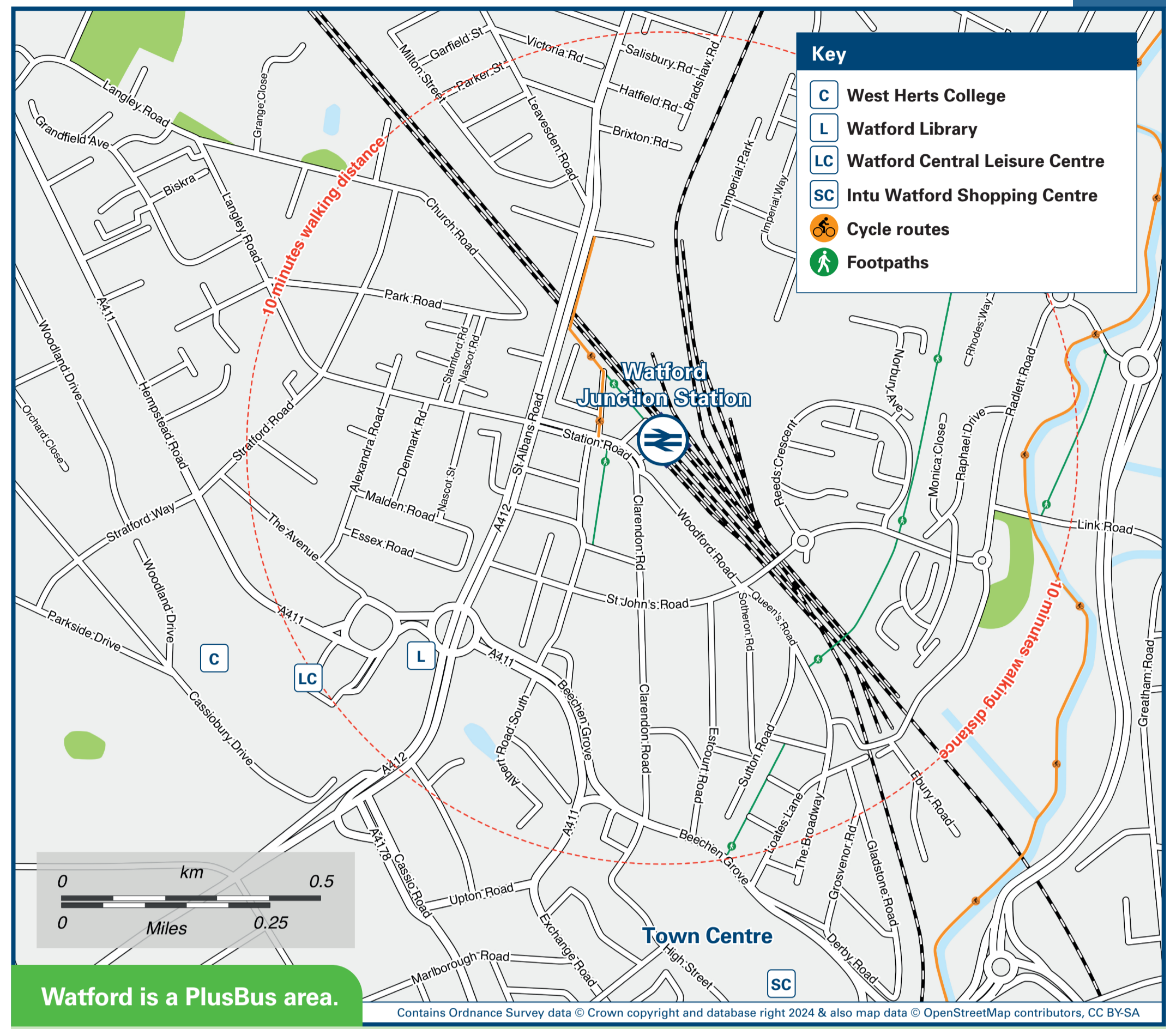

Watford is a PlusBus area.

**PlusBus** is a discount price 'bus pass' that you buy with your train ticket. It gives you unlimited bus travel around your chosen town, on participating buses. Visit [www.plusbus.info](http://www.plusbus.info)

### Main destinations by bus (Data correct at July 2024)

DESTINATION	BUS ROUTES	BUS STOP
Abbots Langley	20, 328 <sup>^</sup>	6
Bedmond	20	6
Belsize	352#	2
Brent Cross Shopping Centre	142	3
Bricket Wood	321, 635+, 724, 725	5
Bushey	142, 258	3
	328	2
Cassiobury Park	352#, W30+	2
Chipperfield	352#	2
Chiswell Green	321, 724, 725	5
Chorleywood BR2, LU	336#	2
Croxley (Underground Station)	336#, 352#, 724, 725, W1*	2
Croxley Green	322, 336#, 352#, 724, 725, W1*	2
Croxley Park	W30+	2
Denham Station	724	2
Edgware (Underground Station)	142	3
Garston	321, 635+, 724, 725, W1*, W2+, W3+, W4++	5
Harlow	724	5
Harpenden	321	5
Harrow	258	3
Hatfield (Town Centre)	635+, 724	5
Hatfield (University of Hertfordshire)	635+, 724, 725	5
Hatfield Business Park	635+	5
Heathrow Airport (Central Bus Station)	724	2
Heathrow Airport (Terminals 2 & 3)	RA3	A
Hemel Hempstead	20	6
	322, 501 <sup>^^</sup>	5

DESTINATION	BUS ROUTES	BUS STOP
Hertford	724	5
Holywell Estate	20	2
How Wood	635+	5
Hunton Bridge	322, 501 <sup>^^</sup>	5
Kings Langley	322, 501 <sup>^^</sup>	5
Knebworth	725	5
Leavesden/Leavesden Park	20, 328 <sup>^</sup>	6
Leavesden Studios (for Warner Bros. Studio Tour)	Studio Tour Shuttle Bus	4
	20, 328 <sup>^</sup>	6
Leverstock Green	20	6
Luton (for Luton Airport)	321	5
Maple Cross	322, 724, 725, W1**	2
Meriden (The Gossamers Shops)	635+, W1*, W2+, W3+, W4++	5
Mount Vernon Hospital	328	2
	20	6
North Watford	321, 322, 328 <sup>^</sup> , 635+, 724, 725, W1*, W2+, W3+, W4++, W20	5
Northwood Station	328	2
Oxey Hall Estate	W20	2
Rickmansworth	322, 336#, 724, 725, W1**	2
Serratt	352#	2
South Harrow	258	3
South Oxhey (& Carpenders Park Station)	328	2
St Albans	321, 724, 725	5
Stanmore	142	3
Stevenage Station (& Lister Hospital)	725	5
Uxbridge	724	2

DESTINATION	BUS ROUTES	BUS STOP
Watford (Town Centre)	20, 321, 322, 328, 336#, 352#, 501 <sup>^^</sup> , 635+, 724, 725, W1*, W3+, W4++, W20, W30+	2
Watford General Hospital (for Watford Football Ground)	20, 321, 322, 336#, 635+, W1**	2
Welwyn	725	5
Welwyn Garden City	724, 725	5
Woodside	20	6

#### Notes

- PlusBus destination, please see below for details.
- Bus routes 336, 352 and W20 run Mondays to Saturdays only.
- Bus routes 20, 142, 258, 321, 322, 328, 724, 725 and RA3 run daily.
- Direct trains operate to this destination from this station.
- Change here for other National Rail or TfL Rail services.
- Change here for London Underground trains.
- It's a 15 minutes walk from this station to Watford town centre via Clarendon Road, see Local area map.
- Additional bus services run from Watford town centre, contact Traveline for more information.
- <sup>^</sup> Bus route 328 runs Mondays to Saturdays only to this destination.
- <sup>^^</sup> Bus route 501 runs hourly daytime on Sundays and Bank Holidays only.
- <sup>#</sup> Bus routes 336 and 352 run a limited evening service from this station, additional journeys run from Watford town centre, contact Traveline for more information.
- <sup>\*</sup> Bus route W1 runs a limited service Mondays to Fridays and an hourly daytime service Sundays & Bank Holidays to this destination.
- <sup>\*\*</sup> Bus route W1 runs an hourly daytime service Sundays & Bank Holidays to this destination.
- <sup>+</sup> Bus routes 635, W2 and W30 run Mondays to Fridays only.
- <sup>++</sup> Bus routes W3 and W4 run Saturdays only.

### Taxis

Watford Junction is a major station where taxis are usually available on a rank. Advance booking is not normally necessary, unless arriving early in the morning or late at night. Operators who may accept bookings include: (Inclusion of this number doesn't represent any endorsement of the taxi firm)

**Watford United Taxis**  
01923 25 25 25

**A1 Taxis**  
01923 22 22 22

**Allied Taxis**  
01923 21 21 21

### Further information about all onward travel

<b>Local Cycle Info</b> <a href="http://watford.gov.uk">watford.gov.uk</a> <small>For more information about cycle routes.</small>	<b>National Cycle Info</b> <a href="http://sustrans.org.uk">sustrans.org.uk</a> <small>Sustrans is the UK's leading sustainable transport charity.</small>	<b>Bus Times</b> <small>See timetable displays at bus stops.</small>  <a href="http://www.traveline.info">www.traveline.info</a> <b>0871 200 22 33</b> <small>plus your phone company's access charge</small>	<b>NextBuses</b>  <b>Find the bus times for your stop.</b> <small>Search for a bus stop by entering a postcode, street &amp; town or a stop name &amp; town.</small>	<b>PlusBus</b> <a href="http://plusbus.info">plusbus.info</a> <small>A discount price 'bus pass' that you buy with your train ticket. It gives you unlimited bus travel around your chosen town, on participating buses.</small>
--	--	--	---	--

### National Rail Enquiries

<b>Online</b> <a href="http://nationalrail.co.uk">nationalrail.co.uk</a>	<b>NRE App</b> <b>Free National Rail Enquiries app for iOS and Android</b>	<b>Social Media</b> <a href="https://facebook.com/nationalrailenq">facebook.com/nationalrailenq</a> @nationalrailenq	<b>Alert Me</b> <small>You can sign up to Alert Me messages on the National Rail Enquiries website where you can receive train and platform notifications directly to your smart phone.</small> <a href="http://nationalrail.co.uk/alertme">nationalrail.co.uk/alertme</a>	<b>Contact Centre</b> <b>03457 48 49 50</b> <small>Calls cost no more than calls to geographic numbers (01 or 02) and may be recorded.</small>	<b>PlusBike</b> <a href="http://nationalrail.co.uk/plusbike">nationalrail.co.uk/plusbike</a> <small>For more information.</small>
---	---	--	--	--	---



This poster shows details of popular destinations and main, frequent bus routes. Additional services may run, so please check with Traveline or see posters at local bus stops. Whilst considerable care has been taken to ensure the information contained on this poster is correct and accurate, National Rail cannot accept responsibility for any loss or inconvenience caused by any errors or omissions, or for loss, damage, injury or inconvenience relating to the cancellation, alteration, delay or diversion of a service. For any feedback, please e-mail [comments@onwardtravelposters.com](mailto:comments@onwardtravelposters.com)

Scan this code with your mobile for full station information.