

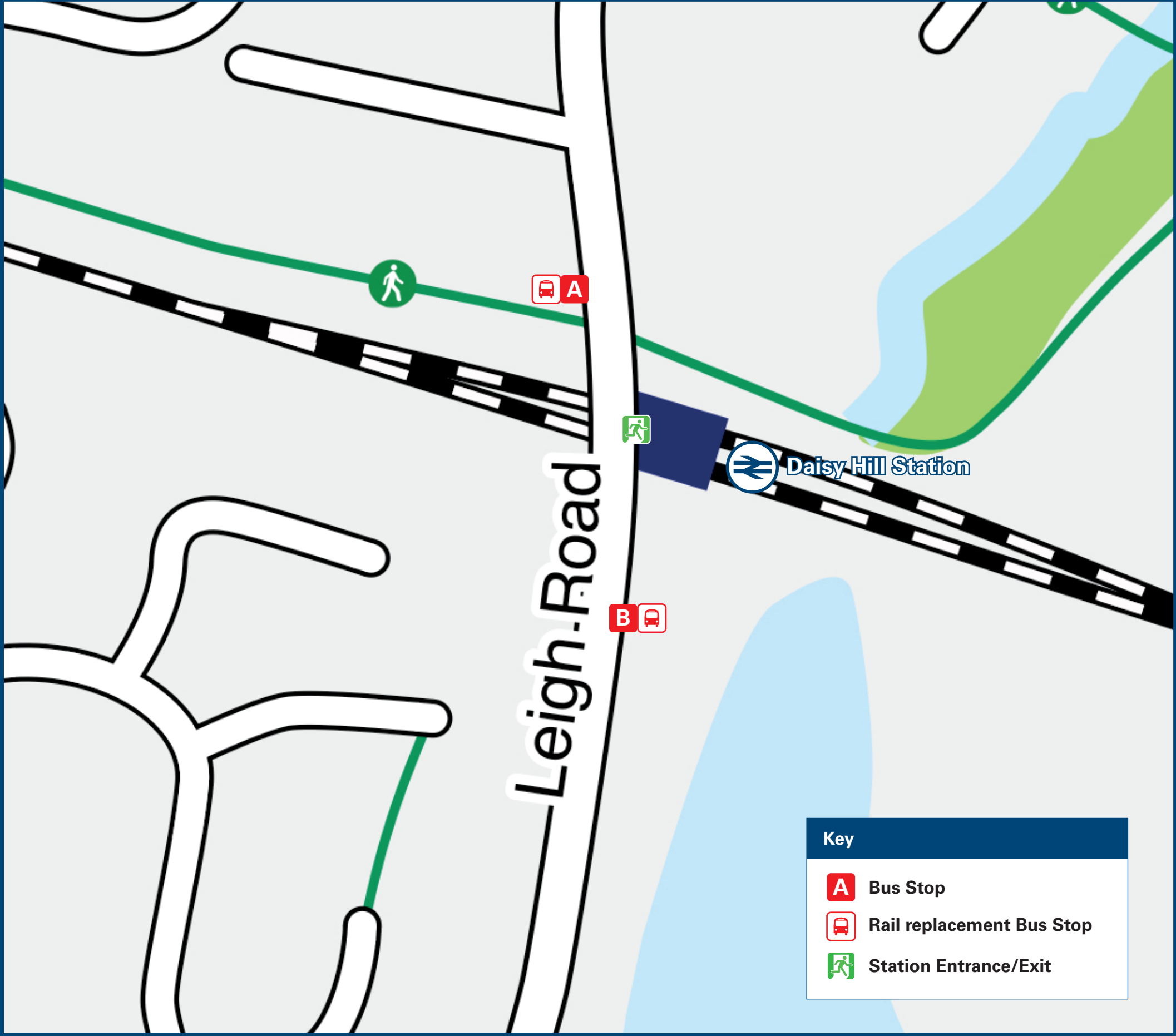

Daisy Hill Station

Onward Travel Information

Buses



Rail replacement buses depart from bus stops on Leigh Road outside the station entrance.

Local area map

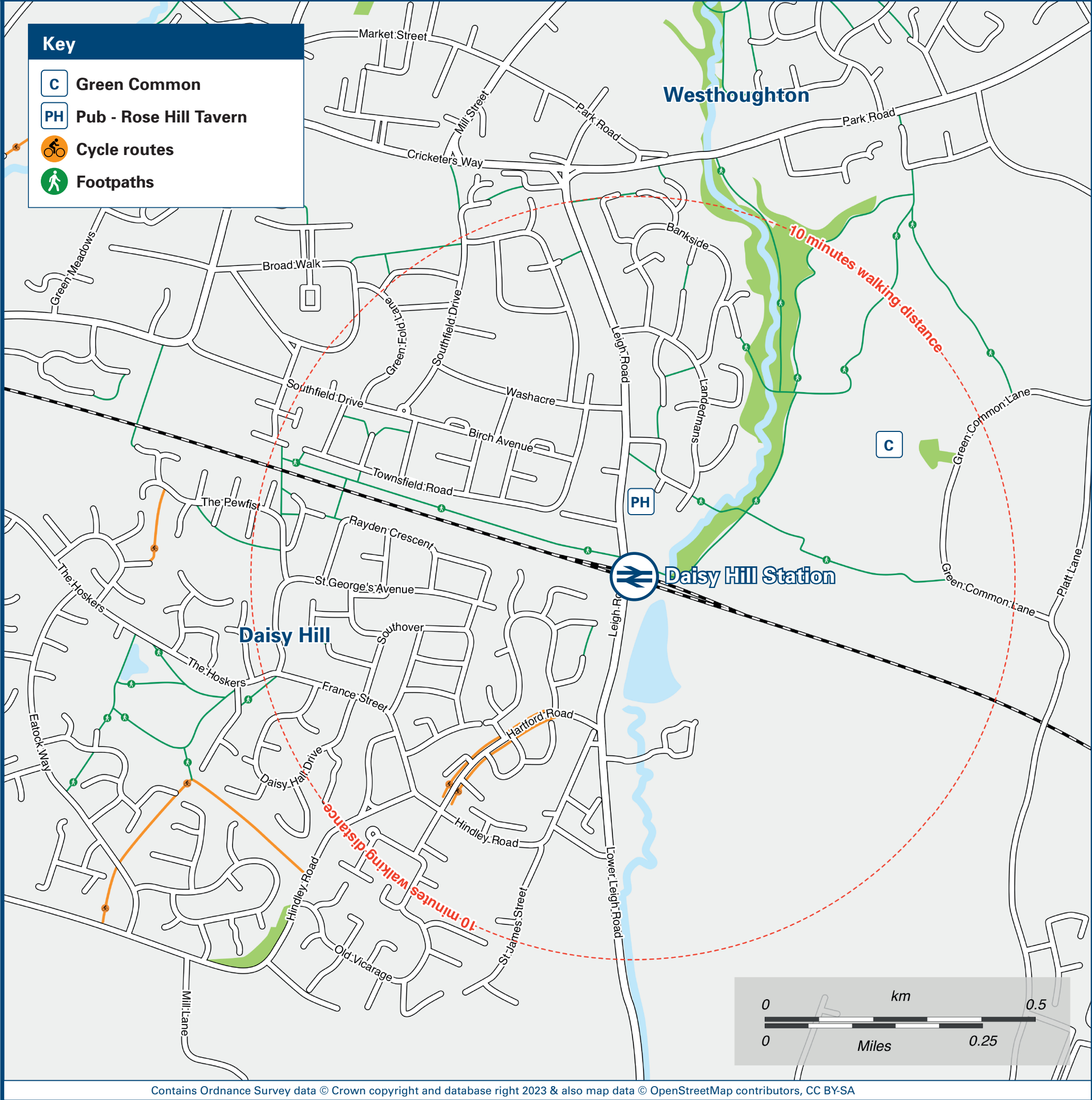

Main destinations by bus

(Data correct at November 2023)



DESTINATION	BUS ROUTES	BUS STOP
Atherton	516	B
Bolton	7	A
Castle Hill (Sandy Lane)	7	B
Chequerbent (Manchester Road)	7	A
Daisy Hill Village (Hindley Road)	7	B
Deane	7	A
Hindley	7	B

DESTINATION	BUS ROUTES	BUS STOP
Horwich (Old Lord's Estate)	516	A
Horwich (Town Centre)	516	A
Horwich Parkway Station (alight at Football Stadium)	516	A
Howe Bridge	516	B
Hunger Hill	7	A
Ince	7	B
Leigh	516	B

DESTINATION	BUS ROUTES	BUS STOP
Middlebrook (Retail & Leisure Park)	516	A
Westhoughton Station	516	A
Westhoughton (Town Centre/Market Street)	7, 516	A
Wigan	7	B
Wingates	516	A

Notes

Bus routes 7 and 516 operate daily including evenings, Sundays and Public Holidays.
For bus times please see bus stop timetables or contact Traveline on 0871 200 22 33.

Direct trains operate to this destination from this station.

Taxis

Daisy Hill station has no taxi rank or cab office. Advance booking is essential, please consider using the following local operators: (Inclusion of this number doesn't represent any endorsement of the taxi firm)

Alexander Cars
01942 816 677

Premier Cars
01942 818 027

Timewise Taxis
01942 799 094

Further information about all onward travel

Local Cycle Info bolton.gov.uk For more information about cycle routes.	National Cycle Info sustrans.org.uk Sustrans is the UK's leading sustainable transport charity.	Bus Times See timetable displays at bus stops. www.traveline.info 0871 200 22 33 calls cost 15p per minute plus your phone company's access charge	NextBuses Find the bus times for your stop. Search for a bus stop by entering a postcode, street & town or a stop name & town.	PlusBus plusbus.info A discount price 'bus pass' that you buy with your train ticket. It gives you unlimited bus travel around your chosen town, on participating buses.
---	---	---	--	--

National Rail Enquiries

Online nationalrail.co.uk	NRE App Free National Rail Enquiries app for iOS and Android	Social Media facebook.com/nationalrailenq @nationalrailenq	Alert Me You can sign up to Alert Me messages on the National Rail Enquiries website where you can receive train and platform notifications directly to your smart phone. nationalrail.co.uk/alertme	Contact Centre 03457 48 49 50 Calls cost no more than calls to geographic numbers (01 or 02) and may be recorded.	PlusBike nationalrail.co.uk/plusbike For more information.
---	--	--	---	--	--



NORTHERN



National Rail
Britain's train companies working together



This poster shows details of popular destinations and main, frequent bus routes. Additional services may run, so please check with Traveline or see posters at local bus stops. Whilst considerable care has been taken to ensure the information contained on this poster is correct and accurate, National Rail cannot accept responsibility for any loss or inconvenience caused by any errors or omissions, or for loss, damage, injury or inconvenience relating to the cancellation, alteration, delay or diversion of a service. For any feedback, please e-mail comments@onwardtravelposters.com

Scan this code with your mobile for full station information.