

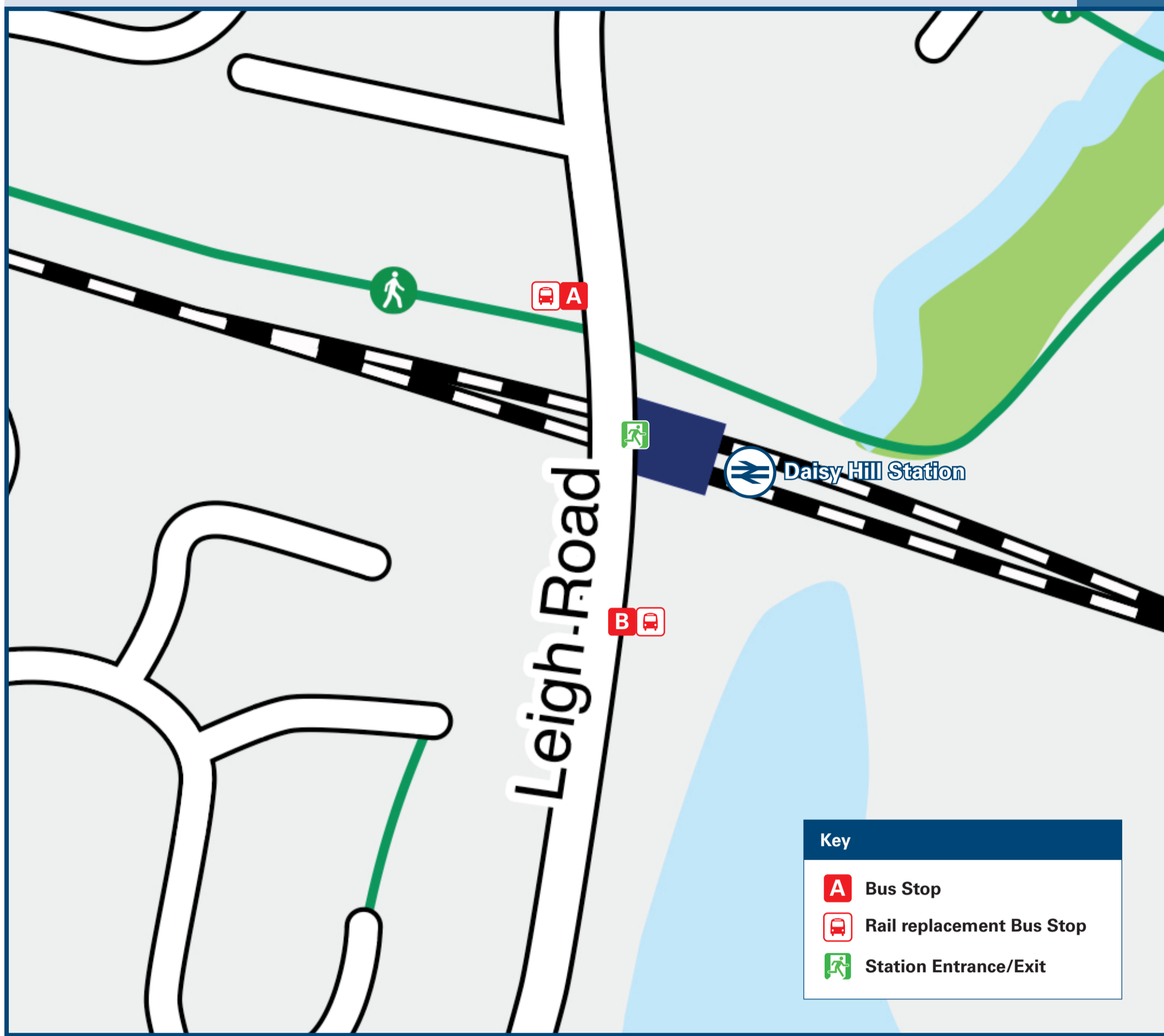

# Daisy Hill Station

# Onward Travel Information

## Buses



Rail replacement services Pick Up / Drop Off at the bus stops on Leigh Road outside the station entrance.

## Local area map

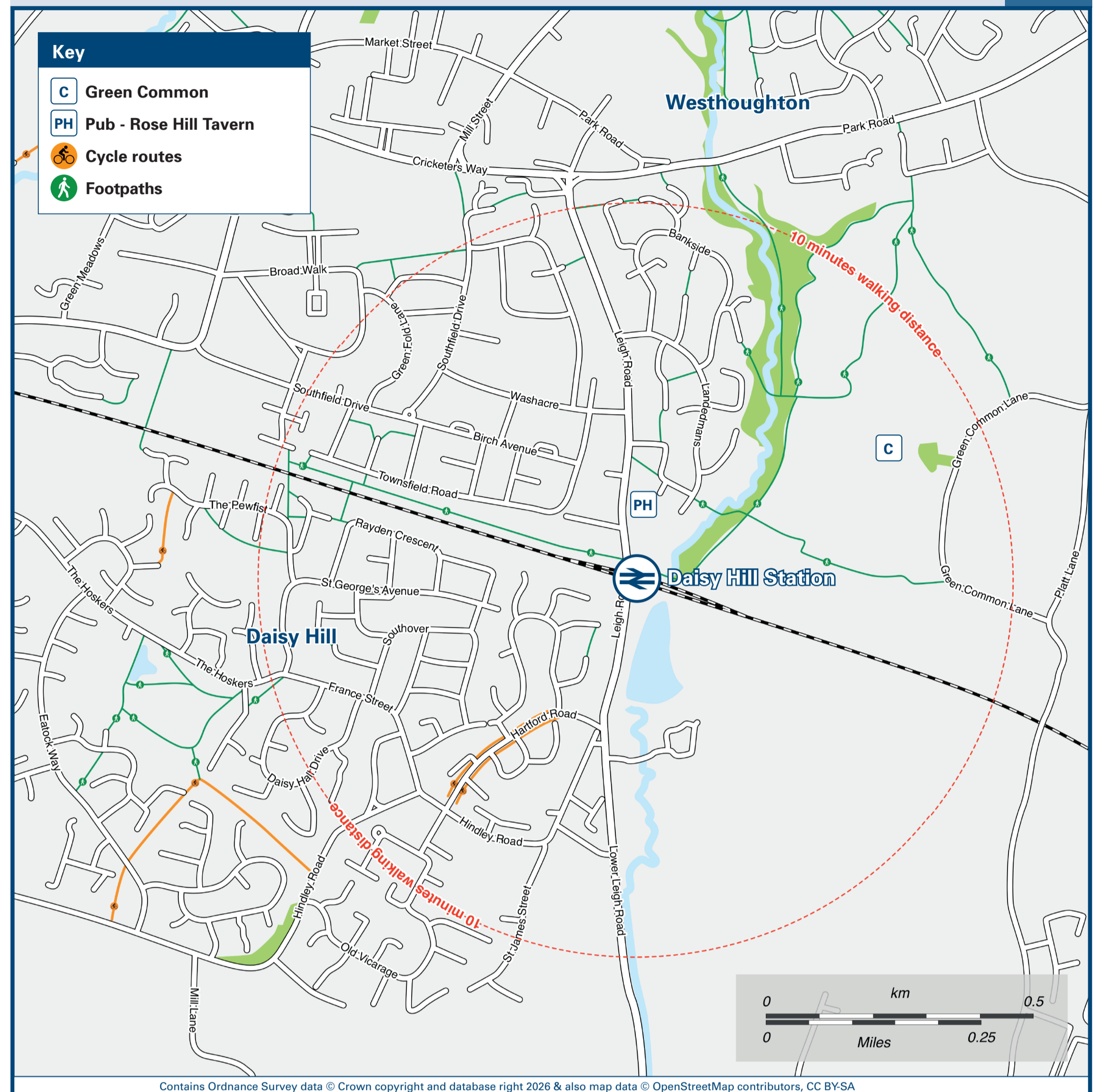

## Main destinations by bus

(Data correct at February 2026)

DESTINATION	BUS ROUTES	BUS STOP
Atherton	516	B
Bolton	607	A
Castle Hill (Sandy Lane)	607	B
Chequerbent (Manchester Road)	607	A
Daisy Hill Village (Hindley Road)	607	B
Deane	607	A
Hindley	607	B
Horwich (Old Lord's Estate)	516	A

DESTINATION	BUS ROUTES	BUS STOP
Horwich (Town Centre)	516	A
Howe Bridge	516	B
Hunger Hill	607	A
Ince	607	B
Leigh	516	B
Middlebrook (Lostock Lane, for Hazel Fold Estate)	516	A
Middlebrook (Retail & Leisure Park)	516	A
Middlebrook (Toughsheet Community Stadium)#	516	A

DESTINATION	BUS ROUTES	BUS STOP
Westhoughton Station	516	A
Westhoughton (Town Centre/Market Street)	516, 607	A
Wigan	607	B
Wingates	516	A

**Notes**

Bus routes 516 and 607 operate daily services including evenings, Sundays and Public Holidays.

For bus times and days of operation please contact Traveline on [www.traveline.info](http://www.traveline.info) or call: 0871 200 22 33

Direct trains operate to this destination from this station.

# Alight here for Bolton Wanderers FC and Horwich Parkway station.

## Taxis

Daisy Hill station has no taxi rank or cab office. Advance booking is essential, please consider using the following local operators: (Inclusion of this number doesn't represent any endorsement of the taxi firm)

**Premier Cars**  
01942 818 027

**Time Wise Taxis**  
01942 818 188

**Star 401 A-Z Private Hire**  
01942 810 401

## Further information about all onward travel

<b>Local Cycle Info</b> <a href="http://bolton.gov.uk">bolton.gov.uk</a> For more information about cycle routes.	<b>National Cycle Info</b> <a href="http://walkwheelcycletrust.org.uk">walkwheelcycletrust.org.uk</a>	<b>Bus Times</b> See timetable displays at bus stops.  <a href="http://www.traveline.info">www.traveline.info</a> 0871 200 22 33 call cost 13p per minute plus your phone company's access charge	<b>PlusBus</b>  <a href="http://plusbus.info">plusbus.info</a> PlusBus is a discount price 'bus pass' that you buy with your train ticket. It gives you unlimited bus travel around your chosen town, on participating buses. Visit <a href="http://www.plusbus.info">www.plusbus.info</a>
---	--	--	---

## National Rail Enquiries

<b>Online</b> <a href="http://nationalrail.co.uk">nationalrail.co.uk</a>	<b>NRE App</b> Free National Rail Enquiries app for iOS and Android	<b>Social Media</b> facebook.com/nationalrailenq @nationalrailenq	<b>Alert Me</b> You can sign up to Alert Me messages on the National Rail Enquiries website where you can receive train and platform notifications directly to your smart phone. <a href="http://nationalrail.co.uk/alertme">nationalrail.co.uk/alertme</a>	<b>Contact Centre</b> 03457 48 49 50 Calls cost no more than calls to geographic numbers (01 or 02) and may be recorded.	<b>PlusBike</b>  <a href="http://nationalrail.co.uk/plusbike">nationalrail.co.uk/plusbike</a> For more information.
---	--	---	---	--	--

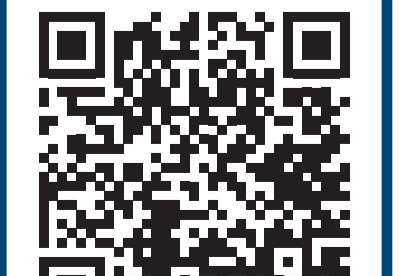

This poster shows details of popular destinations and main, frequent bus routes. Additional services may run, so please check with Traveline or see posters at local bus stops. Whilst considerable care has been taken to ensure the information contained on this poster is correct and accurate, National Rail cannot accept responsibility for any loss or inconvenience caused by any errors or omissions, or for loss, damage, injury or inconvenience relating to the cancellation, alteration, delay or diversion of a service. For any feedback, please e-mail [comments@onwardtravelposters.com](mailto:comments@onwardtravelposters.com)

Scan this code with your mobile for full station information.