

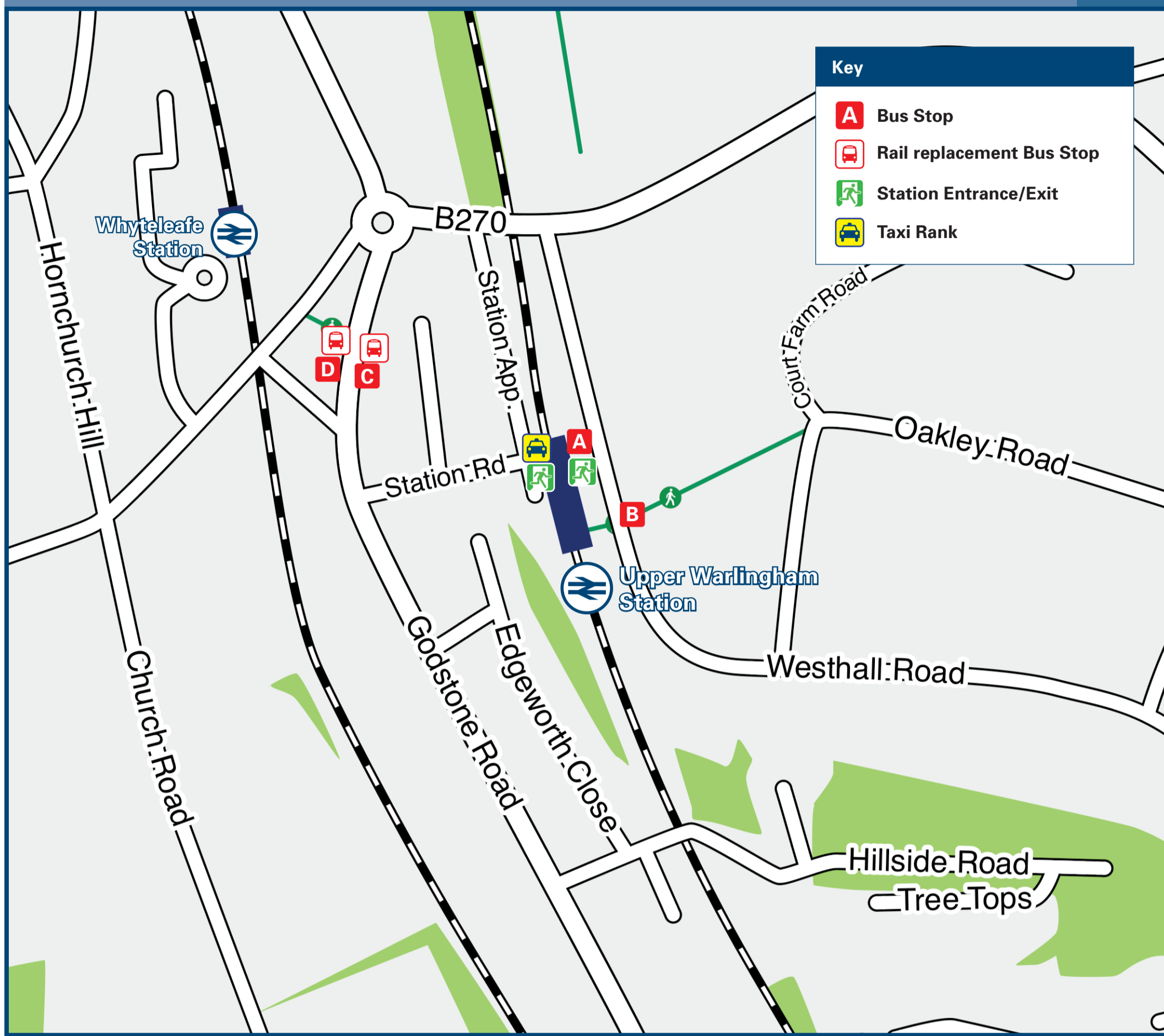

Upper Warlingham Station

Onward Travel Information

Buses and Taxis



Key

- Bus Stop
- Rail replacement Bus Stop
- Station Entrance/Exit
- Taxi Rank

Rail replacement buses depart from public bus stops on the A22 Godstone Road, bus stops **C** and **D** on the Buses and Taxis map.

Local area map

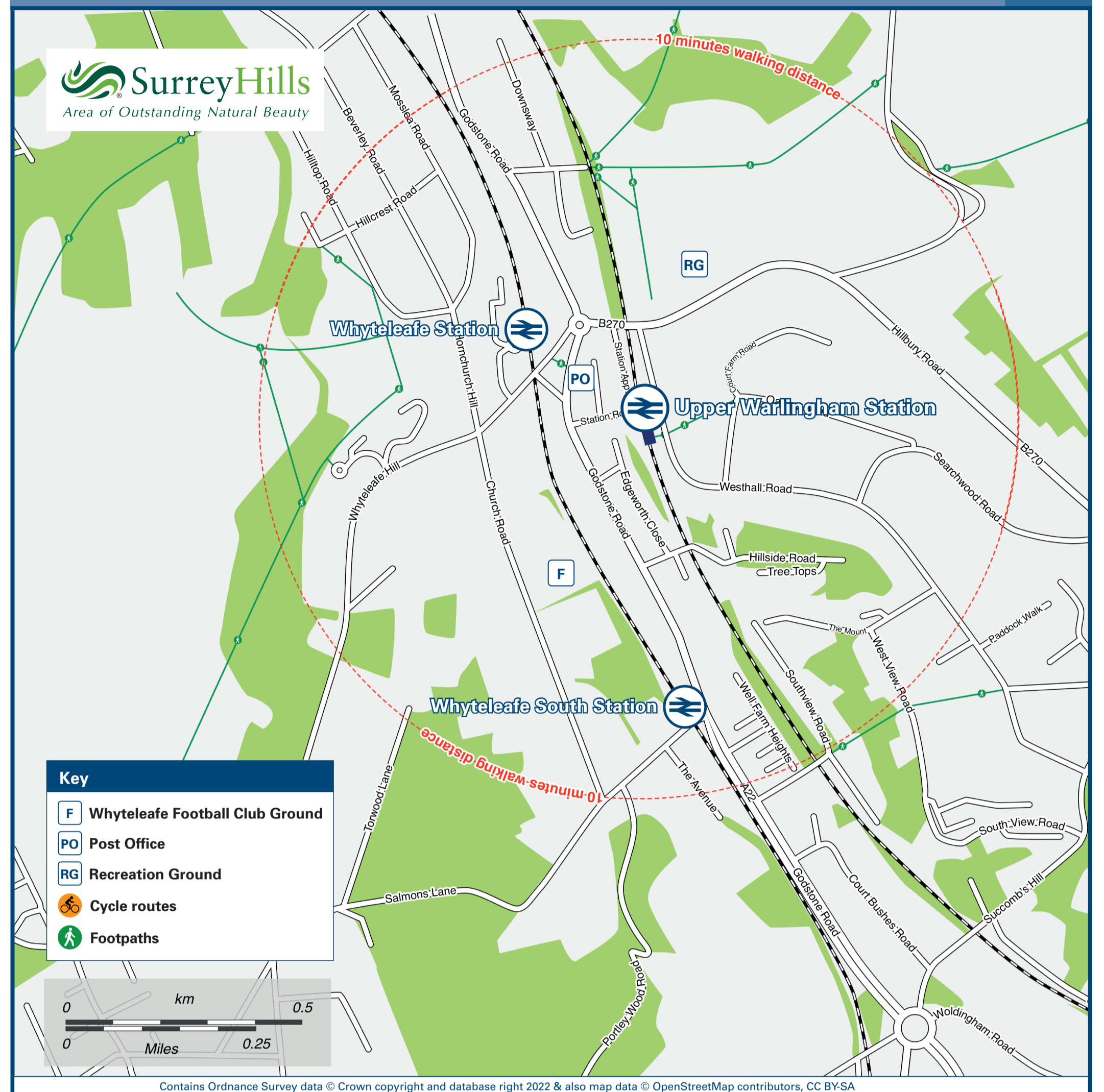

Key

- Whyteleafe Football Club Ground
- Post Office
- Recreation Ground
- Cycle routes
- Footpaths

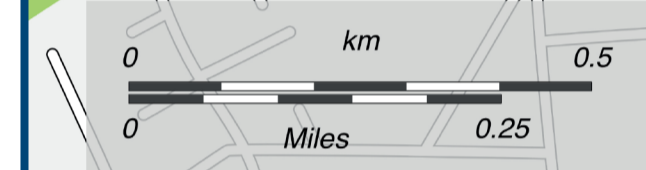

Main destinations by bus

(Data correct at April 2023)



| DESTINATION | BUS ROUTES | BUS STOP |
|------------------------------|------------|------------|
| Caterham (Railway Station) | 407, 411 | C |
| | 409, 411 | A |
| Caterham-on-the-Hill | 409 | A |
| Chaldon | 411 | A C |
| Chelsham Common (Great Park) | 409, 411* | B+ |
| | 411* | D |
| Coulsdon | 434 | D |
| Farleigh | 409, 411* | B+ |
| | 411* | D |
| Croydon | 407 | D |

| DESTINATION | BUS ROUTES | BUS STOP |
|--|------------|------------|
| Gatton Point (for East Surrey College) | 411 | A C |
| Godstone Green | 409 | A |
| Kenley | 407, 434 | D |
| Merstham | 411 | A C |
| Purley (Town Centre, Tesco) | 407, 434 | D |
| Redhill (Bus Station, near Station) | 411 | A C |
| Reigate | 411 | A C |
| Selsdon | 409, 411* | B+ |
| | 411* | D |

| DESTINATION | BUS ROUTES | BUS STOP |
|------------------|------------|-----------|
| Sutton | 407 | D |
| Waddon | 407 | D |
| Wallington Green | 407 | D |
| Warlingham Green | 409, 411 | B+ |
| | 411 | D |
| Woodcote | 434 | D |

Notes

Bus routes 407, 409 and 434 operates everyday, Monday to Sundays. Bus route 411 operates Mondays to Fridays only.
 * Limited journeys only to this destination, please check timetables.
 + Bus stop **B+** on the map is an unmarked bus stop with no bus stop flag and pole, please wait opposite station entrance and signal clearly for the bus to stop.
 AONB Surrey Hills (AONB) www.surreyhills.org
 Direct trains operate to Caterham, Kenley and Purley from Whyteleafe station.
 Direct trains operate to this destination from this station.

Taxis

Upper Warlingham station is served by a taxi rank or cab office. Check availability before travelling, and pre-book if necessary. Please consider using the following local operators: (Inclusion of this number doesn't represent any endorsement of the taxi firm)

| | | |
|-------------------------------|---------------------------------|---|
| Catax 01883 345 151 | AM Cars 01883 622 944 | Rons Taxi Service 07775 928 071 |
|-------------------------------|---------------------------------|---|

Further information about all onward travel

| | | | | |
|---|---|--|--|--|
| Local Cycle Info tandridge.gov.uk For more information about cycle routes. | National Cycle Info sustrans.org.uk Sustrans is the UK's leading sustainable transport charity. | Bus Times See timetable displays at bus stops. www.traveline.info 0871 200 22 33 call cost 12p per minute plus your phone company's access charge | NextBuses Find the bus times for your stop. Search for a bus stop by entering a postcode, street & town or a stop name & town. | PlusBus plusbus.info A discount price 'bus pass' that you buy with your train ticket. It gives you unlimited bus travel around your chosen town, on participating buses. |
|---|---|--|--|--|

National Rail Enquiries

| | | | | | |
|---|--|--|---|--|--|
| Online nationalrail.co.uk | NRE App Free National Rail Enquiries app for iOS and Android | Social Media facebook.com/nationalrailenq @nationalrailenq | Alert Me You can sign up to Alert Me messages on the National Rail Enquiries website where you can receive train and platform notifications directly to your smart phone. nationalrail.co.uk/alertme | Contact Centre 03457 48 49 50 Calls cost no more than calls to geographic numbers (01 or 02) and may be recorded. | PlusBike nationalrail.co.uk/plusbike For more information. |
|---|--|--|---|--|--|



This poster shows details of popular destinations and main, frequent bus routes. Additional services may run, so please check with Traveline or see posters at local bus stops. Whilst considerable care has been taken to ensure the information contained on this poster is correct and accurate, National Rail cannot accept responsibility for any loss or inconvenience caused by any errors or omissions, or for loss, damage, injury or inconvenience relating to the cancellation, alteration, delay or diversion of a service. For any feedback, please e-mail comments@onwardtravelposters.com

Scan this code with your mobile for full station information.