

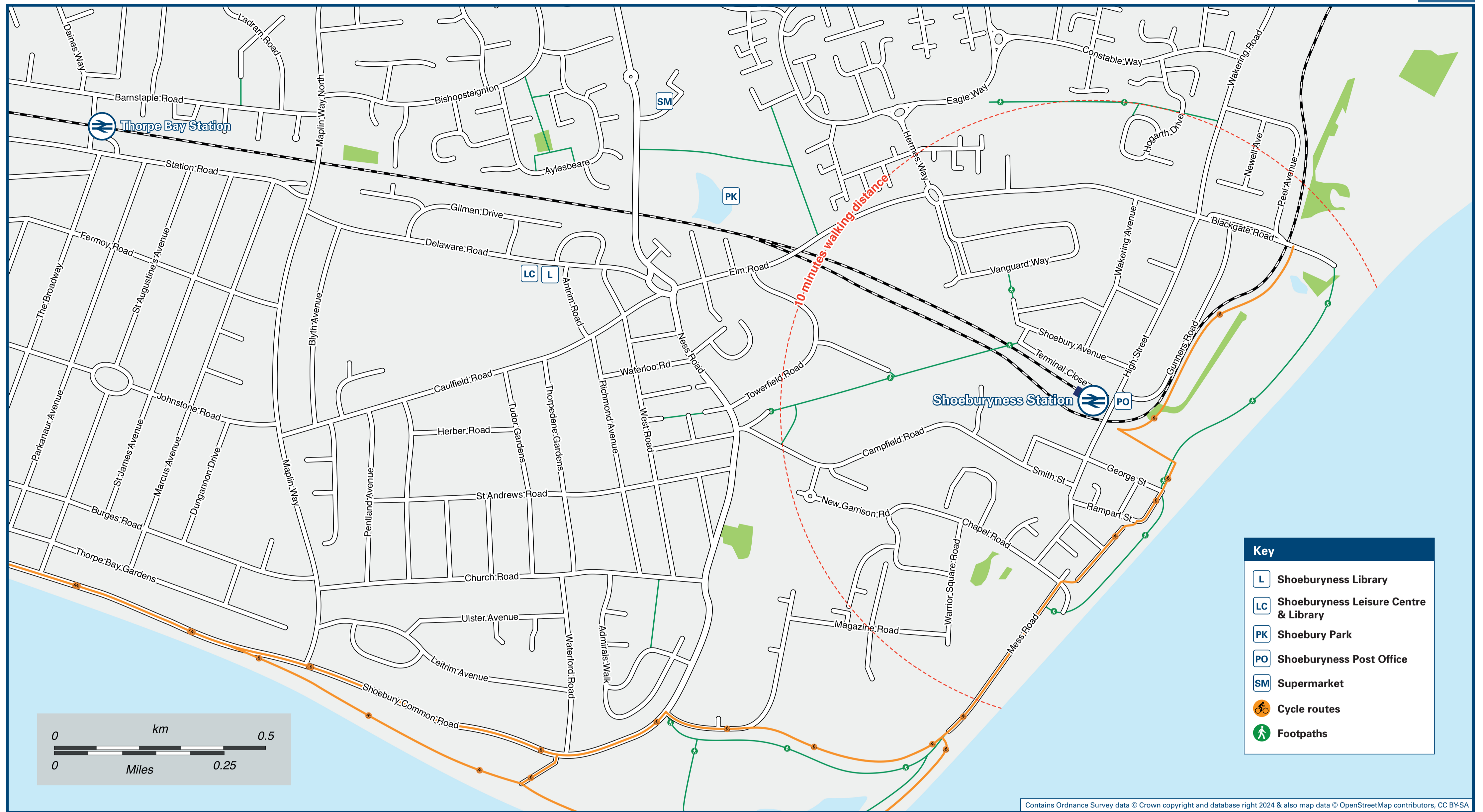

# Shoeburyness Station

# Onward Travel Information

## Local area map



## Buses and Taxis

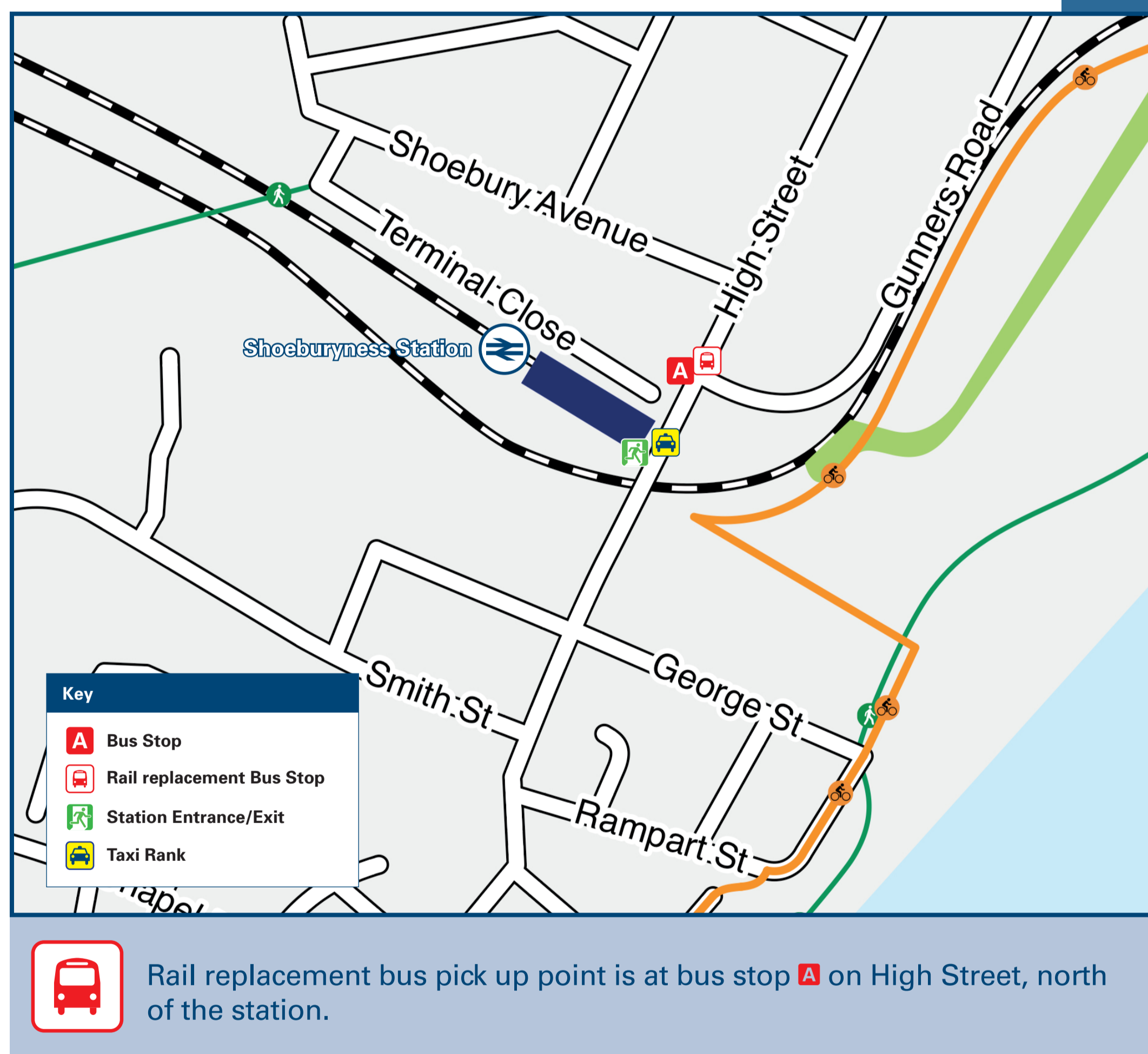

### Taxis

Shoeburyness Station is served by a taxi rank or a cab office. Check availability before travelling, and pre-book if necessary. Please consider using the following local operators: (Inclusion of this number doesn't represent any endorsement of the taxi firm)

**Radio Cars**  
01702 345 678

**A2B Taxis**  
01702 217 430

**Coles Cabs Private Hire**  
07494 204 815

## Main destinations by bus

(Data correct at June 2024)

DESTINATION	BUS ROUTES	BUS STOP
Barling	14	A
Bournes Green	14	A
Eastwood	9	A
Great Wakering	14	A
Little Wakering	14	A
North Shoebury	9, 14	A
Prittlewell	9	A
Rayleigh	9	A
Southchurch	9, 14	A
Southend Airport	9	A
Southend-on-Sea (Town Centre)	9, 14	A
Southend Victoria Station	9	A
Stonebridge	14	A
Thorpe Bay	9	A

### Notes

- Bus route 9 runs a frequent daily service Mondays to Sundays.
- Bus route 14 runs a limited service Mondays to Saturdays only.
- Direct trains operate to Prittlewell, Rayleigh and Southend Airport from Southend Victoria station.
- Direct trains operate to this destination from this station.
- Change here for connecting National Rail services

## Further information about all onward travel

<b>Local Cycle Info</b> southend.gov.uk For more information about cycle routes.	<b>National Cycle Info</b> sustrans.org.uk Sustrans is the UK's leading sustainable transport charity.	<b>Bus Times</b> See timetable displays at bus stops. www.traveline.info 0871 200 22 33 traveline public transport info	<b>NextBuses</b> mobi Find the bus times for your stop. Search for a bus stop by entering a postcode, street & town or a stop name & town.	<b>PlusBus</b> plusbus.info A discount price 'bus pass' that you buy with your train ticket. It gives you unlimited bus travel around your chosen town, on participating buses.
--	--	---	--	---

## National Rail Enquiries

<b>Online</b> nationalrail.co.uk	<b>NRE App</b> Free National Rail Enquiries app for iOS and Android	<b>Social Media</b> facebook.com/nationalrailenq @nationalrailenq	<b>Alert Me</b> You can sign up to Alert Me messages on the National Rail Enquiries website where you can receive train and platform notifications directly to your smart phone. nationalrail.co.uk/alertme	<b>Contact Centre</b> 03457 48 49 50 Calls cost no more than calls to geographic numbers (01 or 02) and may be recorded.	<b>PlusBike</b> nationalrail.co.uk/plusbike For more information.
-------------------------------------	--	---	---	--	---



**National Rail**  
Britain's train companies working together

