

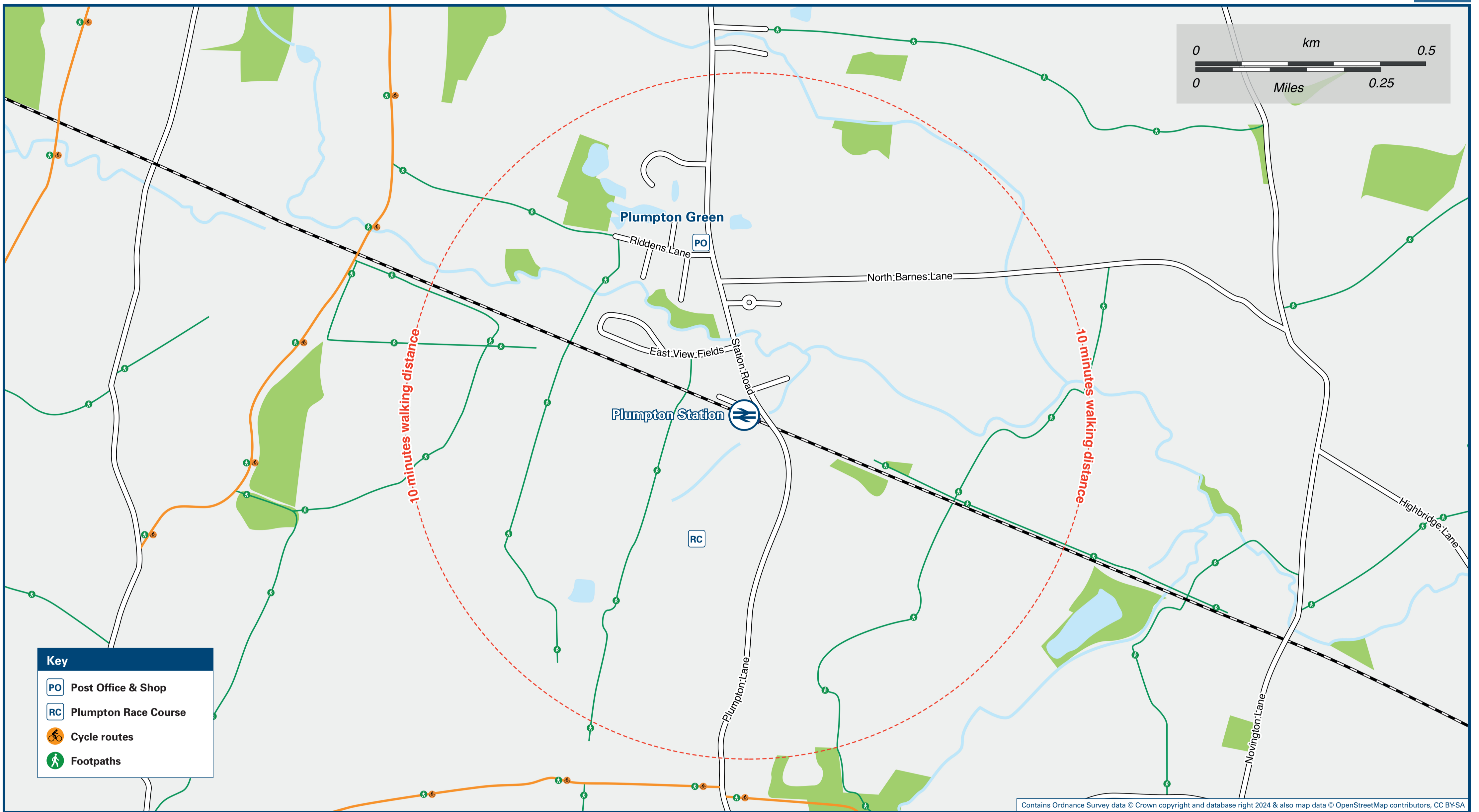

# Plumpton Station

# Onward Travel Information

## Local area map



## Buses

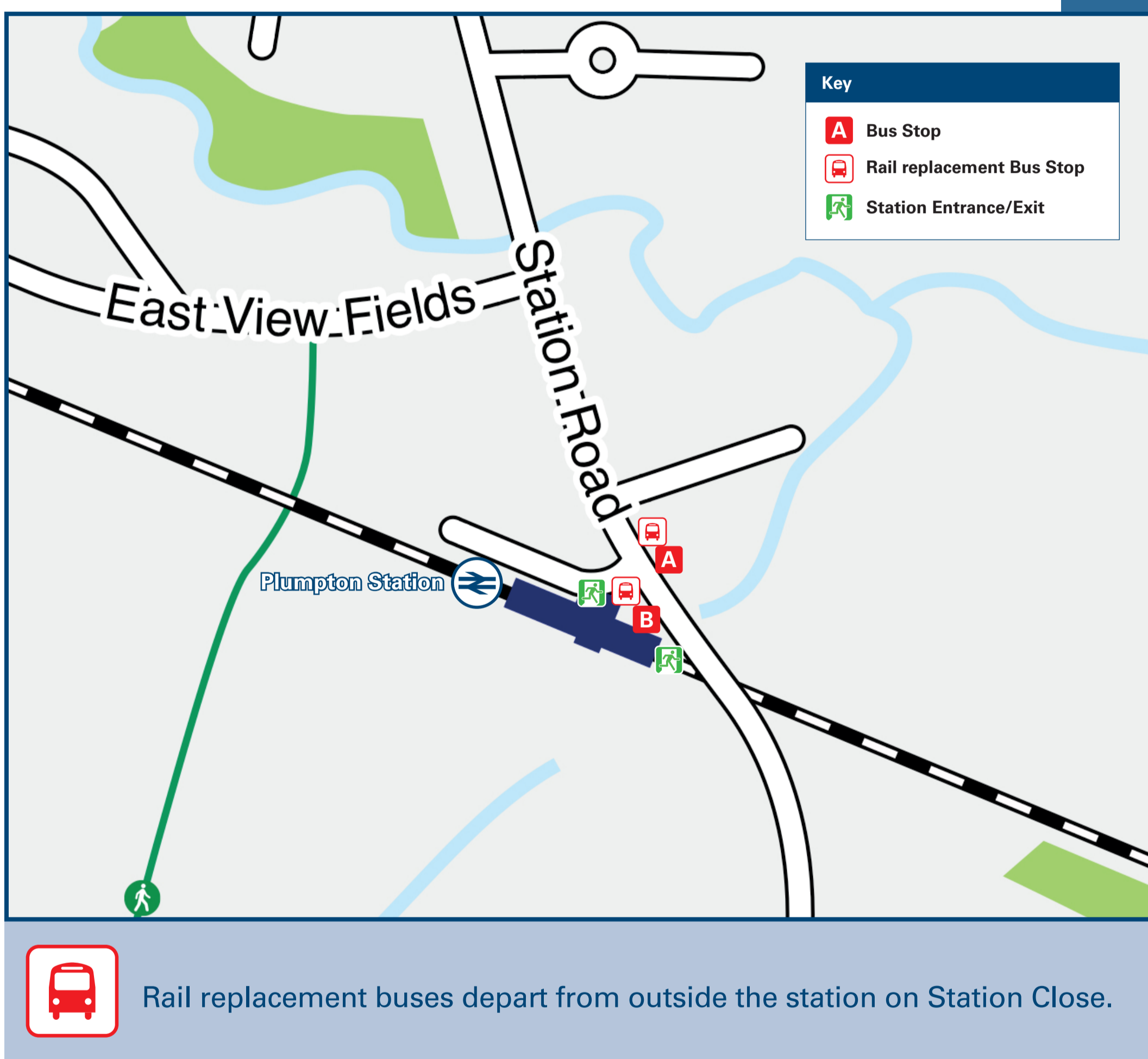

## Main destinations by bus

(Data correct at May 2024)

DESTINATION	BUS ROUTES	BUS STOP
Burgess Hill	167, 168	B
East Chiltington	20 minutes walk from this station	
	168	A
Haywards Heath (Town Centre & Station) ⚡	166	B
Lewes (Nevill Crescent/Nevill Road)	166	A
Lewes (Town Centre) ⚡	166, 167	A
Lewes Victoria Hospital	166	A
Offham	166	A
Plumpton Crossways (Plough Inn)	166, 167, 168	B
Plumpton Green (Fountain Inn)	15 minutes walk from this station	
	166, 167, 168	B
Plumpton Village (for Plumpton College)	166, 168	A
Princess Royal Hospital (Haywards Heath)	166	B
Wivelsfield (Ote Hall Chapel)	166, 167, 168	B
Wivelsfield Green	166, 167, 168	B

### Notes

Bus route 166 operates Mondays to Saturdays.  
 Bus route 167 operates Mondays to Fridays only, please check timetables.  
 Bus route 168 operates Mondays to Fridays only, some journeys run Mondays, Wednesdays and Fridays only, please check timetables.  
 Flexibus is an on-demand bus service that operates in this area which must be booked in advance. For more information call 01273 078 203 or visit [www.eastsussex.gov.uk/roads-transport/public/flexibus](http://www.eastsussex.gov.uk/roads-transport/public/flexibus)  
 For bus times and other bus service enquiries, please contact Traveline on 0871 200 22 33 or contact Compass Travel (for bus routes 166, 167 & 168) call 01903 690 025.  
 ⚡ Direct trains operate to this destination from this station.  
 National Park South Downs National Park [www.southdowns.gov.uk](http://www.southdowns.gov.uk)

## Taxis

Plumpton Station has no taxi rank or cab office. Advance booking is essential, please consider using the following local operators: (Inclusion of this number doesn't represent any endorsement of the taxi firm)

**GMTaxis**  
01273 477 567

**Lewes Taxis**  
01273 483 232

**Five Star Taxis (Hassocks)**  
01444 871 971

## Further information about all onward travel

<b>Local Cycle Info</b> <a href="http://lewes.gov.uk">lewes.gov.uk</a> <small>For more information about cycle routes.</small>	<b>National Cycle Info</b> <a href="http://sustrans.org.uk">sustrans.org.uk</a> <small>Sustrans is the UK's leading sustainable transport charity.</small>	<b>Bus Times</b> <small>See timetable displays at bus stops.</small> <a href="http://www.traveline.info">www.traveline.info</a> <b>0871 200 22 33</b> <small>calls cost 13p per minute plus your phone company's access charge</small>	<b>NextBuses</b>  <b>Find the bus times for your stop.</b> <small>Search for a bus stop by entering a postcode, street &amp; town or a stop name &amp; town.</small>	<b>PlusBus</b> <a href="http://plusbus.info">plusbus.info</a> <small>A discount price 'bus pass' that you buy with your train ticket. It gives you unlimited bus travel around your chosen town, on participating buses.</small>
--------------------------------------------------------------------------------------------------------------------------------------	------------------------------------------------------------------------------------------------------------------------------------------------------------------	----------------------------------------------------------------------------------------------------------------------------------------------------------------------------------------------------------------------------------------------------	-------------------------------------------------------------------------------------------------------------------------------------------------------------------------------	----------------------------------------------------------------------------------------------------------------------------------------------------------------------------------------------------------------------------------------

## National Rail Enquiries

<b>Online</b> <a href="http://nationalrail.co.uk">nationalrail.co.uk</a>	<b>NRE App</b> <b>Free National Rail Enquiries app for iOS and Android</b>	<b>Social Media</b> <a href="https://facebook.com/nationalrailenq">facebook.com/nationalrailenq</a> @nationalrailenq	<b>Alert Me</b> <small>You can sign up to Alert Me messages on the National Rail Enquiries website where you can receive train and platform notifications directly to your smart phone.</small> <a href="http://nationalrail.co.uk/alertme">nationalrail.co.uk/alertme</a>	<b>Contact Centre</b> <b>03457 48 49 50</b> <small>Calls cost no more than calls to geographic numbers (01 or 02) and may be recorded.</small>	<b>PlusBike</b> <a href="http://nationalrail.co.uk/plusbike">nationalrail.co.uk/plusbike</a> <small>For more information.</small>
-----------------------------------------------------------------------------	-------------------------------------------------------------------------------	----------------------------------------------------------------------------------------------------------------------------	----------------------------------------------------------------------------------------------------------------------------------------------------------------------------------------------------------------------------------------------------------------------------------	------------------------------------------------------------------------------------------------------------------------------------------------------	-----------------------------------------------------------------------------------------------------------------------------------------



This poster shows details of popular destinations and main, frequent bus routes. Additional services may run, so please check with Traveline or see posters at local bus stops. Whilst considerable care has been taken to ensure the information contained on this poster is correct and accurate, National Rail cannot accept responsibility for any loss or inconvenience caused by any errors or omissions, or for loss, damage, injury or inconvenience relating to the cancellation, alteration, delay or diversion of a service. For any feedback, please e-mail [comments@onwardtravelposters.com](mailto:comments@onwardtravelposters.com)

Scan this code with your mobile for full station information.