

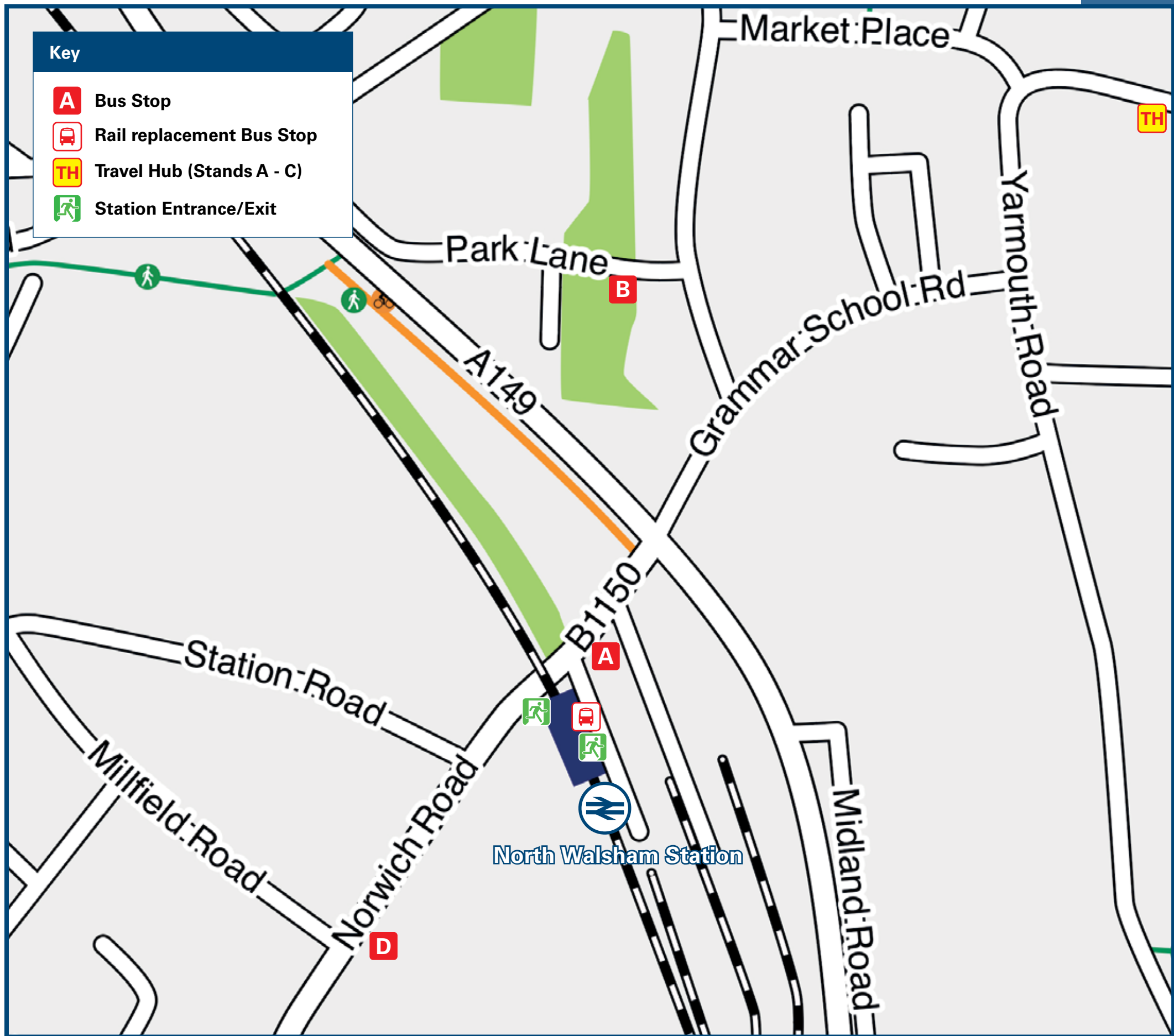

North Walsham Station

Onward Travel Information

Buses



Rail replacement bus services pick up and drop off at the bus stops adjacent to the station entrance.

Local area map

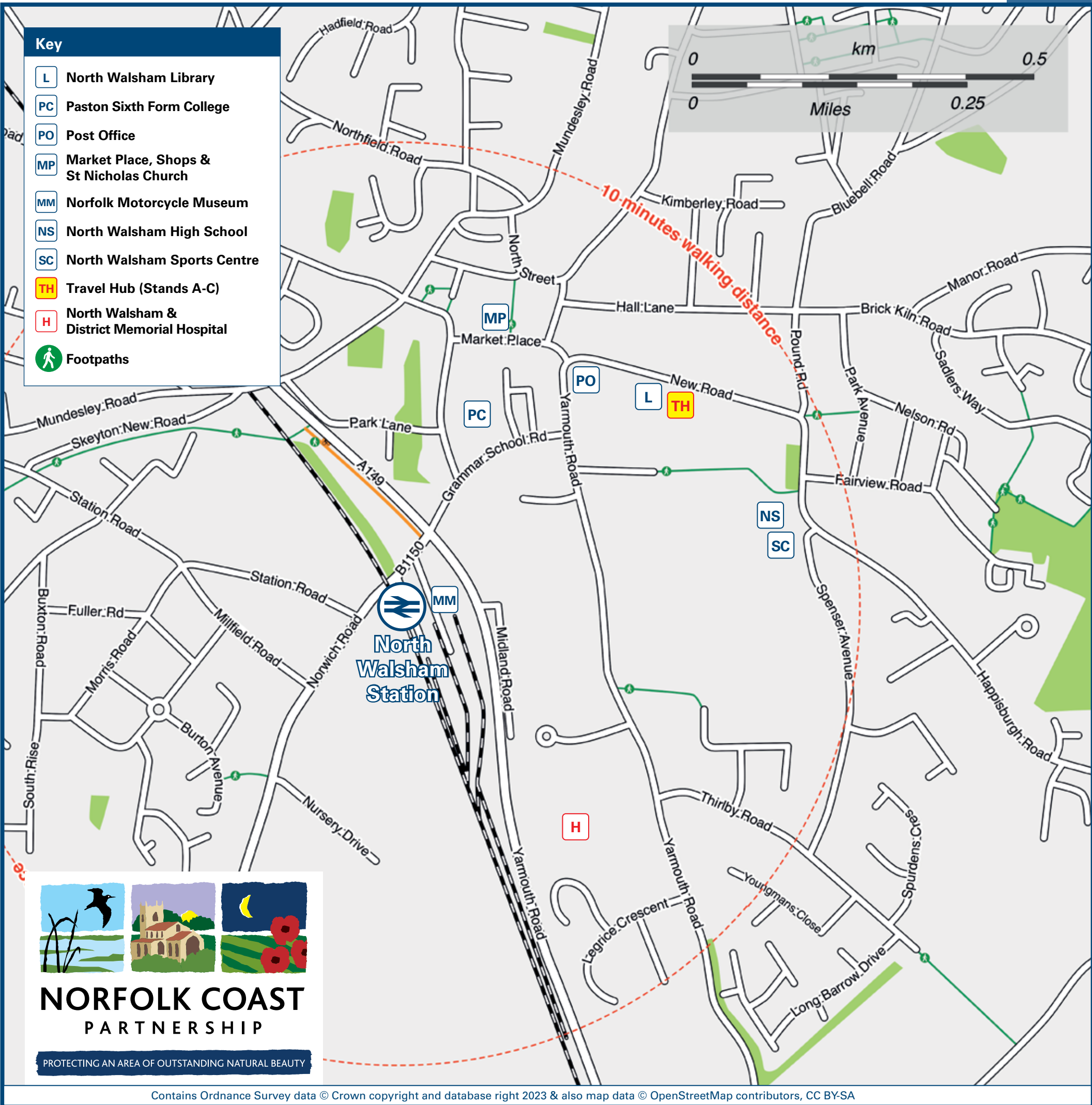

Contains Ordnance Survey data © Crown copyright and database right 2023 & also map data © OpenStreetMap contributors, CC BY-SA

Main destinations by bus

(Data correct at September 2024)



DESTINATION	BUS ROUTES	BUS STOP
Antingham	6A, 33	Hub B, Hub C
Aylsham	18	Hub C
Bacton	34	Hub A
Badersfield	54	A
Banningham	18	Hub C
Bastwick	6, X6	Hub A
Bengate	6, X6	Hub A
Buxton	54	A
Caister-on-Sea	6, X6	Hub A
Calthorpe	18	Hub C
Catfield	6, X6	Hub A
Coltishall	X55	D
Erpingham	18	Hub C
Felmingham	18	Hub C
Frettenham	54	A
Gimingham	5, CH2, X55+	Hub A, Hub B
Great Yarmouth	6, X6	Hub A
Hainford	54	A
Happisburgh	34	Hub A
Horstead	X55	D
Hoveton & Wroxham Station	Direct train	
Ingworth	18	Hub C
Knapton	34	Hub A

DESTINATION	BUS ROUTES	BUS STOP
Ludham	6, X6	Hub A
Martham	X6+	Hub A
Mundesley	34	Hub A
Northrepps	5, CH2, X55+	Hub A, Hub B
Ormesby	33	B, Hub C
Ormesby	6, X6	Hub A
Overstrand	5, CH2	Hub A
Potter Heigham	6, X6	Hub A
Rollesby	6, X6	Hub A
Roughton	6A	B, Hub B
Sea Palling	34	Hub A
Sco Ruston	X55	D
Scottow	X55	D
Sidestrand	5, CH2	Hub A
Skeyton	54	A
Smallburgh	6, X6	Hub A
Southrepps	33	B, Hub C
Spixworth	54	A
Stalham	X55#	D
Sutton	34	Hub A
	6, X6	Hub A
	6, 34, X6	Hub A

DESTINATION	BUS ROUTES	BUS STOP
Swaffield	5, CH2, X55+	Hub A, Hub B
Swanton Abbott	34	Hub A
Swanton Abbott	54	A
Thorpe Market	6A, 33	B, Hub B, Hub C
Trimingham	5, CH2	Hub A
Trunch	5, CH2, X55+	Hub A, Hub B
Walcott	34	Hub A
Wayford and Wayford Bridge	6, X6	Hub A

Notes

Bus routes 5 and CH2 (Coasthopper) 54 and X55 operate daily, Mondays to Sundays.
Bus routes 6, 6A and X6 operate Mondays to Saturdays.
Bus routes 18, 33 and 34 operate Mondays to Fridays, only.
⚡ Direct trains operate to this destination from this station.
+ Not all journeys serve this destination with this service, please check timetables before travelling.
Alight bus on the B1150 Spixworth Crostwick Lane, it's a 10 minutes walk into the village.
STM Take the train to Hoveton & Wroxham, or the bus to Buxton or Coltishall for The Bure Valley Railway. Telephone the Bure Valley Railway on 01263 733858 for information.
AONB Norfolk Coast (AONB) www.norfolkcoastaonb.org.uk

Taxis

North Walsham station has no taxi rank or cab office. Advance booking is essential, please consider using the following local operators: (Inclusion of this number doesn't represent any endorsement of the taxi firm)

NJE
01692 404 796

Crystal Cabs
01692 400 880

AA North Walsham Taxis
01692 669 465

Further information about all onward travel

Local Cycle Info

www.norfolkcoastaonb.org.uk;
For more information about cycle routes.

National Cycle Info

sustrans.org.uk
Sustrans is the UK's leading sustainable transport charity.

Bus Times

See timetable displays at bus stops.

www.traveline.info
0871 200 22 33
calls cost 12p per minute plus your phone company's access charge

NextBuses



PlusBus

Find the bus times for your stop.
Search for a bus stop by entering a postcode, street & town or a stop name & town.

plusbus.info
A discount price 'bus pass' that you buy with your train ticket. It gives you unlimited bus travel around your chosen town, on participating buses.

National Rail Enquiries

Online

nationalrail.co.uk

NRE App

Free National Rail Enquiries app for iOS and Android

Social Media

facebook.com/nationalrailenq
 @nationalrailenq

Alert Me

You can sign up to Alert Me messages on the National Rail Enquiries website where you can receive train and platform notifications directly to your smart phone.
nationalrail.co.uk/alertme

Contact Centre

03457 48 49 50
Calls cost no more than calls to geographic numbers (01 or 02) and may be recorded.

PlusBike

nationalrail.co.uk/plusbike
For more information.

greateranglia



National Rail
Britain's train companies working together



This poster shows details of popular destinations and main, frequent bus routes. Additional services may run, so please check with Traveline or see posters at local bus stops. Whilst considerable care has been taken to ensure the information contained on this poster is correct and accurate, National Rail cannot accept responsibility for any loss or inconvenience caused by any errors or omissions, or for loss, damage, injury or inconvenience relating to the cancellation, alteration, delay or diversion of a service. For any feedback, please e-mail comments@onwardtravelposters.com

Scan this code with your mobile for full station information.