

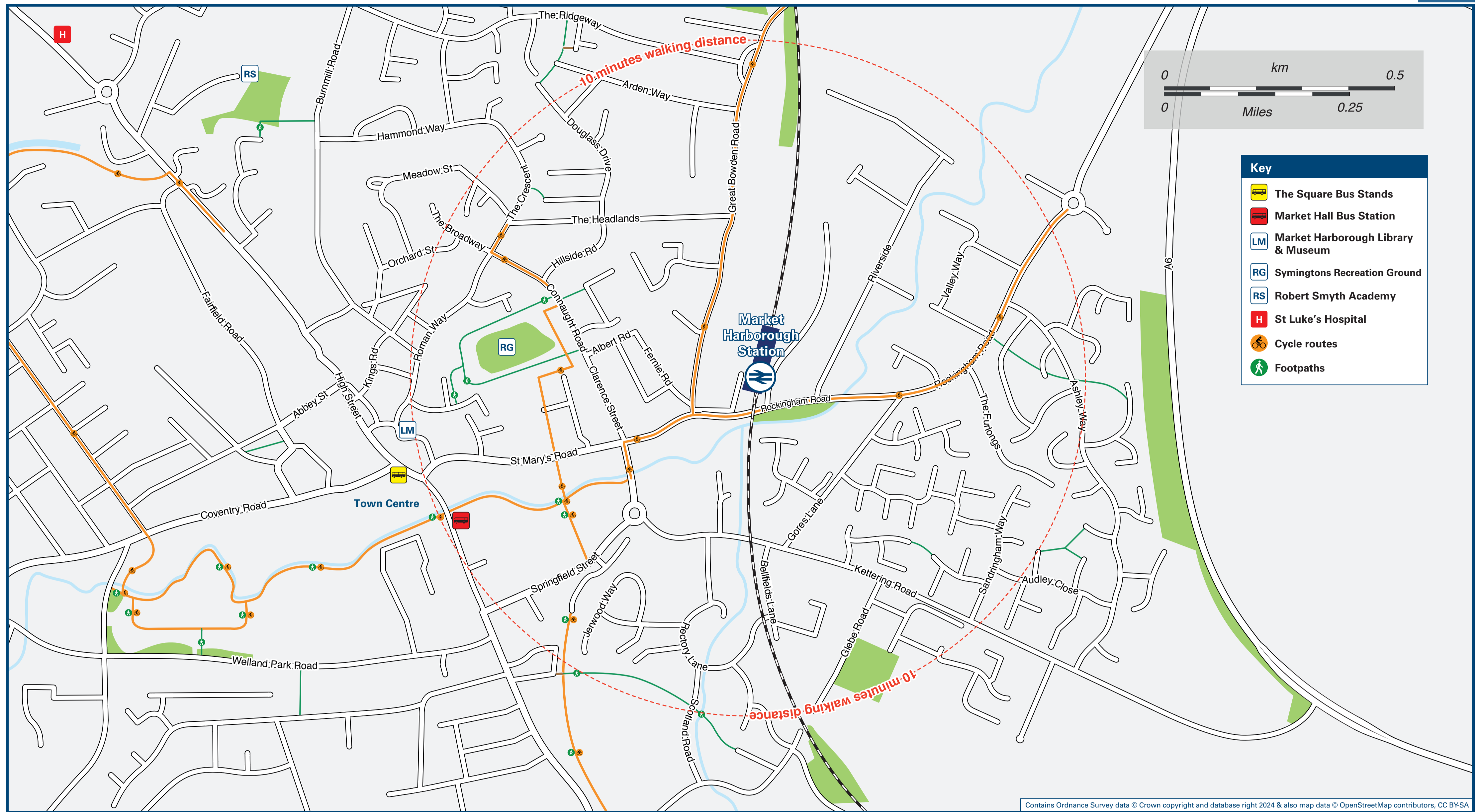

# Market Harborough Station

# Onward Travel Information

## Local area map



## Buses and Taxis

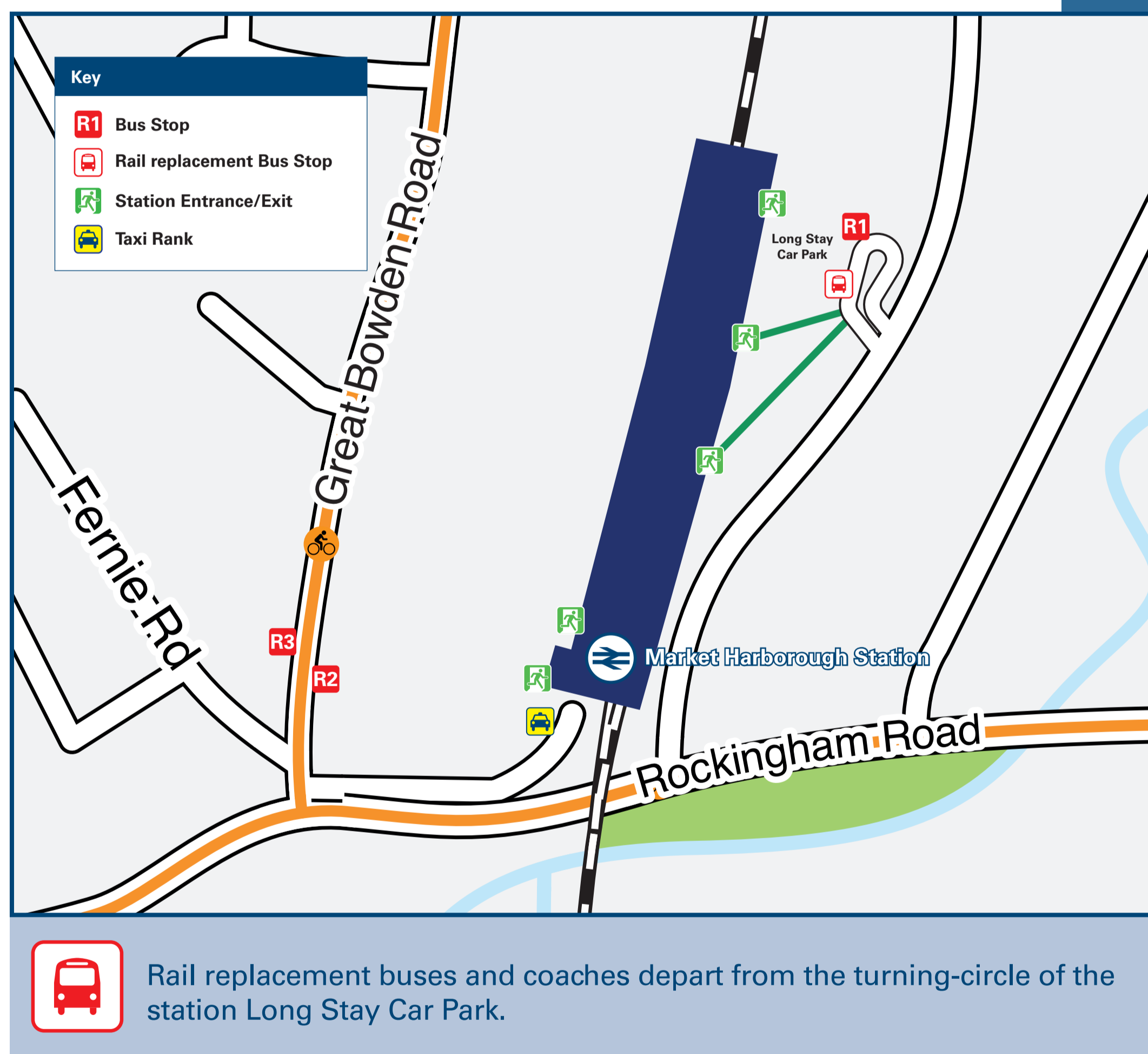

## Main destinations by bus

(Data correct at April 2024)

DESTINATION	BUS ROUTES	BUS STOP
Church Langton	44	R 1*, R 3
East Langton	44	R 1*, R 3
Fleckney	44	R 1*, R 3
Foxton	44	R 1*, R 2
Great Bowden	44	R 1*, R 3
HMP Gartree (Opposite bus shelter)	44 (bus runs via Foxton)	R 1*, R 2
Kibworth Beauchamp (The Square)	44	R 1*, R 3
Kibworth Harcourt (Barnards Way)	44	R 1*, R 3
Market Harborough (Airfield Business Park)	44	R 1*, R 2
Market Harborough (St Lukes Hospital)	44	R 1*, R 2
Market Harborough (Town Centre, The Square) ♻️, #	44	R 1*, R 2
Saddington	44	R 1*, R 3
Smeeton Westerby	44	R 1*, R 3
Thorpe Langton	44	R 1*, R 3
Tur Langton	44	R 1*, R 3

### Notes

Bus route 44 operates Mondays to Saturdays.  
 For bus times and details of bus routes from the town centre, please contact Traveline on 0871 200 22 33.  
 ♻️ It's approximately a 10 to 15 minutes walk from this station to Market Harborough (Town Centre, The Square), see maps for walking route.  
 # Bus services to additional destinations depart from the Town Centre (The Square and Market Hall bus stops), contact Traveline for details.  
 \* Bus stop {R1} is located at the station back entrance near the long stay car park.

## Taxis

Market Harborough station is served by a taxi rank or cab office. Check availability before travelling, and pre-book if necessary. Please consider using the following local operators: (Inclusion of this number doesn't represent any endorsement of the taxi firm)

**A2B Taxis**  
01858 466 770

**Diamond Taxis**  
01858 469 090

**Random Cabs**  
01858 469 299

## Further information about all onward travel

<b>Local Cycle Info</b> <a href="http://choosehowyoumove.co.uk">choosehowyoumove.co.uk</a> <small>For more information about cycle routes.</small>	<b>National Cycle Info</b> <a href="http://sustrans.org.uk">sustrans.org.uk</a> <small>Sustrans is the UK's leading sustainable transport charity.</small>	<b>Bus Times</b> <small>See timetable displays at bus stops.</small> <a href="http://www.traveline.info">www.traveline.info</a> <b>0871 200 22 33</b> <small>calls cost 13p per minute plus your phone company's access charge</small>	<b>NextBuses</b>  <b>Find the bus times for your stop.</b> <small>Search for a bus stop by entering a postcode, street &amp; town or a stop name &amp; town.</small>	<b>PlusBus</b> <a href="http://plusbus.info">plusbus.info</a> <small>A discount price 'bus pass' that you buy with your train ticket. It gives you unlimited bus travel around your chosen town, on participating buses.</small>
--	--	--	---	--

## National Rail Enquiries

<b>Online</b> <a href="http://nationalrail.co.uk">nationalrail.co.uk</a>	<b>NRE App</b> <b>Free National Rail Enquiries app for iOS and Android</b>	<b>Social Media</b> <a href="https://facebook.com/nationalrailenq">facebook.com/nationalrailenq</a> @nationalrailenq	<b>Alert Me</b> <small>You can sign up to Alert Me messages on the National Rail Enquiries website where you can receive train and platform notifications directly to your smart phone.</small> <a href="http://nationalrail.co.uk/alertme">nationalrail.co.uk/alertme</a>	<b>Contact Centre</b> <b>03457 48 49 50</b> <small>Calls cost no more than calls to geographic numbers (01 or 02) and may be recorded.</small>	<b>PlusBike</b> <a href="http://nationalrail.co.uk/plusbike">nationalrail.co.uk/plusbike</a> <small>For more information.</small>
---	---	--	--	--	---



**National Rail**  
Britain's train companies working together



This poster shows details of popular destinations and main, frequent bus routes. Additional services may run, so please check with Traveline or see posters at local bus stops. Whilst considerable care has been taken to ensure the information contained on this poster is correct and accurate, National Rail cannot accept responsibility for any loss or inconvenience caused by any errors or omissions, or for loss, damage, injury or inconvenience relating to the cancellation, alteration, delay or diversion of a service. For any feedback, please e-mail [comments@onwardtravelposters.com](mailto:comments@onwardtravelposters.com)

Scan this code with your mobile for full station information.