

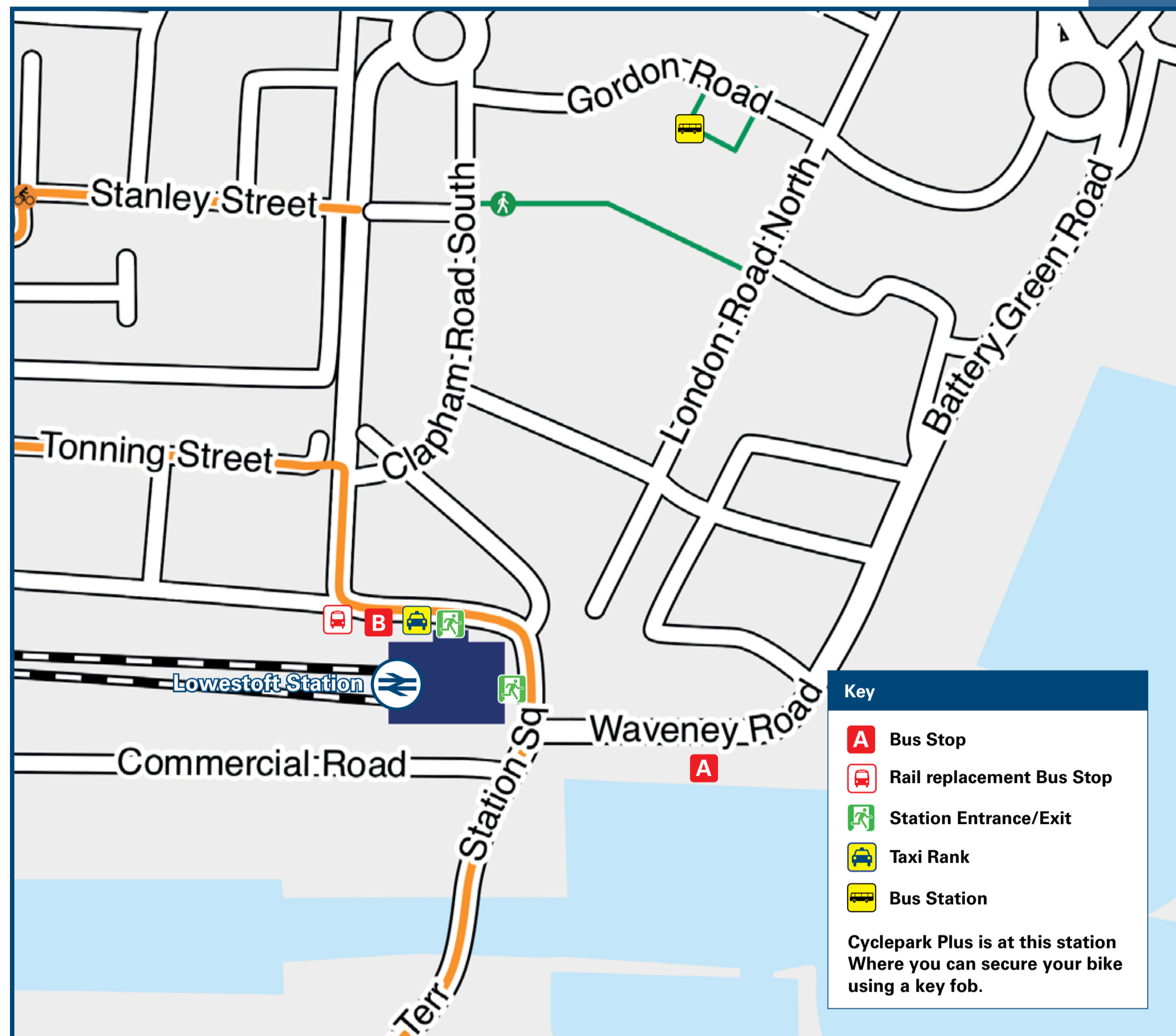

# Lowestoft Station

# Onward Travel Information

## Buses and Taxis



Rail replacement bus services pick up and drop off at the bus stops in the interchange area, just outside the station and adjacent to Platform 2.

## Local area map



Lowestoft is a PlusBus area.

PlusBus is a discount price 'bus pass' that you buy with your train ticket. It gives you unlimited bus travel around your chosen town, on participating buses. Visit [www.plusbus.info](http://www.plusbus.info)

## Main destinations by bus

(Data correct at September 2024)

DESTINATION	BUS ROUTES	BUS STOP
Blundeston	X1	Bus Station 5
● Carlton Colville	109	A
● Corton Village	X2, X21, X22	Bus Station 2, 3
● East Anglia Transport Museum	1, 1A	Bus Station 4
● Fortress Estate (Ribblesdale)	X22	Bus Station 2
Gorleston	1, 1A, X1	Bus Station 4, 5
Great Yarmouth (Town Centre)	1, 1A, X1	Bus Station 4, 5
● Hollow Grove Way	109	A
● Hopton-on-Sea	X2, X21	Bus Station 3
● Kessingland (& "Africa Alive" Park & Zoo)	1, 1A, X1	Bus Station 4, 5
● Kirkley	99	A
	99	A
	X2, X21, X22	Bus Station 2, 3

DESTINATION	BUS ROUTES	BUS STOP
James Paget Hospital (Gorleston)	1, 1A, X1	Bus Station 4, 5
● Lowestoft (Bus Station)	5 minutes walk (see maps)	
	99, 109, X2, X21, X22	B
● Lowestoft (East Coast College Campus)	105, 122	Bus Station 10
● Normanston	102, 105	Bus Station 10
● Oulton Broad	102, 106, 122	Bus Station 8, 10
● Oulton Rock Estate	105, 122	Bus Station 10
● Oulton Village	102, 105, 122	Bus Station 10
	99	A
● Pakefield	X2, X21	Bus Station 3
● Pleasurewood Hills Theme Park (Alight at Tesco)	1, 1A, X1	Bus Station 4, 5
Reydon	99	A
Southwold	99	A
Wangford	99	A

DESTINATION	BUS ROUTES	BUS STOP
● Whitton	109	A
	106, X22	Bus Station 2, 8
Worlingham	X2, X21, X22	Bus Station 2, 3
Wrentham	99	A

**Notes**

- PlusBus destination, please see below for details.
- Bus routes 1, 1A, 99, 101, 109, 122, X1, X21 and X22 operate daily.
- Bus routes 102, 105, 106 & X2 operate on Mondays to Saturdays, only.
- Plusbus tickets are valid within the Lowestoft Plusbus zone only on First Norfolk & Suffolk services.
- For bus times please see bus stop or bus station timetables or contact Traveline.
- Direct trains operate to this destination from this station.
- Taxis info Lowestoft station is served by a taxi rank or cab office. Check availability before travelling, and pre-book if necessary. Please consider using the following local operators: (Inclusion of this number doesn't represent any endorsement of the taxi firm)
- National Park Broadlands National Park [www.enjoythebroads.com](http://www.enjoythebroads.com)

## Taxis

Lowestoft station is served by a taxi rank or cab office. Check availability before travelling, and pre-book if necessary. Please consider using the following local operators: (Inclusion of this number doesn't represent any endorsement of the taxi firm)

**Atlas Taxis**  
01502 500 000

**51 Taxis**  
01502 515 151

**Roadrunners Taxi**  
01502 555 555

## Further information about all onward travel

<b>Local Cycle Info</b> <a href="http://www.suffolkonboard.com/cycle">www.suffolkonboard.com/cycle</a> For more information about cycle routes.	<b>National Cycle Info</b> <a href="http://sustrans.org.uk">sustrans.org.uk</a> Sustrans is the UK's leading sustainable transport charity.	<b>Bus Times</b> See timetable displays at bus stops.  <a href="http://www.traveline.info">www.traveline.info</a> 0871 200 22 33 call cost 12p per minute plus your phone company's access charge	<b>NextBuses</b> <b>Find the bus times for your stop.</b> Search for a bus stop by entering a postcode, street & town or a stop name & town.	<b>PlusBus</b> <b>plusbus.info</b> A discount price 'bus pass' that you buy with your train ticket. It gives you unlimited bus travel around your chosen town, on participating buses.
---	---	--	--	--

## National Rail Enquiries

<b>Online</b> <a href="http://nationalrail.co.uk">nationalrail.co.uk</a>	<b>NRE App</b> Free National Rail Enquiries app for iOS and Android	<b>Social Media</b> facebook.com/nationalrailenq @nationalrailenq	<b>Alert Me</b> You can sign up to Alert Me messages on the National Rail Enquiries website where you can receive train and platform notifications directly to your smart phone. <a href="http://nationalrail.co.uk/alertme">nationalrail.co.uk/alertme</a>	<b>Contact Centre</b> 03457 48 49 50 Calls cost no more than calls to geographic numbers (01 or 02) and may be recorded.	<b>PlusBike</b> <a href="http://nationalrail.co.uk/plusbike">nationalrail.co.uk/plusbike</a> For more information.
---	--	---	---	--	--



**National Rail**  
Britain's train companies working together

