

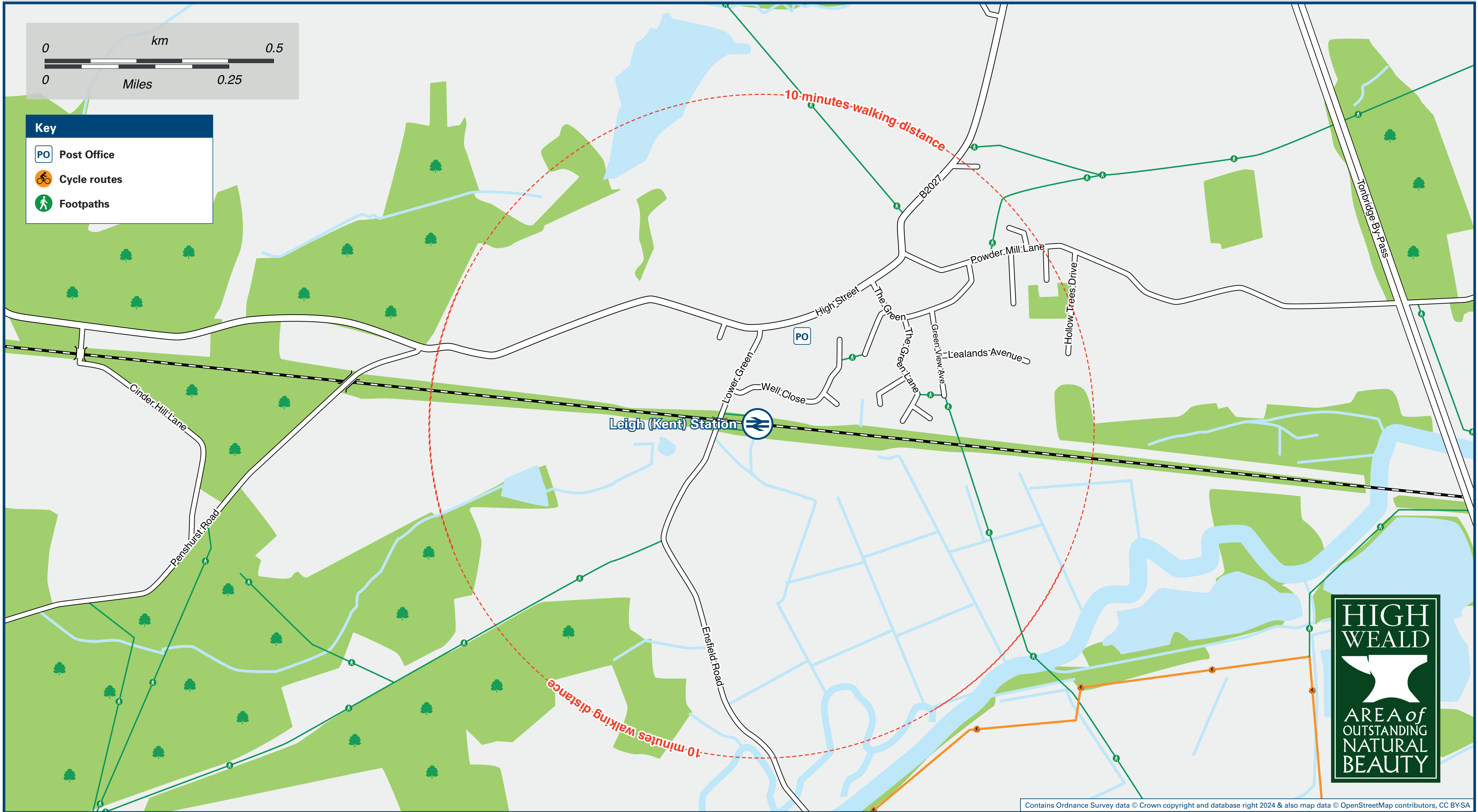

Leigh (Kent) Station

Onward Travel Information

Local area map



Buses

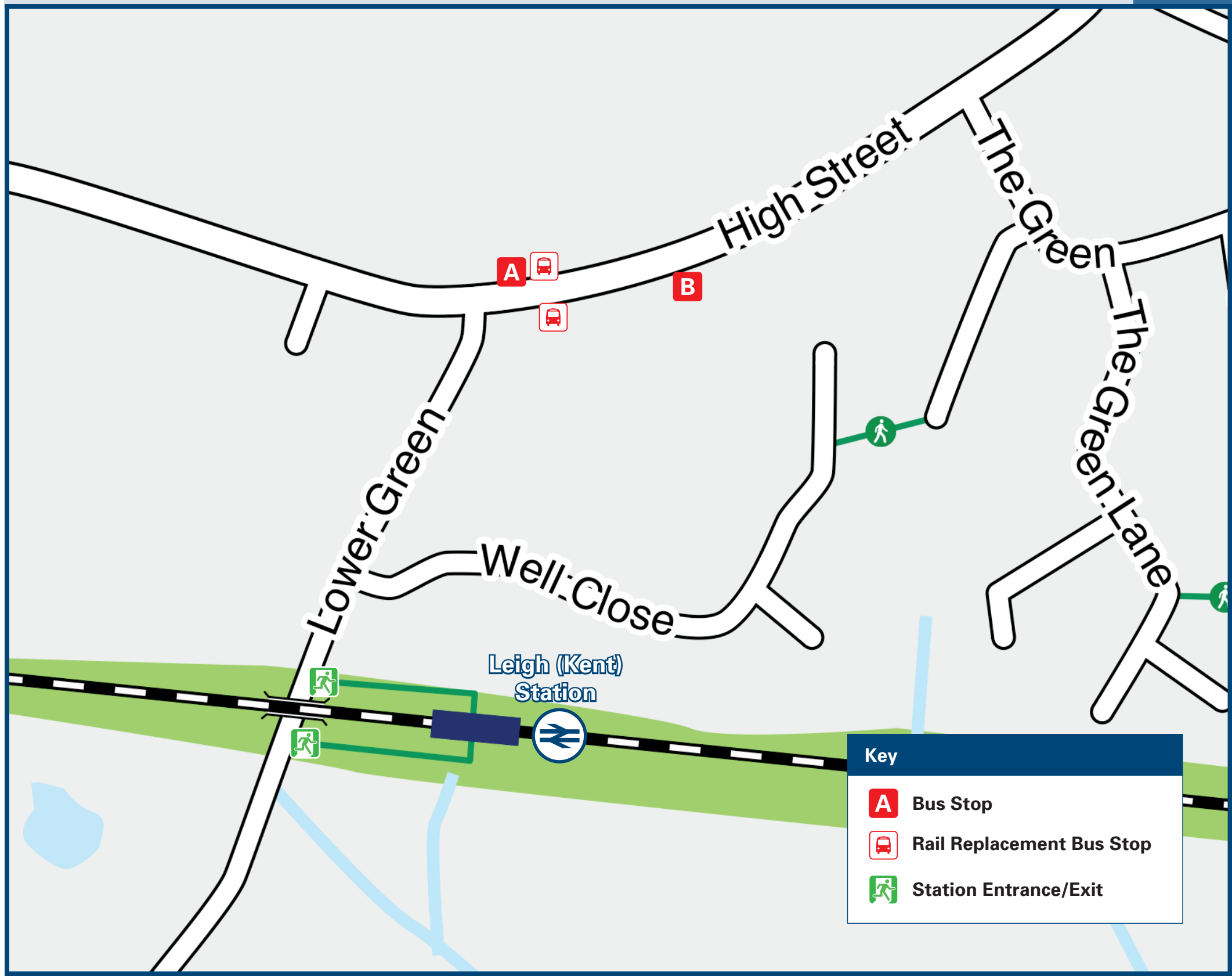

Rail replacement buses depart from outside the Fleur de Lis Public House on the High Street.

Main destinations by bus

(Data correct at July 2025)

DESTINATION	BUS ROUTES	BUS STOP
Charcott	210	B
Chiddingstone Causeway	210	B
Hildenborough Village	210	A
Hilden Park	210	A
Penshurst Railway Station	210	B
Tonbridge (Castle)	210	A
Tonbridge (High Street / Shops)	210	A
Tonbridge (Quarry Hill Parade for Station)	210	A
Tonbridge School	210	A

Notes

Bus route 210 operates a limited daytime service on Mondays to Saturdays, only.
For bus times and days of operation please contact Traveline on www.traveline.info or call: 0871 200 22 33
Direct trains operate to this destination from this station.
AONB High Weald (AONB) www.highweald.org

Taxis

Leigh (Kent) Station has no taxi rank or cab office. Advance booking is essential, please consider using the following local operators: (Inclusion of this number doesn't represent any endorsement of the taxi firm)

HS Taxis (Hildenborough)
07886 327 104

Castle Cars
01732 363 638

Relyon Cars
01732 863 800

Further information about all onward travel

Local Cycle Info

sevenoaks.gov.uk
For more information about cycle routes.

National Cycle Info

sustrans.org.uk
Sustrans is the UK's leading sustainable transport charity.

Bus Times

See timetable displays at bus stops.
www.traveline.info
0871 200 22 33
calls cost 15p per minute plus your phone company's access charge

NextBuses

Find the bus times for your stop.
Search for a bus stop by entering a postcode, street & town or a stop name & town.

PlusBus

plusbus.info
A discount price 'bus pass' that you buy with your train ticket. It gives you unlimited bus travel around your chosen town, on participating buses.

National Rail Enquiries

Online

nationalrail.co.uk

NRE App

Free National Rail Enquiries app for iOS and Android

Social Media

[facebook.com/nationalrailenq](https://www.facebook.com/nationalrailenq)
[@nationalrailenq](https://twitter.com/nationalrailenq)

Alert Me

You can sign up to Alert Me messages on the National Rail Enquiries website where you can receive train and platform notifications directly to your smart phone.
nationalrail.co.uk/alertme

Contact Centre

03457 48 49 50
Calls cost no more than calls to geographic numbers (01 or 02) and may be recorded.

PlusBike

nationalrail.co.uk/plusbike
For more information.



National Rail
Britain's train companies working together



This poster shows details of popular destinations and main, frequent bus routes. Additional services may run, so please check with Traveline or see posters at local bus stops. Whilst considerable care has been taken to ensure the information contained on this poster is correct and accurate, National Rail cannot accept responsibility for any loss or inconvenience caused by any errors or omissions, or for loss, damage, injury or inconvenience relating to the cancellation, alteration, delay or diversion of a service. For any feedback, please e-mail comments@onwardtravelposters.com

Scan this code with your mobile for full station information.