

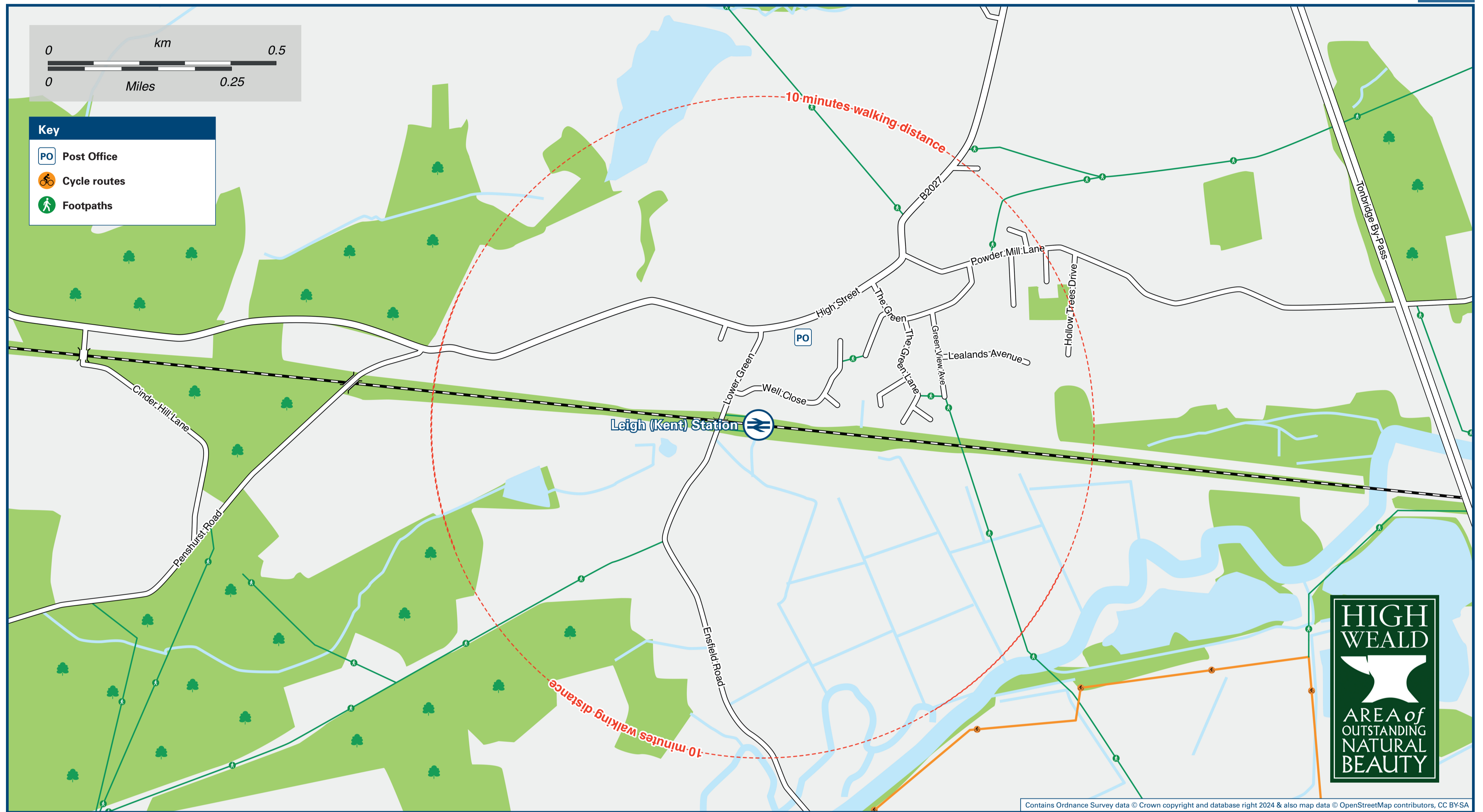

Leigh (Kent) Station

Onward Travel Information

Local area map



Buses

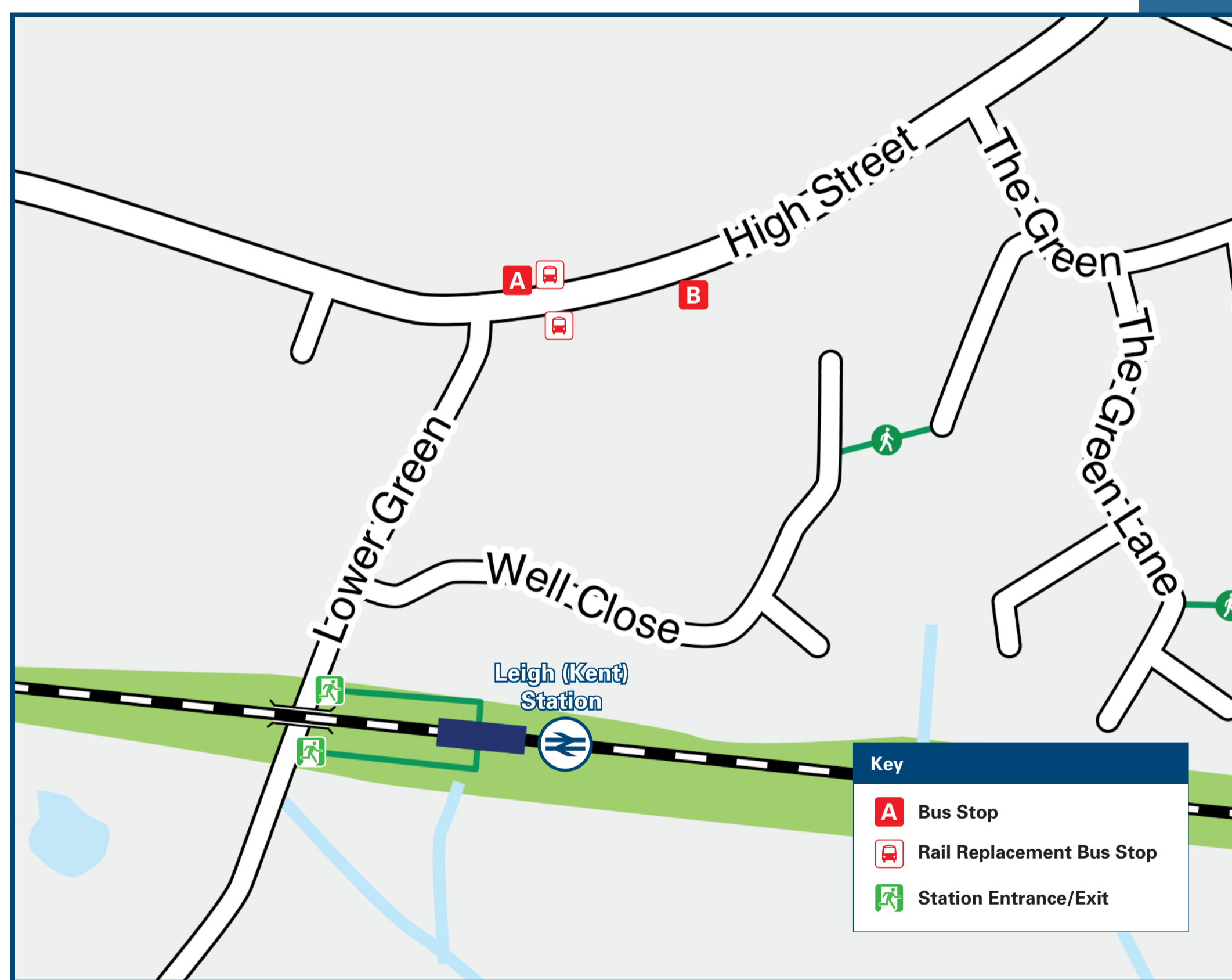

Rail replacement buses depart from outside the Fleur de Lis Public House on the High Street.

Main destinations by bus

(Data correct at May 2024)

DESTINATION	BUS ROUTES	BUS STOP
Charcott	210	B
Chiddingstone Causeway	210	B
Hildenborough Village	210	A
Hilden Park	210	A
Penshurst Railway Station	210	B
Tonbridge (Castle)	210	A
Tonbridge (High Street / Shops)	210	A
Tonbridge (Quarry Hill Parade for Station)	210	A
Tonbridge School	210	A

Notes

Bus route 210 operates Mondays to Saturdays only.
 For bus times and other bus service enquiries, please contact Traveline on 0871 200 22 33 or Autocar Bus & Coach Services (for bus route 210) call 01892 833 830.
 Direct trains operate to this destination from this station.
 AONB High Weald (AONB) www.highweald.org

Taxis

Leigh (Kent) Station has no taxi rank or cab office. Advance booking is essential, please consider using the following local operators: (Inclusion of this number doesn't represent any endorsement of the taxi firm)

HS Taxis (Hildenborough)
01732 252 888

Castle Cars
01732 363 638

Relyon Cars
01732 863 800

Further information about all onward travel

Local Cycle Info sevenoaks.gov.uk For more information about cycle routes.	National Cycle Info sustrans.org.uk Sustrans is the UK's leading sustainable transport charity.	Bus Times See timetable displays at bus stops. www.traveline.info 0871 200 22 33 calls cost 13p per minute plus your phone company's access charge	NextBuses Find the bus times for your stop. Search for a bus stop by entering a postcode, street & town or a stop name & town.	PlusBus plusbus.info A discount price 'bus pass' that you buy with your train ticket. It gives you unlimited bus travel around your chosen town, on participating buses.
---	---	---	--	---

National Rail Enquiries

Online nationalrail.co.uk	NRE App Free National Rail Enquiries app for iOS and Android	Social Media facebook.com/nationalrailenq @nationalrailenq	Alert Me You can sign up to Alert Me messages on the National Rail Enquiries website where you can receive train and platform notifications directly to your smart phone. nationalrail.co.uk/alertme	Contact Centre 03457 48 49 50 Calls cost no more than calls to geographic numbers (01 or 02) and may be recorded.	PlusBike nationalrail.co.uk/plusbike For more information.
---	--	---	---	--	--



National Rail
Britain's train companies working together



This poster shows details of popular destinations and main, frequent bus routes. Additional services may run, so please check with Traveline or see posters at local bus stops. Whilst considerable care has been taken to ensure the information contained on this poster is correct and accurate, National Rail cannot accept responsibility for any loss or inconvenience caused by any errors or omissions, or for loss, damage, injury or inconvenience relating to the cancellation, alteration, delay or diversion of a service. For any feedback, please e-mail comments@onwardtravelposters.com

Scan this code with your mobile for full station information.