

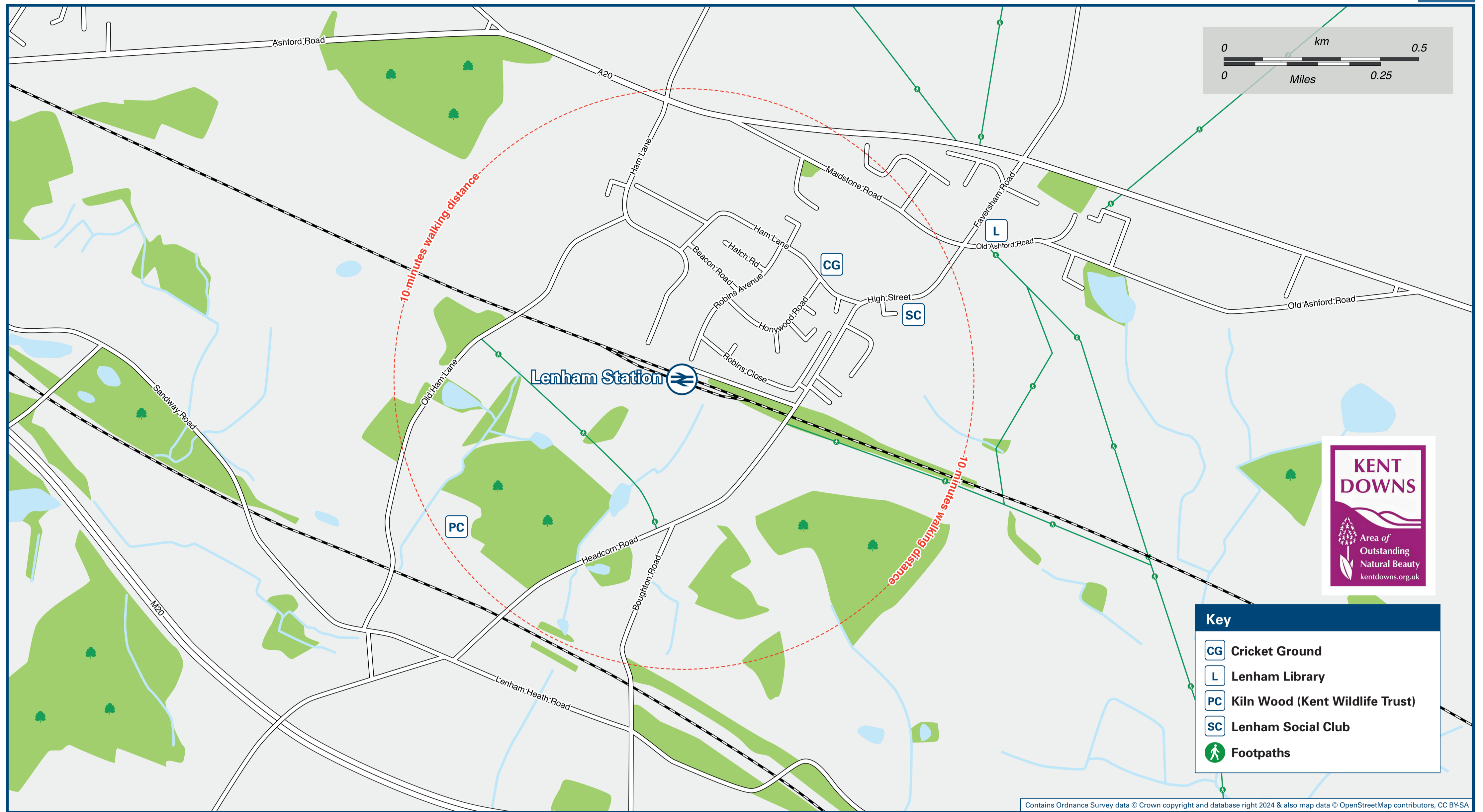

# Lenham Station

# Onward Travel Information

## Local area map



## Buses

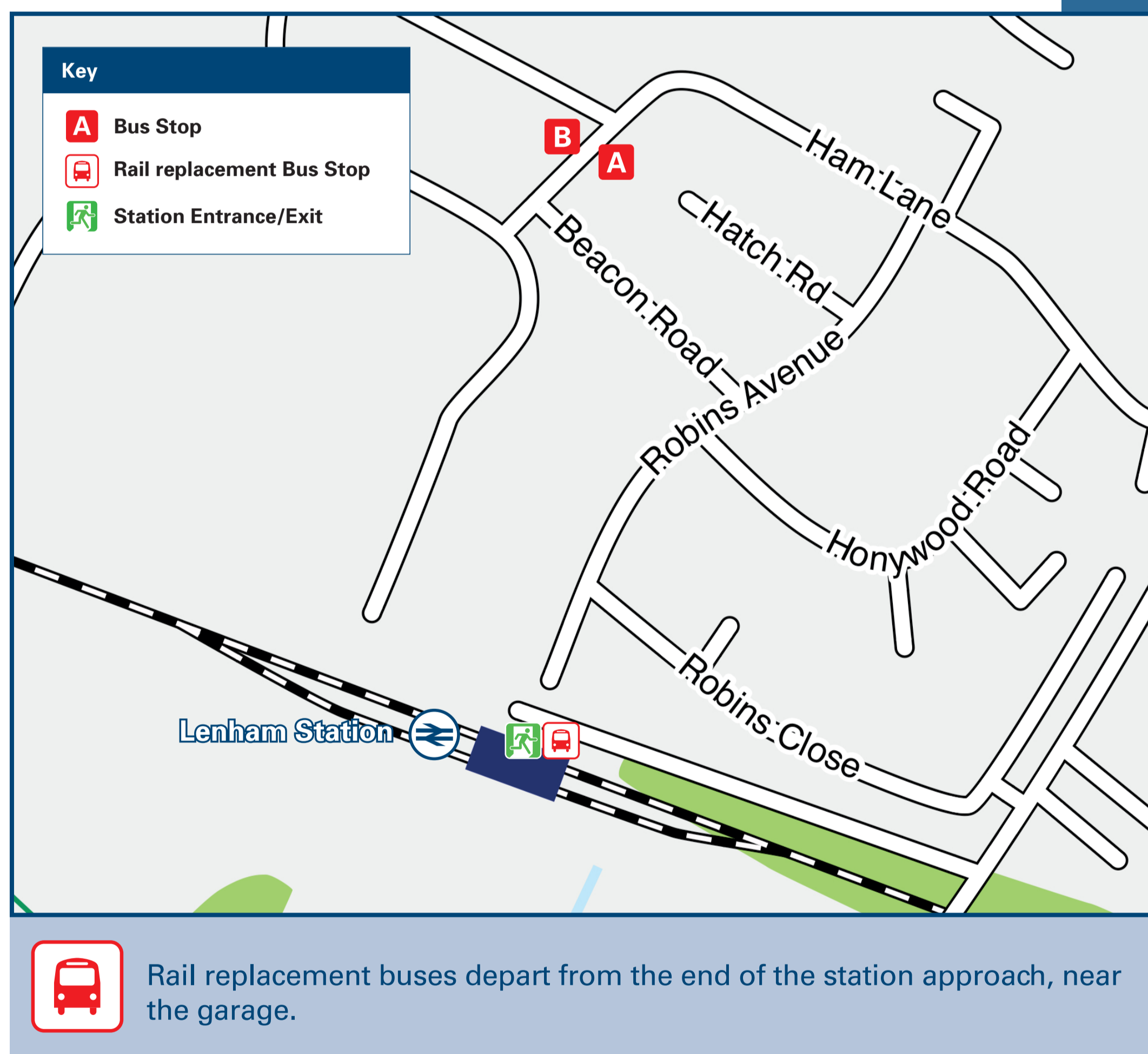

## Main destinations by bus

(Data correct at July 2024)

DESTINATION	BUS ROUTES	BUS STOP
Ashford (Orchard Heights)	10X	B
Ashford (Potter's Corner, Hare & Hounds)	10X	B
Ashford (The Warren for John Lewis)	10X	B
Ashford (Town Centre, County Square)	10X	B
Ashford International Railway Station	10X	B
Bearsted (The Yeoman)	10X	A
Charing (The Moat)	10X	B
Charing Heath (Church)	10X*	B
Harrietsham (The Roebuck Hotel)	10X	A
Hollingbourne (Great Danes Hotel)	10X#	A
Hothfield (The Woolpack)	10X	B
Maidstone (Earl Street, for Fremlin Walk Shops)	10X	A
Maidstone (King Street, for The Mall Shopping Centre)	10X	A
Maidstone (Royal Star Arcade)	10X	A
Maidstone (Weaving Street, for Mote Park)	10X	A

**Notes**

Bus route 10X operates Mondays to Saturdays.  
 For bus times and further information contact Stagecoach South East (for bus route 10X) [www.stagecoachbus.com/help-and-contact](http://www.stagecoachbus.com/help-and-contact) or call 0345 241 8000 or contact Traveline on 0871 200 22 33.

Direct trains operate to this destination from Lenham station.  
 # Hollingbourne Village and Railway Station are a 15 to 20 minutes walk from the Great Danes Hotel bus stop on the A20.  
 \* Bus route 10X operates a limited service to Charing Heath village, please check the timetable.  
 AONB Kent Downs (AONB) [www.kentdowns.org.uk](http://www.kentdowns.org.uk)

## Taxis

Lenham Station has no taxi rank or cab office. Advance booking is essential, please consider using the following local operators: (Inclusion of this number doesn't represent any endorsement of the taxi firm)

**United Cars**  
01622 321 321

**Sapphire Cars**  
01622 663 000

**Streamline Kent**  
01622 750 000

## Further information about all onward travel

<b>Local Cycle Info</b> <a href="http://maidstone.gov.uk">maidstone.gov.uk</a> For more information about cycle routes.	<b>National Cycle Info</b> <a href="http://sustrans.org.uk">sustrans.org.uk</a> Sustrans is the UK's leading sustainable transport charity.	<b>Bus Times</b> See timetable displays at bus stops. <a href="http://www.traveline.info">www.traveline.info</a> 0871 200 22 33 <small>calls cost 12p per minute plus your phone company's access charge</small>	<b>NextBuses</b>  <b>Find the bus times for your stop.</b> Search for a bus stop by entering a postcode, street & town or a stop name & town.	<b>PlusBus</b> <a href="http://plusbus.info">plusbus.info</a> A discount price 'bus pass' that you buy with your train ticket. It gives you unlimited bus travel around your chosen town, on participating buses.
---	---	--	--	---

## National Rail Enquiries

<b>Online</b> <a href="http://nationalrail.co.uk">nationalrail.co.uk</a>	<b>NRE App</b> Free National Rail Enquiries app for iOS and Android	<b>Social Media</b> <a href="https://facebook.com/nationalrailenq">facebook.com/nationalrailenq</a> @nationalrailenq	<b>Alert Me</b> You can sign up to Alert Me messages on the National Rail Enquiries website where you can receive train and platform notifications directly to your smart phone. <a href="http://nationalrail.co.uk/alertme">nationalrail.co.uk/alertme</a>	<b>Contact Centre</b> 03457 48 49 50 Calls cost no more than calls to geographic numbers (01 or 02) and may be recorded.	<b>PlusBike</b> <a href="http://nationalrail.co.uk/plusbike">nationalrail.co.uk/plusbike</a> For more information.
---	--	--	---	--	--



**National Rail**  
Britain's train companies working together



This poster shows details of popular destinations and main, frequent bus routes. Additional services may run, so please check with Traveline or see posters at local bus stops. Whilst considerable care has been taken to ensure the information contained on this poster is correct and accurate, National Rail cannot accept responsibility for any loss or inconvenience caused by any errors or omissions, or for loss, damage, injury or inconvenience relating to the cancellation, alteration, delay or diversion of a service. For any feedback, please e-mail [comments@onwardtravelposters.com](mailto:comments@onwardtravelposters.com)

Scan this code with your mobile for full station information.