

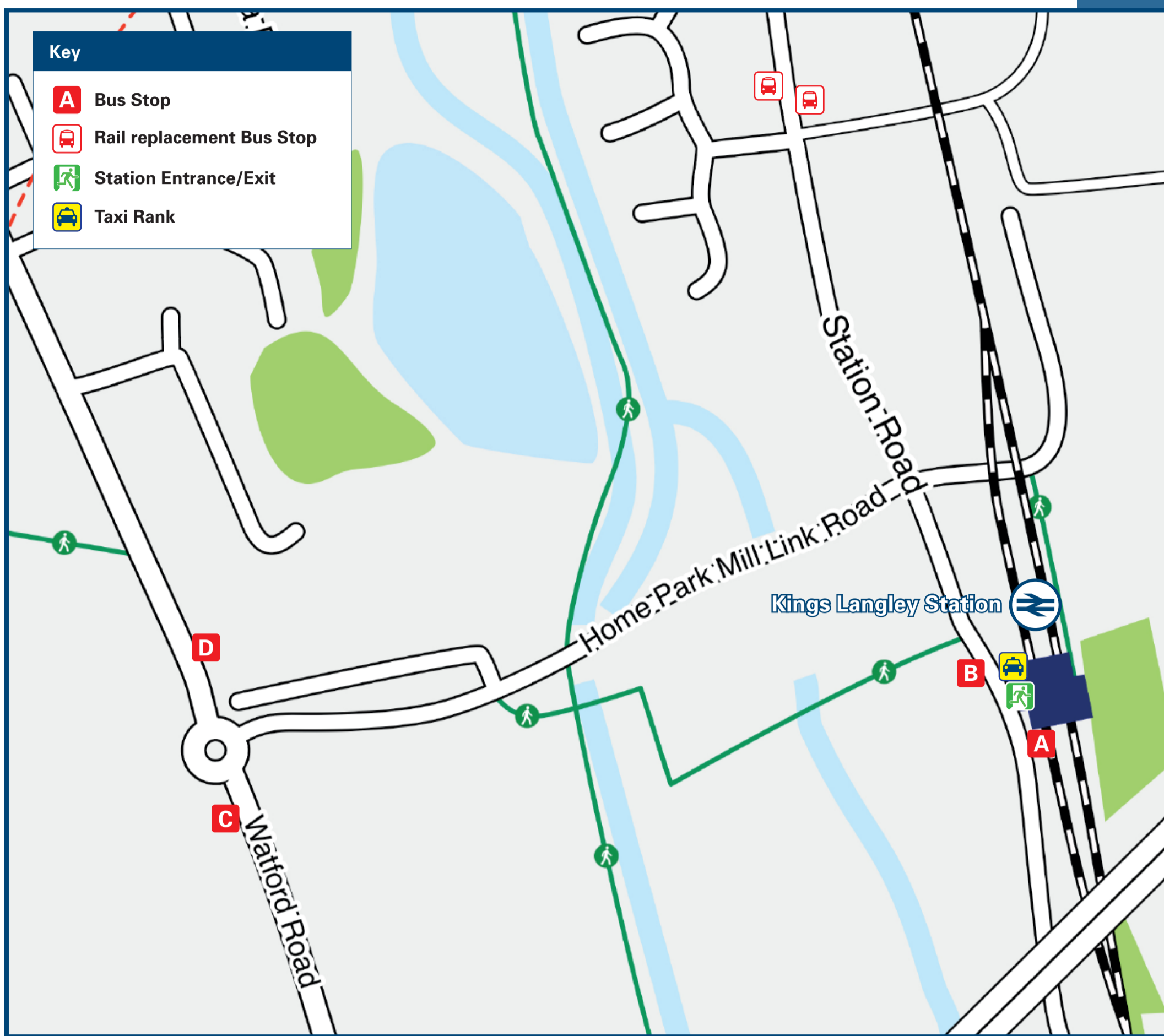

Kings Langley Station

Onward Travel Information

Buses and Taxis



Rail replacement buses depart from bus stops on Station Road, near to the junction with Roman Gardens towards Hemel Hempstead and near to the junction of Egg Farm Lane towards Watford, see map above.

Local area map

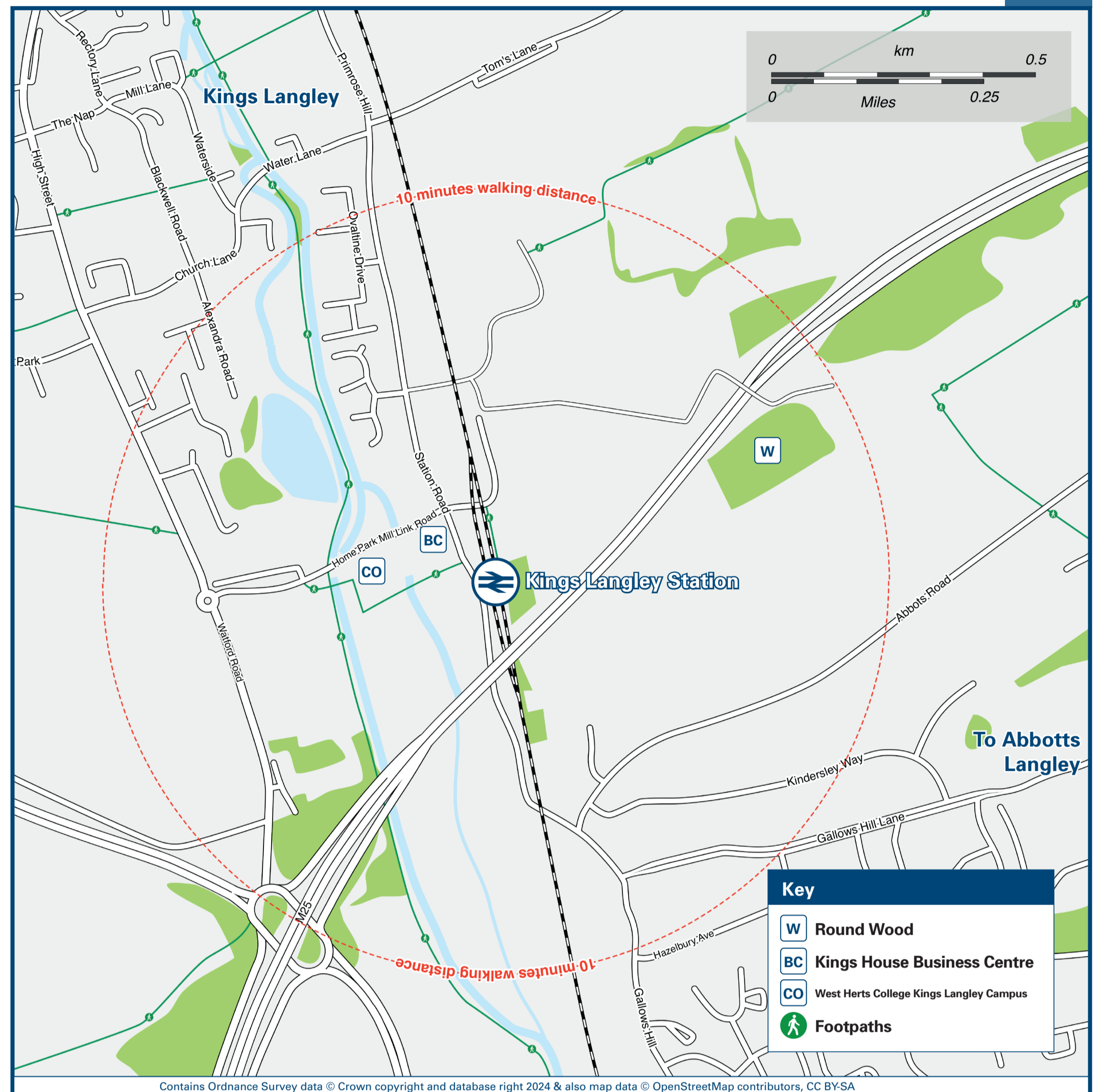

Main destinations by bus

(Data correct at July 2024)



DESTINATION	BUS ROUTES	BUS STOP
Abbots Langley	H19+, R9*	A
	H19+	A
Apsley	322	C
Bedmond (High View Park)	H19+	A
Berkhamsted	501^	C
Chipperfield	R9**	B
Croxley Green	322	D
Hemel Hempstead Town Centre	H19+	A
	322, 501^^	C
Hunton Bridge	322, 501^	D

DESTINATION	BUS ROUTES	BUS STOP
	15 - 20 minutes walk from this station (see Local area map)	
Kings Langley Village (High Street)	H19+	A
	R9**	B
	322, 501^	C
Leavesden Park	R9*	A
Maple Cross (Downings Wood Terminus)	322~	D
Nash Mills	322, 501^	C
North Watford (for Superstores)	R9*	A
Rickmansworth (Berry Lane Estate)	322	D
Rickmansworth Station	322	D

DESTINATION	BUS ROUTES	BUS STOP
Watford General Hospital	322	D
Watford Junction Station	322, 501^	D
Watford Town Centre	322, 501^	D

Notes

Bus route 322 operates daily.
 For bus times and further information contact Traveline on 0871 200 22 33 or Arriva (for bus route 322) call 0344 800 44 11; Red Rose Travel (for bus route 501) call 01296 747 926 or Red Eagle Buses (for bus routes (H19 & R9) call 01296 747 926.

- Direct trains operate to this destination from this station.
- Change here for other National Rail trains.
- Change here for London Underground trains.

+ Bus route H19 runs one bus at 10:40 on Tuesdays and Thursdays only to this destination.
 * Bus route R9 runs one bus at 11:23 on Mondays, Wednesdays and Fridays only to this destination.
 ** Bus route R9 runs one bus at 14:14 on Mondays, Wednesdays and Fridays only to this destination.
 ^ Bus route 501 runs hourly daytime on Sundays & Public Holidays only.
 ^^ Bus route 501 runs hourly daytime on Sundays & Public Holidays only and continues from Hemel Hempstead to Berkhamsted, Tring and Aylesbury.
 ~ Bus route 322 runs Mondays to Saturdays only to Maple Cross.

Taxis

Kings Langley Station is served by a taxi rank or cab office. Check availability before travelling, and pre-book if necessary. Consider using the following local operators: (Inclusion of this number doesn't represent any endorsement of the taxi firm)

Kings Cars
01923 262 266

Kings Langley Cars
01923 551 155

Street Cars
01923 264 045

Further information about all onward travel

Local Cycle Info dacorum.gov.uk For more information about cycle routes.	National Cycle Info sustrans.org.uk Sustrans is the UK's leading sustainable transport charity.	Bus Times See timetable displays at bus stops. traveline public transport info www.traveline.info 0871 200 22 33 call cost 13p per minute plus your phone company's access charge	NextBuses Download on the App Store Find the bus times for your stop. Search for a bus stop by entering a postcode, street & town or a stop name & town.	PlusBus plusbus.info A discount price 'bus pass' that you buy with your train ticket. It gives you unlimited bus travel around your chosen town, on participating buses.
---	--	---	---	---

National Rail Enquiries

Online nationalrail.co.uk	NRE App Free National Rail Enquiries app for iOS and Android	Social Media facebook.com/nationalrailenq @nationalrailenq	Alert Me You can sign up to Alert Me messages on the National Rail Enquiries website where you can receive train and platform notifications directly to your smart phone. nationalrail.co.uk/alertme	Contact Centre 03457 48 49 50 Calls cost no more than calls to geographic numbers (01 or 02) and may be recorded.	PlusBike nationalrail.co.uk/plusbike For more information.
-------------------------------------	--	---	---	--	---

