

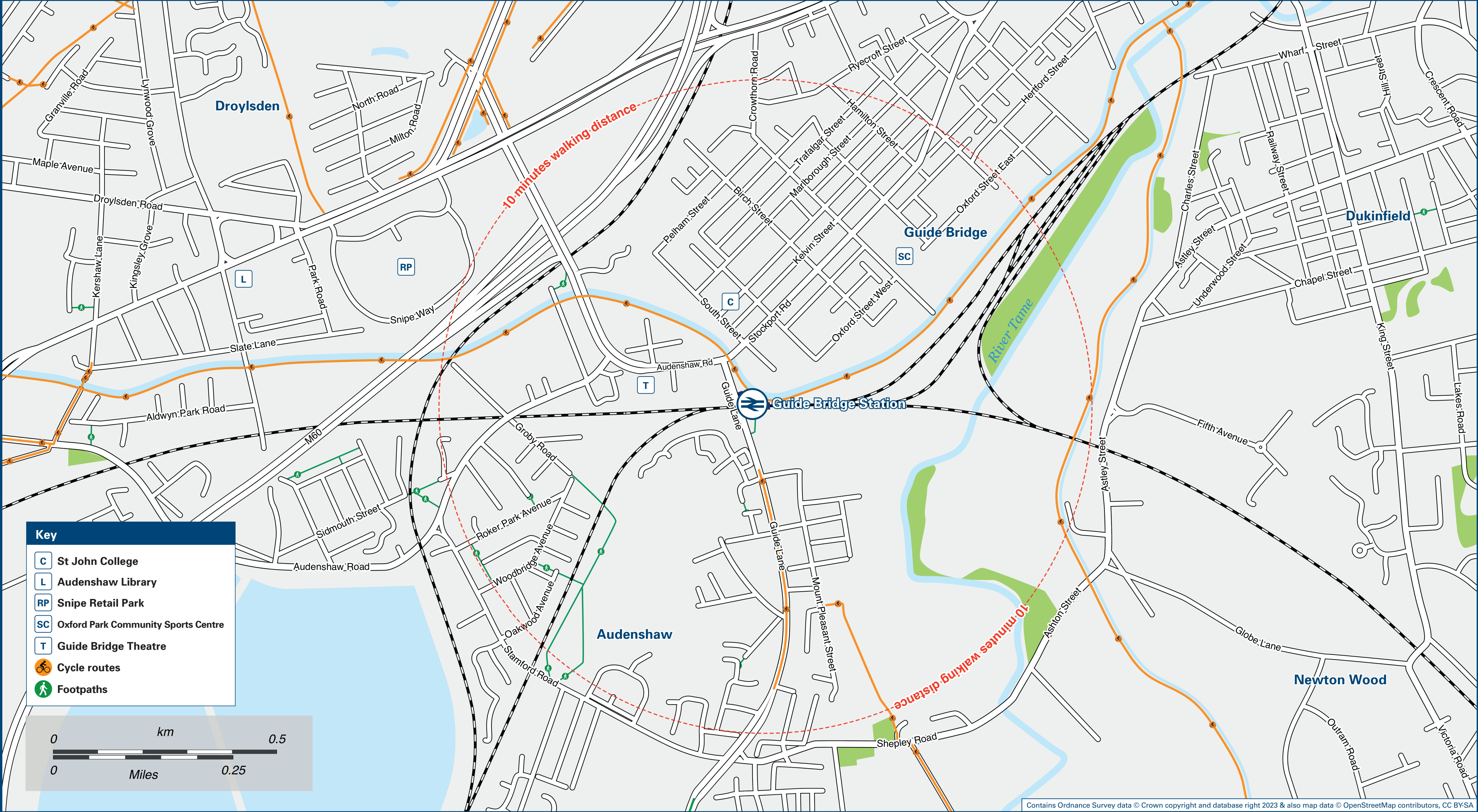

Guide Bridge Station

Onward Travel Information

Local area map



Buses

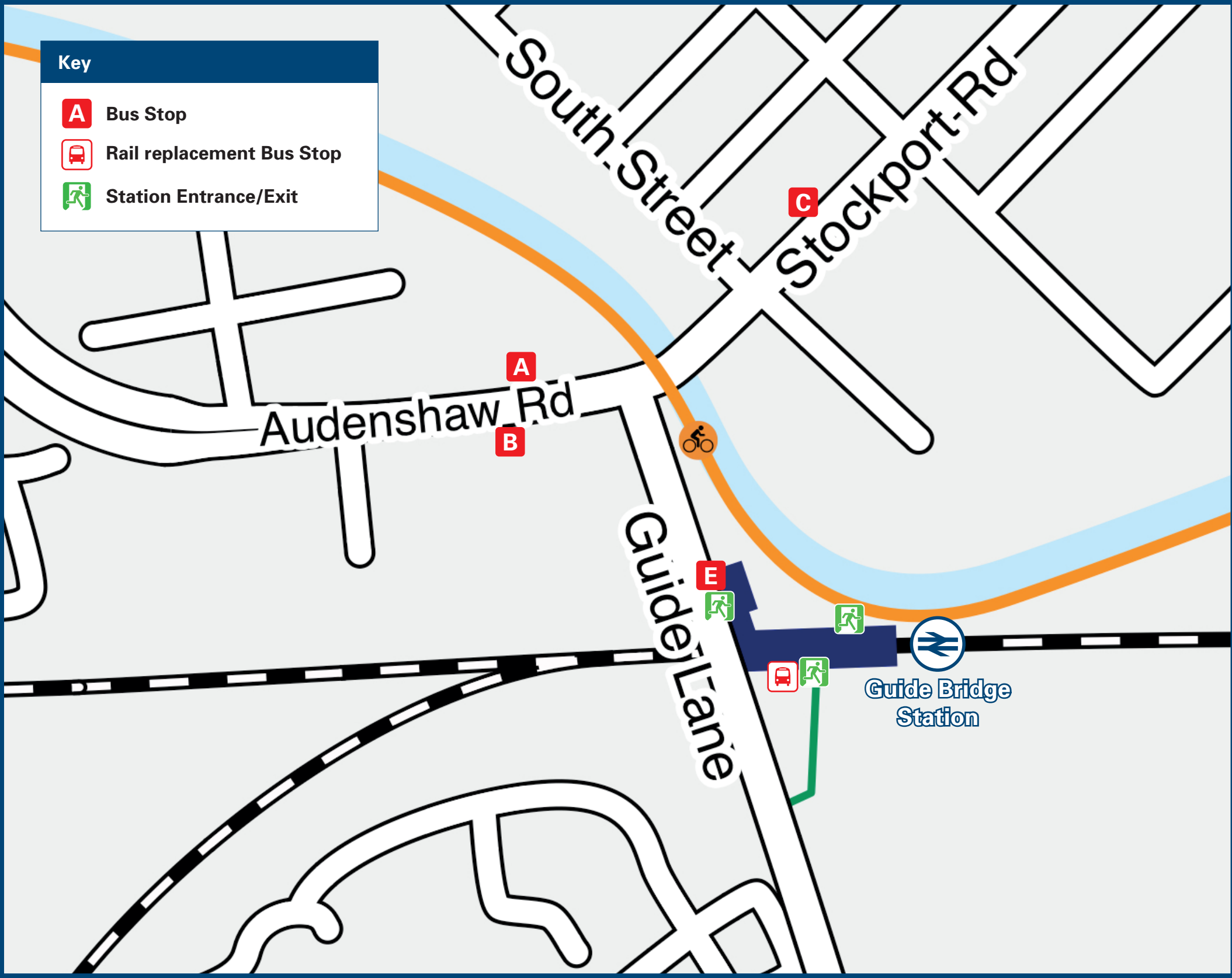

Rail replacement buses depart from the lay-by outside the station entrance.

Main destinations by bus

(Data correct at November 2023)

DESTINATION	BUS ROUTES	BUS STOP
Ardwick	219	B
Ashton-under-Lyne (Interchange)	219	A
	219, 347	C
Audenshaw	219	B
Beswick	219	B
Circular Road Estate (Stockport Road)	347	E
Denton (for Crown Point Shopping Park)	347	E
Fairfield	219	B
Haughton Green	347	E
Higher Openshaw	219	B
Manchester City Centre	219	B
Openshaw	219	B
Stalybridge	219*	A, C

Notes

Bus routes 219 and 347 operate daily, including evenings and public holidays.
For bus times please see bus stop timetables or contact Traveline on 0871 200 22 33.
Direct trains operate to this destination from this station.
* Operates early mornings, evenings and late nights only to Stalybridge.

Taxis

Guide Bridge station has no taxi rank or cab office. Advance booking is essential, please consider using the following local operators: (Inclusion of this number doesn't represent any endorsement of the taxi firm)

A1 Private Hire
0161 343 5050

Metro Cabs
0161 368 8888

On Time Taxis
0161 370 8557

Further information about all onward travel

Local Cycle Info

tameside.gov.uk
For more information about cycle routes.

National Cycle Info

sustrans.org.uk
Sustrans is the UK's leading sustainable transport charity.

Bus Times

See timetable displays at bus stops.

www.traveline.info
0871 200 22 33
calls cost 15p per minute
plus your phone company's access charge

NextBuses

Find the bus times for your stop.
Search for a bus stop by entering a postcode, street & town or a stop name & town.

PlusBus

plusbus.info
A discount price 'bus pass' that you buy with your train ticket. It gives you unlimited bus travel around your chosen town, on participating buses.

National Rail Enquiries

Online

nationalrail.co.uk

NRE App

Free National Rail Enquiries app for iOS and Android

Social Media

facebook.com/nationalrailenq
 @nationalrailenq

Alert Me

You can sign up to Alert Me messages on the National Rail Enquiries website where you can receive train and platform notifications directly to your smart phone.
nationalrail.co.uk/alertme

Contact Centre

03457 48 49 50
Calls cost no more than calls to geographic numbers (01 or 02) and may be recorded.

PlusBike

nationalrail.co.uk/plusbike
For more information.



National Rail
Britain's train companies working together



This poster shows details of popular destinations and main, frequent bus routes. Additional services may run, so please check with Traveline or see posters at local bus stops. Whilst considerable care has been taken to ensure the information contained on this poster is correct and accurate, National Rail cannot accept responsibility for any loss or inconvenience caused by any errors or omissions, or for loss, damage, injury or inconvenience relating to the cancellation, alteration, delay or diversion of a service. For any feedback, please e-mail comments@onwardtravelposters.com

Scan this code with your mobile for full station information.