

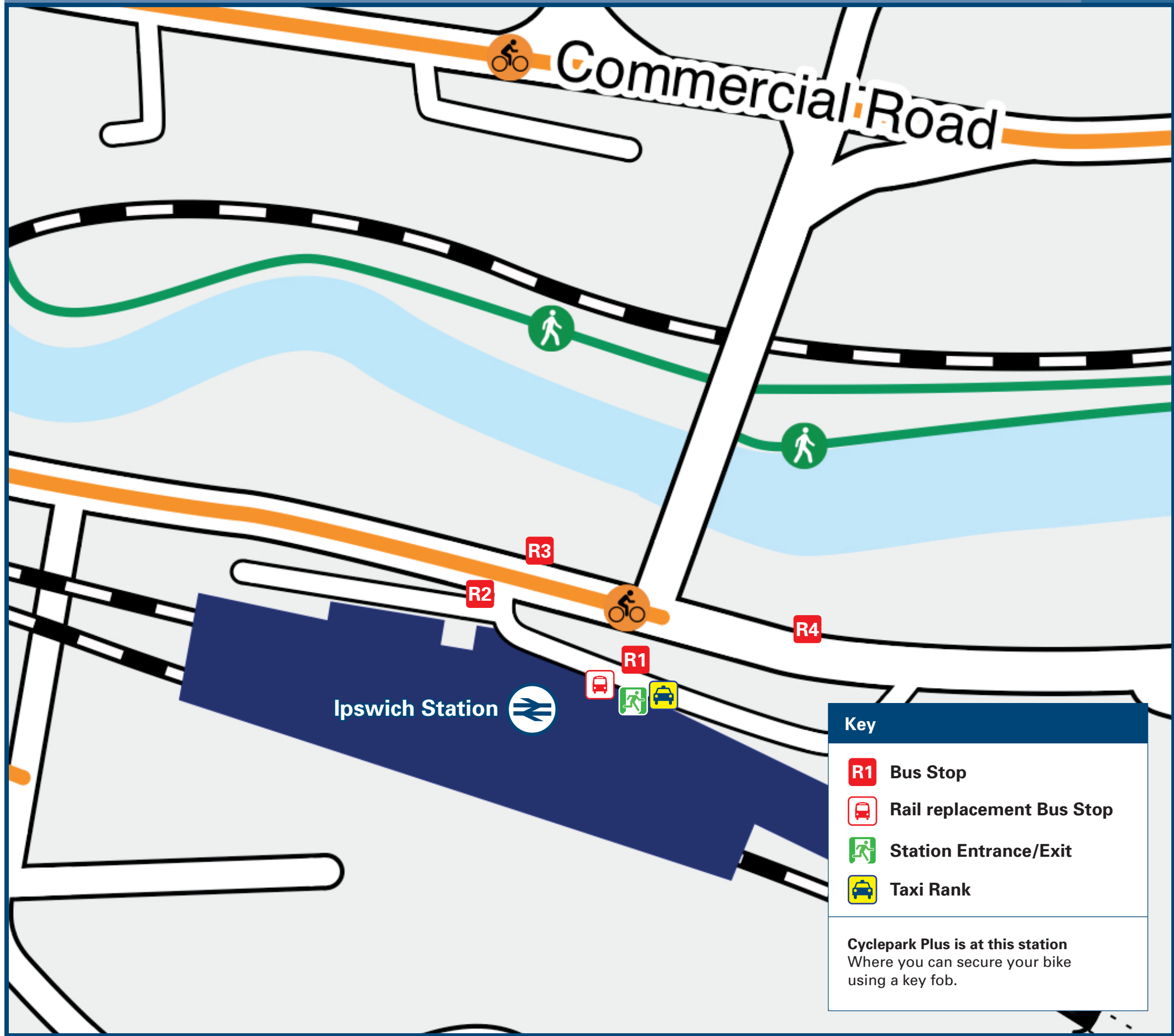

# Ipswich Station

## Onward Travel Information

### Buses and Taxis



Rail Replacement transport stops at the bus stop on Station forecourt.

### Local area map

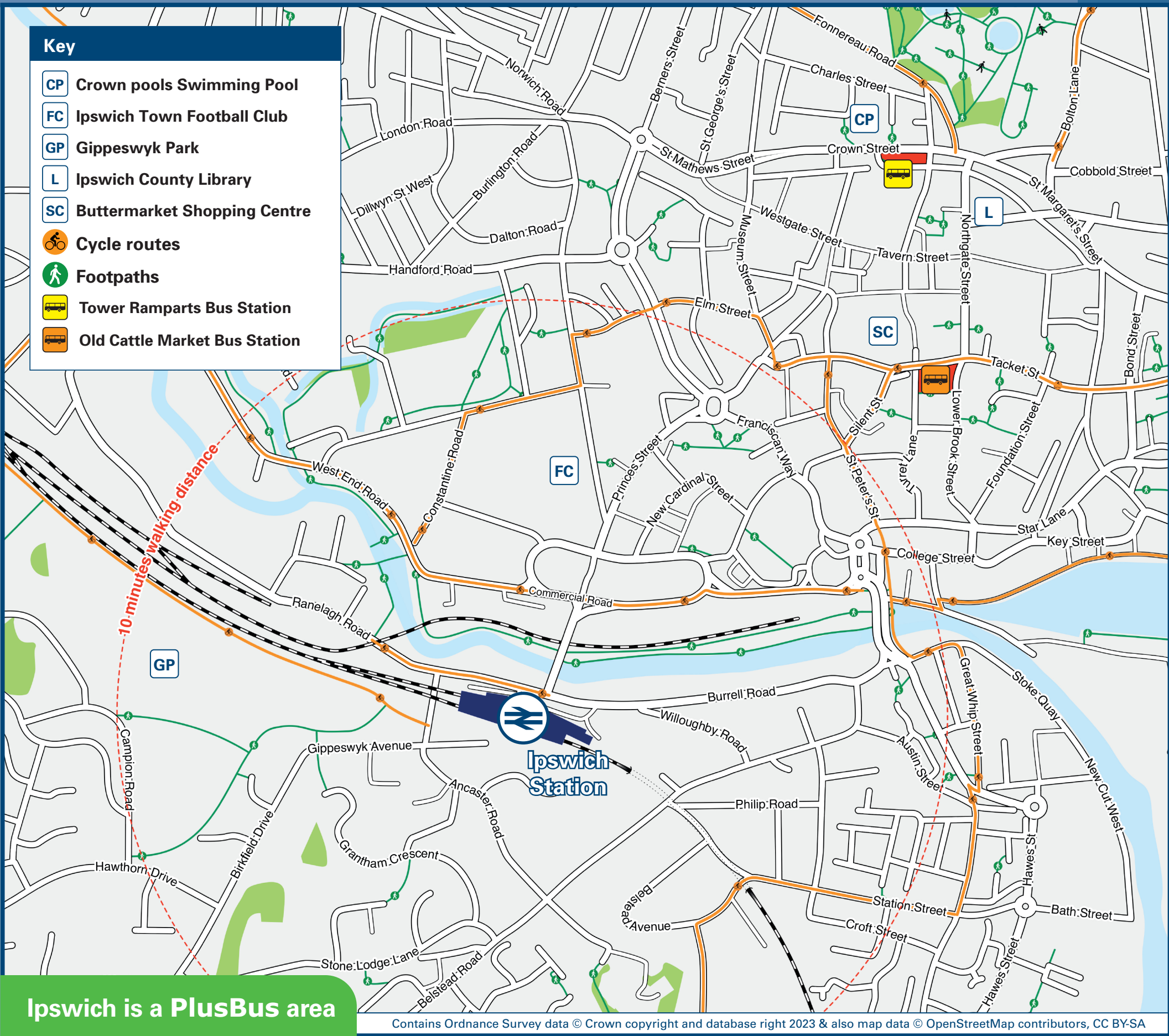

**PlusBus** is a discount price 'bus pass' that you buy with your train ticket. It gives you unlimited bus travel around your chosen town, on participating buses. Visit [www.plusbus.info](http://www.plusbus.info)

### Main destinations by bus

(Data correct at August 2023)



DESTINATION	BUS ROUTES	BUS STOP
● Belstead Road	16	R 4
● Bourne Bridge	92#, 97	R 4
● Brantham	92#	R 4
● Brookwood (Belmont Road)	13	R 2
	15	R 4
● Cambridge Drive	12	R 2
● Capel St Mary	93#	R 2
● Chantry	12, 13, 14#	R 2
	15	R 4
● Chantry Park	13, 91#, 93#	R 2
	15	R 4
● Chelmondiston	97	R 4
● Copdock	13, 93#	R 2
● East Bergholt	93#	R 2
● Freston	92, 97	R 4

DESTINATION	BUS ROUTES	BUS STOP
● Gippeswyk Park	14#, 91#, 93#	R 2
	15	R 4
● Grange Farm	66, 66A	R 1
● Hadleigh Road Industrial Estate	91#	R 2
● Halifax (Primary School - Montgomery Road)	16	R 4
● Hintlesham	91#	R 2
● Holbrook	92#	R 4
● Ipswich Hospital	66, 66A	R 1
● Ipswich Racecourse	3*	R 1
● Ipswich Town Centre	15A, 16, 66, 66A, 92#, 97, 12, 13, 14#, 91#, 93#	R 1 R 3
● Kesgrave	66, 66A	R 1
● Maidenhall	15, 16	R 4
● Martlesham Heath	66, 66A	R 1
● Pinebrook	13	R 2

DESTINATION	BUS ROUTES	BUS STOP
● Pinewood	15	R 4
● Priory Heath	3*	R 1
● Rushmere	66, 66A	R 1
● Shotley/Shotley Gate	97	R 4
● Stoke Park	15, 16	R 4
● Stutton	92	R 4
● Washbrook	93#	R 2
● Woolverstone	97	R 4

#### Notes

- **PlusBus** destination, please see below for details.
- PlusBus** tickets are valid within the **PlusBus** zone on First Buses and Ipswich Buses but not valid on service 800 Park & Ride
- Bus services to all parts of Ipswich and beyond operate from the Tower Ramparts Bus Station and the Old Cattle Market Bus Station
- \* Bus route 3 runs morning services on Mondays to Fridays from Ipswich Railway Station, only.
- # Bus route 14, 91, 92 and 93 run limited Mondays to Saturdays services, only. No Sunday services.
- Direct trains operate to this destination from this station.

### Taxis

Ipswich is a major station where taxis are usually available on a rank. Advance booking is not normally necessary, unless arriving early in the morning or late at night. Operators who may accept bookings include: (Inclusion of this number doesn't represent any endorsement of the taxi firm)

**Unity Travel**  
01473 715 000

**Hawk Express Cabs**  
01473 222 222

**Ipswich Cabs 289**  
01473 289 289

### Further information about all onward travel

Local Cycle Info	National Cycle Info	Bus Times	NextBuses	PlusBus
<a href="http://www.suffolkonboard.com/cycle">www.suffolkonboard.com/cycle</a> For more information about cycle routes.	<a href="http://sustrans.org.uk">sustrans.org.uk</a> Sustrans is the UK's leading sustainable transport charity.	See timetable displays at bus stops.  <a href="http://www.traveline.info">www.traveline.info</a> 0871 200 22 33 calls cost 12p per minute	 <b>Find the bus times for your stop.</b> Search for a bus stop by entering a postcode, street & town or a stop name & town.	 <b>plusbus.info</b> A discount price 'bus pass' that you buy with your train ticket. It gives you unlimited bus travel around your chosen town, on participating buses.

### National Rail Enquiries

Online	NRE App	Social Media	Alert Me	Contact Centre	PlusBike
<a href="http://nationalrail.co.uk">nationalrail.co.uk</a>	<b>Free National Rail Enquiries app for iOS and Android</b>	<a href="https://facebook.com/nationalrailenq">facebook.com/nationalrailenq</a> @nationalrailenq	You can sign up to Alert Me messages on the National Rail Enquiries website where you can receive train and platform notifications directly to your smart phone. <a href="http://nationalrail.co.uk/alertme">nationalrail.co.uk/alertme</a>	<b>03457 48 49 50</b> Calls cost no more than calls to geographic numbers (01 or 02) and may be recorded.	<a href="http://nationalrail.co.uk/plusbike">nationalrail.co.uk/plusbike</a> For more information.

greateranglia



**National Rail**  
Britain's train companies working together

