

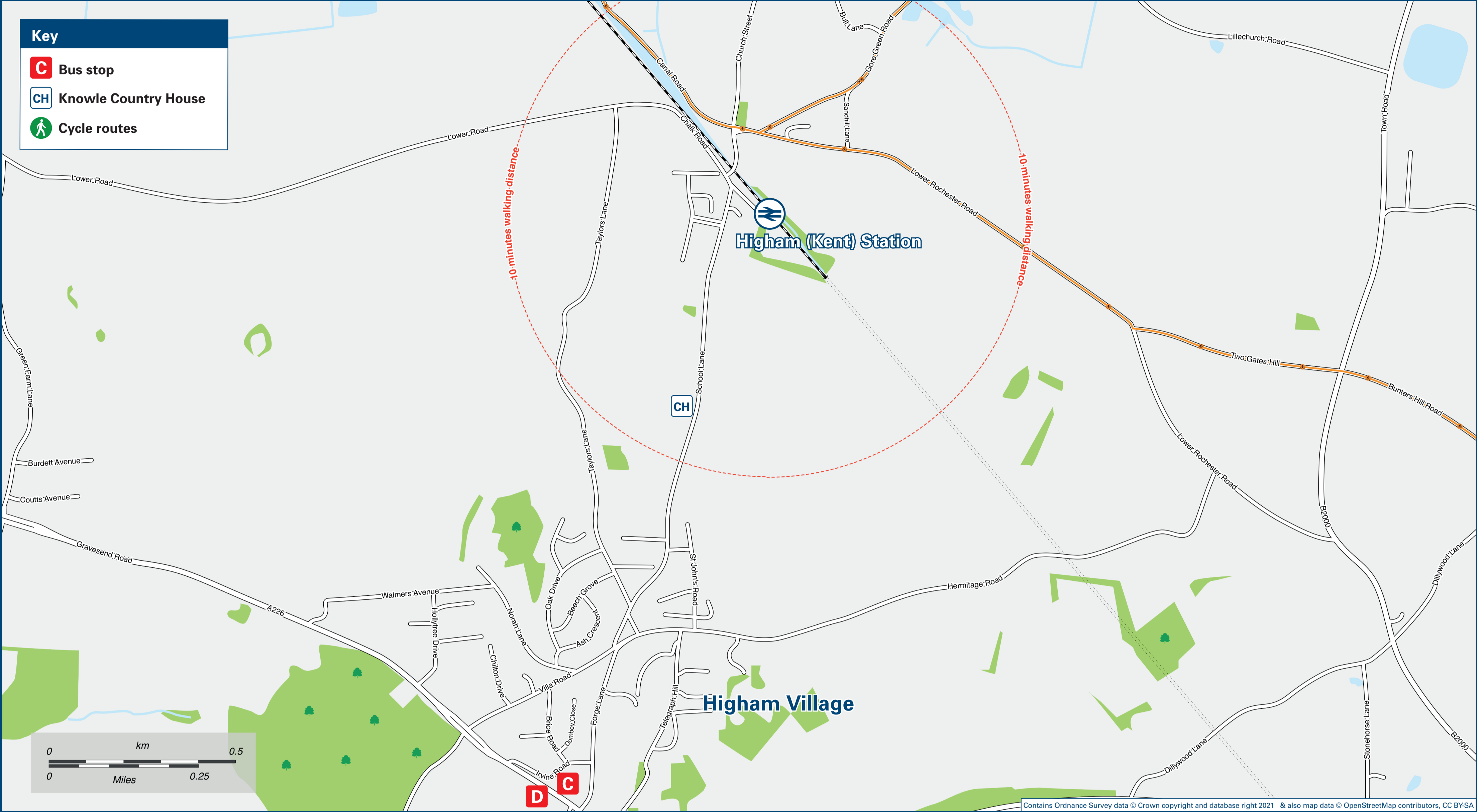

Higham Station

Onward Travel Information

Local area map



Buses

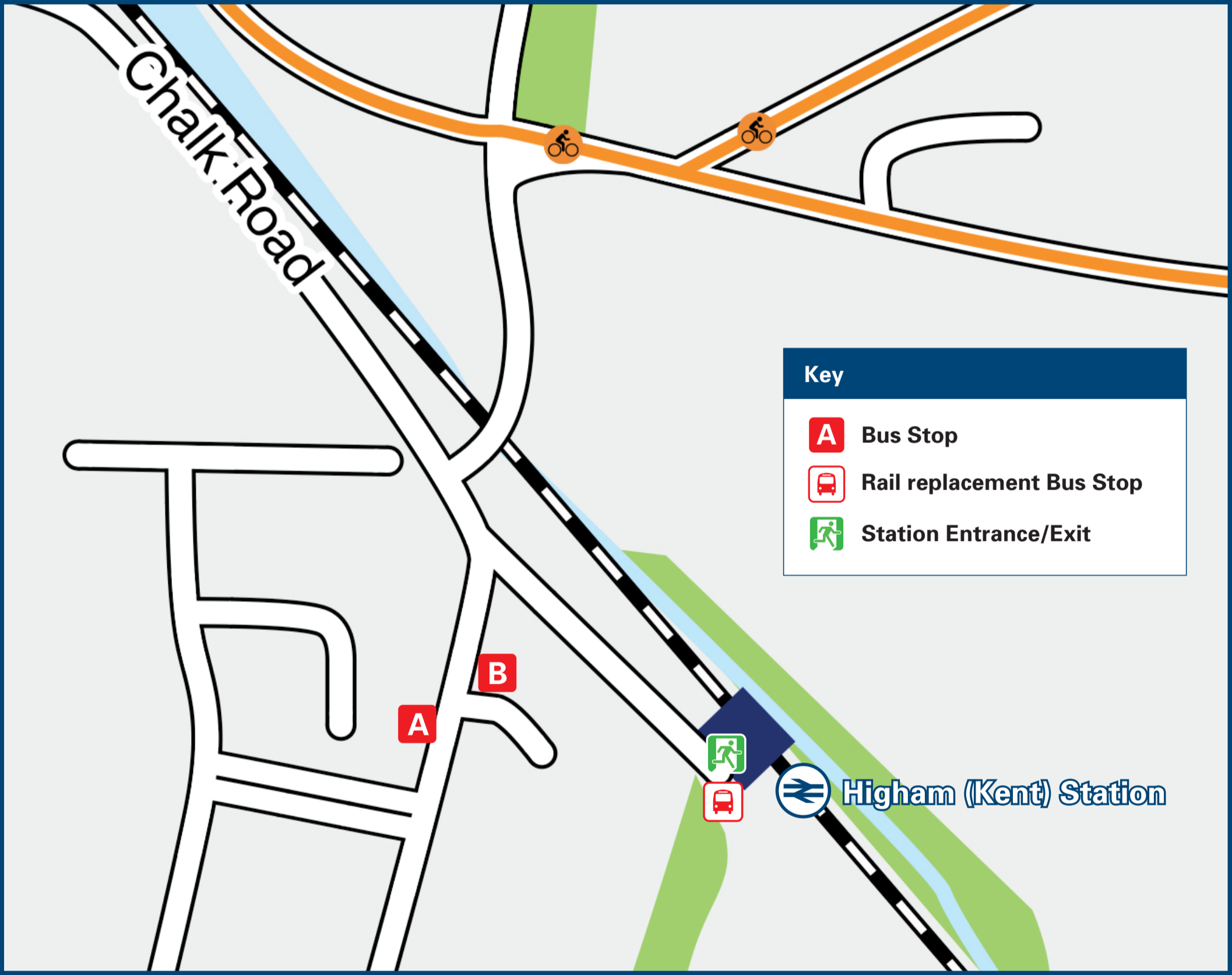

Rail replacement buses depart from outside the station.

Main destinations by bus

(Data correct at August 2023)

DESTINATION	BUS ROUTES	BUS STOP
Chalk (Thong Lane)	417	B
Chalk (Vicarage Lane)	190	D+
Chatham (Railway Station) ⚙	190	C+
Chatham (Waterfront Bus Station)	190	C+
Cliffe (The Six Bells, for RSPB Cliffe Pools)	417	A
Cliffe Woods (Primary School)	417	A
Denton (St John's School)	417	B
	190	D+
Gravesend (Railway Station) ⚙	417	B
	190	D+
Higham Village (Forge Lane)	25 to 30 minutes walk from this station	
	417	B
Rochester (Railway Station) ⚙	190	C+
Shorne (Crossroads)	417	B
	190	D+
Shorne Woods Country Park	417	B
Strood (Canal Road) ⚙	190	C+

Notes

Bus route 190 operates daily.
Bus route 417 operates a limited service on Mondays to Saturdays only. No Sunday or Bank Holiday service.
For bus times and other bus service enquiries, please contact Traveline on 0871 200 22 33 or contact the bus operator (see below):
Redroute Buses (for bus route 417) www.redroutebuses.com or call 0800 2346 842, or Arriva Kent & Surrey (for bus route 190) www.arrivabus.co.uk/help/contact-us or call 0344 800 44 11.
+ Bus stops A and D+ are in Higham Village on the Gravesend Road near to Forge Lane, which is a 30 minutes walk from this station.
⚙ Direct trains operate to this destination from this Station.

Taxis

Higham (Kent) Station has no taxi or cab office. Advance booking is essential, please consider using the following operators: (Inclusion of this number doesn't represent any endorsement of the taxi firm)

Strood Cabs
01634 710 001

Ace Taxis
01634 720 500

Knights Travel Medway
01634 321 505

Further information about all onward travel

Local Cycle Info gravesham.gov.uk For more information about cycle routes.	National Cycle Info sustrans.org.uk Sustrans is the UK's leading sustainable transport charity.	Bus Times See timetable displays at bus stops. www.traveline.info 0871 200 22 33 calls cost 15p per minute plus your phone company's access charge	NextBuses Find the bus times for your stop. Search for a bus stop by entering a postcode, street & town or a stop name & town.	PlusBus plusbus.info A discount price 'bus pass' that you buy with your train ticket. It gives you unlimited bus travel around your chosen town, on participating buses.
---	---	---	--	--

National Rail Enquiries

Online nationalrail.co.uk	NRE App Free National Rail Enquiries app for iOS and Android	Social Media facebook.com/nationalrailenq @nationalrailenq	Alert Me You can sign up to Alert Me messages on the National Rail Enquiries website where you can receive train and platform notifications directly to your smart phone. nationalrail.co.uk/alertme	Contact Centre 03457 48 49 50 Calls cost no more than calls to geographic numbers (01 or 02) and may be recorded.	PlusBike nationalrail.co.uk/plusbike For more information.
---	--	--	---	---	--

southeastern



National Rail
Britain's train companies working together

