

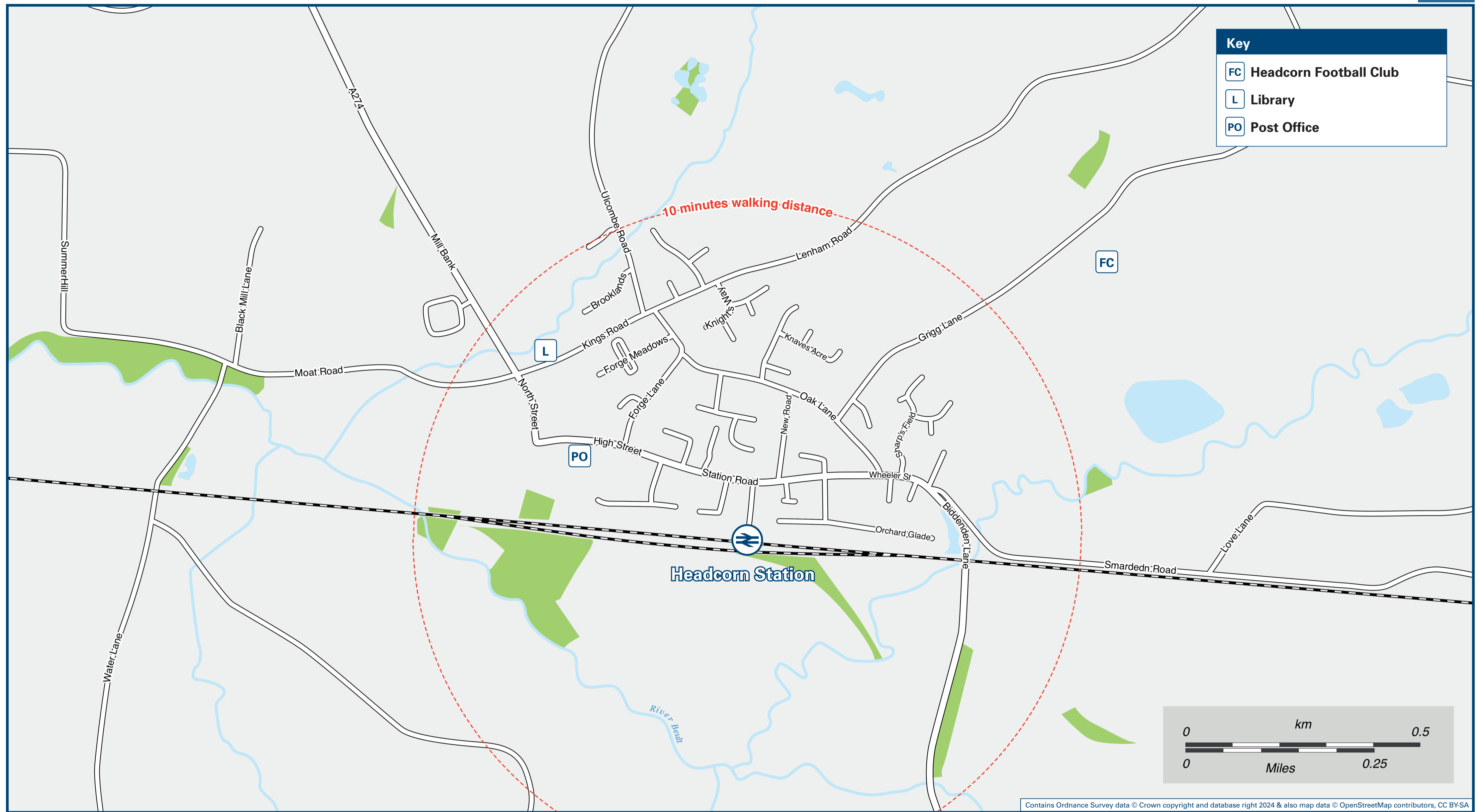

Headcorn Station

Onward Travel Information

Local area map



Buses and Taxis

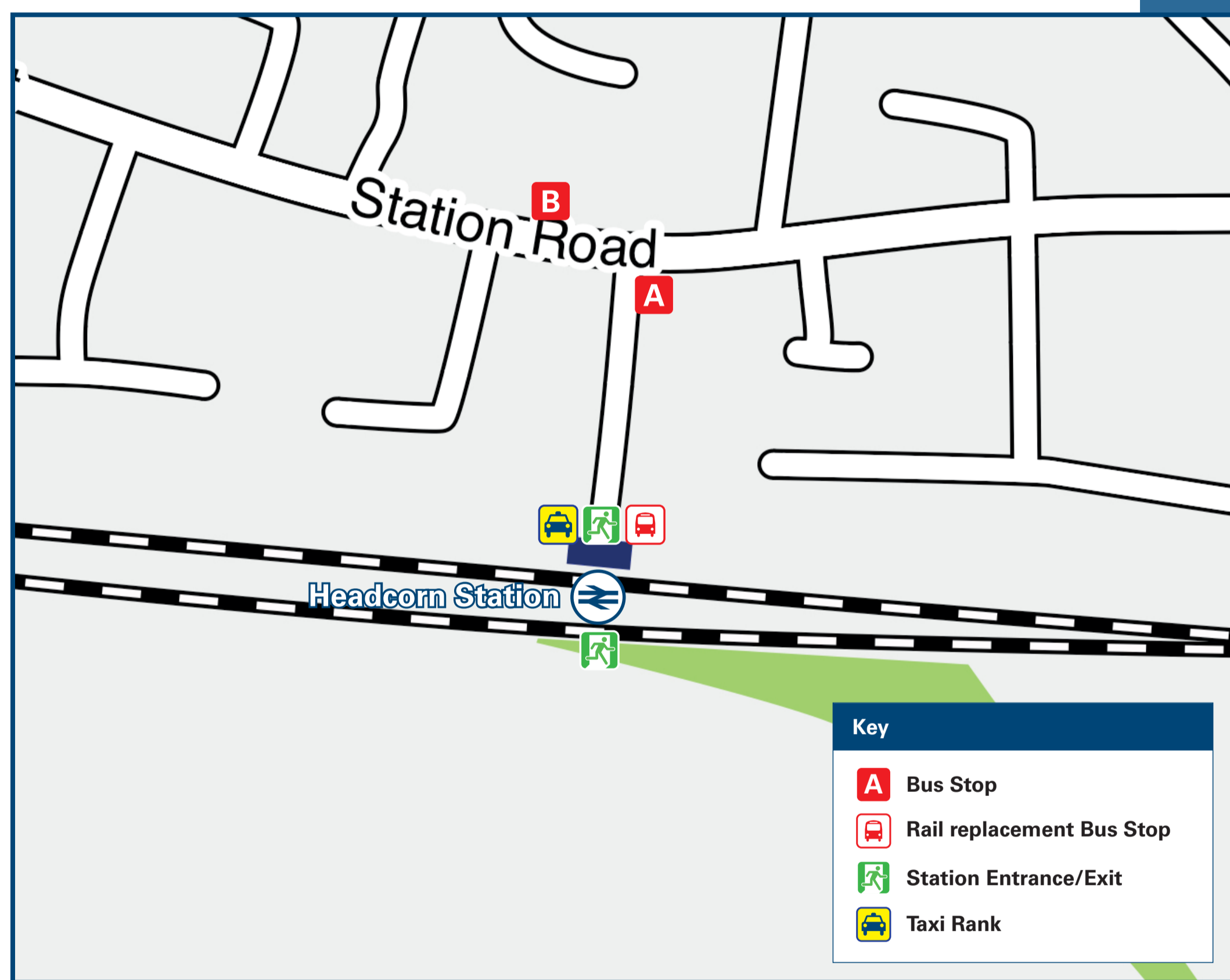

Rail replacement buses depart from the Station forecourt (Ashford side of station).

Main destinations by bus

(Data correct at July 2024)

DESTINATION	BUS ROUTES	BUS STOP
Biddenden (The Weavers)	12	B*
Gladdish	12	A*
Langley (The Plough Inn)	12	A*
Maidstone (Town Centre, Royal Star Arcade)	12	A*
Park Wood (Car Showrooms, Sutton Road)	12	A*
Shepway (Sutton Road Cemetery)	12	A*
Shepway (Sutton Road Morrisons)	12	A*
St Michaels (The Crown)	12	B*
Sutton Valence (The Kings Head)	12	A*
Tenterden (The Vine)	12	B*
Warmlake Corner	12	A*

Notes

Bus route 12 operates daily, Mondays to Sundays, including Bank Holidays. For bus times and further information contact Traveline call 0871 200 22 33 or Arriva Kent & Surrey (for bus route 12) call 0344 800 44 11.
* Please note some buses call at the station forecourt, contact Traveline for times. All buses call at stop (A) towards Maidstone or stop (B) towards Tenterden.

Taxis

Headcorn Station is served by a taxi rank or cab office. Check availability before travelling, and pre-book if necessary. Please consider using the following local operators: (Inclusion of this number doesn't represent any endorsement of the taxi firm)

MTC Taxis
01622 890 003

Streamline Kent
01622 750 000

Further information about all onward travel

Local Cycle Info maidstone.gov.uk For more information about cycle routes.	National Cycle Info sustrans.org.uk Sustrans is the UK's leading sustainable transport charity.	Bus Times See timetable displays at bus stops. www.traveline.info 0871 200 22 33 call cost 13p per minute plus your phone company's access charge	NextBuses Find the bus times for your stop. Search for a bus stop by entering a postcode, street & town or a stop name & town.	PlusBus plusbus.info A discount price 'bus pass' that you buy with your train ticket. It gives you unlimited bus travel around your chosen town, on participating buses.
---	--	--	--	--

National Rail Enquiries

Online nationalrail.co.uk	NRE App Free National Rail Enquiries app for iOS and Android	Social Media facebook.com/nationalrailenq @nationalrailenq	Alert Me You can sign up to Alert Me messages on the National Rail Enquiries website where you can receive train and platform notifications directly to your smart phone. nationalrail.co.uk/alertme	Contact Centre 03457 48 49 50 Calls cost no more than calls to geographic numbers (01 or 02) and may be recorded.	PlusBike nationalrail.co.uk/plusbike For more information.
-------------------------------------	--	---	---	--	---



National Rail
Britain's train companies working together



This poster shows details of popular destinations and main, frequent bus routes. Additional services may run, so please check with Traveline or see posters at local bus stops. Whilst considerable care has been taken to ensure the information contained on this poster is correct and accurate, National Rail cannot accept responsibility for any loss or inconvenience caused by any errors or omissions, or for loss, damage, injury or inconvenience relating to the cancellation, alteration, delay or diversion of a service. For any feedback, please e-mail comments@onwardtravelposters.com

Scan this code with your mobile for full station information.