

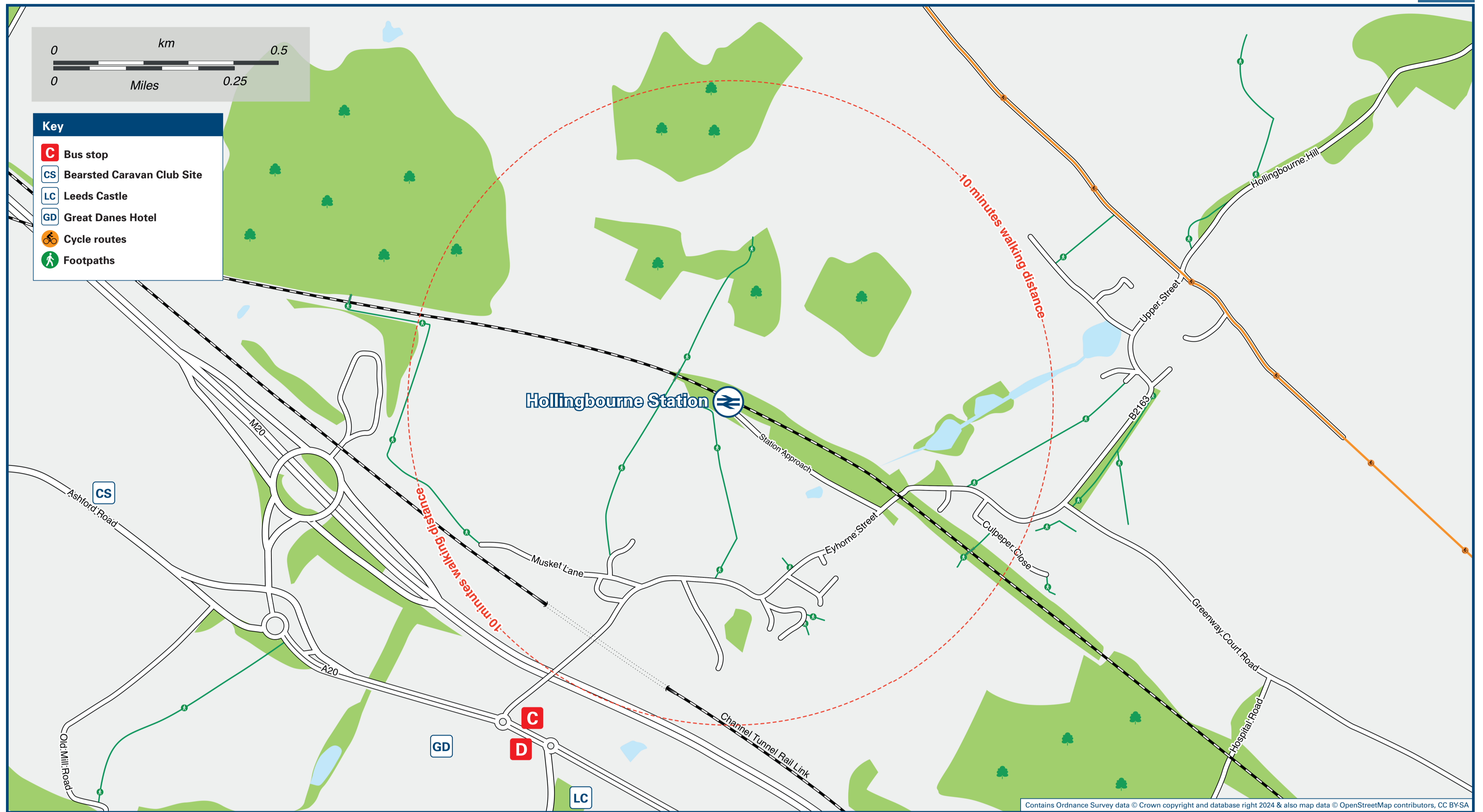

Hollingbourne Station

Onward Travel Information

Local area map



Buses

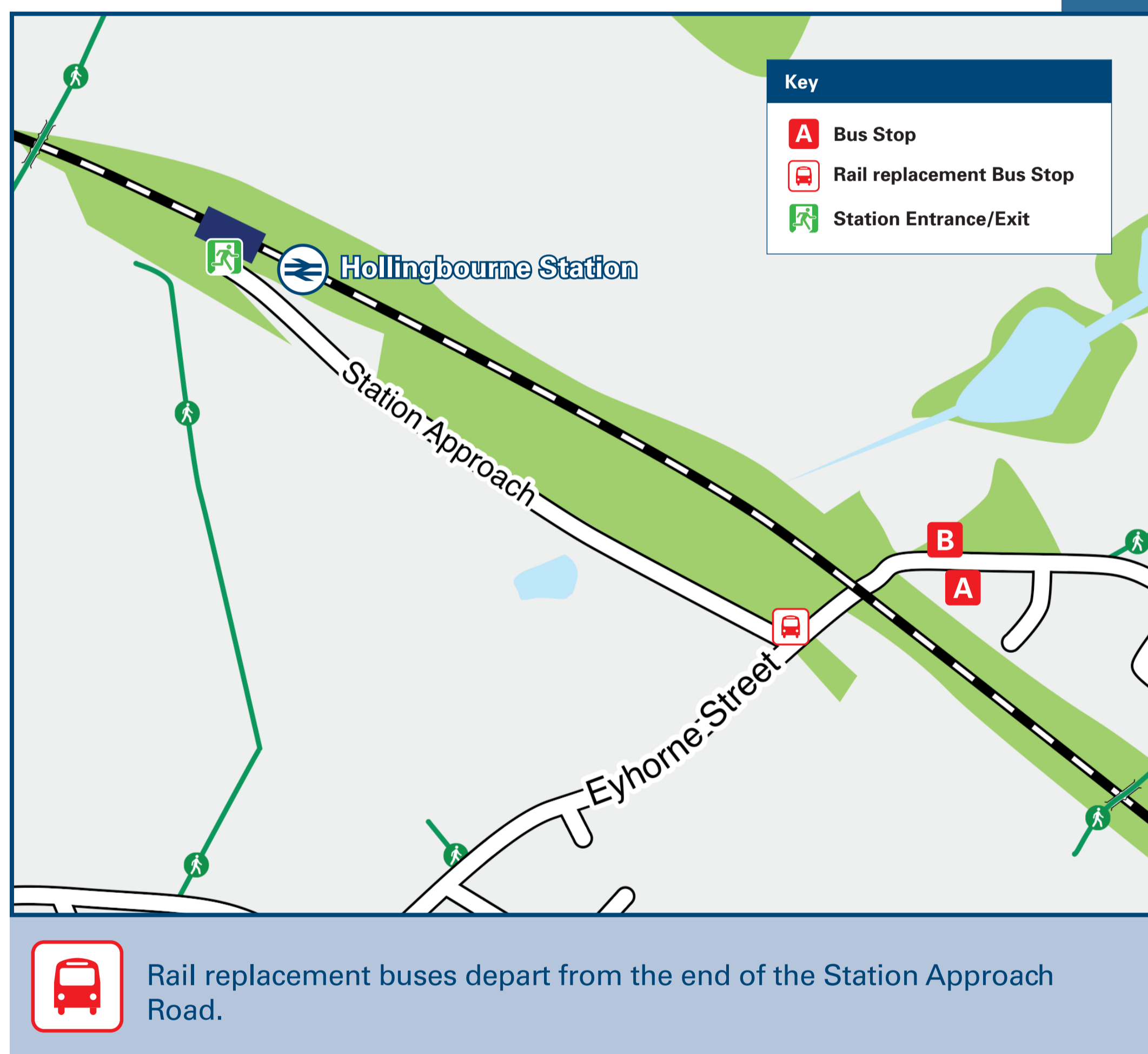

Main destinations by bus

(Data correct at July 2024)

DESTINATION	BUS ROUTES	BUS STOP
Ashford (Town Centre & Station)	10X	C
Bearsted (The Yeoman)	10X	D
Boughton Monchelsea	14	A
Charing (Primary School)	10X	C
Charing Heath (Church)	10X*	C
Chart Sutton	14	A
Harrietsham (The Roebuck Hotel)	10X	C
Hothfield (The Woolpack)	10X	C
Langley (The Potting Shed)	13, 14	A
Langley Heath (Skinner's Way)	13, 14	A
Leeds Castle (Entrance)	13, 14	A
Leeds Village (Burgess Hall Drive)	13, 14	A
Lenham (The Square)	10X	C
Maidstone Town Centre (Royal Star Acade)	10X	D
Otham Village (The White Horse)	13	A
Park Wood	13, 14	A
Shepway (Morrisons)	13, 14	A

Notes

Bus route 10X operates Mondays to Saturdays.
 Bus routes 13 and 14 operate a limited service Mondays to Fridays only.
 For bus times and further information contact Nu-Venture Coaches (for bus routes 13 & 14) www.nu-venture.online/contact or call 01622 882 288 or Stagecoach South East (for bus route 10X) www.stagecoachbus.com/help-and-contact or call 0345 241 8000 or contact Traveline on 0871 200 22 33.

☺ Direct trains operate to this destination from this station.
 * Bus route 10X operates a limited service to Charing Heath village.
 AONB Kent Downs (AONB) www.kentdowns.org.uk

Taxis

Hollingbourne Station has no taxi rank or cab office. Advance booking is essential, please consider using the following local operators: (Inclusion of this number doesn't represent any endorsement of the taxi firm)

Maidstone Taxis
01622 765 555

Sapphire Cars
01622 234 001

United Cars
01622 321 321

Further information about all onward travel

Local Cycle Info maidstone.gov.uk <small>For more information about cycle routes.</small>	National Cycle Info sustrans.org.uk <small>Sustrans is the UK's leading sustainable transport charity.</small>	Bus Times <small>See timetable displays at bus stops.</small> www.traveline.info 0871 200 22 33 <small>calls cost 13p per minute plus your phone company's access charge</small>	NextBuses Find the bus times for your stop. <small>Search for a bus stop by entering a postcode, street & town or a stop name & town.</small>	PlusBus plusbus.info <small>A discount price 'bus pass' that you buy with your train ticket. It gives you unlimited bus travel around your chosen town, on participating buses.</small>
--	--	--	---	---

National Rail Enquiries

Online nationalrail.co.uk	NRE App Free National Rail Enquiries app for iOS and Android	Social Media facebook.com/nationalrailenq @nationalrailenq	Alert Me <small>You can sign up to Alert Me messages on the National Rail Enquiries website where you can receive train and platform notifications directly to your smart phone.</small> nationalrail.co.uk/alertme	Contact Centre 03457 48 49 50 <small>Calls cost no more than calls to geographic numbers (01 or 02) and may be recorded.</small>	PlusBike nationalrail.co.uk/plusbike <small>For more information.</small>
---	---	--	--	--	---



National Rail
Britain's train companies working together

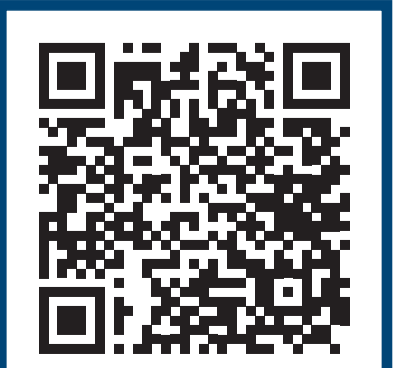

This poster shows details of popular destinations and main, frequent bus routes. Additional services may run, so please check with Traveline or see posters at local bus stops. Whilst considerable care has been taken to ensure the information contained on this poster is correct and accurate, National Rail cannot accept responsibility for any loss or inconvenience caused by any errors or omissions, or for loss, damage, injury or inconvenience relating to the cancellation, alteration, delay or diversion of a service. For any feedback, please e-mail comments@onwardtravelposters.com

Scan this code with your mobile for full station information.