

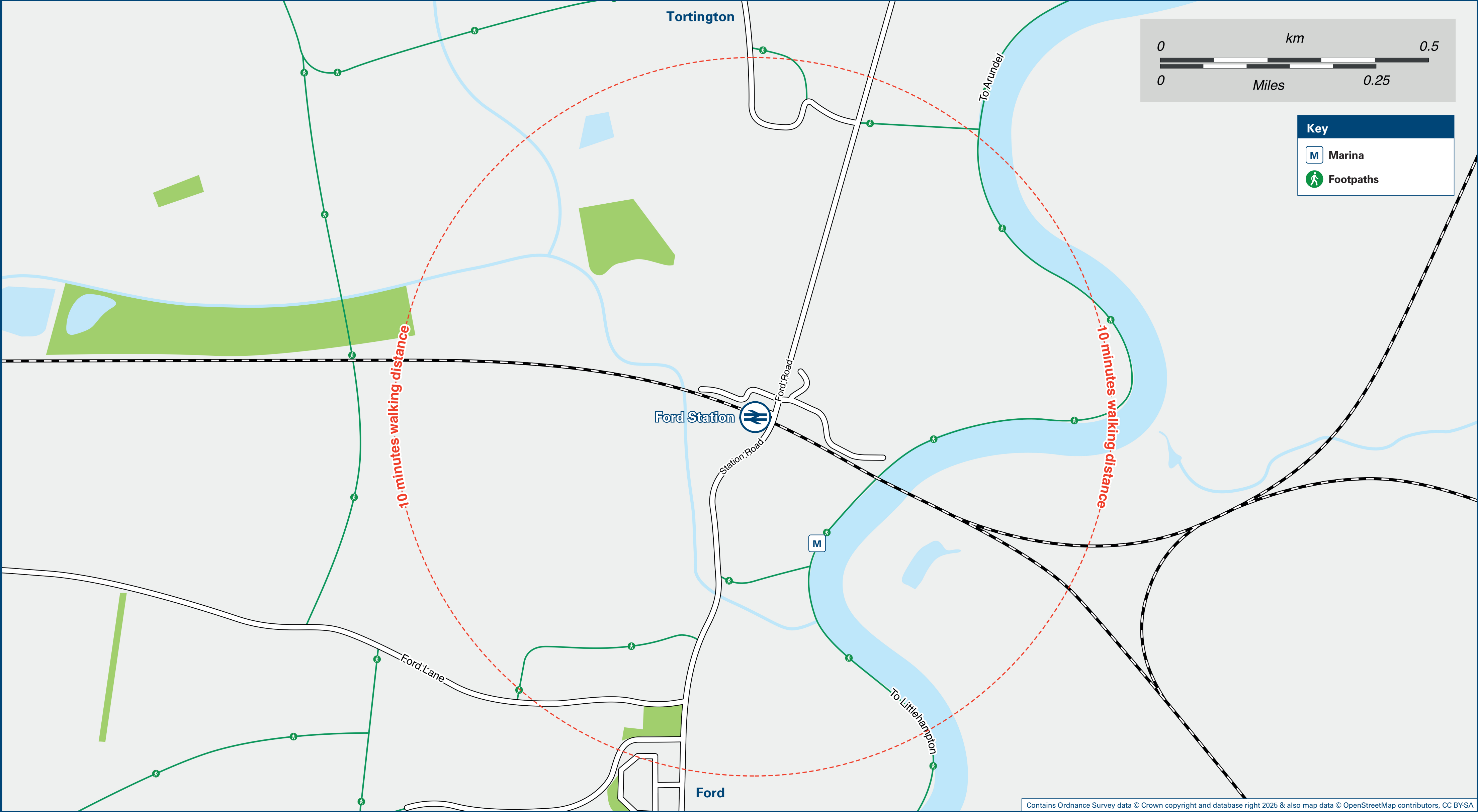

Ford Station

Onward Travel Information

Local area map



Buses

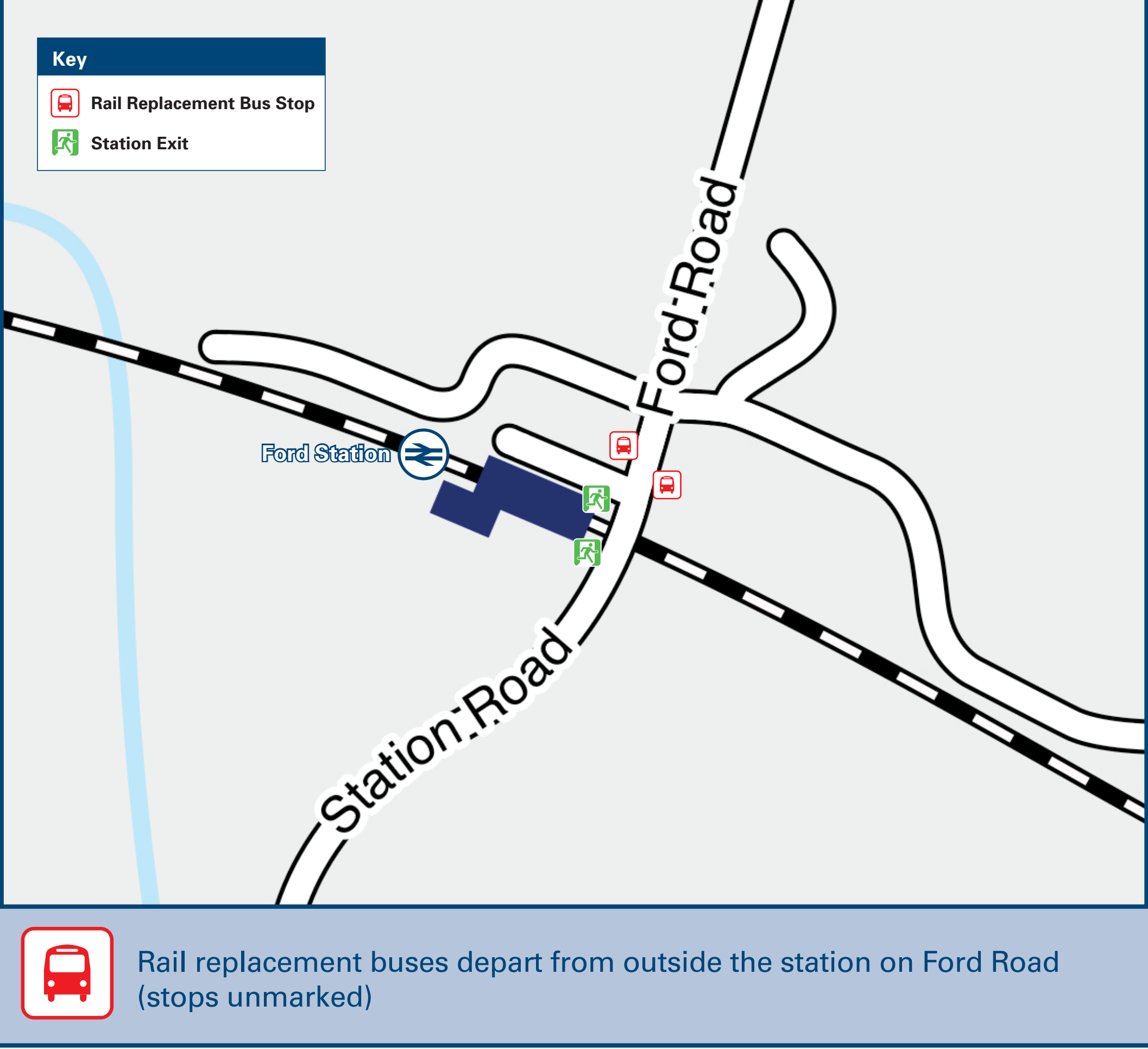

Information

(Data correct at July 2025)

THERE ARE NO REGULAR BUS SERVICES SERVING FORD RAILWAY STATION.

The “Book-a-Bus 97 Flex” is a flexible on-demand bus service which can be booked for journeys in Barnham and its surrounding areas (including Slindon, Fontwell, Walberton, Aldingbourne, Oving, Shripney, Yapton, Torrington), subject to availability. To book a journey, download the “Book-a-Bus Barnham” app or call 01243 858854. For further information visit www.westsussex.gov.uk/BookABusBarnham

For bus times and days of operation please contact Traveline on www.traveline.info or call: 0871 200 22 33

Ford Station has no taxi rank or cab office. Advance booking is essential, please consider using the following local operators: (Inclusion of this number doesn’t represent any endorsement of the taxi firm)

Barnham Station Taxis
01243 551 753

Castle Cars
01903 884 444

Apollo Taxis
01903 723 030

Further information about all onward travel

Local Cycle Info	National Cycle Info	Bus Times	NextBuses	PlusBus
arun.gov.uk For more information about cycle routes.	sustrans.org.uk Sustrans is the UK's leading sustainable transport charity.	See timetable displays at bus stops. www.traveline.info 0871 200 22 33 calls cost 15p per minute plus your phone company's access charge	Find the bus times for your stop. Search for a bus stop by entering a postcode, street & town or a stop name & town.	plusbus.info A discount price 'bus pass' that you buy with your train ticket. It gives you unlimited bus travel around your chosen town, on participating buses.

National Rail Enquiries

Online	NRE App	Social Media	Alert Me	Contact Centre	PlusBike
nationalrail.co.uk	Free National Rail Enquiries app for iOS and Android	facebook.com/nationalrailenq @nationalrailenq	You can sign up to Alert Me messages on the National Rail Enquiries website where you can receive train and platform notifications directly to your smart phone. nationalrail.co.uk/alertme	03457 48 49 50 Calls cost no more than calls to geographic numbers (01 or 02) and may be recorded.	nationalrail.co.uk/plusbike For more information.



National Rail
Britain's train companies working together



Whilst considerable care has been taken to ensure the information contained on this poster is correct and accurate, National Rail cannot accept responsibility for any loss or inconvenience caused by any errors or omissions, or for loss, damage, injury or inconvenience caused. For any feedback, please e-mail comments@onwardtravelposters.com

Scan this code with your mobile for full station information.