

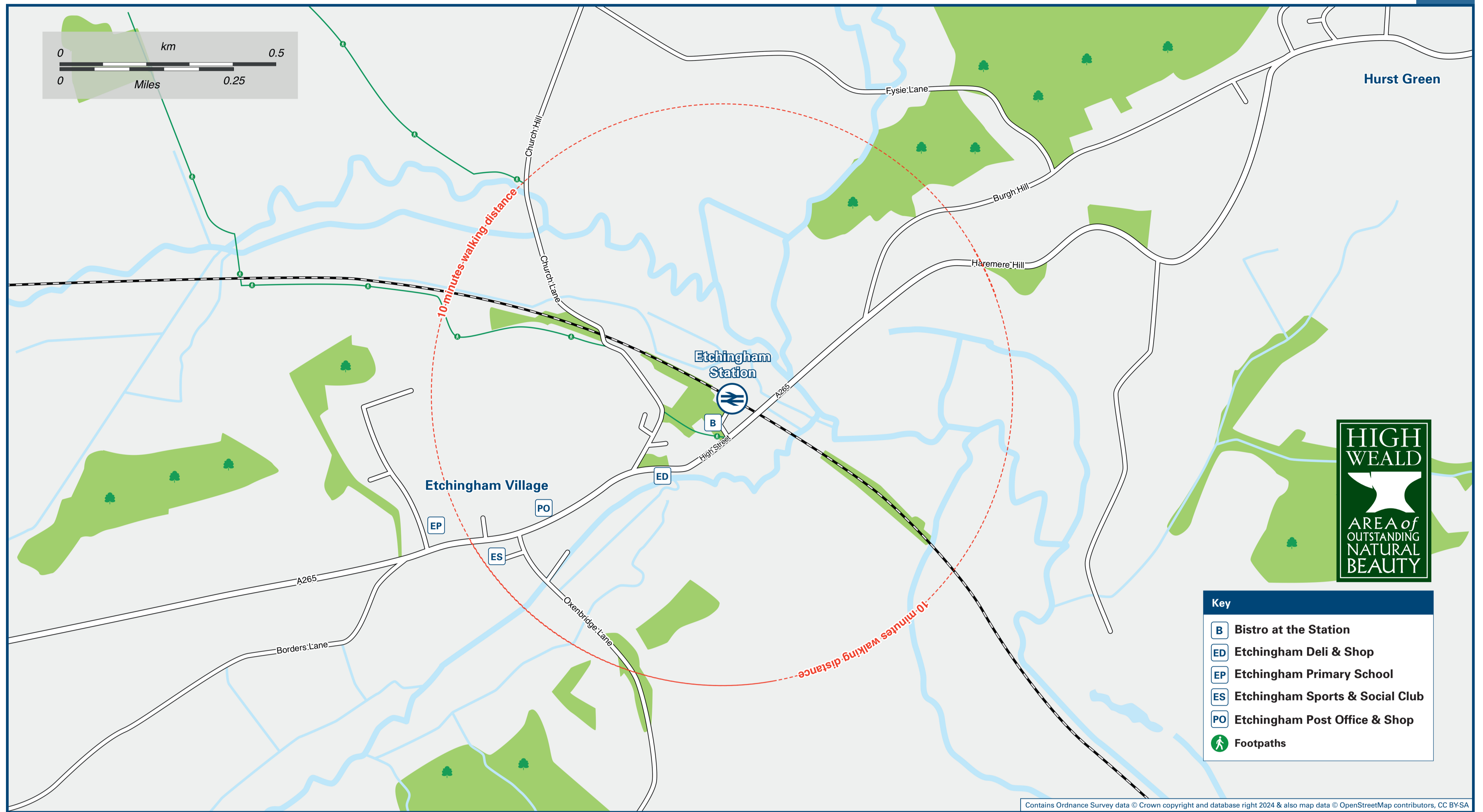

# Etchingham Station

# Onward Travel Information

## Local area map



## Buses

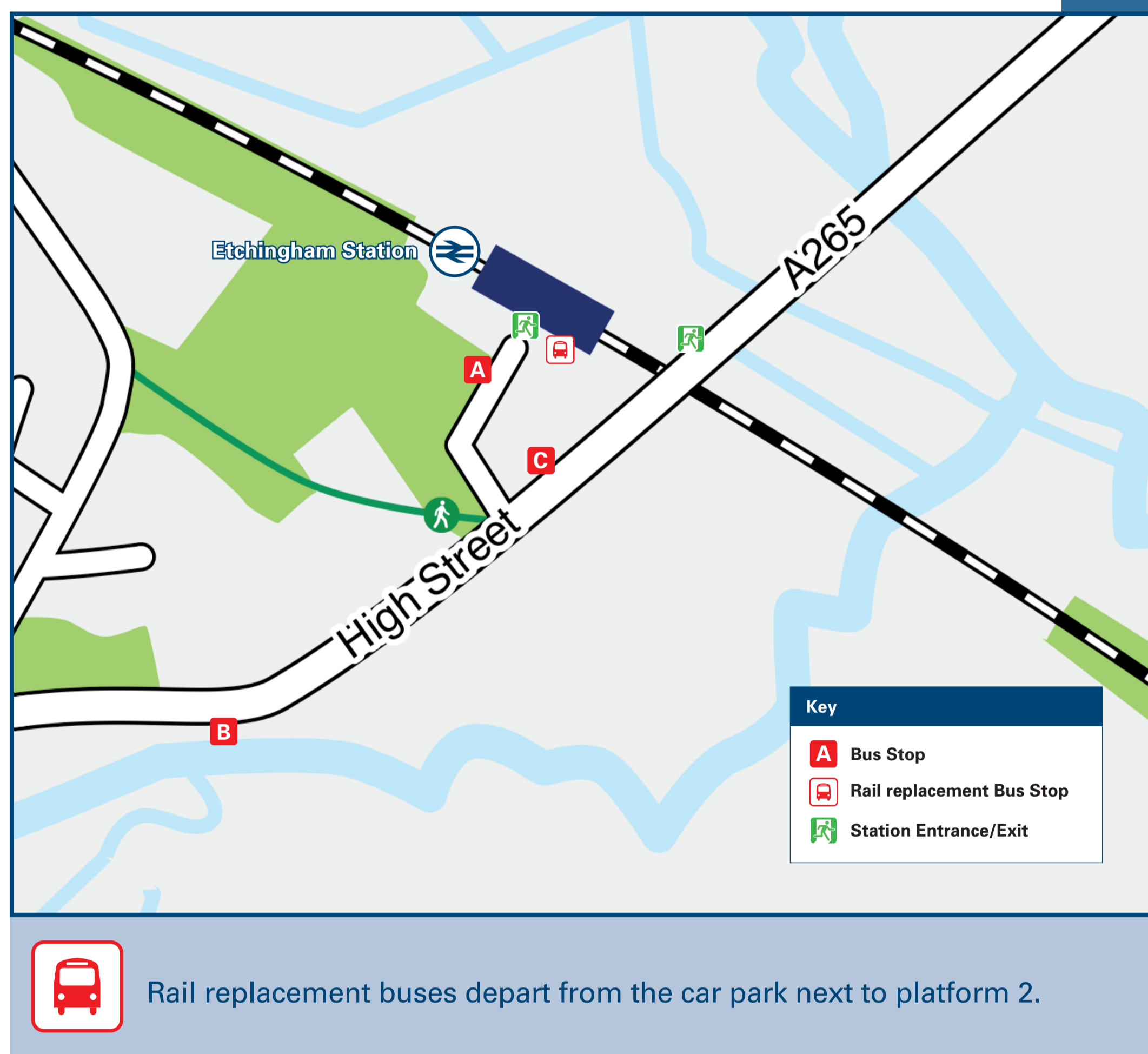

## Main destinations by bus

(Data correct at July 2024)

| DESTINATION                          | BUS ROUTES | BUS STOP |
|--------------------------------------|------------|----------|
| Blackboys                            | 231*       | B, C     |
| Broad Oak                            | 231        | B, C     |
| Burwash (Post Office)                | 231        | B, C     |
| Burwash (Strand Meadow)              | 231        | B, C     |
| Burwash Common                       | 231        | B, C     |
| Burwash Weald                        | 231        | B, C     |
| Cross-in-Hand                        | 231*       | B, C     |
| Framfield                            | 231*       | B, C     |
| Heathfield                           | 231        | B, C     |
| Uckfield Hospital                    | 231*       | B, C     |
| Uckfield Town Centre (Bus Station) # | 231*       | B, C     |

**Notes**

Bus route 231 operates a limited service Mondays to Saturdays only. No service on Sundays or Bank Holidays. For bus times and other bus service enquiries, please contact: Compass Travel www.compass-travel.co.uk, or telephone: 01903 690 025

\* To this destination bus route 231 operates a very limited morning service on Mondays to Fridays, only. No service on Saturdays, Sundays or Bank Holidays.

# Change at Uckfield Bus Station for bus routes 28/29/29B to Crowborough, Lewes and Brighton; bus route 31/31A/31B to Haywards Heath & Cuckfield and bus route 261 to East Grinstead.

Change here for connecting National Rail services.  
AONB High Weald (AONB) www.highweald.org

## Taxis

Etchingham Station has no taxi rank or cab office. Advance booking is essential, please consider using the following local operators: (Inclusion of this number doesn't represent any endorsement of the taxi firm)

**Burwash Taxis**  
01435 883 803

**Ivy Cars**  
07754 239 163

**Cleggy's Taxi**  
07790 989 470

## Further information about all onward travel

|   |   |  |                  |   |
|---|---|--|------------------|---|
| <b>Local Cycle Info</b><br><a href="http://rother.gov.uk">rother.gov.uk</a><br>For more information about cycle routes. | <b>National Cycle Info</b><br><a href="http://sustrans.org.uk">sustrans.org.uk</a><br>Sustrans is the UK's leading sustainable transport charity. | <b>Bus Times</b><br>See timetable displays at bus stops.<br><a href="http://www.traveline.info">www.traveline.info</a><br>0871 200 22 33<br><small>calls cost 12p per minute plus your phone company's access charge</small> | <b>NextBuses</b> | <b>PlusBus</b><br><a href="http://plusbus.info">plusbus.info</a><br>A discount price 'bus pass' that you buy with your train ticket. It gives you unlimited bus travel around your chosen town, on participating buses. |
|---|---|--|------------------|---|

## National Rail Enquiries

|   |  |  |   |  |  |
|---|--|--|---|--|--|
| <b>Online</b><br><a href="http://nationalrail.co.uk">nationalrail.co.uk</a> | <b>NRE App</b><br>Free National Rail Enquiries app for iOS and Android | <b>Social Media</b><br><a href="https://www.facebook.com/nationalrailenq">facebook.com/nationalrailenq</a><br><a href="https://twitter.com/nationalrailenq">@nationalrailenq</a> | <b>Alert Me</b><br>You can sign up to Alert Me messages on the National Rail Enquiries website where you can receive train and platform notifications directly to your smart phone.<br><a href="http://nationalrail.co.uk/alertme">nationalrail.co.uk/alertme</a> | <b>Contact Centre</b><br>03457 48 49 50<br>Calls cost no more than calls to geographic numbers (01 or 02) and may be recorded. | <b>PlusBike</b><br><a href="http://nationalrail.co.uk/plusbike">nationalrail.co.uk/plusbike</a><br>For more information. |
|---|--|--|---|--|--|

southeastern



**National Rail**  
Britain's train companies working together



This poster shows details of popular destinations and main, frequent bus routes. Additional services may run, so please check with Traveline or see posters at local bus stops. Whilst considerable care has been taken to ensure the information contained on this poster is correct and accurate, National Rail cannot accept responsibility for any loss or inconvenience caused by any errors or omissions, or for loss, damage, injury or inconvenience relating to the cancellation, alteration, delay or diversion of a service. For any feedback, please e-mail [comments@onwardtravelposters.com](mailto:comments@onwardtravelposters.com)

Scan this code with your mobile for full station information.