



# East Midlands Parkway Station

# Onward Travel Information

## Local area map



## Buses and Taxis

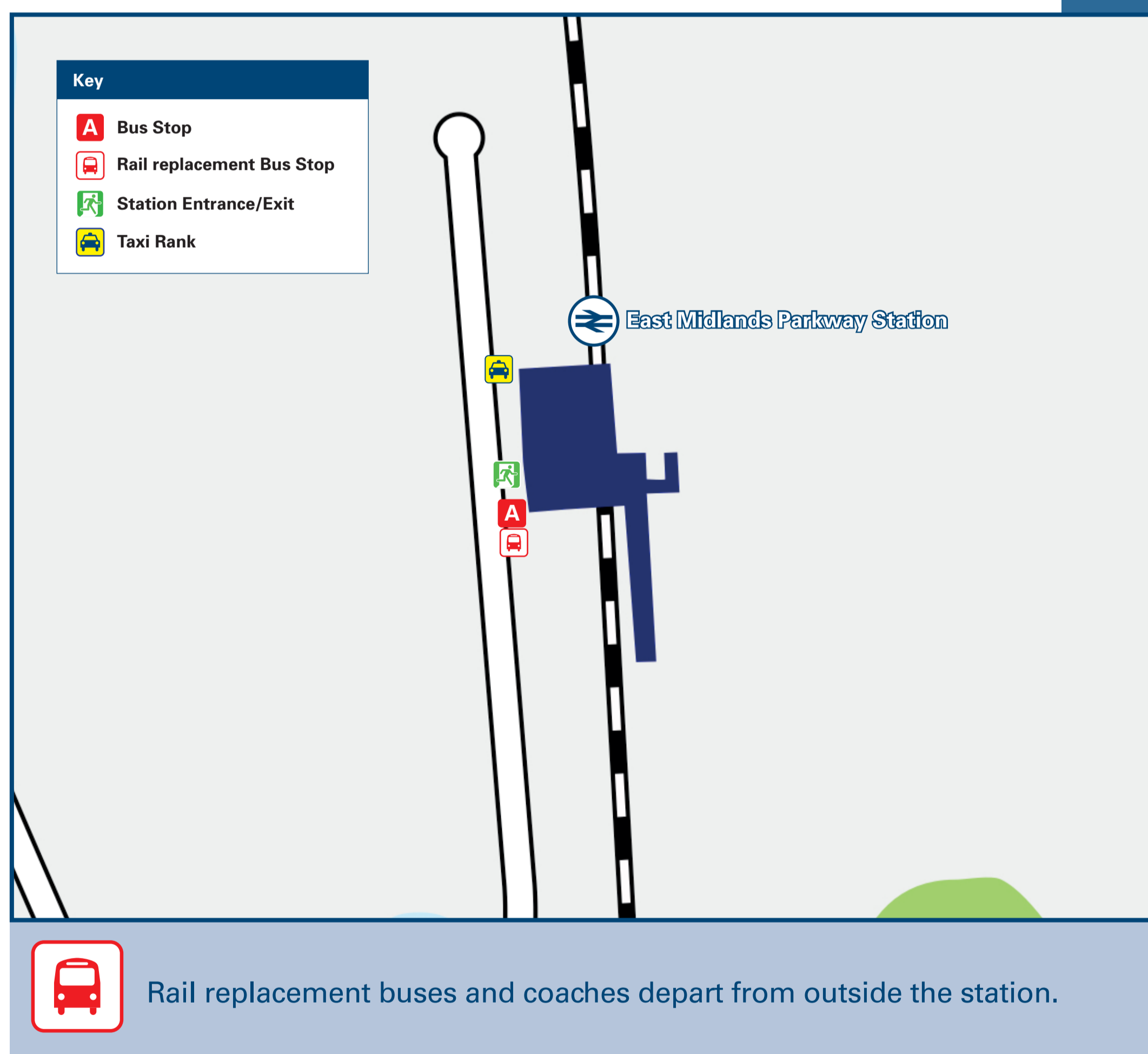

## Information

(Data correct at March 2024)

### Local Bus Information:

**Nottsbus on Demand bus service must be booked in advance from East Midlands Parkway Station, buses depart from stop {A}.**

**Nottsbus On Demand is a bookable bus service that operates daily between 7am and midnight (excluding Bank Holidays) to local villages and towns in the West Rushcliffe Zone including:**

**Barton, Clifton Park & Ride (for trams towards Nottingham city centre), East Leake, East Midlands Airport, East Midlands Gateway, Gotham, Hathern, Kegworth, Kingston on Soar,**

**Normanton on Soar, Ratcliffe on Soar, Stanford on Soar, Sutton Bonington (including the University of Nottingham Sutton Bonington Campus), West Leake and Zouch.**

**To book a journey get the App available to download for free from the Apple or Google Play Stores or by calling: 0115 804 0404 between 8.30am and 5pm Mondays to Thursdays (8:30am and 4.30pm on Fridays).**

**Cycling info [sustrans.org.uk](http://sustrans.org.uk)**

**East Midlands Parkway station is served by a taxi rank or cab office. Check availability before travelling, and pre-book if necessary. If no taxis are on the rank please call: (Inclusion of this number doesn't represent any endorsement of the taxi firm)**

**A J Cars  
01509 279 279**

## Further information about all onward travel

<b>Local Cycle Info</b> <a href="http://rushcliffe.gov.uk">rushcliffe.gov.uk</a> For more information about cycle routes, walking and public transport.	<b>National Cycle Info</b> <a href="http://sustrans.org.uk">sustrans.org.uk</a> Sustrans is the UK's leading sustainable transport charity.	<b>Bus Times</b> See timetable displays at bus stops.  <a href="http://www.traveline.info">www.traveline.info</a> 0871 200 22 33 calls cost 13p per minute plus your phone company's access charge	<b>NextBuses</b>  <b>Find the bus times for your stop.</b> Search for a bus stop by entering a postcode, street & town or a stop name & town.	<b>PlusBus</b> <a href="http://plusbus.info">plusbus.info</a> A discount price 'bus pass' that you buy with your train ticket. It gives you unlimited bus travel around your chosen town, on participating buses.
---	---	---	--	---

## National Rail Enquiries

<b>Online</b> <a href="http://nationalrail.co.uk">nationalrail.co.uk</a>	<b>NRE App</b> Free National Rail Enquiries app for iOS and Android	<b>Social Media</b> facebook.com/nationalrailenq @nationalrailenq	<b>Alert Me</b> You can sign up to Alert Me messages on the National Rail Enquiries website where you can receive train and platform notifications directly to your smart phone. <a href="http://nationalrail.co.uk/alertme">nationalrail.co.uk/alertme</a>	<b>Contact Centre</b> 03457 48 49 50 Calls cost no more than calls to geographic numbers (01 or 02) and may be recorded.	<b>PlusBike</b> <a href="http://nationalrail.co.uk/plusbike">nationalrail.co.uk/plusbike</a> For more information.
---	--	---	---	--	--



**National Rail**  
Britain's train companies working together



This poster shows details of popular destinations and main, frequent bus routes. Additional services may run, so please check with Traveline or see posters at local bus stops. Whilst considerable care has been taken to ensure the information contained on this poster is correct and accurate, National Rail cannot accept responsibility for any loss or inconvenience caused by any errors or omissions, or for loss, damage, injury or inconvenience relating to the cancellation, alteration, delay or diversion of a service. For any feedback, please e-mail [comments@onwardtravelposters.com](mailto:comments@onwardtravelposters.com)

Scan this code with your mobile for full station information.