



# Darsham Station

# Onward Travel Information

## Local area map



## Buses

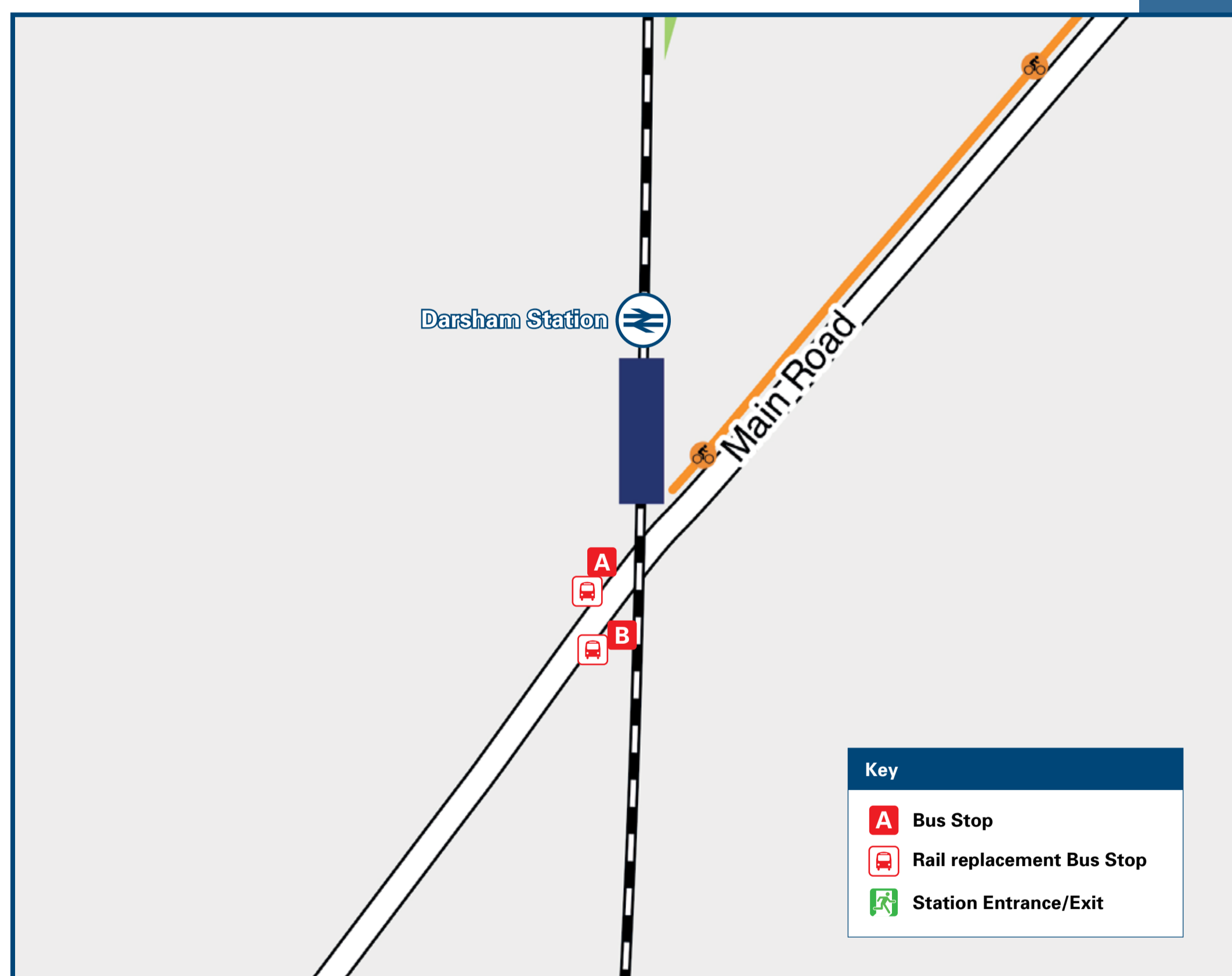

Rail replacement bus services pick up and drop off adjacent to the station entrance in both directions.

## Main destinations by bus

(Data correct at September 2024)

DESTINATION	BUS ROUTES	BUS STOP
Aldeburgh	521, 522	B
Beccles	522	A
Benhall Green	521	B
Bigsby's Corner	521	B
Bramfield	521, 522	A
Darsham Village	20 minutes walk from this Station	A
Friston	521	B
Halesworth	521, 522	A
Kelsale	521, 522	B
Knodishall	521	B
Leiston	521, 522	B
Mells	521, 522	A
Saxmundham	521, 522	B
Sternfield	521	B
Thorpeness	521	B
Yoxford	15 minutes walk from this Station	B

**Notes**

Bus route 521 operates a limited Mondays to Saturdays service, only. No Sunday service.  
 Bus route 522 operates a limited Mondays to Fridays service, only. No Saturday or Sunday service.  
 Darsham Rail Station is also served by Connecting Communities: When you need to make a journey and there's no public transport available locally, Connecting Communities can collect and connect customers to appropriate bus or train links for onward travel. Please call: 01728 635 938 or on the web: [www.suffolkonboard.com/cc](http://www.suffolkonboard.com/cc) for more information on this scheme, and for a booking service.

Direct trains operate to this destination from this station.

## Taxis

Darsham Station has no taxi rank or cab office. Advance booking is essential, please consider using the following local operators: (Inclusion of this number doesn't represent any endorsement of the taxi firm)

**Torrens Cars (Saxmundham)**  
07532 044 085

**Hart Cars (Saxmundham)**  
01728 602 009

## Further information about all onward travel

<b>Local Cycle Info</b> <a href="http://www.suffolkonboard.com/cycle">www.suffolkonboard.com/cycle</a> For more information about cycle routes.	<b>National Cycle Info</b> <a href="http://sustrans.org.uk">sustrans.org.uk</a> Sustrans is the UK's leading sustainable transport charity.	<b>Bus Times</b> See timetable displays at bus stops. <a href="http://www.traveline.info">www.traveline.info</a> 0871 200 22 33 call cost 13p per minute plus your phone company's access charge	<b>NextBuses</b> <b>Find the bus times for your stop.</b> Search for a bus stop by entering a postcode, street & town or a stop name & town.	<b>PlusBus</b> <a href="http://plusbus.info">plusbus.info</a> A discount priced 'bus pass' that you buy with your train ticket. It gives you unlimited bus travel around your chosen town, on participating buses.
---	---	--	--	--

## National Rail Enquiries

<b>Online</b> <a href="http://nationalrail.co.uk">nationalrail.co.uk</a>	<b>NRE App</b> Free National Rail Enquiries app for iOS and Android	<b>Social Media</b> facebook.com/nationalrailenq @nationalrailenq	<b>Alert Me</b> You can sign up to Alert Me messages on the National Rail Enquiries website where you can receive train and platform notifications directly to your smart phone. <a href="http://nationalrail.co.uk/alertme">nationalrail.co.uk/alertme</a>	<b>Contact Centre</b> 03457 48 49 50 Calls cost no more than calls to geographic numbers (01 or 02) and may be recorded.	<b>PlusBike</b> <a href="http://nationalrail.co.uk/plusbike">nationalrail.co.uk/plusbike</a> For more information.
---	--	---	---	--	--



**National Rail**  
Britain's train companies working together

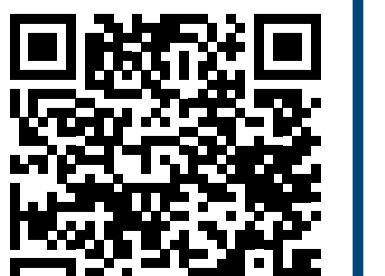

This poster shows details of popular destinations and main, frequent bus routes. Additional services may run, so please check with Traveline or see posters at local bus stops. Whilst considerable care has been taken to ensure the information contained on this poster is correct and accurate, National Rail cannot accept responsibility for any loss or inconvenience caused by any errors or omissions, or for loss, damage, injury or inconvenience relating to the cancellation, alteration, delay or diversion of a service. For any feedback, please e-mail [comments@onwardtravelposters.com](mailto:comments@onwardtravelposters.com)

Scan this code with your mobile for full station information.