

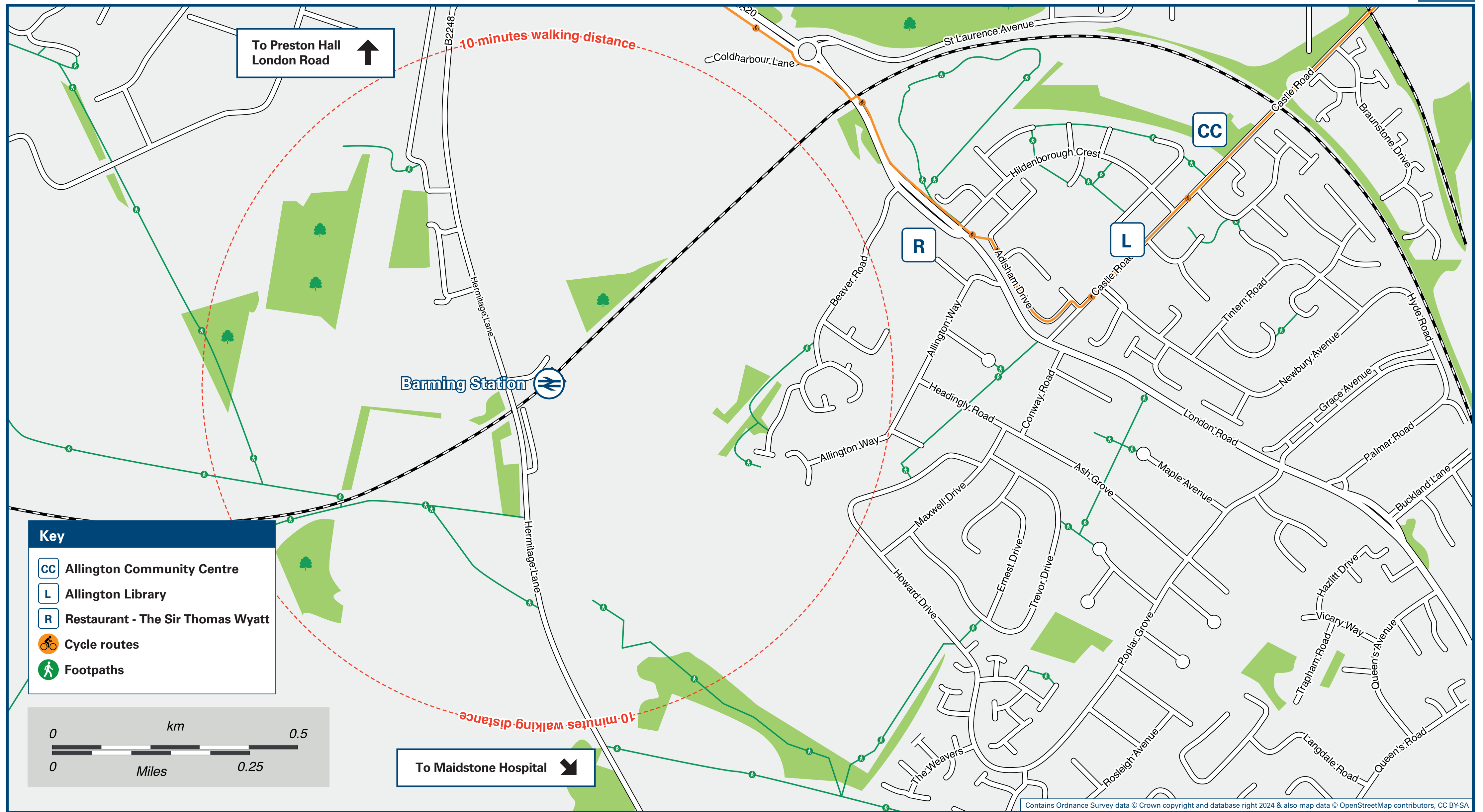

Barming Station

Onward Travel Information

Local area map



Buses

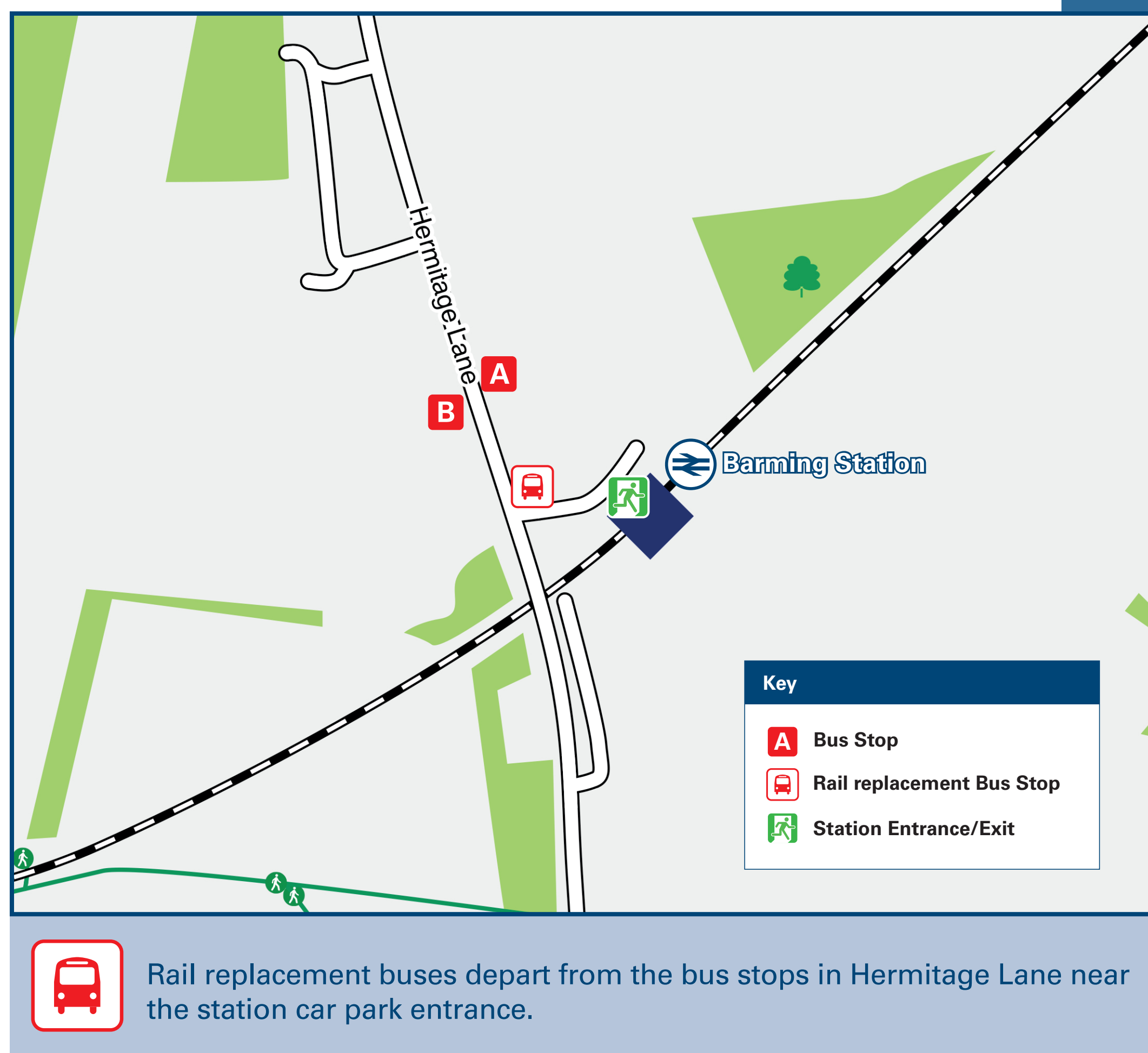

Rail replacement buses depart from the bus stops in Hermitage Lane near the station car park entrance.

Main destinations by bus

(Data correct at July 2024)

DESTINATION	BUS ROUTES	BUS STOP
Aylesford Retail Park (Homebase)	77	B
Hadlow (& Hadlow College)	77	B
Ditton Corner (A20)	77	B
Kings Hill	77	B
Larkfield	77	B
Maidstone Hospital	77	A
Mereworth	77	B
Tonbridge	77	B
West Malling (High Street)	77	B

Notes

Bus route 77 operates a limited service on Mondays to Fridays only. For bus times and further information, please call Traveline on 0871 200 22 33 or Nu-Venture (for bus route 77) call 01622 882 288.

Direct trains operate to this destination from this station.

Taxis

Barming Station has no taxi rank or cab office. Local taxis are available as listed below: (Inclusion of this number doesn't represent any endorsement of the taxi firm)

Express Taxis 01622 222 222

Maidstone Taxis 07930 281 229

Sapphire Cars 01622 663 000

Further information about all onward travel

Local Cycle Info tmbc.gov.uk <small>For more information about cycle routes.</small>	National Cycle Info sustrans.org.uk <small>Sustrans is the UK's leading sustainable transport charity.</small>	Bus Times <small>See timetable displays at bus stops.</small> www.traveline.info 0871 200 22 33 <small>calls cost 13p per minute plus your phone company's access charge</small>	NextBuses <small>Find the bus times for your stop.</small> Search for a bus stop by entering a postcode, street & town or a stop name & town.	PlusBus plusbus.info <small>A discount price 'bus pass' that you buy with your train ticket. It gives you unlimited bus travel around your chosen town, on participating buses.</small>
--	--	--	--	---

National Rail Enquiries

Online nationalrail.co.uk	NRE App Free National Rail Enquiries app for iOS and Android	Social Media facebook.com/nationalrailenq @nationalrailenq	Alert Me <small>You can sign up to Alert Me messages on the National Rail Enquiries website where you can receive train and platform notifications directly to your smart phone.</small> nationalrail.co.uk/alertme	Contact Centre 03457 48 49 50 <small>Calls cost no more than calls to geographic numbers (01 or 02) and may be recorded.</small>	PlusBike nationalrail.co.uk/plusbike For more information.
---	---	--	--	--	--



This poster shows details of popular destinations and main, frequent bus routes. Additional services may run, so please check with Traveline or see posters at local bus stops. Whilst considerable care has been taken to ensure the information contained on this poster is correct and accurate, National Rail cannot accept responsibility for any loss or inconvenience caused by any errors or omissions, or for loss, damage, injury or inconvenience relating to the cancellation, alteration, delay or diversion of a service. For any feedback, please e-mail comments@onwardtravelposters.com

Scan this code with your mobile for full station information.