

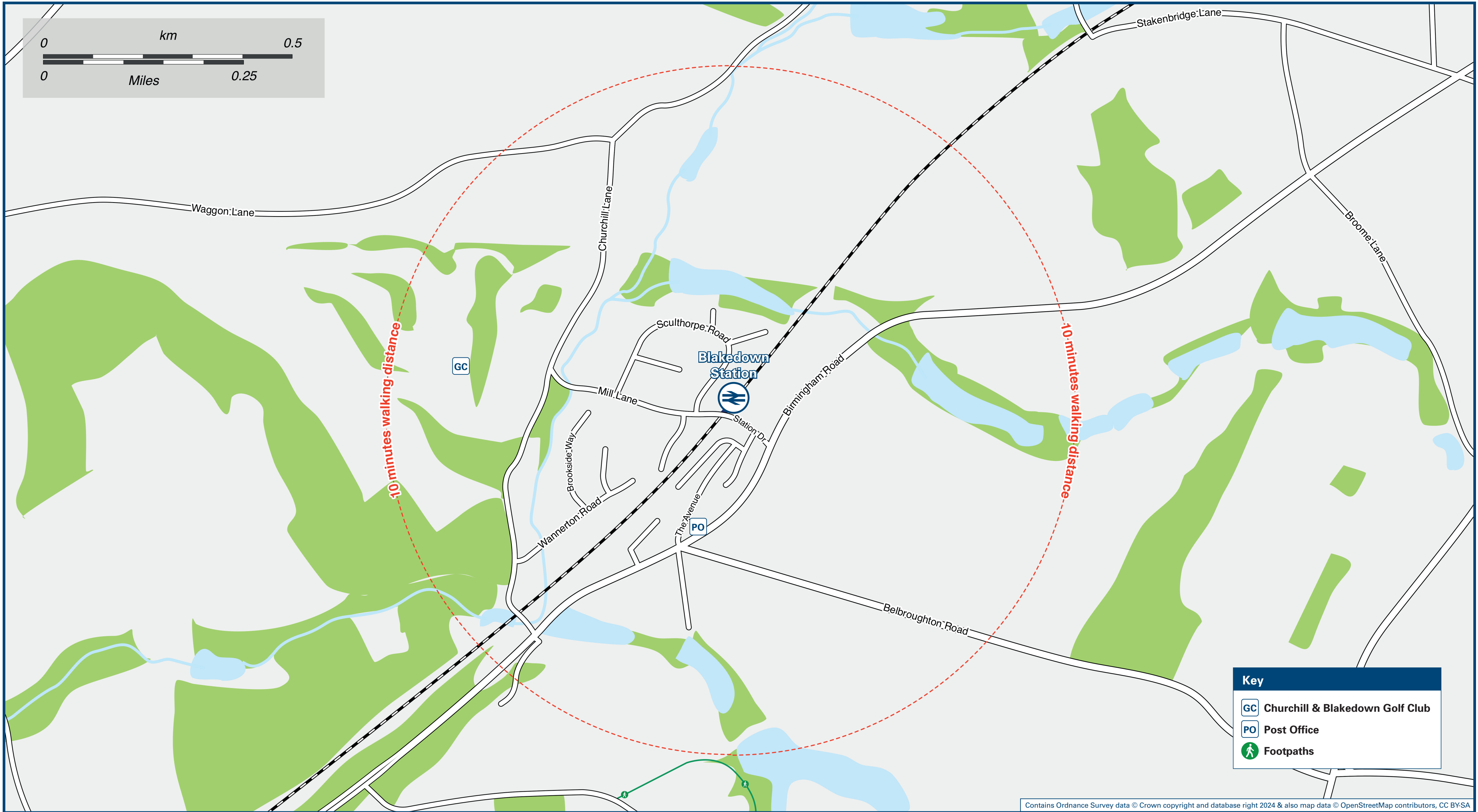

Blakedown Station

Onward Travel Information

Local area map



Buses

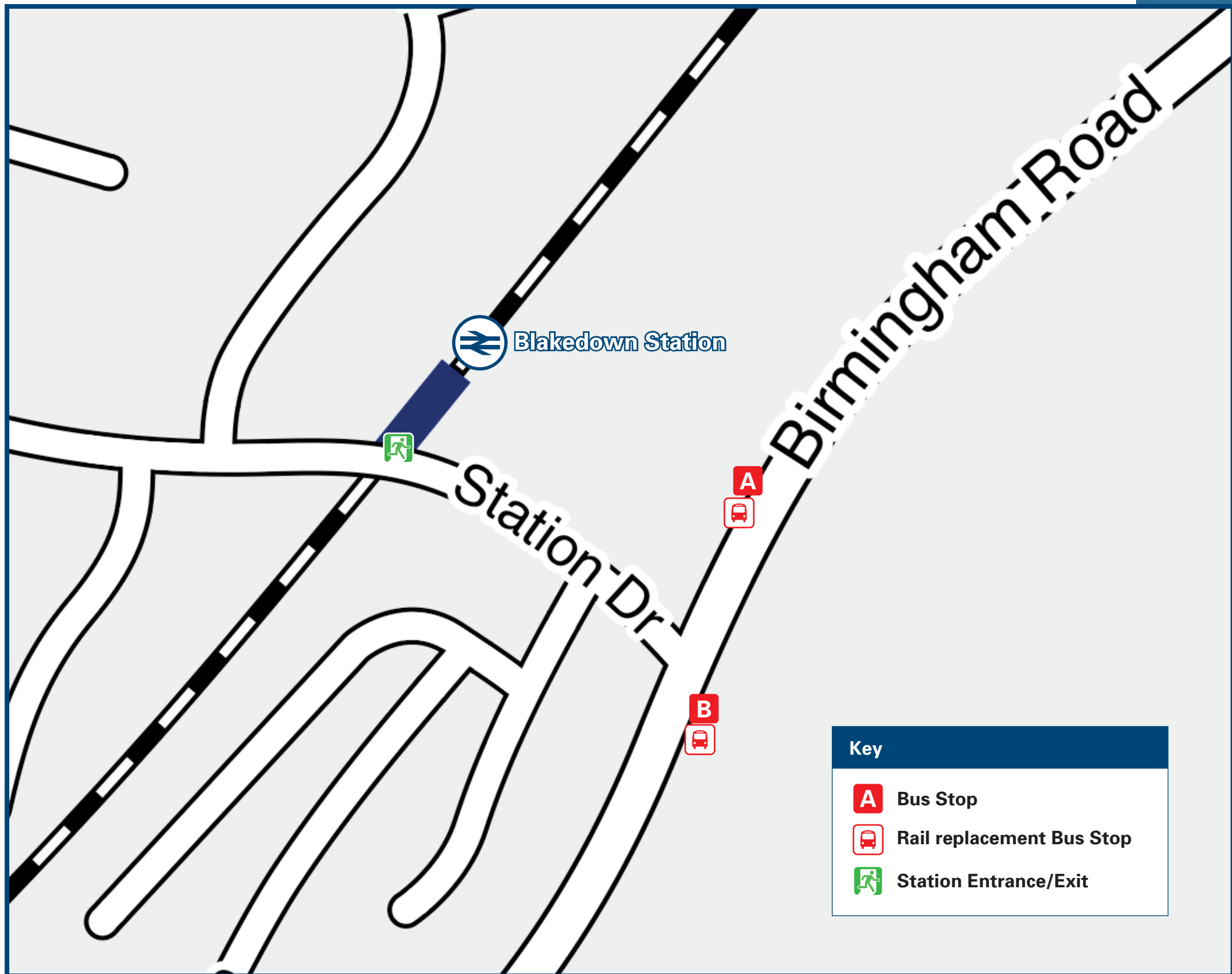

Rail replacement buses/coaches pick up/set down on A456 at public service bus stops.

Main destinations by bus

DESTINATION	BUS ROUTES	BUS STOP
Greenhill	192	B
Hagley	192	A
Halesowen	192	A
Hasbury	192	A
Hayley Green	192	A
Hurcott	192	B
Kidderminster	192	B
West Hagley	192	A

Notes

Bus route 192 operates an hourly daytime service Mondays to Saturdays only.
For bus times and further information contact Traveline on 0871 200 22 33 or Diamond Bus see www.diamondbuses.co.uk or call 0121 322 2222.

Direct trains operate to this destination from this Station.

Taxis

Blakedown station has no taxi rank or cab office. Advance booking is essential, please consider using the following local operators: (Inclusion of this number doesn't represent any endorsement of the taxi firm)

Falcon Taxis
01562 700 700

Blakedown Cars
07736 525 338

Regency Taxis
01562 66666

Further information about all onward travel

Local Cycle Info wyreforstdc.gov.uk For more information about cycle routes.	National Cycle Info sustrans.org.uk Sustrans is the UK's leading sustainable transport charity.	Bus Times See timetable displays at bus stops. www.traveline.info 0871 200 22 33 calls cost 15p per minute plus your phone company's access charge	NextBuses Find the bus times for your stop. Search for a bus stop by entering a postcode, street & town or a stop name & town.	PlusBus plusbus.info A discount price 'bus pass' that you buy with your train ticket. It gives you unlimited bus travel around your chosen town, on participating buses.
---	---	---	--	--

National Rail Enquiries

Online nationalrail.co.uk	NRE App Free National Rail Enquiries app for iOS and Android	Social Media facebook.com/nationalrailenq @nationalrailenq	Alert Me You can sign up to Alert Me messages on the National Rail Enquiries website where you can receive train and platform notifications directly to your smart phone. nationalrail.co.uk/alertme	Contact Centre 03457 48 49 50 Calls cost no more than calls to geographic numbers (01 or 02) and may be recorded.	PlusBike nationalrail.co.uk/plusbike For more information.
---	--	--	---	--	--

