

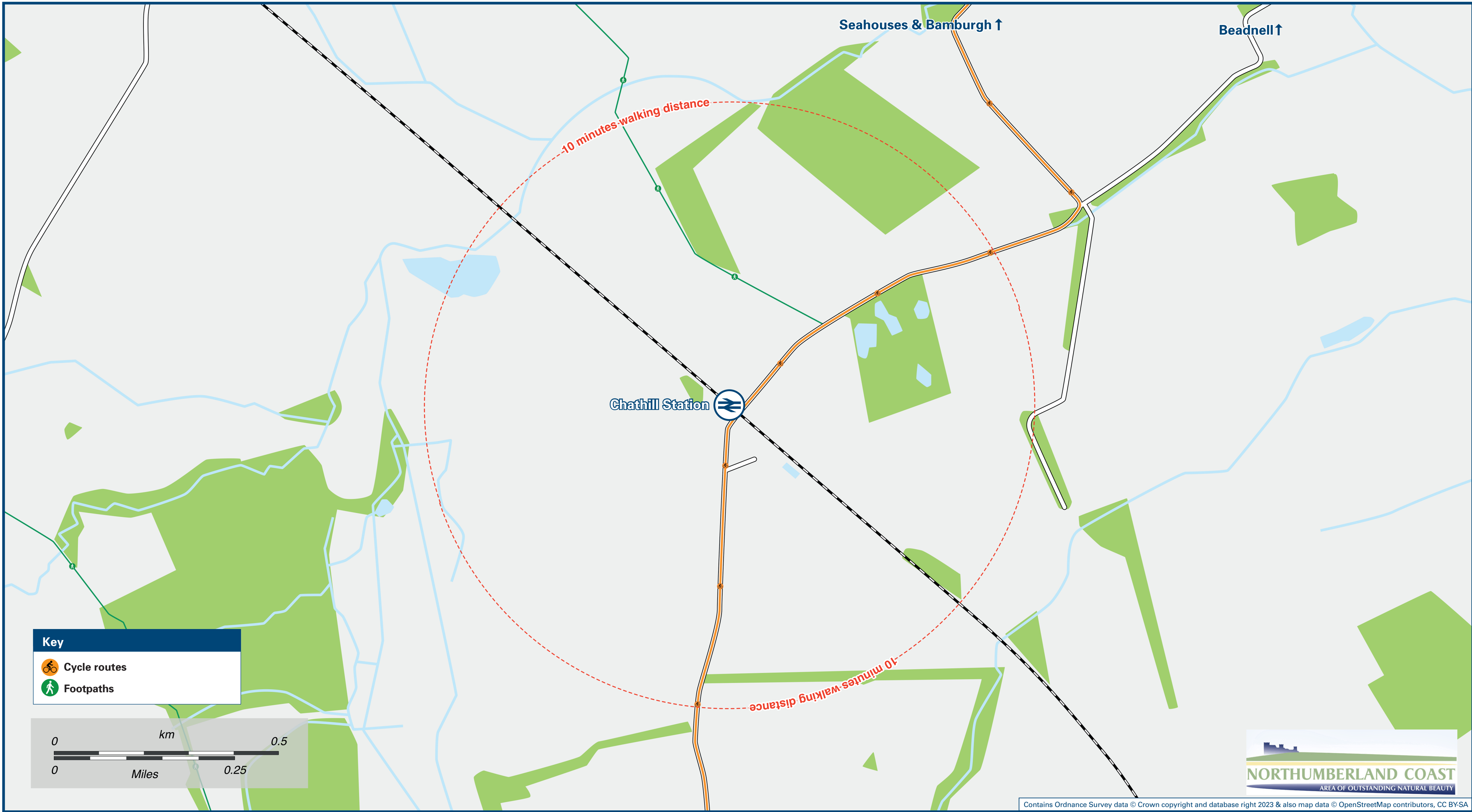

Chathill Station

Onward Travel Information

Local area map



Bus Map

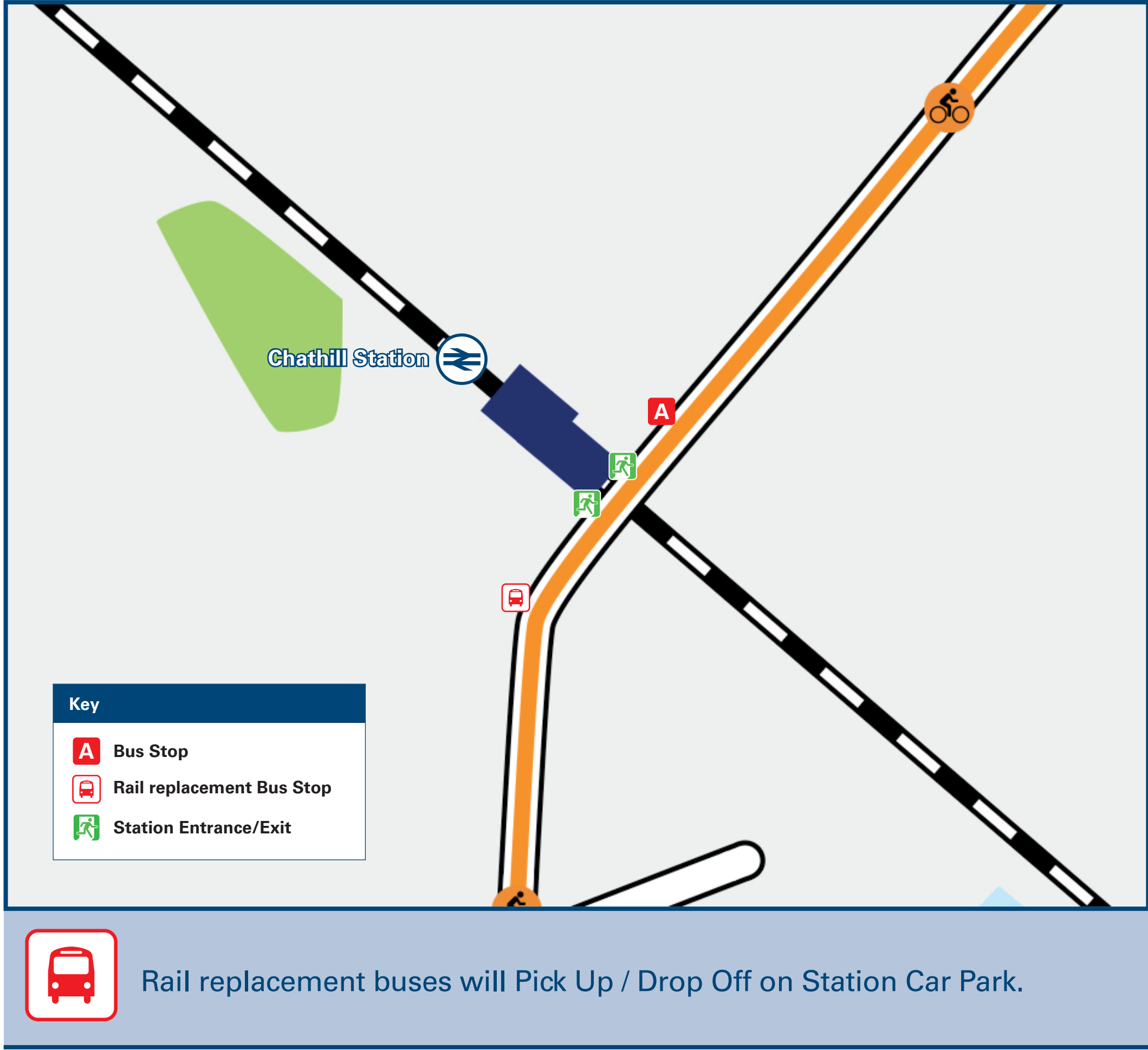

Main destinations by bus



DESTINATION	BUS ROUTES	BUS STOP
Bamburgh (The Grove)	918*	A
Beadnell (Craster Arms)	918*	A
Belford (North Bank)	918*	A
North Sunderland (St Paul's Church)	918*	A
Seahouses (King Street)	918*	A
Waren Mill (Budle Bay Campsite)	918*	A

Notes

* Bus route 918 operates a very limited service, running from Chathill Railway at 07:04 and 19:10 on Mondays to Saturdays, only. No Sunday service.

If your train arrives after the bus has left, our Taxi Guarantee Scheme will get you to where you need to be. Call RSM Private Hire on 07541 650101 to arrange your taxi, which will take you "free of charge" to any bus stop served by the 918. The Taxi Guarantee Scheme only applies at Chathill Station, only.

Further information about all onward travel

Local Cycle Info northumberland.gov.uk For more information about cycle routes.	National Cycle Info sustrans.org.uk Sustrans is the UK's leading sustainable transport charity.	Bus Times See timetable displays at bus stops. www.traveline.info 0871 200 22 33 calls cost 10p per minute plus your phone company's access charge	NextBuses Find the bus times for your stop. Search for a bus stop by entering a postcode, street & town or a stop name & town.	PlusBus plusbus.info A discount price 'bus pass' that you buy with your train ticket. It gives you unlimited bus travel around your chosen town, on participating buses.
---	---	---	--	--

National Rail Enquiries

Online nationalrail.co.uk	NRE App Free National Rail Enquiries app for iOS and Android	Social Media facebook.com/nationalrailenq @nationalrailenq	Alert Me You can sign up to Alert Me messages on the National Rail Enquiries website where you can receive train and platform notifications directly to your smart phone. nationalrail.co.uk/alertme	Contact Centre 03457 48 49 50 Calls cost no more than calls to geographic numbers (01 or 02) and may be recorded.	PlusBike nationalrail.co.uk/plusbike For more information.
---	--	--	---	---	--

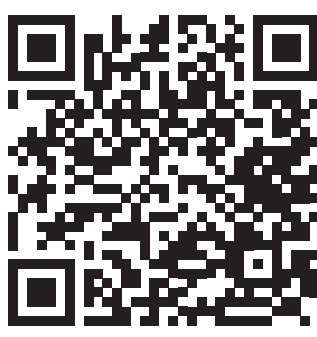

This poster shows details of popular destinations and main, frequent bus routes. Additional services may run, so please check with Traveline or see posters at local bus stops. Whilst considerable care has been taken to ensure the information contained on this poster is correct and accurate, National Rail cannot accept responsibility for any loss or inconvenience caused by any errors or omissions, or for loss, damage, injury or inconvenience relating to the cancellation, alteration, delay or diversion of a service. For any feedback, please e-mail comments@onwardtravelposters.com

Scan this code with your mobile for full station information.