

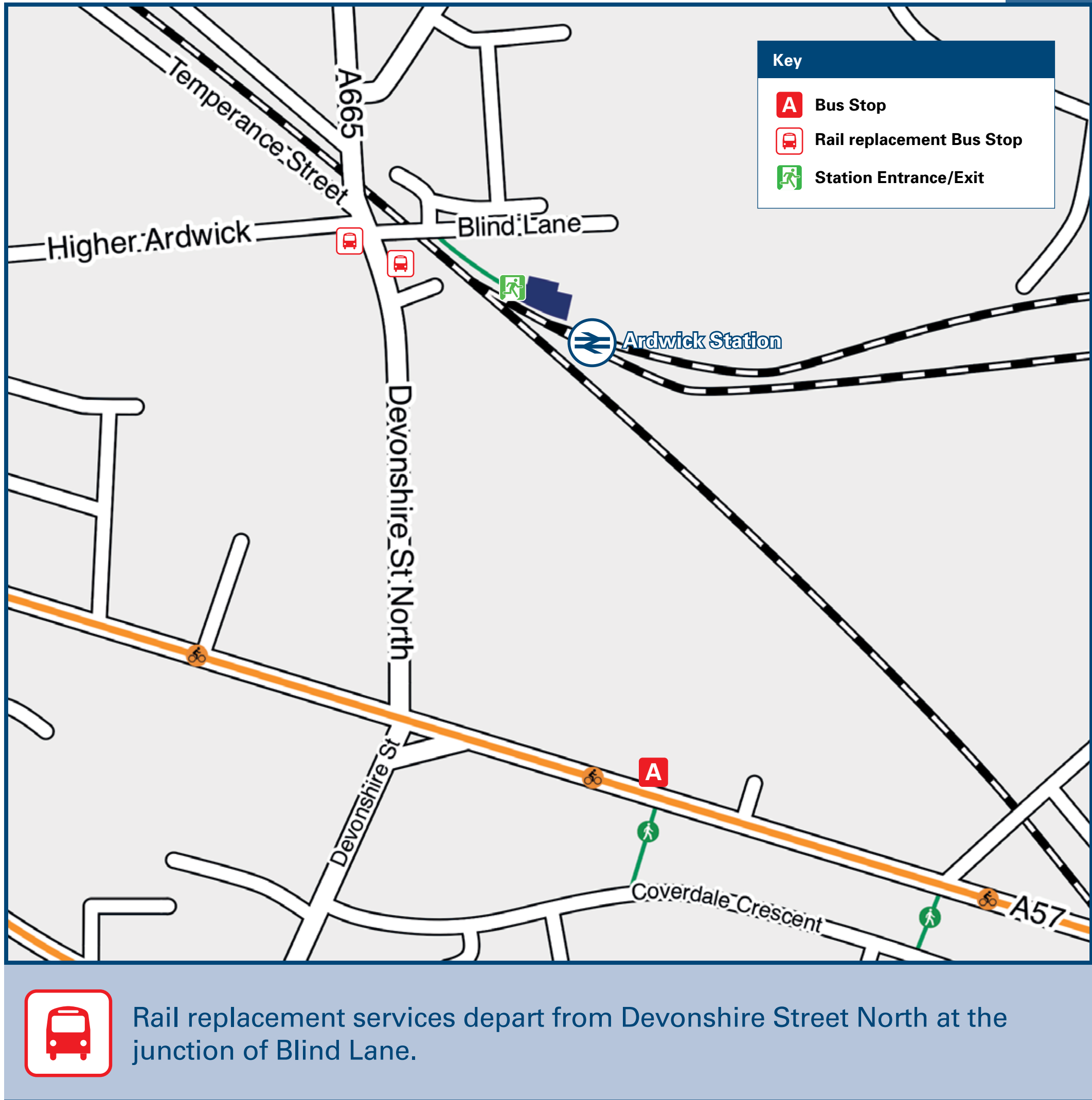

# Ardwick Station

## Onward Travel Information

### Buses



### Local area map

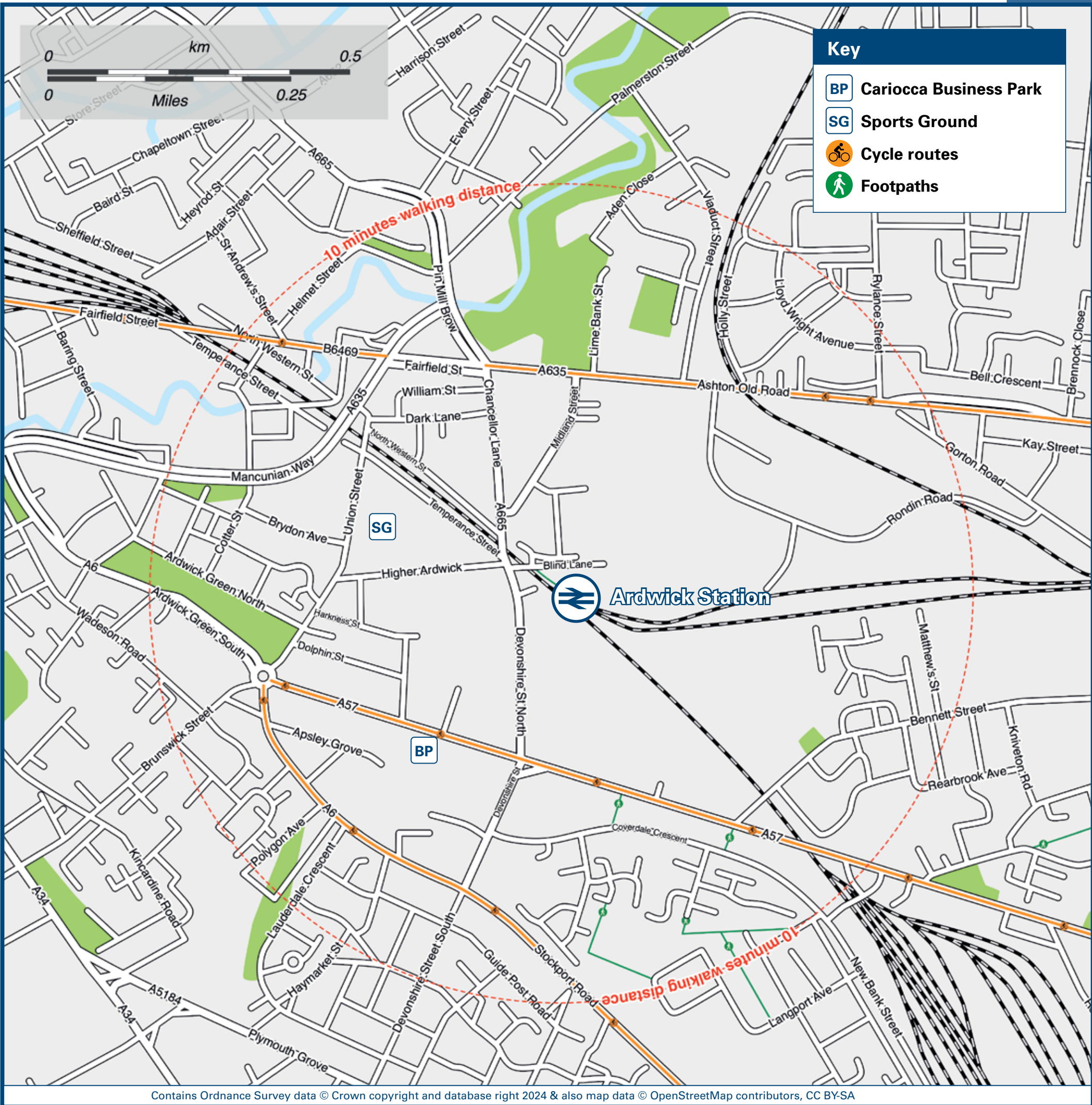

### Main destinations by bus



DESTINATION	BUS ROUTES	BUS STOP	DESTINATION	BUS ROUTES	BUS STOP	DESTINATION	BUS ROUTES	BUS STOP
Belle Vue	201, 202, 203	A	Hattersley	201	A	Stockport	203	A
Dane Bank (Manchester Road)	201, 202	A	Haughton Green	202	A	West Gorton (Wenlock Way & Gorton Lane)	205	A
Dane Bank (Windmill Lane)	205	A	Hyde	201, 202	A			
Denton	201, 202	A	Mottram (John Kennedy Gardens)	201	A			
Gee Cross	202	A	Reddish (Houldsworth Square)	203	A			
Godley	201	A	Reddish Bridge (Hyde Road)	201, 202, 203, 205	A			
Gorton (for Shopping Centre)	201, 202, 203, 205	A	Reddish North Station	203	A			

#### Notes

Bus routes 201, 202, 203 and 205 operate daily, Mondays to Sundays, including evenings and public holidays.

For bus times please see bus stop timetables or contact Traveline on 0871 200 22 33.

⚡ Limited direct trains operate to this destination Monday to Friday evenings only.

### Taxis

Ardwick station has no taxi rank or cab office. Advance booking is essential, please consider using the following local operators: (Inclusion of this number doesn't represent any endorsement of the taxi firm)

**Mantax**  
0161 230 3333

**Radio Cars**  
0161 236 8033

### Further information about all onward travel

<b>Local Cycle Info</b> <a href="http://manchester.gov.uk">manchester.gov.uk</a> For more information about cycle routes.	<b>National Cycle Info</b> <a href="http://sustrans.org.uk">sustrans.org.uk</a> Sustrans is the UK's leading sustainable transport charity.	<b>Bus Times</b> See timetable displays at bus stops. <a href="http://www.traveline.info">www.traveline.info</a> 0871 200 22 33 calls cost 15p per minute plus your phone company's access charge	<b>NextBuses</b> <b>Find the bus times for your stop.</b> Search for a bus stop by entering a postcode, street & town or a stop name & town.	<b>PlusBus</b> <b>plusbus.info</b> A discount price 'bus pass' that you buy with your train ticket. It gives you unlimited bus travel around your chosen town, on participating buses.
---	---	---	--	--

### National Rail Enquiries

<b>Online</b> <a href="http://nationalrail.co.uk">nationalrail.co.uk</a>	<b>NRE App</b> Free National Rail Enquiries app for iOS and Android	<b>Social Media</b> <a href="https://facebook.com/nationalrailenq">facebook.com/nationalrailenq</a> <a href="https://twitter.com/nationalrailenq">@nationalrailenq</a>	<b>Alert Me</b> You can sign up to Alert Me messages on the National Rail Enquiries website where you can receive train and platform notifications directly to your smart phone. <a href="http://nationalrail.co.uk/alertme">nationalrail.co.uk/alertme</a>	<b>Contact Centre</b> 03457 48 49 50 Calls cost no more than calls to geographic numbers (01 or 02) and may be recorded.	<b>PlusBike</b> <a href="http://nationalrail.co.uk/plusbike">nationalrail.co.uk/plusbike</a> For more information.
---	--	--	---	--	--



This poster shows details of popular destinations and main, frequent bus routes. Additional services may run, so please check with Traveline or see posters at local bus stops. Whilst considerable care has been taken to ensure the information contained on this poster is correct and accurate, National Rail cannot accept responsibility for any loss or inconvenience caused by any errors or omissions, or for loss, damage, injury or inconvenience relating to the cancellation, alteration, delay or diversion of a service. For any feedback, please e-mail [comments@onwardtravelposters.com](mailto:comments@onwardtravelposters.com)

Scan this code with your mobile for full station information.