

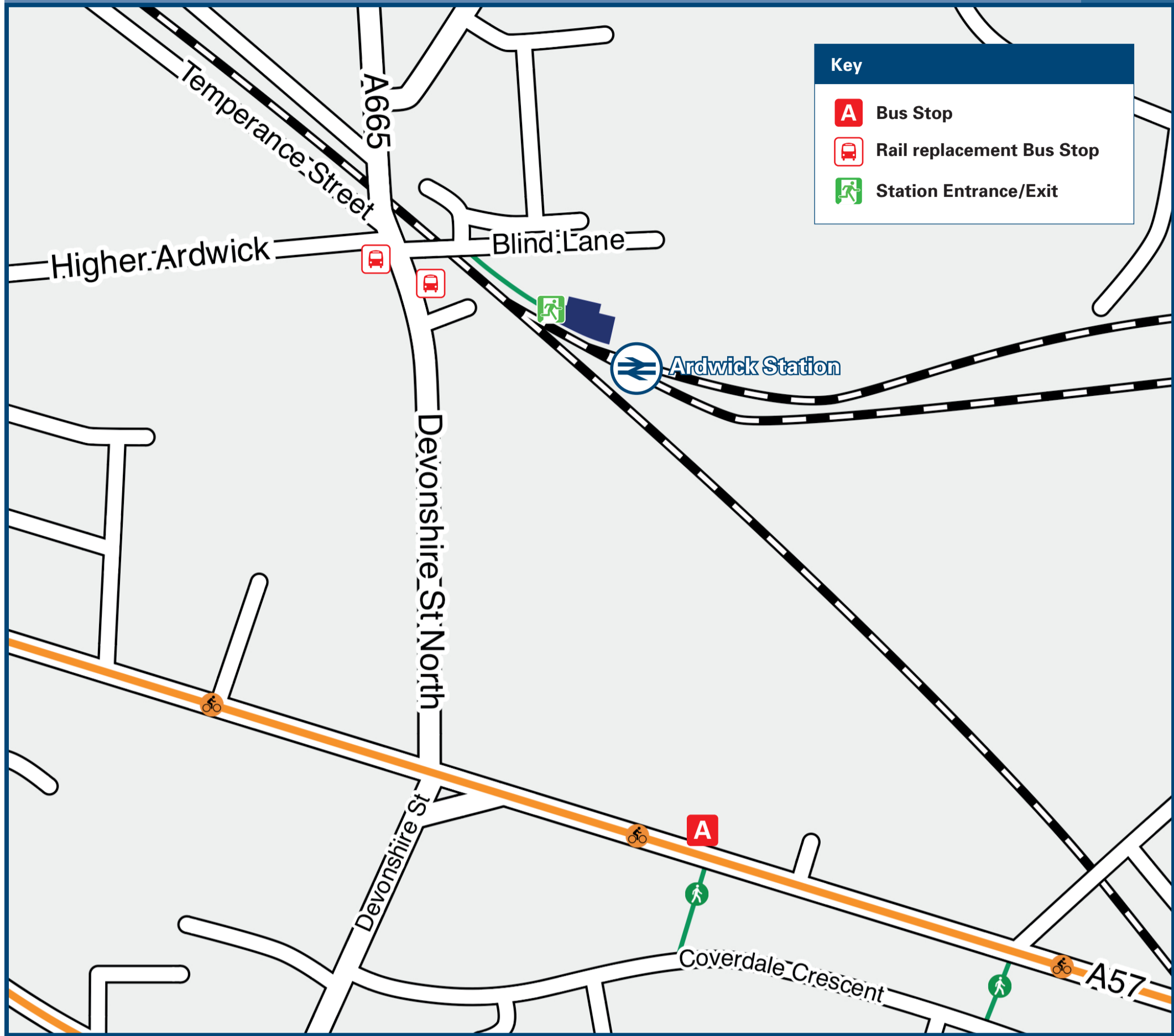

# Ardwick Station

## Onward Travel Information

### Buses



Rail replacement buses depart from Mellor Lane.

### Local area map

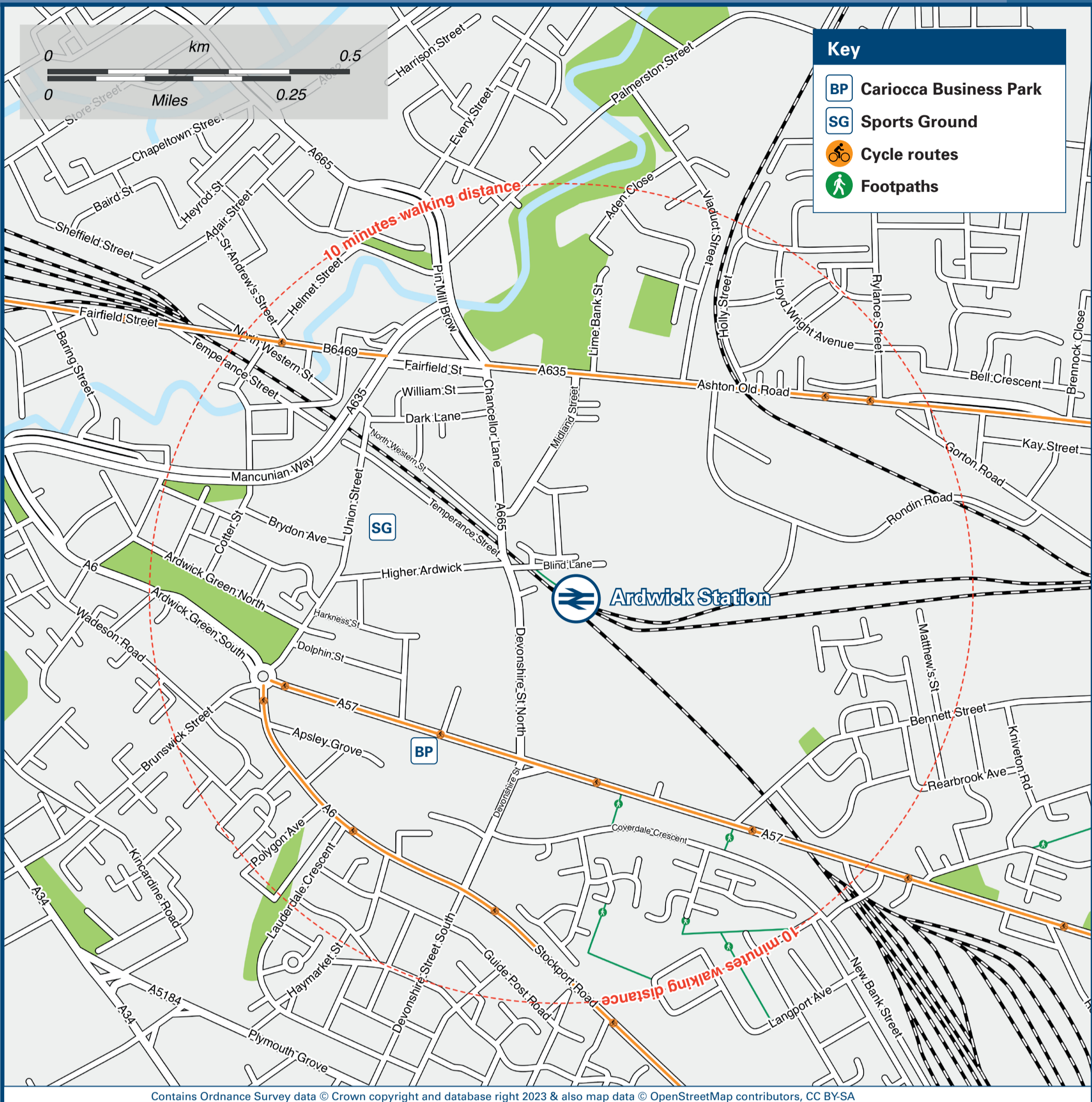

### Main destinations by bus

(Data correct at October 2023)



DESTINATION	BUS ROUTES	BUS STOP
Belle Vue	201, 202, 203	A
Dane Bank (Manchester Road)	201, 202	A
Dane Bank (Windmill Lane)	205	A
Denton	201, 202	A
Gee Cross	202	A
Godley	201	A

DESTINATION	BUS ROUTES	BUS STOP
Gorton (for Shopping Centre)	201, 202, 203, 205	A
Hattersley	201	A
Haughton Green	202	A
Hyde	201, 202	A
Mottram (John Kennedy Gardens)	201	A
Reddish (Houldsworth Square)	203	A

DESTINATION	BUS ROUTES	BUS STOP
Reddish Bridge (Hyde Road)	201, 202, 203, 205	A
Reddish North Station	203	A
Stockport	203	A
West Gorton (Wenlock Way & Gorton Lane)	205	A

**Notes**

Bus routes 201, 202, 203 and 205 operate daily, Mondays to Sundays, including evenings and Public Holidays.

For bus times please see bus stop timetables or contact Traveline on 0871 200 22 33.

⚡ Limited direct trains operate to this destination Monday to Friday evenings only.

### Taxis

Ardwick station has no taxi rank or cab office. Advance booking is essential, please consider using the following local operators: (Inclusion of this number doesn't represent any endorsement of the taxi firm)

**Mantax**  
0161 230 3333

**Radio Cars**  
0161 236 8033

### Further information about all onward travel

Local Cycle Info	National Cycle Info	Bus Times	NextBuses	PlusBus
<a href="http://manchester.gov.uk">manchester.gov.uk</a> For more information about cycle routes.	<a href="http://sustrans.org.uk">sustrans.org.uk</a> Sustrans is the UK's leading sustainable transport charity.	See timetable displays at bus stops. <a href="http://www.traveline.info">www.traveline.info</a> 0871 200 22 33 call cost 15p per minute plus your phone company's access charge	Find the bus times for your stop. Search for a bus stop by entering a postcode, street & town or a stop name & town.	<a href="http://plusbus.info">plusbus.info</a> A discount price 'bus pass' that you buy with your train ticket. It gives you unlimited bus travel around your chosen town, on participating buses.

### National Rail Enquiries

Online	NRE App	Social Media	Alert Me	Contact Centre	PlusBike
<a href="http://nationalrail.co.uk">nationalrail.co.uk</a>	Free National Rail Enquiries app for iOS and Android	<a href="https://www.facebook.com/nationalrailenq">facebook.com/nationalrailenq</a> <a href="https://twitter.com/nationalrailenq">@nationalrailenq</a>	You can sign up to Alert Me messages on the National Rail Enquiries website where you can receive train and platform notifications directly to your smart phone. <a href="http://nationalrail.co.uk/alertme">nationalrail.co.uk/alertme</a>	03457 48 49 50 Calls cost no more than calls to geographic numbers (01 or 02) and may be recorded.	<a href="http://nationalrail.co.uk/plusbike">nationalrail.co.uk/plusbike</a> For more information.



NORTHERN



**National Rail**  
Britain's train companies working together

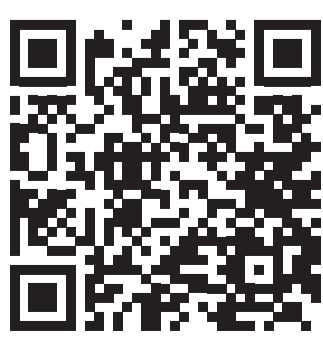

This poster shows details of popular destinations and main, frequent bus routes. Additional services may run, so please check with Traveline or see posters at local bus stops. Whilst considerable care has been taken to ensure the information contained on this poster is correct and accurate, National Rail cannot accept responsibility for any loss or inconvenience caused by any errors or omissions, or for loss, damage, injury or inconvenience relating to the cancellation, alteration, delay or diversion of a service. For any feedback, please e-mail [comments@onwardtravelposters.com](mailto:comments@onwardtravelposters.com)

Scan this code with your mobile for full station information.