

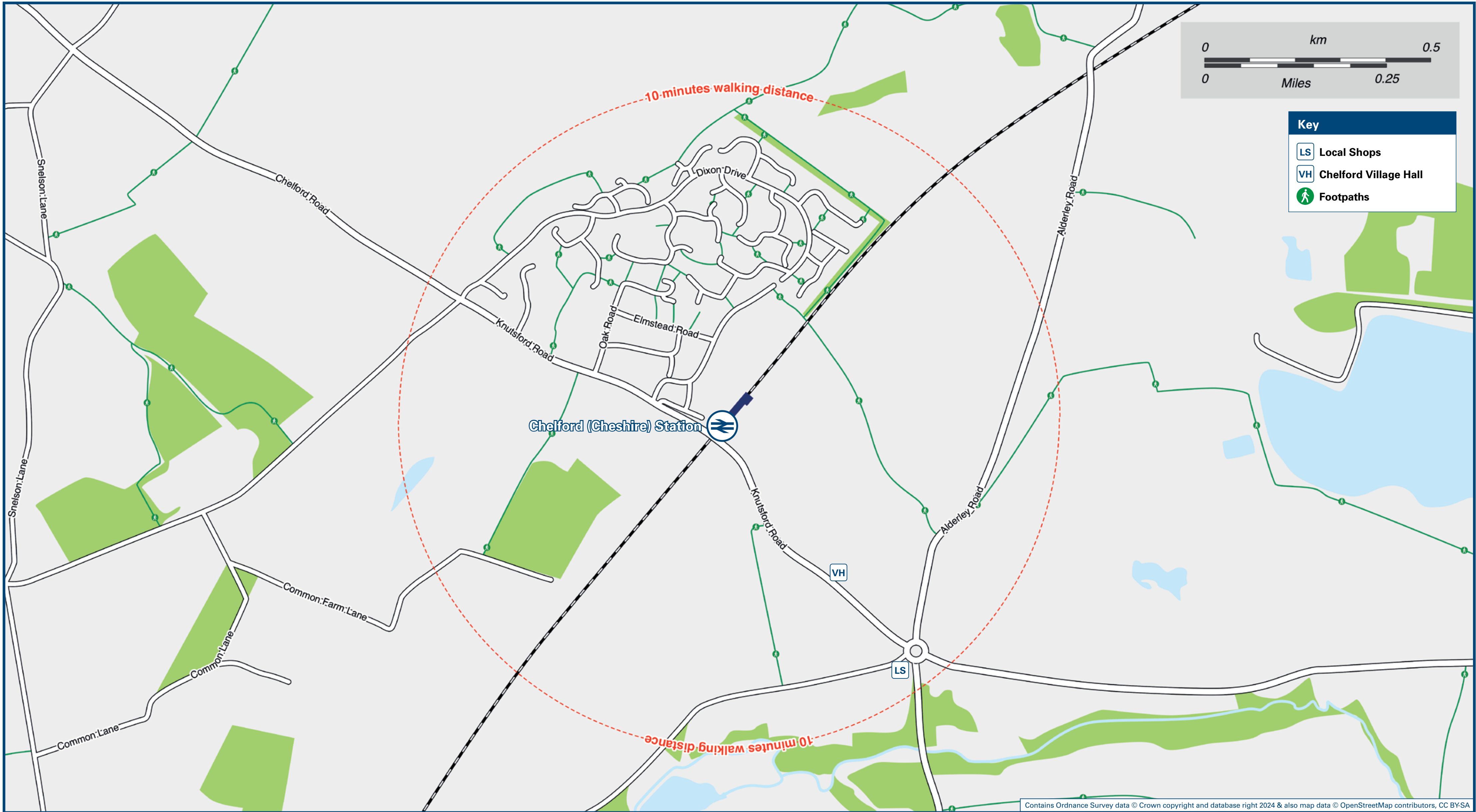

Chelford Station

Onward Travel Information

Local area map



Buses

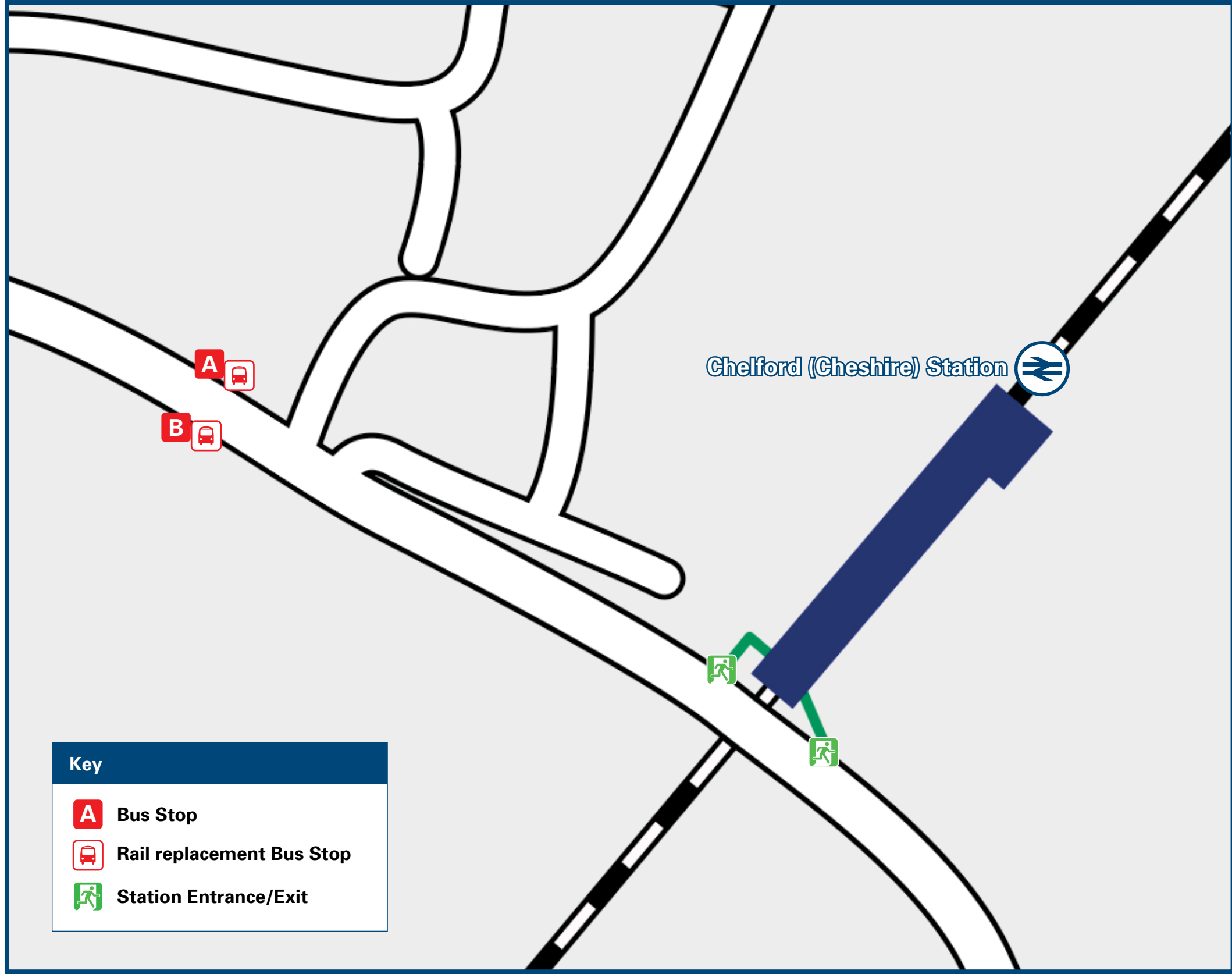

Rail replacement buses to Stockport will depart from the stop on Knutsford Road (A537) at the junction with Dixon Street, outside the NatWest bank Buses to Crewe will stop on Knutsford Road opposite Dixon Street.

Main destinations by bus

DESTINATION	BUS ROUTES	BUS STOP
Altrincham	88	B
Broken Cross	88	A
Hale Barns	88	B
Henbury	88	A
Knolls Green	88	B
Knutsford (Bus Station)	88	B
Knutsford (Railway Station)	88	B
Macclesfield	88	A
Macclesfield General Hospital	88	A
Mobberley	88	B
Monks Heath	88	A
Morley Green	88	B
Ollerton	88	B
Over Peover	88	B
Peover Heath	88	B
Whipping Stocks Inn (for Radbroke Hall, Barclays Bank)	88	B
Wilmslow	88	B
Upton Priory	88	A

Notes

Bus route 88 operates a limited service on Mondays to Saturdays only. For bus times please see bus stop timetables or contact Traveline.

Direct trains operate to this destination from this station.

Taxis

Chelford Station has no taxi rank or cab office. Advance booking is essential, please consider using the following local operators: (Inclusion of this number doesn't represent any endorsement of the taxi firm)

Knutsford Taxis (Knutsford)
01565 740 540

AA Taxi (Knutsford)
07578 455 005

Cab Co
01625 432 000

Further information about all onward travel

Local Cycle Info cheshireeast.gov.uk For more information about cycle routes.	National Cycle Info sustrans.org.uk Sustrans is the UK's leading sustainable transport charity.	Bus Times See timetable displays at bus stops. www.traveline.info 0871 200 22 33 calls cost 15p per minute plus your phone company's access charge	NextBuses Find the bus times for your stop. Search for a bus stop by entering a postcode, street & town or a stop name & town.	PlusBus plusbus.info A discount price 'bus pass' that you buy with your train ticket. It gives you unlimited bus travel around your chosen town, on participating buses.
---	---	---	--	--

National Rail Enquiries

Online nationalrail.co.uk	NRE App Free National Rail Enquiries app for iOS and Android	Social Media facebook.com/nationalrailenq @nationalrailenq	Alert Me You can sign up to Alert Me messages on the National Rail Enquiries website where you can receive train and platform notifications directly to your smart phone. nationalrail.co.uk/alertme	Contact Centre 03457 48 49 50 Calls cost no more than calls to geographic numbers (01 or 02) and may be recorded.	PlusBike nationalrail.co.uk/plusbike For more information.
---	--	--	---	--	--



This poster shows details of popular destinations and main, frequent bus routes. Additional services may run, so please check with Traveline or see posters at local bus stops. Whilst considerable care has been taken to ensure the information contained on this poster is correct and accurate, National Rail cannot accept responsibility for any loss or inconvenience caused by any errors or omissions, or for loss, damage, injury or inconvenience relating to the cancellation, alteration, delay or diversion of a service. For any feedback, please e-mail comments@onwardtravelposters.com

Scan this code with your mobile for full station information.