

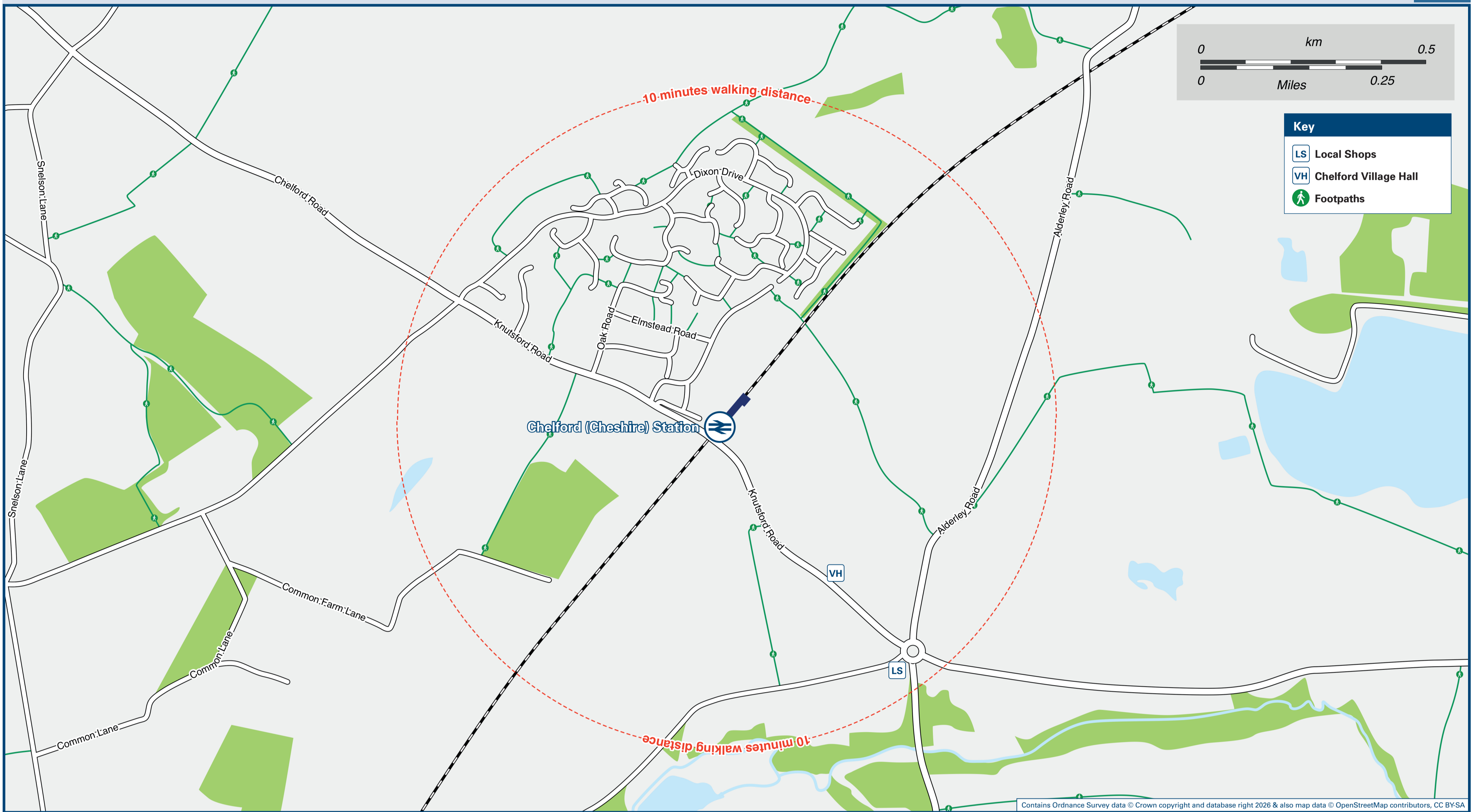

Chelford Station

Onward Travel Information

Local area map



Buses

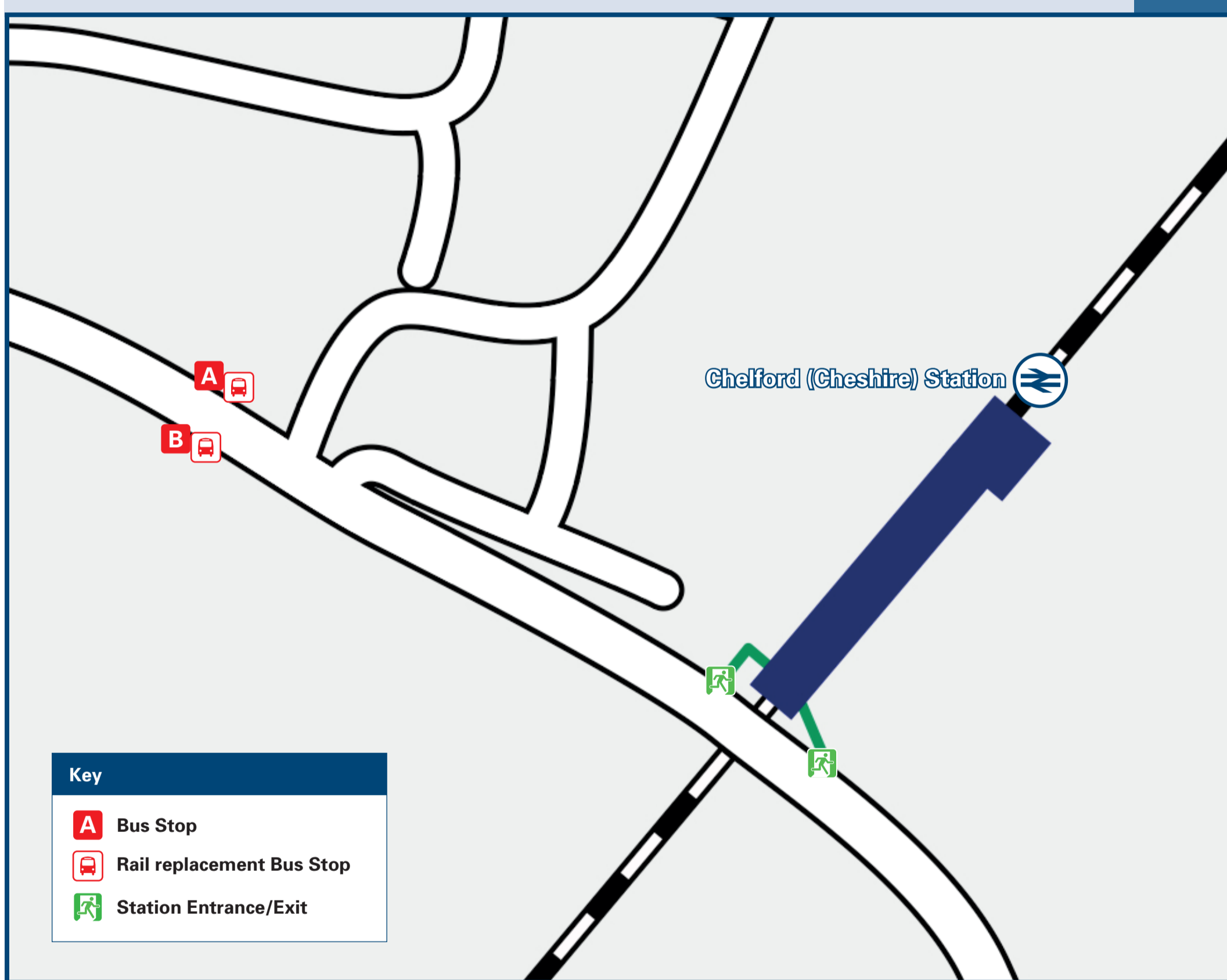

Rail replacement buses to Stockport will depart from the stop on Knutsford Road (A537) at the junction with Dixon Drive, outside the NatWest bank. Buses to Crewe will stop on Knutsford Road opposite Dixon Drive.

Main destinations by bus

(Data correct at February 2026)

DESTINATION	BUS ROUTES	BUS STOP
Altrincham Interchange	87*	B
Broken Cross	87	A
Hale Barns	87*	B
Henbury	87	A
Knutsford (Bus Station)	87	B
Knutsford (Railway Station)	87	B
Macclesfield	87	A
Macclesfield General Hospital	87	A
Mobberley	87*	B
Monks Heath	87	A
Morley Green	87*	B
Ollerton	87	B
Over Peover	87	B
Peover Heath	87	B
Shaw Heath	87*	B
Upton Priory	87	A
Wilmslow (Bank Square and Railway Station)	87*	B

Notes

Bus route 87 operates a daytime service on Mondays to Saturdays, only.
 For bus times and days of operation please contact Traveline on www.traveline.info or call: 0871 200 22 33
 * To this destination bus route 87 becomes linked bus 88, from Knutsford - through fares and connections are available.

Taxis

Chelford Station has no taxi rank or cab office. Advance booking is essential, please consider using the following local operators: (Inclusion of this number doesn't represent any endorsement of the taxi firm)

Knutsford Taxis (Knutsford)
01565 740 540

AB Cabs (Knutsford)
07473 366 888

Goostrey Private Hire
01477 535 060

Further information about all onward travel

Local Cycle Info cheshireast.gov.uk <small>For more information about cycle routes.</small>	National Cycle Info walkwheelcycletrust.org.uk	Bus Times <small>See timetable displays at bus stops.</small> www.traveline.info 0871 200 22 33 <small>calls cost 13p per minute plus your phone company's access charge</small>	PlusBus plusbus.info <small>PlusBus is a discount price 'bus pass' that you buy with your train ticket. It gives you unlimited bus travel around your chosen town, on participating buses. Visit www.plusbus.info</small>
--	--	--	--

National Rail Enquiries

Online nationalrail.co.uk	NRE App Free National Rail Enquiries app for iOS and Android	Social Media facebook.com/nationalrailenq @nationalrailenq	Alert Me <small>You can sign up to Alert Me messages on the National Rail Enquiries website where you can receive train and platform notifications directly to your smart phone.</small> nationalrail.co.uk/alertme	Contact Centre 03457 48 49 50 <small>Calls cost no more than calls to geographic numbers (01 or 02) and may be recorded.</small>	PlusBike nationalrail.co.uk/plusbike <small>For more information.</small>
---	---	--	--	--	---



This poster shows details of popular destinations and main, frequent bus routes. Additional services may run, so please check with Traveline or see posters at local bus stops. Whilst considerable care has been taken to ensure the information contained on this poster is correct and accurate, National Rail cannot accept responsibility for any loss or inconvenience caused by any errors or omissions, or for loss, damage, injury or inconvenience relating to the cancellation, alteration, delay or diversion of a service. For any feedback, please e-mail comments@onwardtravelposters.com

Scan this code with your mobile for full station information.