

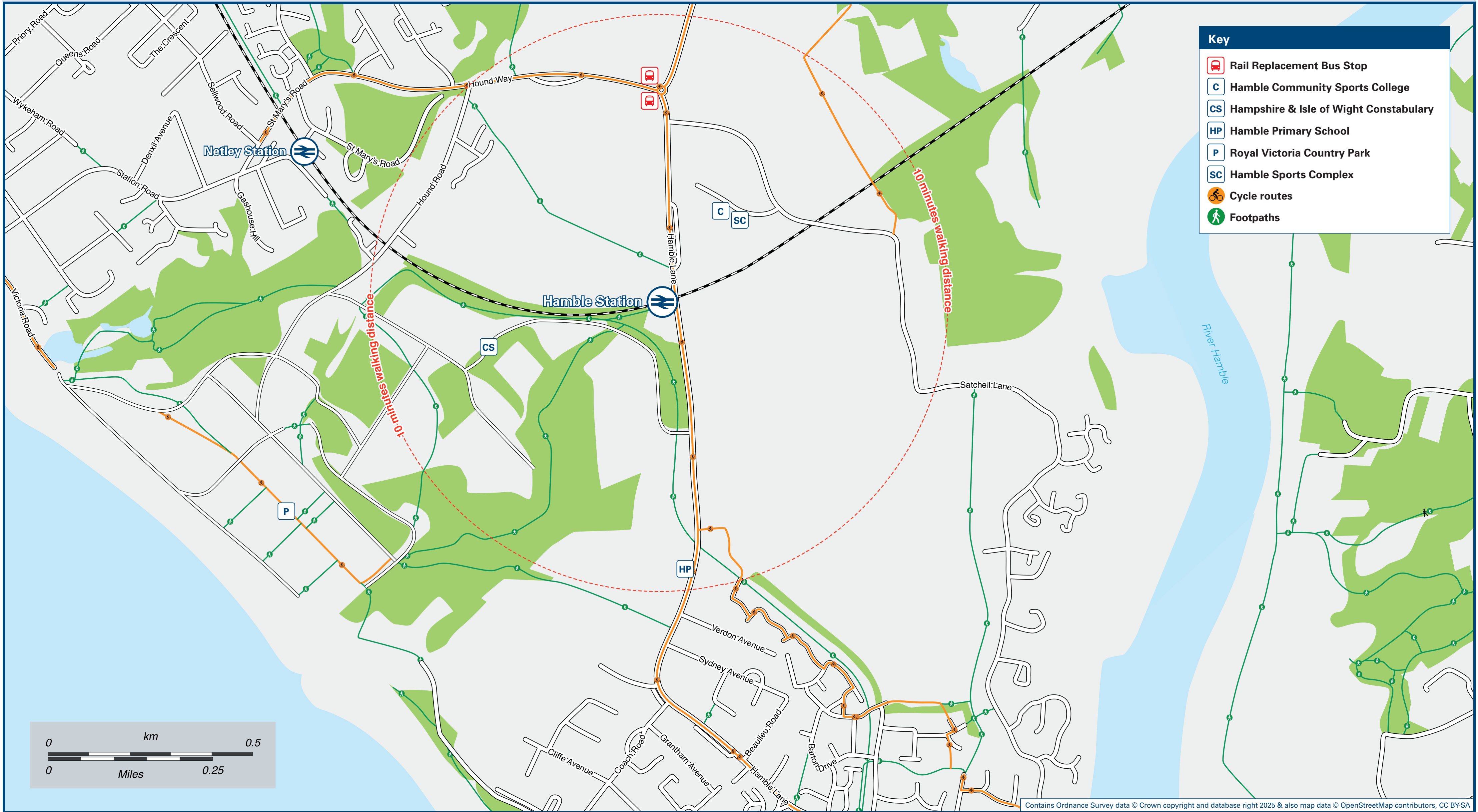

Hamble Station

Onward Travel Information

Local area map



Buses

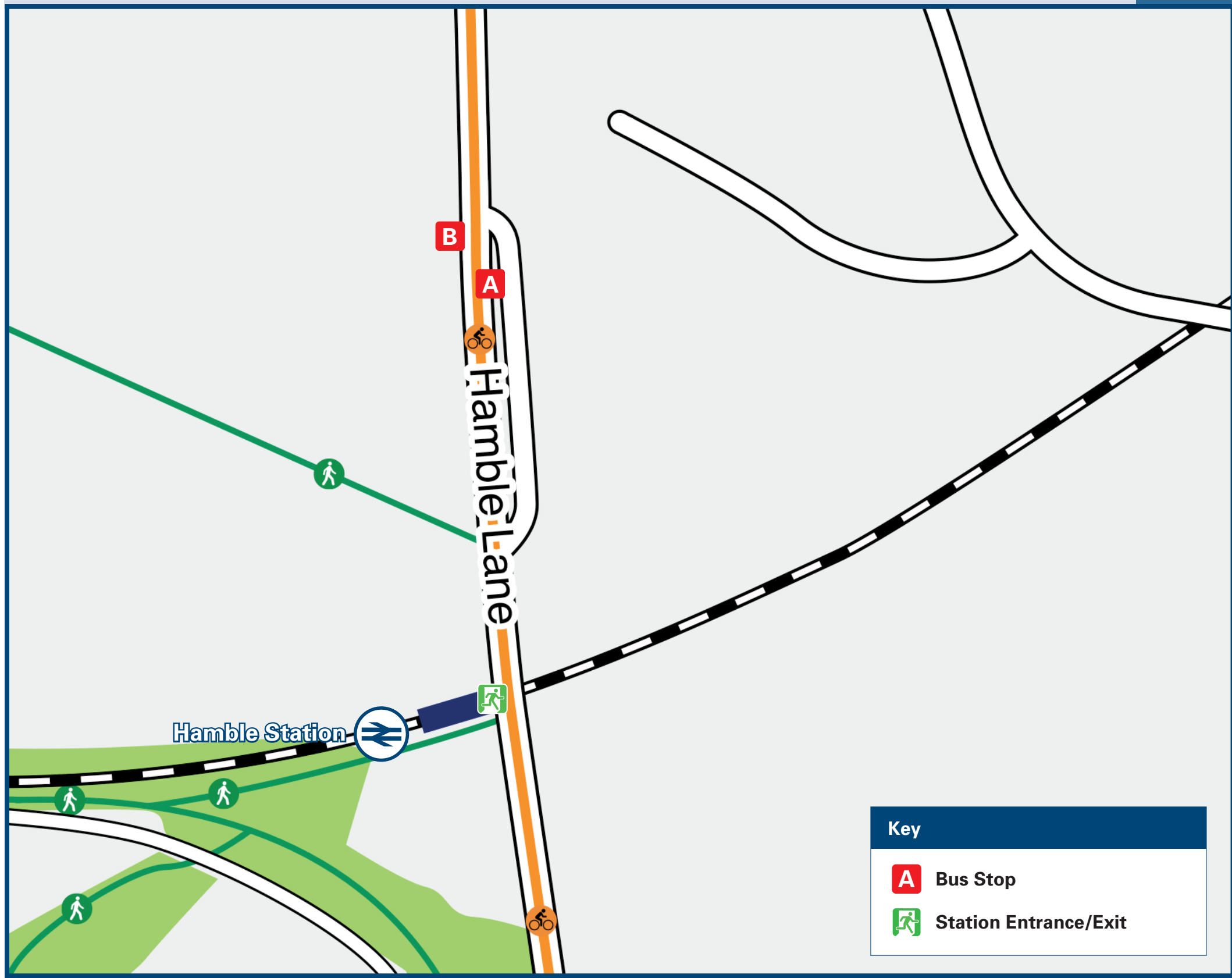

Rail replacement buses depart from Hound Corner, at the junction of Hound Road and Hamble Lane.

Main destinations by bus

(Data correct at November 2025)

DESTINATION	BUS ROUTES	BUS STOP
Butlocks Heath	15	B
Hamble-le-Rice Village	15	A
Netley Station	15	B
Netley Village & Abbey	15	B
Ocean Village (Itchen Bridge West)	15	B
Southampton City Centre	15	B
Weston (Wright's Hill)	15	B
Woolston	15	B

Notes

Bus route 15 operates a daily service, Mondays to Sundays.
For bus times and days of operation please contact Traveline on www.traveline.info or call: 0871 200 22 33
Direct trains operate to this destination from this station.

Taxis

Hamble Station has no taxi rank or cab office. Advance booking is essential, please consider using the following local operators: (Inclusion of this number doesn't represent any endorsement of the taxi firm)

Viking Cars
023 8040 6633

Radio Taxis
023 8066 6666

Aero Taxis
023 8001 0203

Further information about all onward travel

Local Cycle Info

eastleigh.gov.uk

For more information about cycle routes.

National Cycle Info

walkwheelcycletrust.org.uk

Bus Times

See timetable displays at bus stops.

www.traveline.info
0871 200 22 33
call cost 15p per minute
plus your phone company's access charge

PlusBus

plusbus.info

PlusBus is a discount price 'bus pass' that you buy with your train ticket. It gives you unlimited bus travel around your chosen town, on participating buses. Visit www.plusbus.info

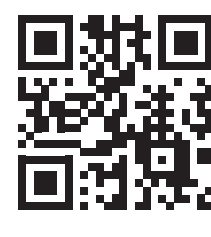

National Rail Enquiries

Online

nationalrail.co.uk

NRE App

Free National Rail Enquiries app for iOS and Android

Social Media

[facebook.com/nationalrailenq](https://www.facebook.com/nationalrailenq)
[@nationalrailenq](https://twitter.com/nationalrailenq)

Alert Me

You can sign up to Alert Me messages on the National Rail Enquiries website where you can receive train and platform notifications directly to your smart phone.
nationalrail.co.uk/alertme

Contact Centre

03457 48 49 50
Calls cost no more than calls to geographic numbers (01 or 02) and may be recorded.

PlusBike

nationalrail.co.uk/plusbike
For more information.



South Western
Railway



National Rail
Britain's train companies working together

