

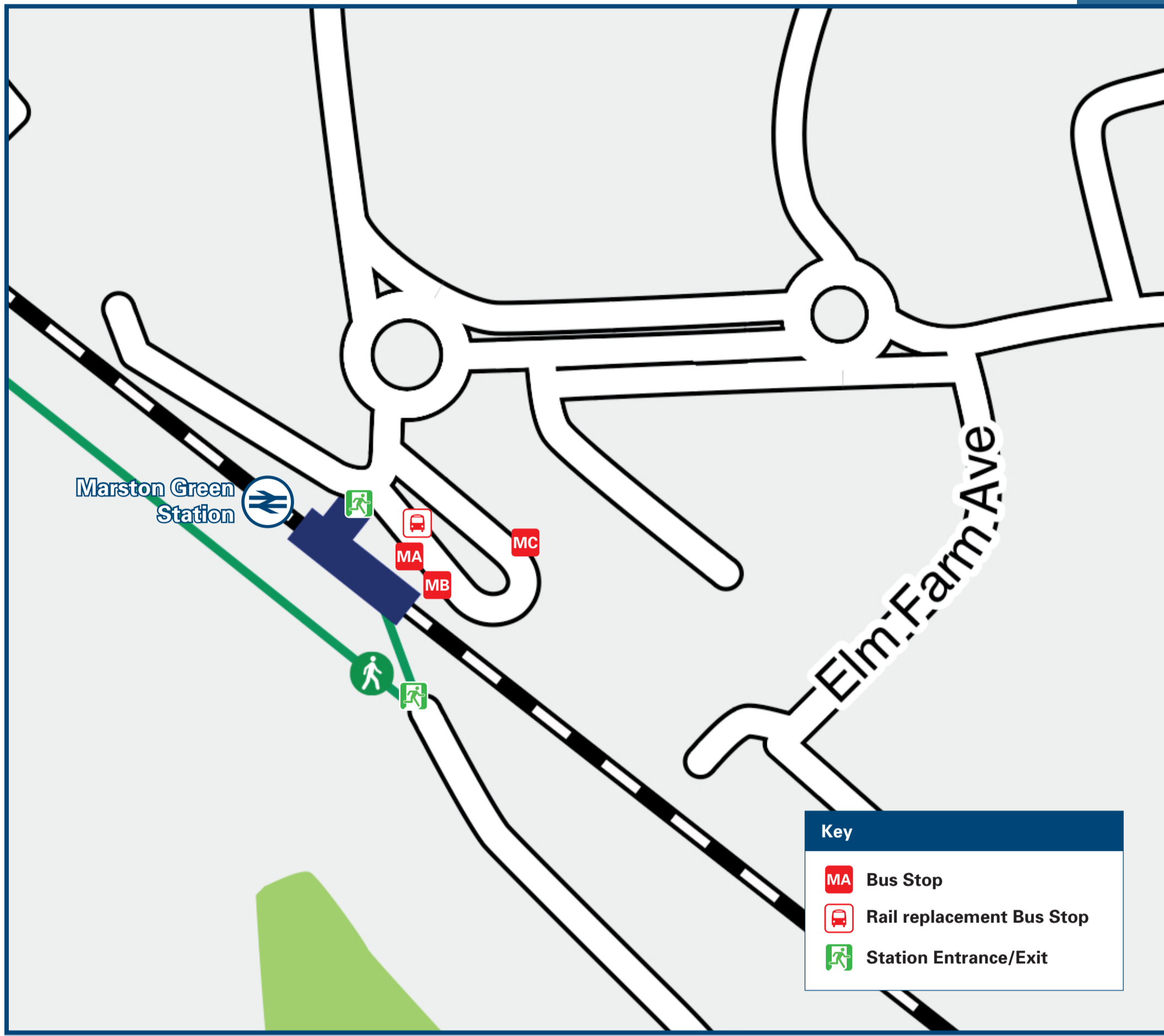

Marston Green Station

Onward Travel Information

Buses



Rail replacement buses/coaches will collect from outside the station front at the public service bus stops (MA & MB)

Local area map

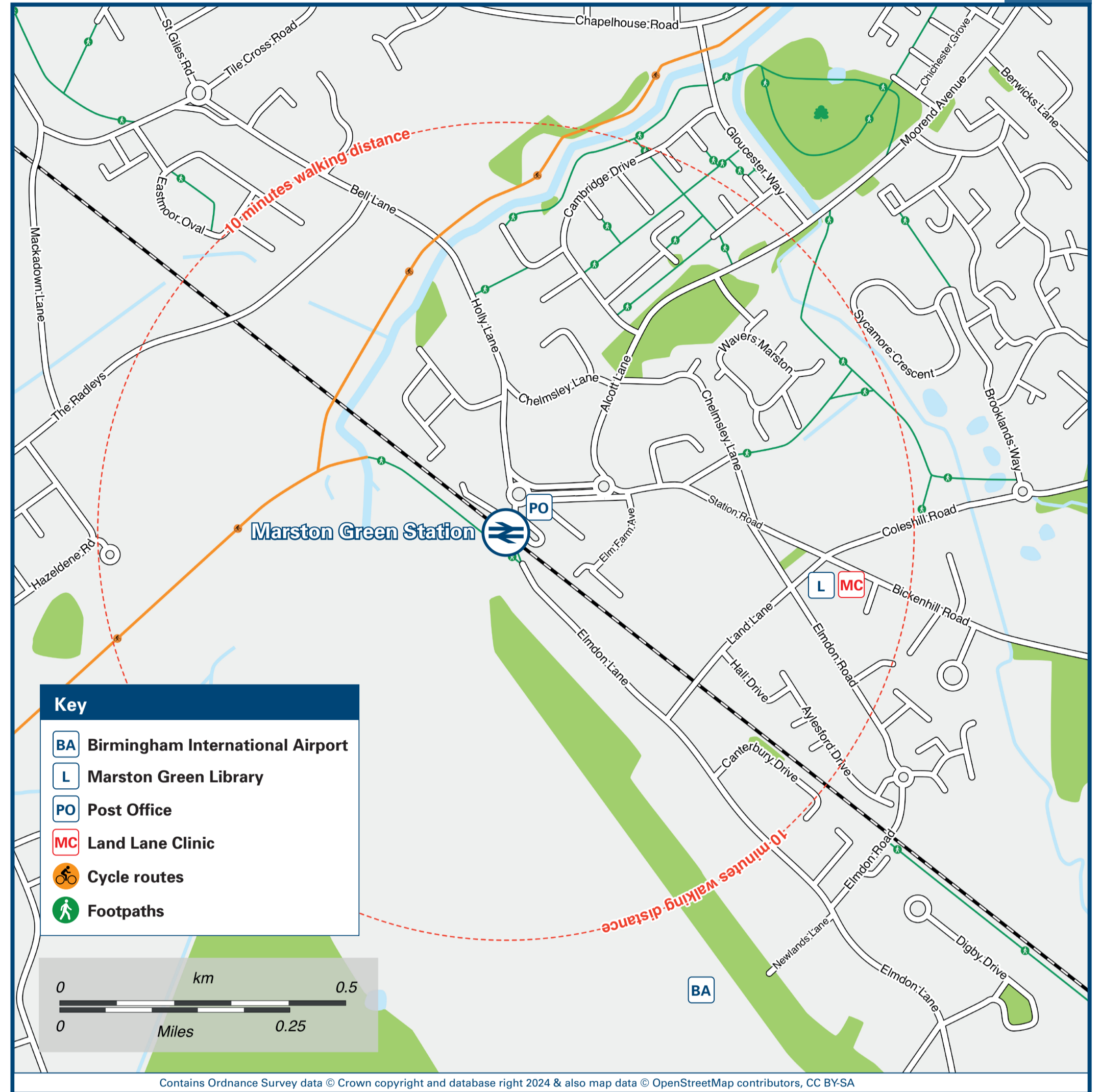

Main destinations by bus

(Data correct at July 2024)



DESTINATION	BUS ROUTES	BUS STOP	DESTINATION	BUS ROUTES	BUS STOP	DESTINATION	BUS ROUTES	BUS STOP
Chelmsley Wood (Interchange)	72, A10#	MA, MB	Lea Hall	72	MA	Solihull (Town Centre)	72, A10#	MA
Cranes Park	A10#	MA	Lode Heath	72, A10#	MA	Tile Cross	72, A10#	MA
Elmdon	A10#	MA	Lyndon Green	72, A10#	MA			
Garretts Green	72, A10#	MA	Sheldon	72, A10#	MA			
Hobs Moat	72, A10#	MA	Solihull Hospital	72, A10#	MA			
Kitt's Green	72	MA	Solihull (Station Interchange)	72	MA			

Notes

Bus route 72 runs everyday, Mondays to Sundays.
 Connections for buses around Birmingham are available from Chelmsley Wood or Solihull Interchanges.
 Direct trains operate to this destination from this Station.
 # Bus route A10 runs a limited daytime service Mondays to Saturdays, only. No Sunday service.

Taxis

Marston Green Station has no taxi rank or cab office. Advance booking is essential, please consider using the following local operators: (Inclusion of this number doesn't represent any endorsement of the taxi firm)

VEEZU
0121 744 1111

Local Radio Cars
0121 770 7707

247 Radio Carz
0121 222 2222

Further information about all onward travel

Local Cycle Info www.tfwm.org.uk/plan-your-journey/ways-to-travel/cycling-and-walking For more information about cycle routes.	National Cycle Info sustrans.org.uk Sustrans is the UK's leading sustainable transport charity.	Bus Times See timetable displays at bus stops. www.traveline.info 0871 200 22 33 calls cost 12p per minute plus your phone company's access charge	NextBuses Find the bus times for your stop. Search for a bus stop by entering a postcode, street & town or a stop name & town.	PlusBus plusbus.info A discount price 'bus pass' that you buy with your train ticket. It gives you unlimited bus travel around your chosen town, on participating buses.
---	---	---	--	--

National Rail Enquiries

Online nationalrail.co.uk	NRE App Free National Rail Enquiries app for iOS and Android	Social Media facebook.com/nationalrailenq @nationalrailenq	Alert Me You can sign up to Alert Me messages on the National Rail Enquiries website where you can receive train and platform notifications directly to your smart phone. nationalrail.co.uk/alertme	Contact Centre 03457 48 49 50 Calls cost no more than calls to geographic numbers (01 or 02) and may be recorded.	PlusBike nationalrail.co.uk/plusbike For more information.
---	--	---	---	--	--



This poster shows details of popular destinations and main, frequent bus routes. Additional services may run, so please check with Traveline or see posters at local bus stops. Whilst considerable care has been taken to ensure the information contained on this poster is correct and accurate, National Rail cannot accept responsibility for any loss or inconvenience caused by any errors or omissions, or for loss, damage, injury or inconvenience relating to the cancellation, alteration, delay or diversion of a service. For any feedback, please e-mail comments@onwardtravelposters.com

Scan this code with your mobile for full station information.