

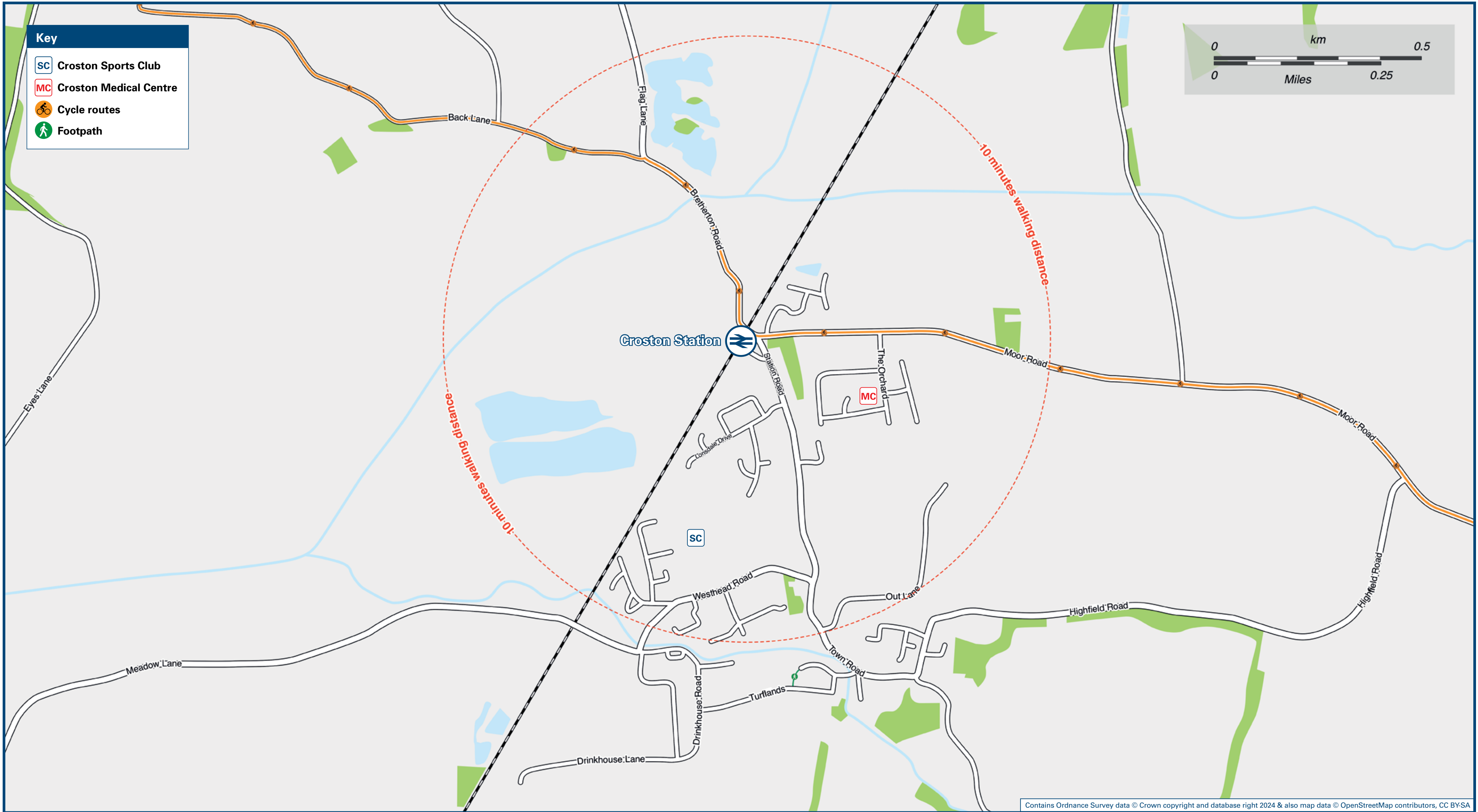

Croston Station

Onward Travel Information

Local area map



Buses

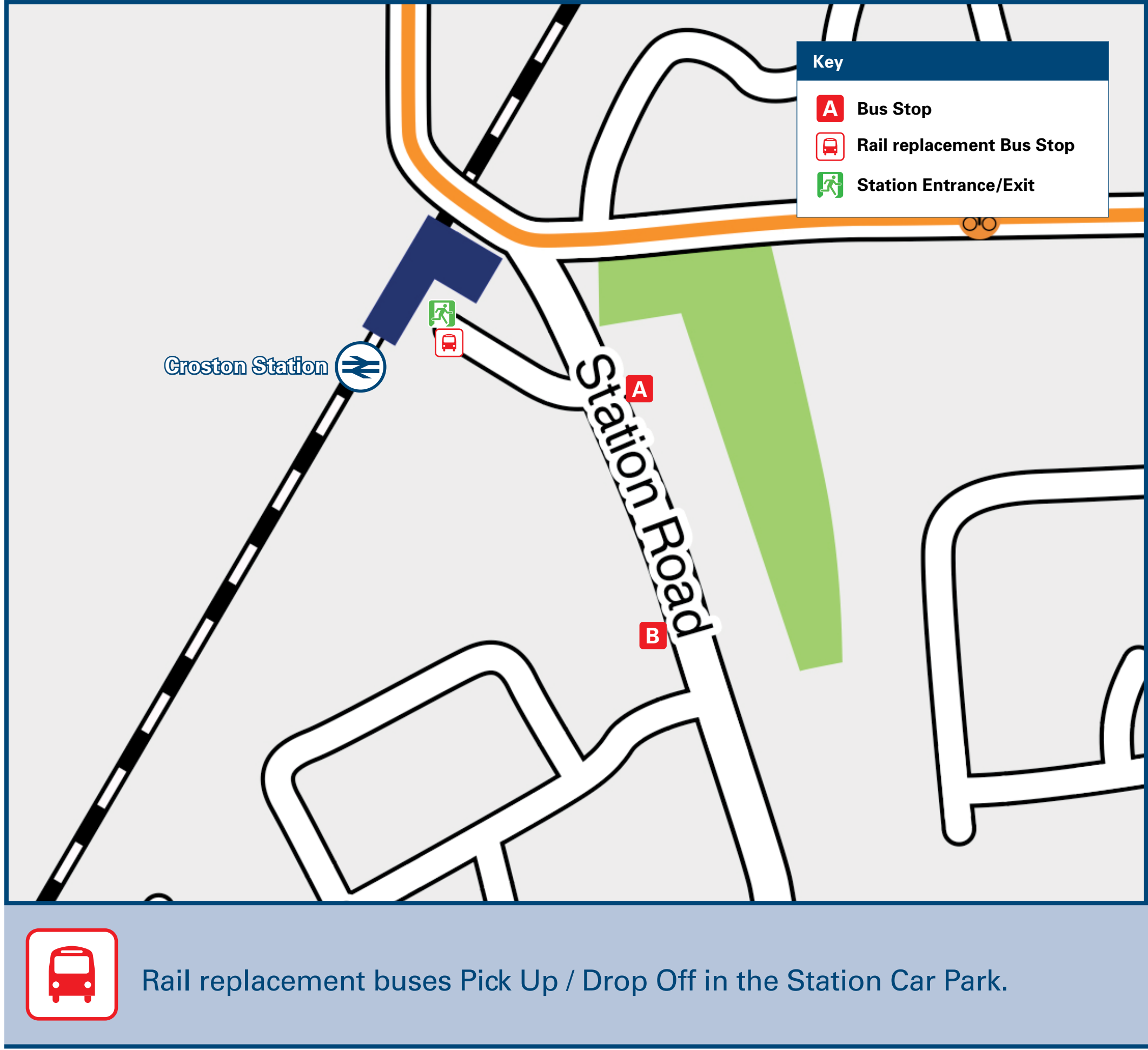

Main destinations by bus

(Data correct at October 2024)

DESTINATION	BUS ROUTES	BUS STOP
Bamber Bridge	112	A
Burscough Bridge	337	A
Charnock	337, 347	B
Chorley	337, 347	B
Clayton Green	112	A
Clayton-le-Woods	112	A
Crossens	347	A
Earnshaw Bridge	112	A
Eccleston	337, 347	B
Leyland	112	A
Mawdesley	337, 347	A
Moss Side	112	A
Newburgh	337	A
Ormskirk	337	A
Parbold	337	A
Preston	112	A
Rufford	347	A
Southport	347	A
Towngate	112	A
Ulnes Walton	112	A
Walton-le-Dale	337, 347	B
Walton Summit	112	A

Notes

Bus routes 112, 337 and 347 operate Mondays to Saturdays.
For bus times please see bus stop timetables or contact Traveline on 0871 200 22 33.
Direct trains operate to this destination from this station.

Taxis

Croston Station has no taxi rank or cab office. Advance booking is essential, please consider using the following local operators: (Inclusion of this number doesn't represent any endorsement of the taxi firm)

1st Choice Cars
01772 600 489

Tarleton Direct Cabs
01772 816 667

Yellow Cabs (Chorley)
01257 266 566

Further information about all onward travel

Local Cycle Info	National Cycle Info	Bus Times	NextBuses	PlusBus
chorley.gov.uk For more information about cycle routes.	sustrans.org.uk Sustrans is the UK's leading sustainable transport charity.	See timetable displays at bus stops. www.traveline.info 0871 200 22 33 call cost 15p per minute plus your phone company's access charge	Find the bus times for your stop. Search for a bus stop by entering a postcode, street & town or a stop name & town.	plusbus.info A discount price 'bus pass' that you buy with your train ticket. It gives you unlimited bus travel around your chosen town, on participating buses.

National Rail Enquiries

Online	NRE App	Social Media	Alert Me	Contact Centre	PlusBike
nationalrail.co.uk	Free National Rail Enquiries app for iOS and Android	facebook.com/nationalrailenq @nationalrailenq	You can sign up to Alert Me messages on the National Rail Enquiries website where you can receive train and platform notifications directly to your smart phone. nationalrail.co.uk/alertme	03457 48 49 50 Calls cost no more than calls to geographic numbers (01 or 02) and may be recorded.	nationalrail.co.uk/plusbike For more information.



This poster shows details of popular destinations and main, frequent bus routes. Additional services may run, so please check with Traveline or see posters at local bus stops. Whilst considerable care has been taken to ensure the information contained on this poster is correct and accurate, National Rail cannot accept responsibility for any loss or inconvenience caused by any errors or omissions, or for loss, damage, injury or inconvenience relating to the cancellation, alteration, delay or diversion of a service. For any feedback, please e-mail comments@onwardtravelposters.com

Scan this code with your mobile for full station information.