

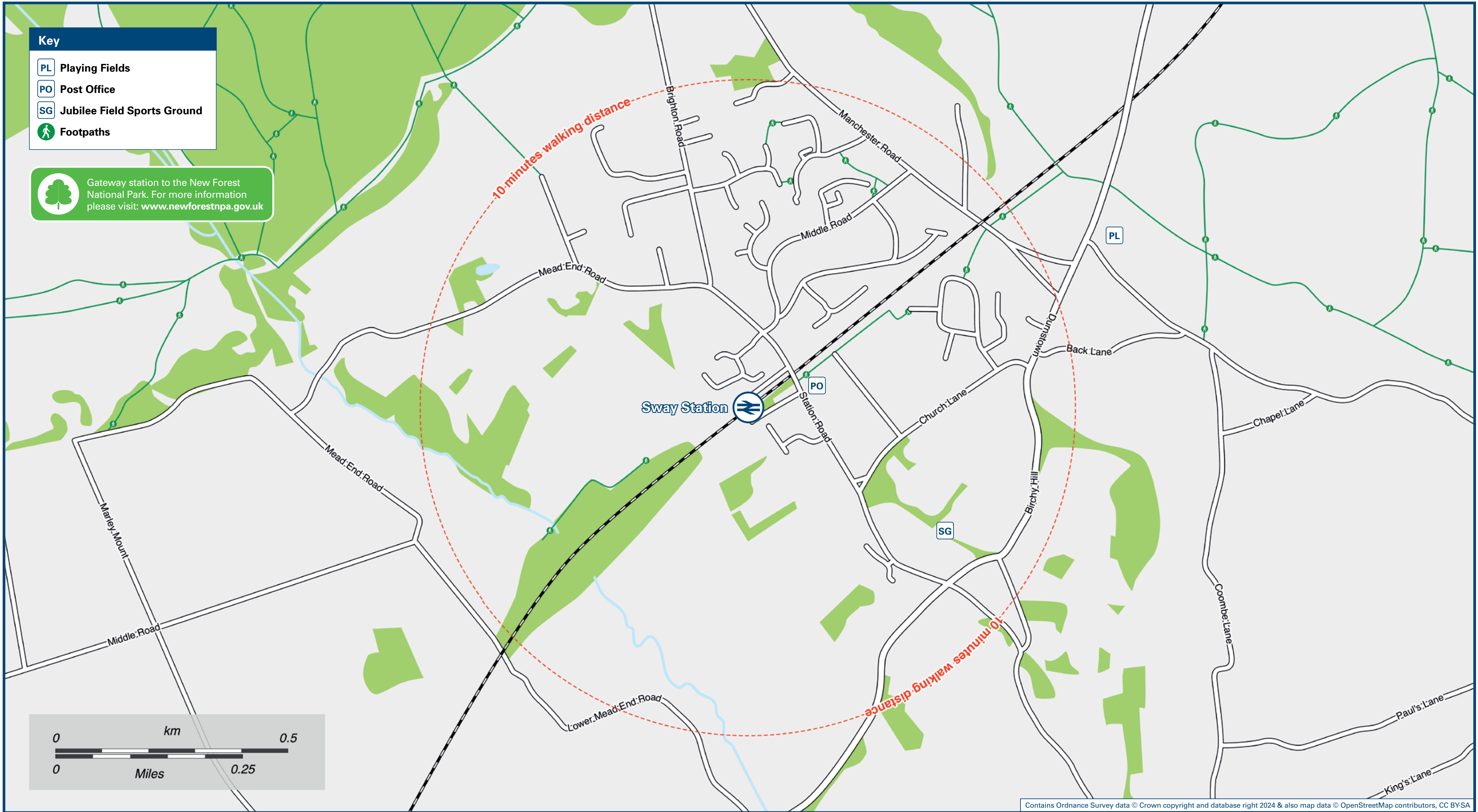

Sway Station

Onward Travel Information

Local area map



Buses

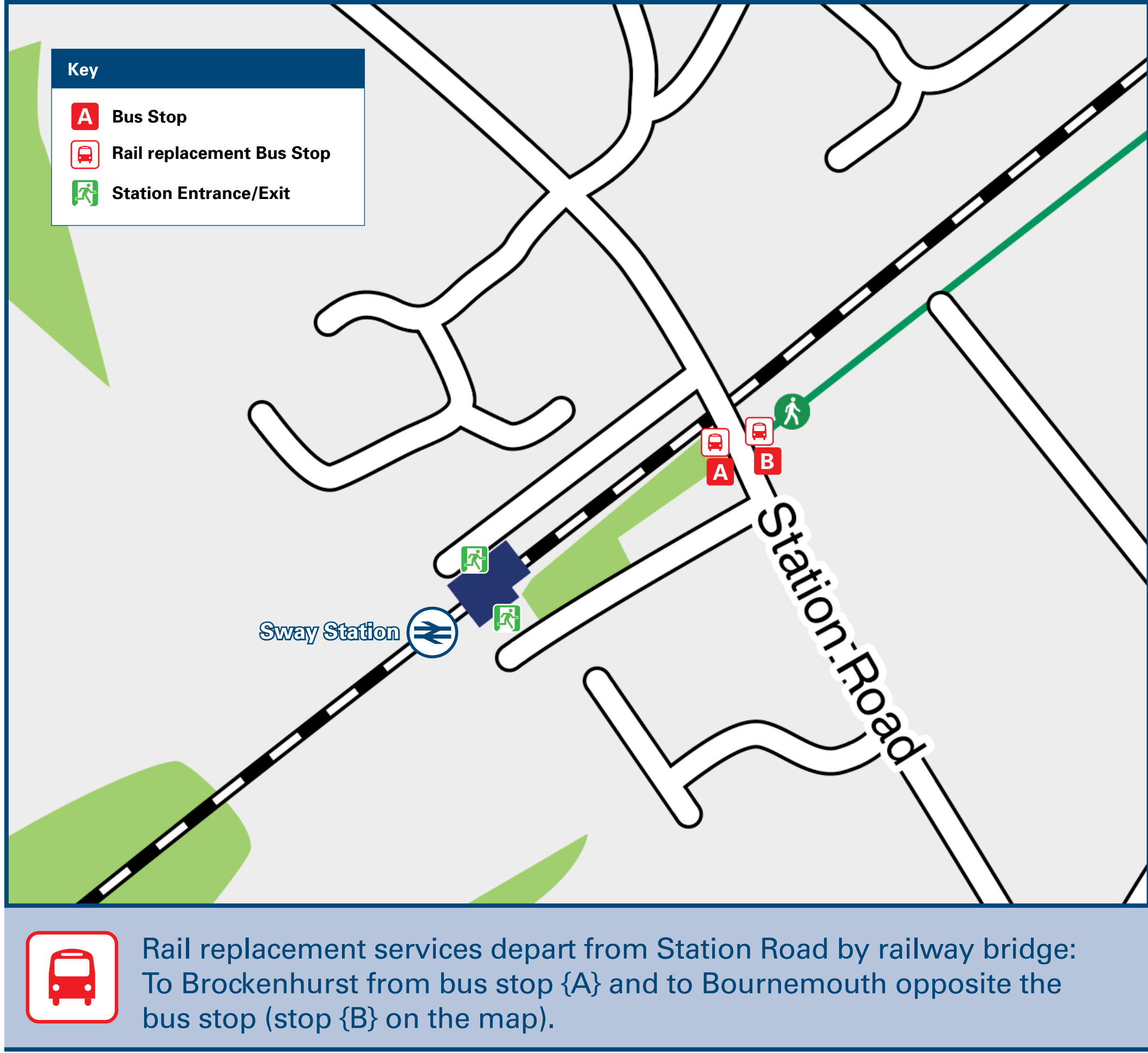

Main destinations by bus

DESTINATION	BUS ROUTES	BUS STOP
Bashley (Village Store & Post Office)	120	A
Bowling Green Village	120	B
Lower Buckland (May Avenue)	120	B
Lymington (Town Centre)	120	B
Lymington New Forest Hospital	120	B
Mount Pleasant	120	B
New Milton	120	A
Tiptoe	120	A

Notes

Bus route 120 operates a limited service Mondays to Saturdays only. For bus times and further information contact Traveline on 0871 200 22 33 or morebus (for bus route 120) call 01202 338 420.

- Direct trains operate to this destination from this station.
- Change trains at Brockenhurst for Lymington.

Taxis

Sway station has neither a taxi rank nor a cab office. Advance booking is essential. Please consider using the following local operators: (Inclusion of this number doesn't represent any endorsement of the taxi firm)

Angel Cars
01425 621 682

Ashley Cars
01425 600 000

1st Choice Private Hire
01425 619 922

Further information about all onward travel

Local Cycle Info newforest.gov.uk For more information about cycle routes.	National Cycle Info sustrans.org.uk Sustrans is the UK's leading sustainable transport charity.	Bus Times See timetable displays at bus stops. www.traveline.info 0871 200 22 33 calls cost 15p per minute plus your phone company's access charge	NextBuses Find the bus times for your stop. Search for a bus stop by entering a postcode, street & town or a stop name & town.	PlusBus plusbus.info A discount price 'bus pass' that you buy with your train ticket. It gives you unlimited bus travel around your chosen town, on participating buses.
---	--	---	---	---

National Rail Enquiries

Online nationalrail.co.uk	NRE App Free National Rail Enquiries app for iOS and Android	Social Media facebook.com/nationalrailenq @nationalrailenq	Alert Me You can sign up to Alert Me messages on the National Rail Enquiries website where you can receive train and platform notifications directly to your smart phone. nationalrail.co.uk/alertme	Contact Centre 03457 48 49 50 Calls cost no more than calls to geographic numbers (01 or 02) and may be recorded.	PlusBike nationalrail.co.uk/plusbike For more information.
-------------------------------------	--	---	---	--	---



National Rail
Britain's train companies working together

