

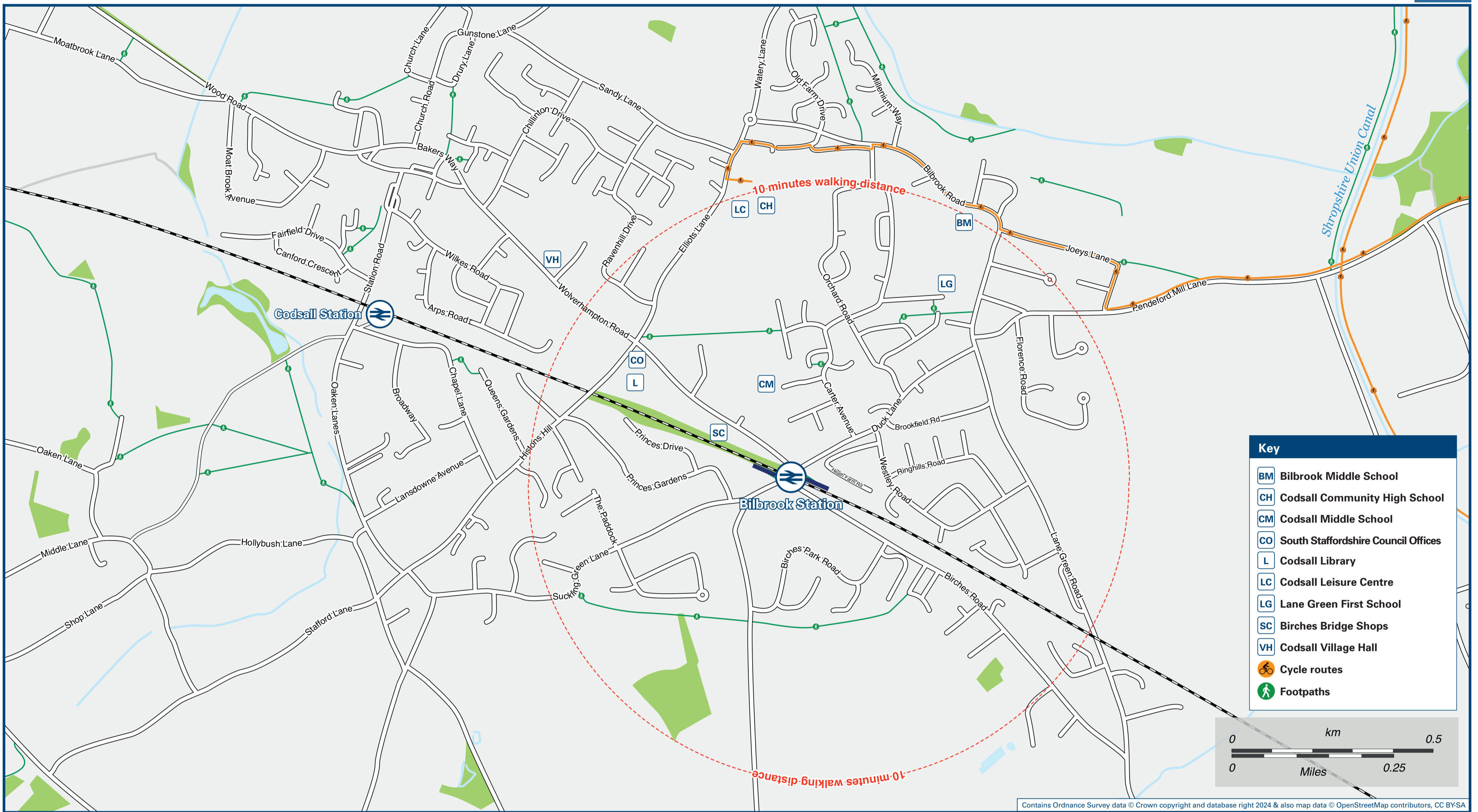

# Bilbrook Station

# Onward Travel Information

## Local area map



## Buses

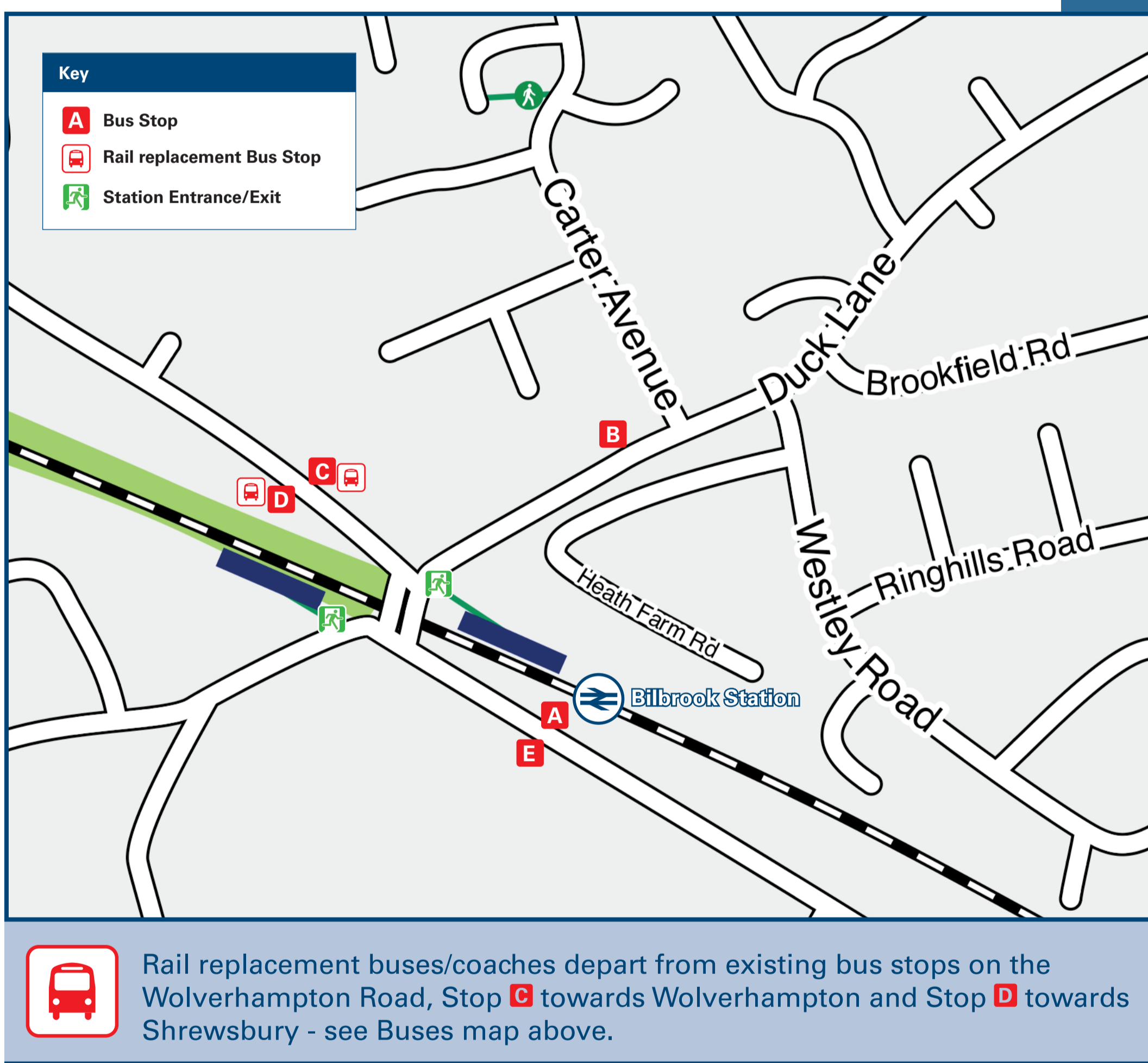

## Main destinations by bus

(Data correct at July 2024)

DESTINATION	BUS ROUTES	BUS STOP
Aldersley	5, 5A	A
	5A	C
Bilbrook (Bilbrook Road)	5	B, E
Claregate	5, 5A	A
	5A	C
Codsall (Bakers Way/Church Road)	5	B, E
	5A	D, E
Codsall Leisure Centre (Elliotts Lane)	5	B, E
Dunstall Hill (Five Ways)	5A	A, C
Palmers Cross	5, 5A	A
	5A	C
Whitmore Reans	5, 5A	A
	5A	C
Wolverhampton	5, 5A	A
	5A	C

### Notes

Bus route 5 operates daily including evenings, Sundays and Bank Holidays.  
 Bus route 5A operates daytime and early evenings Mondays to Saturdays only.  
 For bus times and further information contact Traveline on 0871 200 22 33 or Banga Buses (for bus routes 5 & 5A daytime Mondays to Saturdays) www.bangabuses.co.uk or call 07472 634 061 or Chaserider Buses (for bus route 5 Monday to Saturday evenings and all day on Sundays & Bank Holidays) www.chaserider.co.uk or call 01543 758 594.  
 Direct trains operate to this destination from this station.

## Taxis

Bilbrook Station has no taxi rank or cab office. Advance booking is essential, please consider using the following local operators: (Inclusion of this number doesn't represent any endorsement of the taxi firm)

**ABC Cars**  
01902 333 333

**Bilbrook Cars**  
01902 845 723

**Parkway Cars**  
01902 213 424

## Further information about all onward travel

<b>Local Cycle Info</b> <a href="http://staffordshire.gov.uk">staffordshire.gov.uk</a> For more information about cycle routes.	<b>National Cycle Info</b> <a href="http://sustrans.org.uk">sustrans.org.uk</a> Sustrans is the UK's leading sustainable transport charity.	<b>Bus Times</b> See timetable displays at bus stops. <a href="http://www.traveline.info">www.traveline.info</a> 0871 200 22 33 <small>calls cost 13p per minute plus your phone company's access charge</small>	<b>NextBuses</b> <b>Find the bus times for your stop.</b> Search for a bus stop by entering a postcode, street & town or a stop name & town.	<b>PlusBus</b> <a href="http://plusbus.info">plusbus.info</a> A discount price 'bus pass' that you buy with your train ticket. It gives you unlimited bus travel around your chosen town, on participating buses.
---	---	--	--	---

## National Rail Enquiries

<b>Online</b> <a href="http://nationalrail.co.uk">nationalrail.co.uk</a>	<b>NRE App</b> Free National Rail Enquiries app for iOS and Android	<b>Social Media</b> <a href="https://facebook.com/nationalrailenq">facebook.com/nationalrailenq</a> @nationalrailenq	<b>Alert Me</b> You can sign up to Alert Me messages on the National Rail Enquiries website where you can receive train and platform notifications directly to your smart phone. <a href="http://nationalrail.co.uk/alertme">nationalrail.co.uk/alertme</a>	<b>Contact Centre</b> 03457 48 49 50 Calls cost no more than calls to geographic numbers (01 or 02) and may be recorded.	<b>PlusBike</b> <a href="http://nationalrail.co.uk/plusbike">nationalrail.co.uk/plusbike</a> For more information.
---	--	--	---	--	--



This poster shows details of popular destinations and main, frequent bus routes. Additional services may run, so please check with Traveline or see posters at local bus stops. Whilst considerable care has been taken to ensure the information contained on this poster is correct and accurate, National Rail cannot accept responsibility for any loss or inconvenience caused by any errors or omissions, or for loss, damage, injury or inconvenience relating to the cancellation, alteration, delay or diversion of a service. For any feedback, please e-mail [comments@onwardtravelposters.com](mailto:comments@onwardtravelposters.com)

Scan this code with your mobile for full station information.