

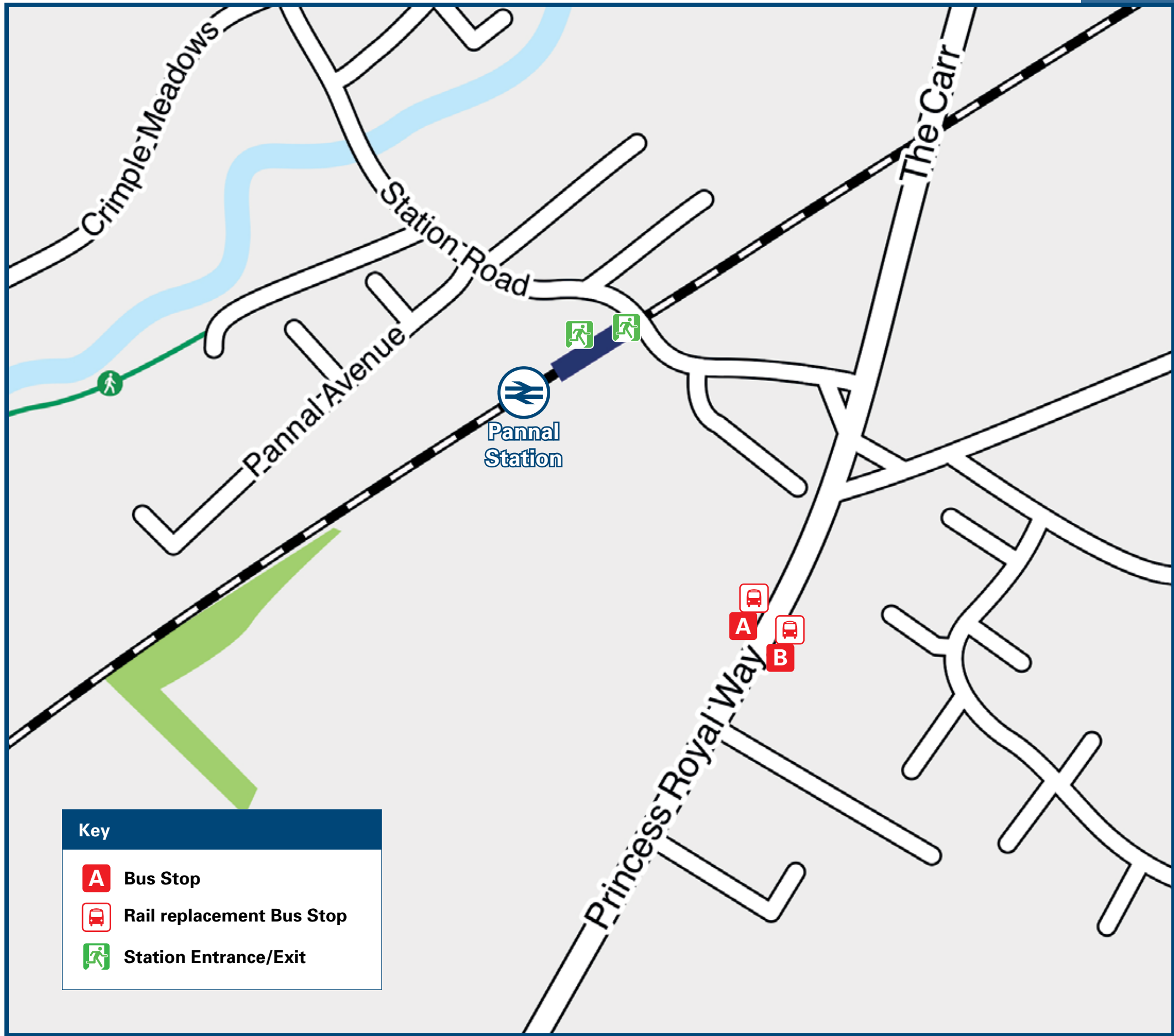

Pannal Station

Onward Travel Information

Buses



Rail replacement transport pick up/drop off at bus stops on the main road (outside the BMW Garage for Harrogate and opposite for Leeds).

Local area map

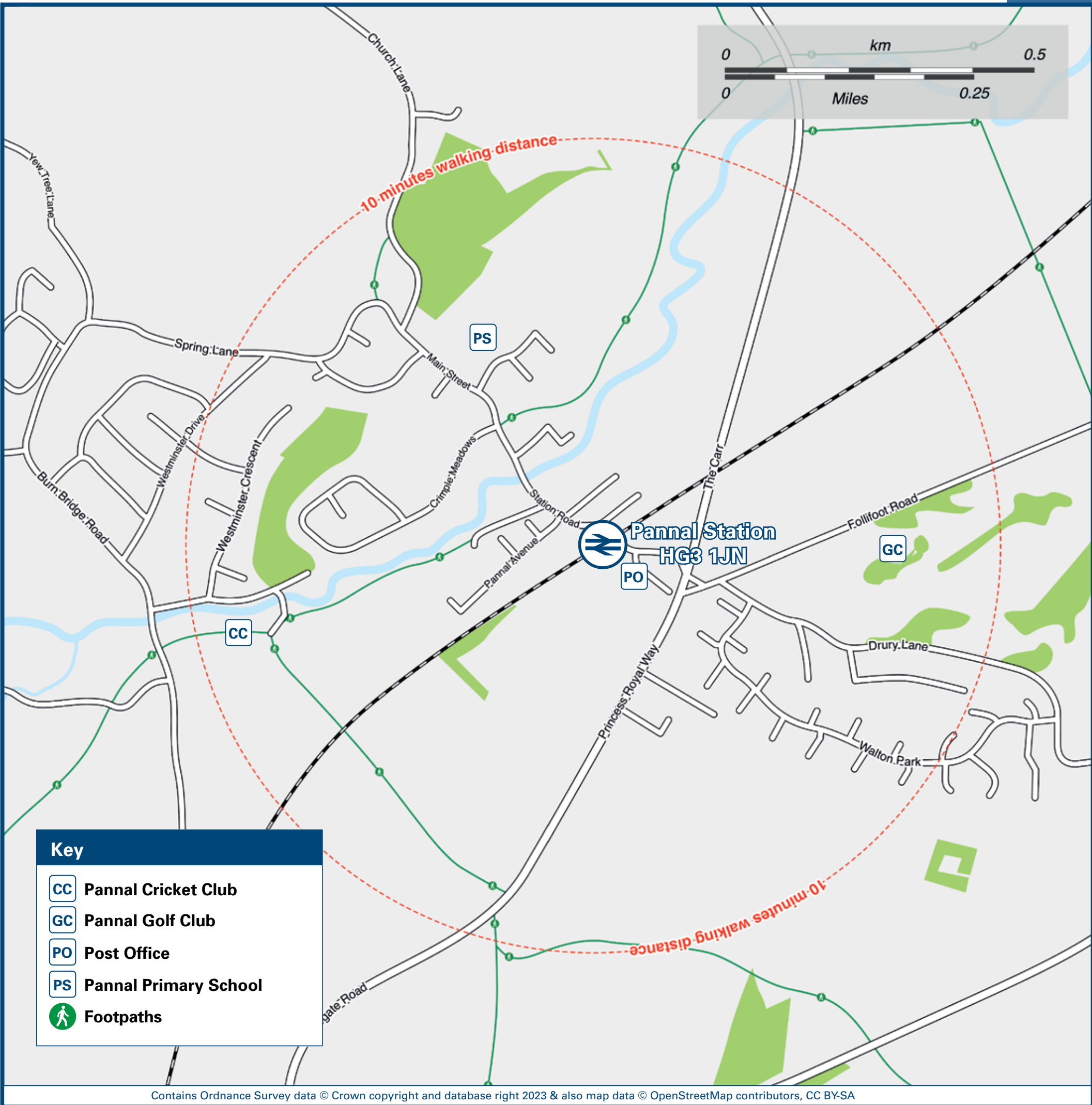

Main destinations by bus

(Data correct at October 2024)



DESTINATION	BUS ROUTES	BUS STOP
Bradford (Interchange)	A2	B
Harewood (for Harewood House)	36	B
Harrogate	36, A2, X52	A
Huby Weeton	A2, X52	B
Killinghall	36	A
Leeds Bradford International Airport	A2	B

DESTINATION	BUS ROUTES	BUS STOP
Leeds (City Centre)	36	B
Moortown	36	B
Oatlands	36, A2, X52	A
Otley	X52	B
Pool	A2, X52	B
Ripley	36	A

DESTINATION	BUS ROUTES	BUS STOP
Ripon	36	A
South Stainley	36	A
Wormald Green	36	A
Yeadon	A2	B

Notes

Bus routes 36 and A2 operate daily.
Bus route X52 operates Mondays to Saturdays.
For bus times please see bus stop timetables or contact Traveline.
Direct trains operate to this destination from this station.

Taxis

Pannal Station has no taxi rank or cab office. Advance booking is essential, please consider using the following local operators: (Inclusion of this number doesn't represent any endorsement of the taxi firm)

Blueline Taxis
01423 530 830

Harrogate Private Hire
01423 870 010

Yellow Line Taxis
01423 521 531

Further information about all onward travel

Local Cycle Info

www.northyorks.gov.uk/roads-parking-and-travel/roads-and-pavements/cycle-lanes-and-routes
For more information about cycle routes.

National Cycle Info

sustrans.org.uk
Sustrans is the UK's leading sustainable transport charity.

Bus Times

See timetable displays at bus stops.

www.traveline.info
0871 200 22 33
calls cost 15p per minute plus your phone company's access charge

NextBuses



Find the bus times for your stop.

Search for a bus stop by entering a postcode, street & town or a stop name & town.

PlusBus



plusbus.info

A discount price 'bus pass' that you buy with your train ticket. It gives you unlimited bus travel around your chosen town, on participating buses.

National Rail Enquiries

Online	NRE App	Social Media	Alert Me	Contact Centre	PlusBike
nationalrail.co.uk	Free National Rail Enquiries app for iOS and Android	facebook.com/nationalrailenq @nationalrailenq	You can sign up to Alert Me messages on the National Rail Enquiries website where you can receive train and platform notifications directly to your smart phone. nationalrail.co.uk/alertme	03457 48 49 50 Calls cost no more than calls to geographic numbers (01 or 02) and may be recorded.	nationalrail.co.uk/plusbike For more information.



NORTHERN



National Rail
Britain's train companies working together



This poster shows details of popular destinations and main, frequent bus routes. Additional services may run, so please check with Traveline or see posters at local bus stops. Whilst considerable care has been taken to ensure the information contained on this poster is correct and accurate, National Rail cannot accept responsibility for any loss or inconvenience caused by any errors or omissions, or for loss, damage, injury or inconvenience relating to the cancellation, alteration, delay or diversion of a service. For any feedback, please e-mail comments@onwardtravelposters.com

Scan this code with your mobile for full station information.