

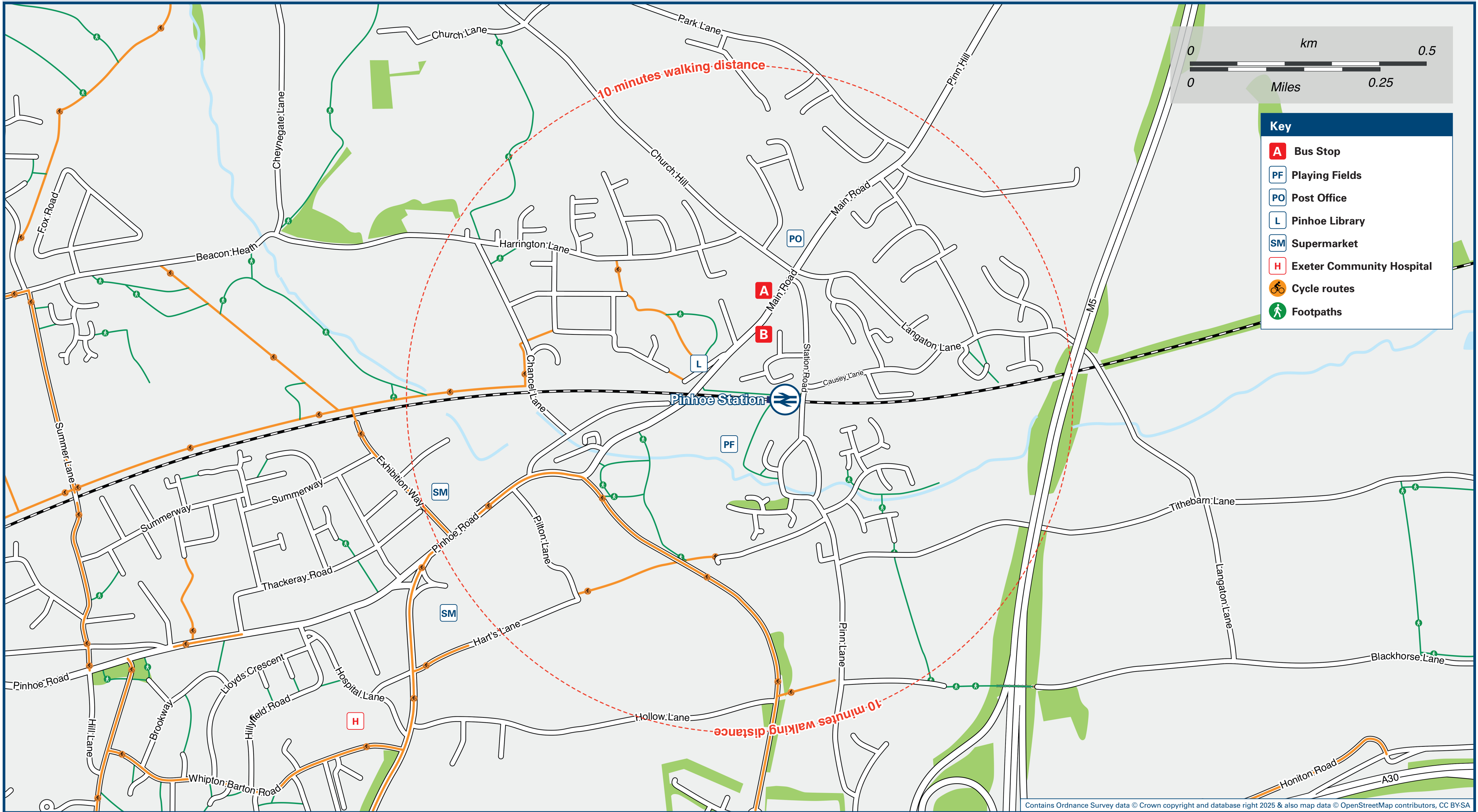

Pinhoe Station

Onward Travel Information

Local area map



Buses

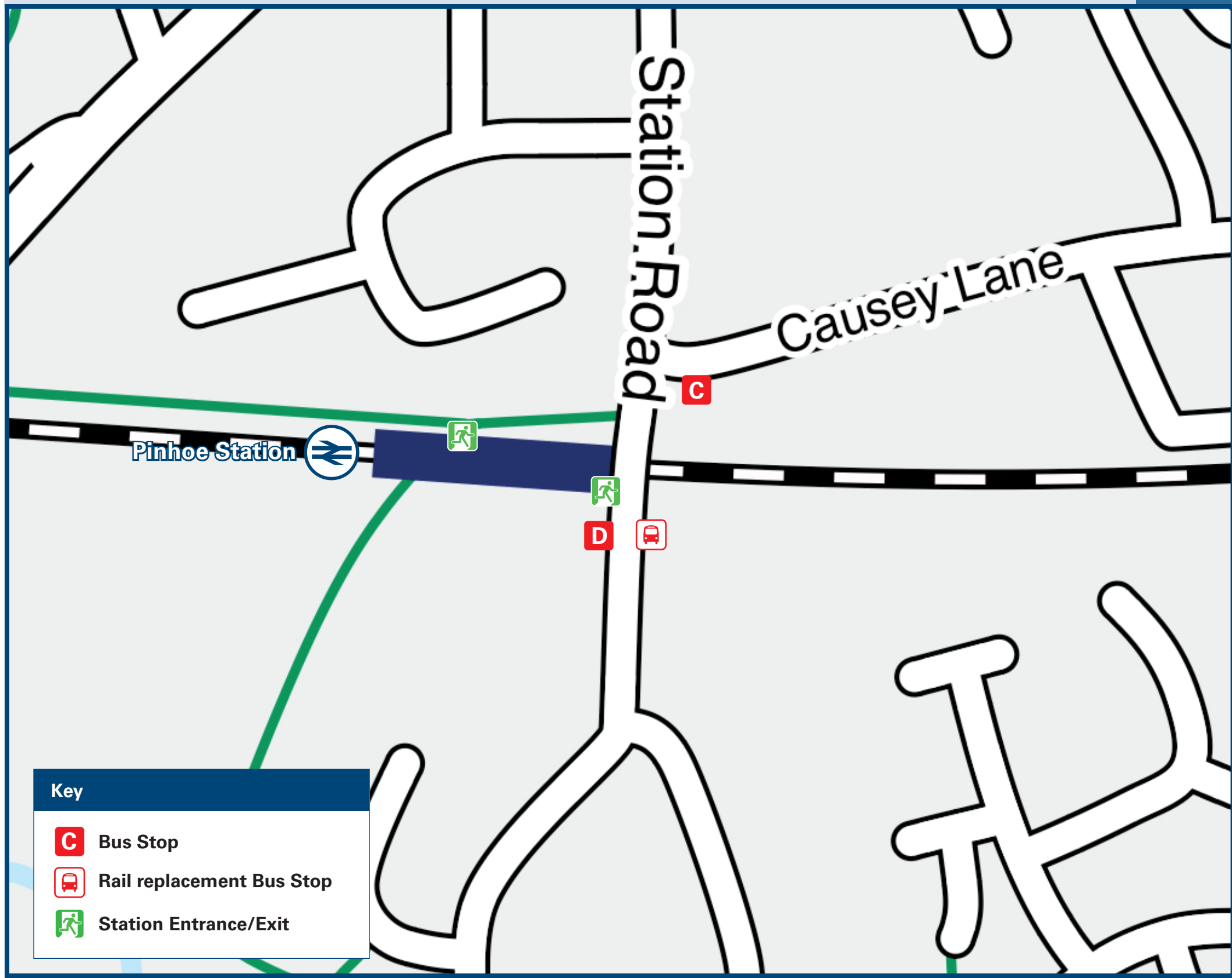

 Rail replacement buses/coaches will depart from Pinn Lane, outside the station entrance.

Main destinations by bus

(Data correct at November 2025)

DESTINATION	BUS ROUTES	BUS STOP
Beacon Heath	P	C
Bradninch	1A	A
Broadclyst	1, 1A	A
Budlake	1, 1A	A
Cullompton	1, 1A	A
Exeter City Centre	P	C
Exeter Community Hospital (nearby)#	1, 1A	B
Halberton	1A	A
St James	P	C
St Thomas	P	C
Stoke Hill	P	C
Tiverton	1A	A
Whipton	1, 1A	B
Willand	1A	A

Notes

Bus route 1 runs a Mondays to Saturdays service, only. No Sunday service.
Bus routes 1A & P run daily services to Exeter.
For bus times and days of operation please contact Traveline on www.traveline.info or call: 0871 200 22 33
☎ Direct trains operate to this destination from this station.
* To this destination bus route 1 runs a limited service.
Short walk to Exeter Community Hospital from Hillyfield Road bus stop.

Taxis

Pinhoe station has no taxi rank or cab office. Advance booking is essential, please consider using the following local operators: (Inclusion of this number doesn't represent any endorsement of the taxi firm)

A2B Taxis Exeter
01392 666 677

Apple Central Taxis
01392 666 666

Epic Taxis
01392 984 911

Further information about all onward travel

Local Cycle Info

exeter.gov.uk

For more information about cycle routes.

National Cycle Info

walkwheelcycletrust.org.uk

Bus Times

See timetable displays at bus stops.

 www.traveline.info
0871 200 22 33
calls cost 15p per minute
plus your phone company's access charge

PlusBus

plusbus.info

PlusBus is a discount price 'bus pass' that you buy with your train ticket. It gives you unlimited bus travel around your chosen town, on participating buses. Visit www.plusbus.info



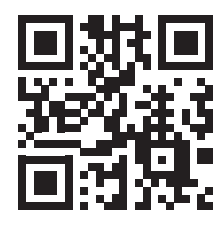

National Rail Enquiries

Online

nationalrail.co.uk

NRE App

Free National Rail Enquiries app for iOS and Android

Social Media

 facebook.com/nationalrailenq
 @nationalrailenq

Alert Me

You can sign up to Alert Me messages on the National Rail Enquiries website where you can receive train and platform notifications directly to your smart phone.
nationalrail.co.uk/alertme

Contact Centre

03457 48 49 50

Calls cost no more than calls to geographic numbers (01 or 02) and may be recorded.

PlusBike

nationalrail.co.uk/plusbike

For more information.



South Western Railway



National Rail
Britain's train companies working together



This poster shows details of popular destinations and main, frequent bus routes. Additional services may run, so please check with Traveline or see posters at local bus stops. Whilst considerable care has been taken to ensure the information contained on this poster is correct and accurate, National Rail cannot accept responsibility for any loss or inconvenience caused by any errors or omissions, or for loss, damage, injury or inconvenience relating to the cancellation, alteration, delay or diversion of a service. For any feedback, please e-mail comments@onwardtravelposters.com

Scan this code with your mobile for full station information.