



Haslemere Station

Onward Travel Information

Buses and Taxis



Key

Bus Stop

Rail replacement Bus Stop

Station Entrance/Exit

Taxi Rank

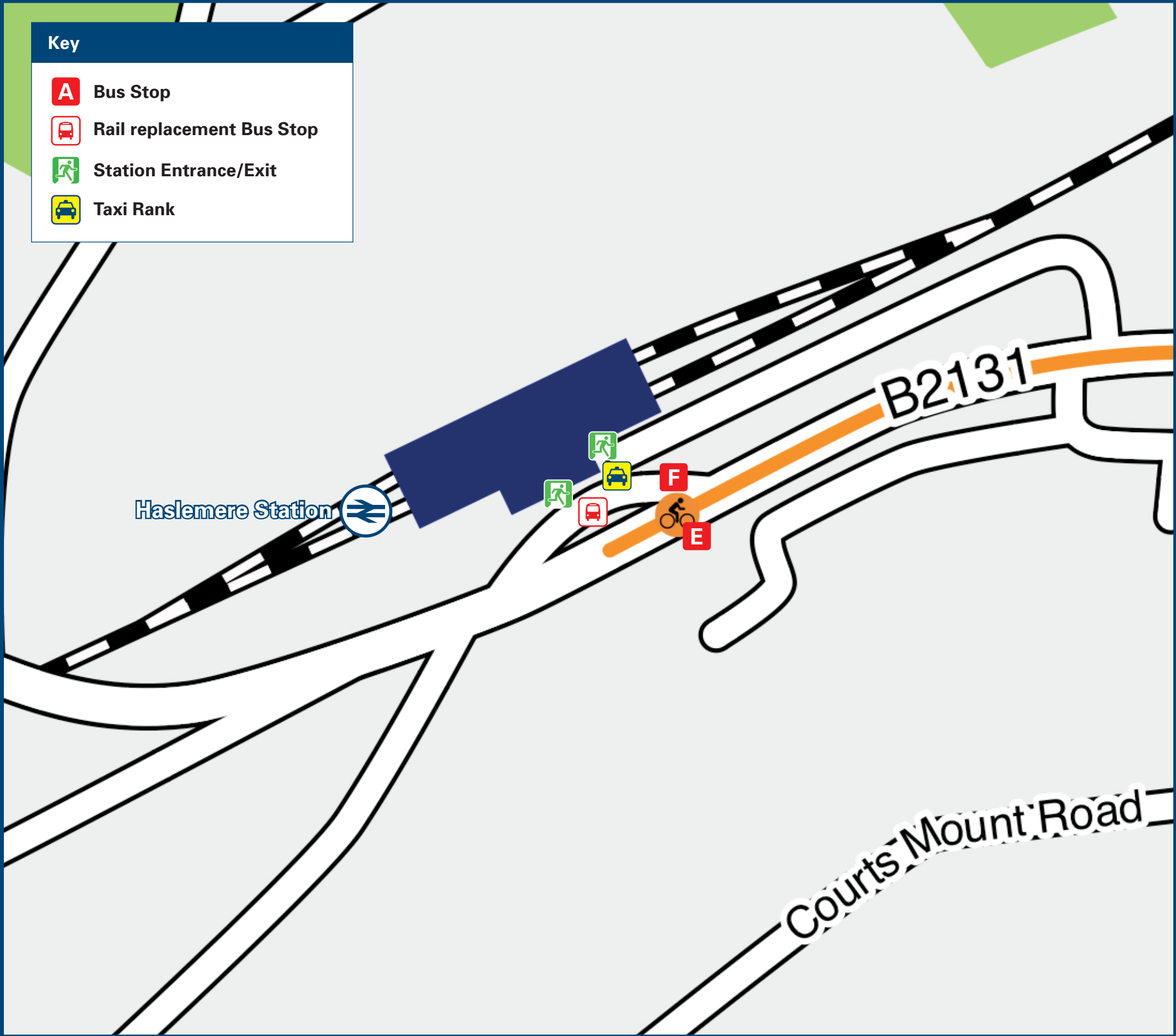

Rail replacement buses depart from the station forecourt, off Lower Street (B2131).

Local area map



Key

High Lane Community Centre

Georgian House Hotel

Haslemere Educational Museum

Haslemere Community Hospital

Cycle routes

Footpaths

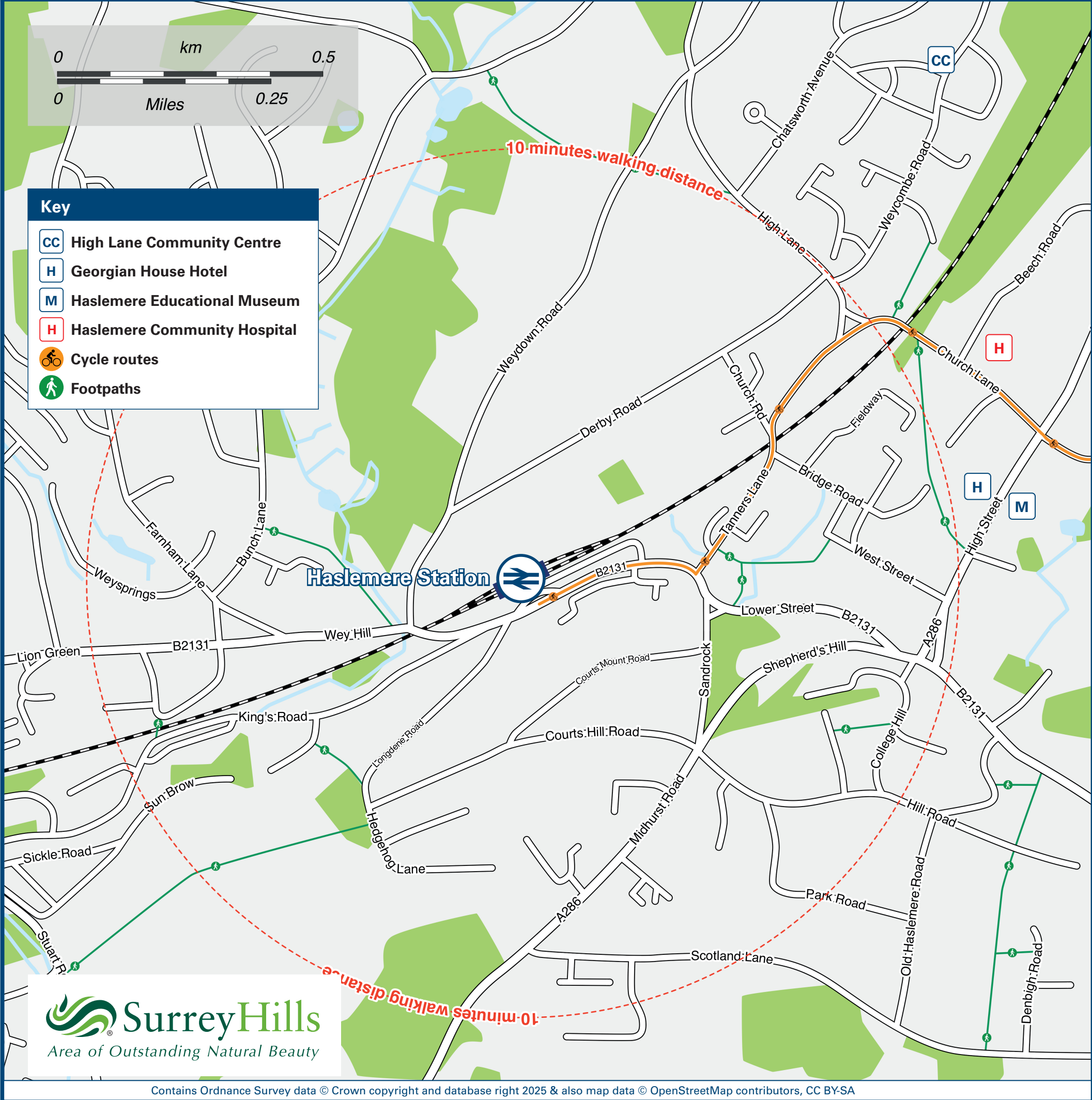

Surrey Hills
Area of Outstanding Natural Beauty

Contains Ordnance Survey data © Crown copyright and database right 2025 & also map data © OpenStreetMap contributors, CC BY-SA

Main destinations by bus

(Data correct at November 2025)



DESTINATION	BUS ROUTES	BUS STOP
Aldershot	19	
Ansteadbrook	71	
Beacon Hill	19	
Bordon Camp	23#	
Brook	70*	
Camelsdale	70	
Chiddingfold	71	
Churt	19	
Easebourne	70	
Farncombe	70*, 71	
Farnham	19	
Fernhurst	70	
Frensham	19	
Godalming	70*, 71	
Grayshott	23#	
Grayswood	70*	

DESTINATION	BUS ROUTES	BUS STOP
Guildford	70*, 71	
Haslemere (Town Centre)	19, 23#, 70, 71	
Haslemere Hospital / Health Centre	19, 70*	
Headley	23#	
Headley Down	23#	
Henley	70	
High Lane Estate	19	
Hindhead (for Devils Punch Bowl)	19, 23#	
Kingsley Green	70	
Lindford	23#	
Liphook	23#	
Lower Bourne	19	
Midhurst	70	
Milford	70*, 71	
Millbridge	19	
Passfield	23#	

DESTINATION	BUS ROUTES	BUS STOP
Shottermill	19, 23#, 70, 71	
Whitehill	23#	
Witley	70*, 71	
Woolmer Hill Estate	71	
Wormley	71	

Notes

Bus routes 19, 70 and 71 operate daily services.
For bus times and days of operation please contact Traveline on www.traveline.info or call: 0871 200 22 33

Direct trains operate to this destination from this station.

It's approximately a 10 minutes walk from this station to Haslemere town centre, see Local area map for walking route.

* To this destination bus route 70 operates Mondays to Saturdays, only. No Sunday service.

Bus routes 23 & operate limited daytime services on Mondays to Saturdays, only. No evenings or Sundays services.

AONB Surrey Hills (AONB) www.surreyhill.org

Taxis

Haslemere station is served by a taxi rank or cab office. Check availability, and pre-book if necessary. Please consider using the following local operators: (Inclusion of this number doesn't represent any endorsement of the taxi firm)

Haslemere taxi Station
01428 658 788

Haslemere Independent
01428 787 222

Haslemere Alpha Taxis
07908 556 622

Further information about all onward travel

Local Cycle Info waverley.gov.uk <small>For more information about cycle routes.</small>	National Cycle Info walkwheelcycletrust.org.uk	Bus Times <small>See timetable displays at bus stops.</small> www.traveline.info 0871 200 22 33 <small>calls cost 15p per minute plus your phone company's access charge</small>	PlusBus plusbus.info <small>PlusBus is a discount price 'bus pass' that you buy with your train ticket. It gives you unlimited bus travel around your chosen town, on participating buses. Visit www.plusbus.info</small>
--	--	--	---

National Rail Enquiries

Online nationalrail.co.uk	NRE App Free National Rail Enquiries app for iOS and Android	Social Media facebook.com/nationalrailenq @nationalrailenq	Alert Me <small>You can sign up to Alert Me messages on the National Rail Enquiries website where you can receive train and platform notifications directly to your smart phone.</small> nationalrail.co.uk/alertme	Contact Centre 03457 48 49 50 <small>Calls cost no more than calls to geographic numbers (01 or 02) and may be recorded.</small>	PlusBike nationalrail.co.uk/plusbike <small>For more information.</small>
---	---	--	--	--	---



National Rail
Britain's train companies working together



This poster shows details of popular destinations and main, frequent bus routes. Additional services may run, so please check with Traveline or see posters at local bus stops. Whilst considerable care has been taken to ensure the information contained on this poster is correct and accurate, National Rail cannot accept responsibility for any loss or inconvenience caused by any errors or omissions, or for loss, damage, injury or inconvenience relating to the cancellation, alteration, delay or diversion of a service. For any feedback, please e-mail comments@onwardtravelposters.com

Scan this code with your mobile for full station information.