

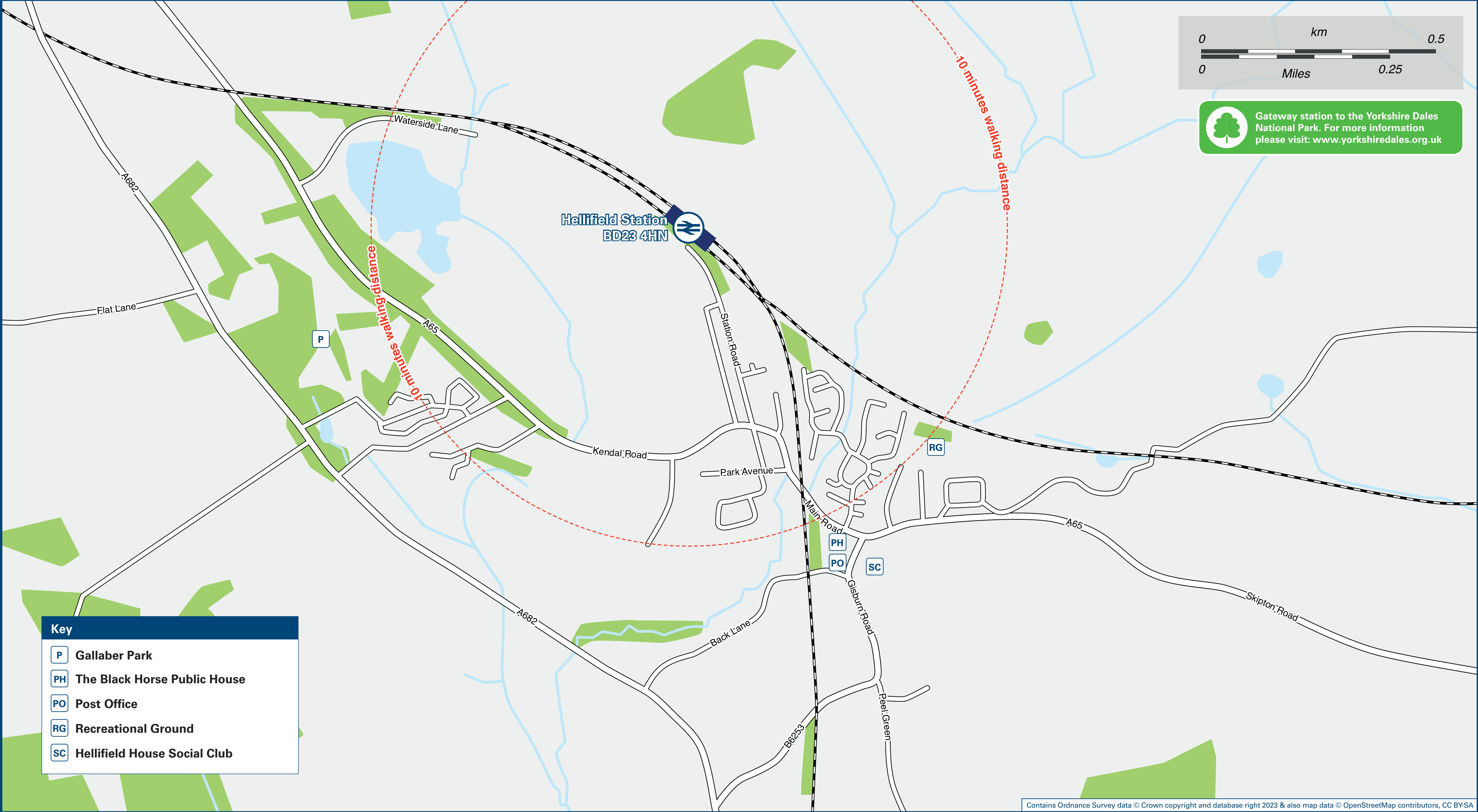

Hellifield Station

Onward Travel Information

Local area map



Buses

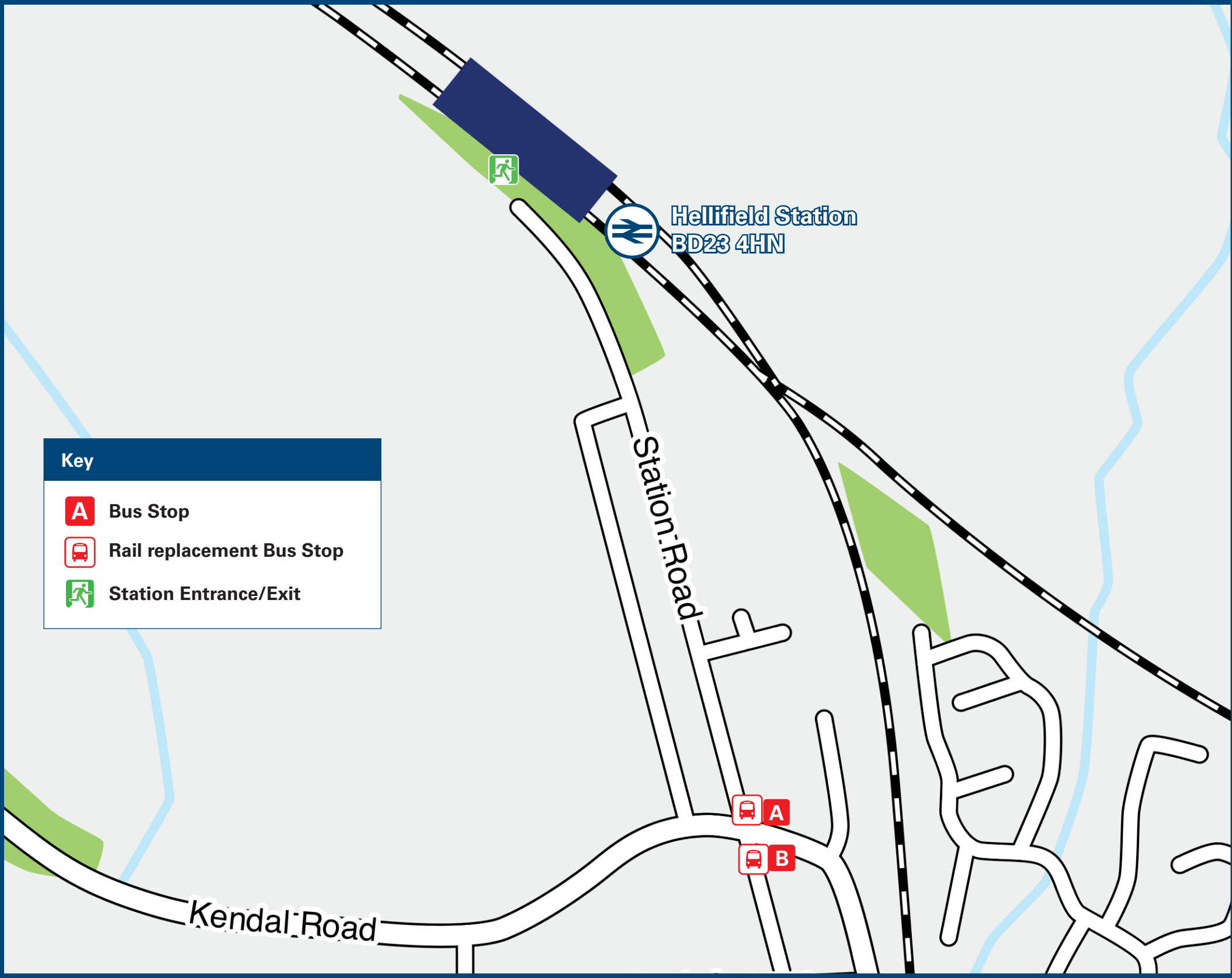

Rail replacement buses from the bus stops on Kendal Road at the junction with Midland Terrace.

Main destinations by bus

(Data correct at November 2023)

DESTINATION	BUS ROUTES	BUS STOP
Coniston Cold	580	A
Gargrave	580	A
Long Preston	580	B
Settle	580	B
Skipton	580	A

Notes

Bus route 580 (The Craven Connection) operates Mondays to Saturdays between Skipton and Settle with onward connections to Ingleton and Kirkby Lonsdale on bus route 581 and then to Lancaster on bus routes 81 and 82.

Additional bus services operate into the Yorkshire Dales National Park and Forest of Bowland (AONB) mainly on Sundays and Bank Holidays during the summer months.

Visit www.dalesbus.org for full details of local bus services.

National Park Yorkshire Dales National Park; www.yorkshiredales.org.uk

Direct trains operate to Skipton, Gargrave, Long Preston and Settle from Hellifield station.

Taxis

Hellifield station has no taxi rank or cab office. Advance booking is essential, please consider using the following local operators: (Inclusion of this number doesn't represent any endorsement of the taxi firm)

Settle Taxis
01729 822 219

Skipton Taxis
0800 7310 413

Long Preston Private Hire
07915 216 930

Further information about all onward travel

Local Cycle Info	National Cycle Info	Bus Times	NextBuses	PlusBus
www.northyorks.gov.uk/roads-parking-and-travel/roads-and-pavements/cycle-lanes-and-routes For more information about cycle routes.	sustrans.org.uk Sustrans is the UK's leading sustainable transport charity.	See timetable displays at bus stops. www.traveline.info 0871 200 22 33 calls cost 15p per minute plus your phone company's access charge	 Find the bus times for your stop. Search for a bus stop by entering a postcode, street & town or a stop name & town. Download on the App Store	 plusbus.info A discount price 'bus pass' that you buy with your train ticket. It gives you unlimited bus travel around your chosen town, on participating buses.

National Rail Enquiries

Online	NRE App	Social Media	Alert Me	Contact Centre	PlusBike
nationalrail.co.uk	Free National Rail Enquiries app for iOS and Android	facebook.com/nationalrailenq @nationalrailenq	You can sign up to Alert Me messages on the National Rail Enquiries website where you can receive train and platform notifications directly to your smart phone. nationalrail.co.uk/alertme	03457 48 49 50 Calls cost no more than calls to geographic numbers (01 or 02) and may be recorded.	 nationalrail.co.uk/plusbike For more information.



This poster shows details of popular destinations and main, frequent bus routes. Additional services may run, so please check with Traveline or see posters at local bus stops. Whilst considerable care has been taken to ensure the information contained on this poster is correct and accurate, National Rail cannot accept responsibility for any loss or inconvenience caused by any errors or omissions, or for loss, damage, injury or inconvenience relating to the cancellation, alteration, delay or diversion of a service. For any feedback, please e-mail comments@onwardtravelposters.com

Scan this code with your mobile for full station information.