

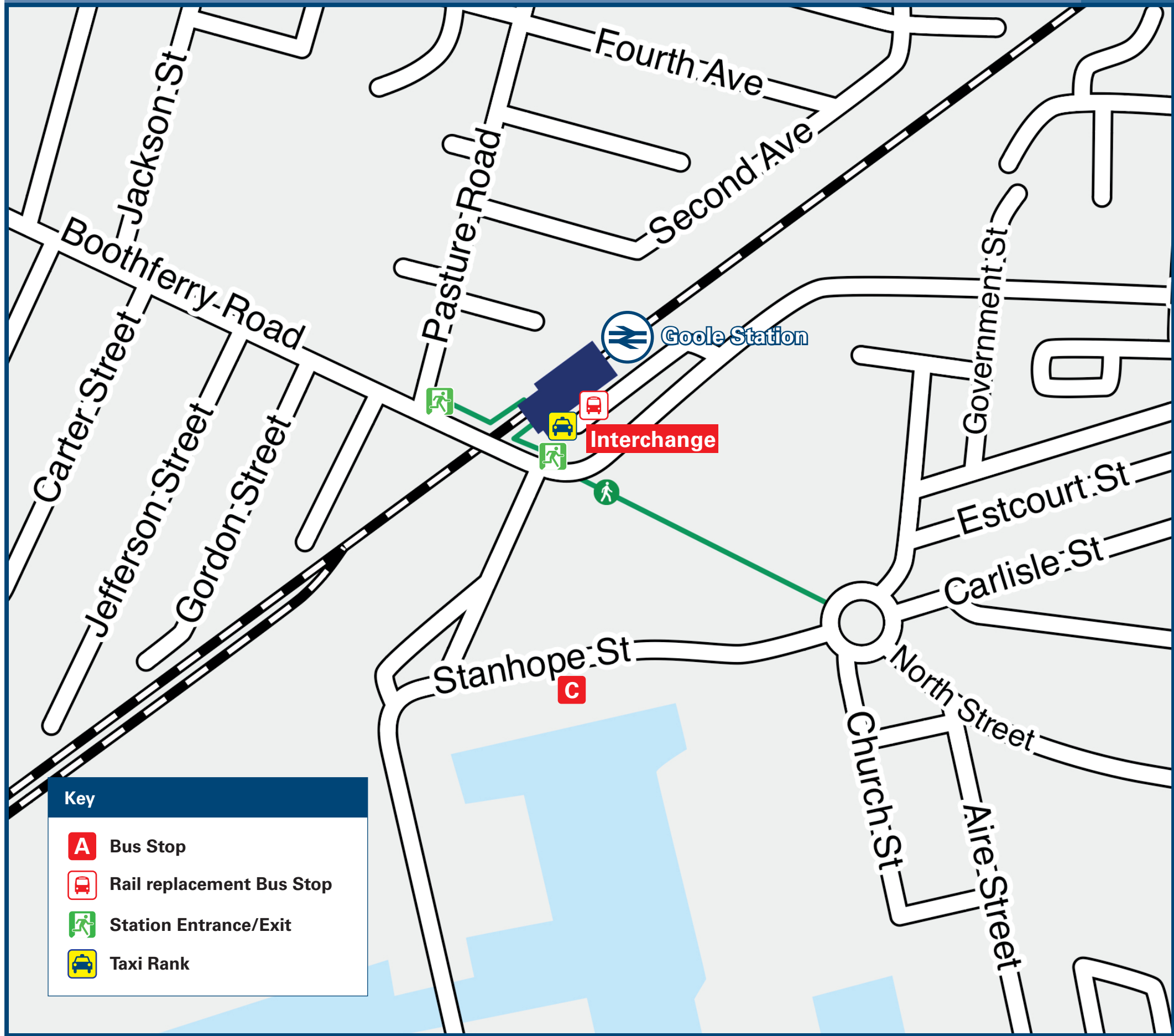

# Goole Station

## Onward Travel Information

### Buses and Taxis



Rail replacement buses pick-up/drop-off at the Station Car Park.

### Local area map

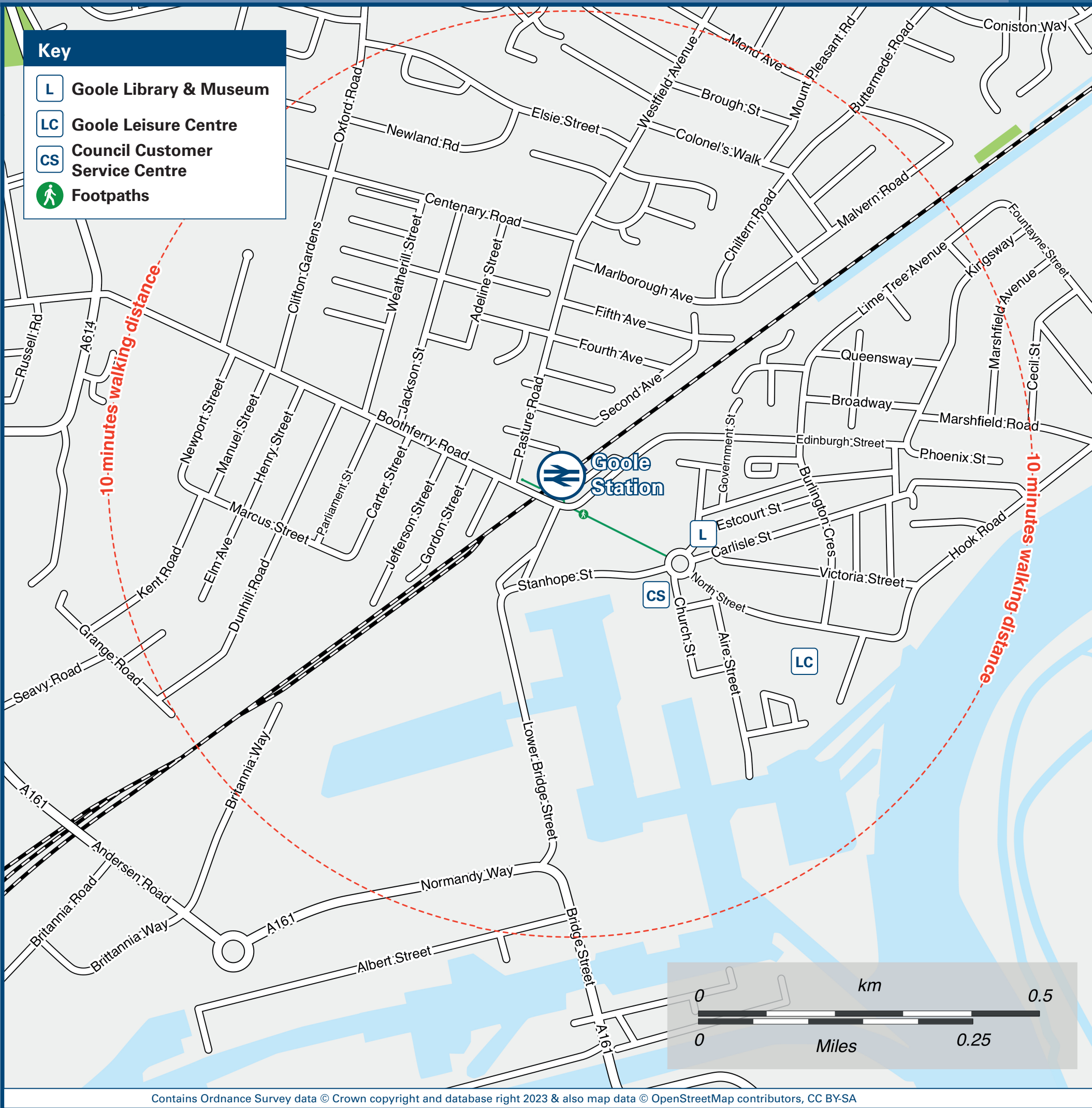

### Main destinations by bus

(Data correct at November 2023)



| DESTINATION                     | BUS ROUTES       | BUS STOP                   |
|---------------------------------|------------------|----------------------------|
| Adlingfleet                     | 361#<br>360~     | Interchange<br>C           |
| Airmyn                          | 88*, 400, 401    | Interchange                |
| Barlow                          | 401              | Interchange                |
| Brough                          | 55               | Interchange                |
| Camblesforth                    | 401              | Interchange                |
| Carlton                         | 401              | Interchange                |
| Crowle                          | 361#             | Interchange                |
| Ealand                          | 361#             | Interchange                |
| East Cowick                     | 401              | Interchange                |
| Eastoft                         | 361#             | Interchange                |
| Eastrington                     | 55               | Interchange                |
| Elloughton                      | 55               | Interchange                |
| Garthorpe                       | 361#<br>360~     | Interchange<br>C           |
| Gilberdyke                      | 55               | Interchange                |
| Goole Town area -               |                  |                            |
| - Goole & District Hospital     | 55<br>G3         | Interchange<br>Interchange |
| - Old Goole (Cottingham Street) | 361#<br>G1, 360~ | Interchange<br>C           |

| DESTINATION          | BUS ROUTES    | BUS STOP         |
|----------------------|---------------|------------------|
| - Rawcliffe Road     | 401           | Interchange      |
| Gunness              | 361#<br>360~  | Interchange<br>C |
| HM Prison Everthorpe | 55            | Interchange      |
| Howden               | 55            | Interchange      |
| Luddington           | 361#<br>360~  | Interchange<br>C |
| Newport              | 55            | Interchange      |
| North Cave           | 55            | Interchange      |
| Ousefleet            | 361#<br>360~  | Interchange<br>C |
| Rawcliffe            | 88*, 400, 401 | Interchange      |
| Reedness             | 361#<br>360~  | Interchange<br>C |
| RSPB Blacktoft Sands | 361#<br>360~  | Interchange<br>C |
| Scunthorpe           | 361#<br>360~  | Interchange<br>C |
| Selby                | 401           | Interchange      |
| Snaith               | 401           | Interchange      |
| South Cave           | 55            | Interchange      |

| DESTINATION | BUS ROUTES   | BUS STOP         |
|-------------|--------------|------------------|
| Swinefleet  | 361#<br>360~ | Interchange<br>C |
| West Cowick | 401          | Interchange      |
| Whitgift    | 361#<br>360~ | Interchange<br>C |

#### Notes

Bus routes 55, 401, G1 & G3 (Goole Town Local Bus Services) operate Mondays to Saturdays, only. No Sunday services.  
For bus times please see bus stop timetables or contact Traveline.  
Direct trains operate to this destination from this station.  
# Bus route 361 operates a limited Mondays to Saturdays services, only. No Sunday services. This service operates from stop (A) Mondays to Fridays, and from stop (C) on Saturdays.  
~ Bus route 360 operates a limited Mondays to Fridays services, only. No Saturday or Sunday service.  
\* Bus route 88 operates a limited Mondays to Saturdays services, only. No Sunday service.

### Taxis

Goole station is served by a taxi rank or cab office. Check availability before travelling, and pre-book if necessary. Please consider using the following local operators: (Inclusion of this number doesn't represent any endorsement of the taxi firm)

Arrow Cabs  
01405 765 474

A-2-B Taxis  
01405 766 766

Jimmy's Taxis  
07849 918 023

### Further information about all onward travel

|  |  |   |   |   |
|--|--|---|---|---|
| <b>Local Cycle Info</b><br>eastriding.gov.uk<br>For more information about cycle routes. | <b>National Cycle Info</b><br>sustrans.org.uk<br>Sustrans is the UK's leading sustainable transport charity. | <b>Bus Times</b><br>See timetable displays at bus stops.<br>www.traveline.info<br>0871 200 22 33<br>calls cost 15p per minute plus your phone company's access charge | <b>NextBuses</b><br>Find the bus times for your stop.<br>Search for a bus stop by entering a postcode, street & town or a stop name & town. | <b>PlusBus</b><br>plusbus.info<br>A discount price 'bus pass' that you buy with your train ticket. It gives you unlimited bus travel around your chosen town, on participating buses. |
|--|--|---|---|---|

### National Rail Enquiries

|                                     |  |   |   |  |   |
|-------------------------------------|--|---|---|--|---|
| <b>Online</b><br>nationalrail.co.uk | <b>NRE App</b><br>Free National Rail Enquiries app for iOS and Android | <b>Social Media</b><br>facebook.com/nationalrailenq<br>@nationalrailenq | <b>Alert Me</b><br>You can sign up to Alert Me messages on the National Rail Enquiries website where you can receive train and platform notifications directly to your smart phone.<br>nationalrail.co.uk/alertme | <b>Contact Centre</b><br>03457 48 49 50<br>Calls cost no more than calls to geographic numbers (01 or 02) and may be recorded. | <b>PlusBike</b><br>nationalrail.co.uk/plusbike<br>For more information. |
|-------------------------------------|--|---|---|--|---|



NORTHERN



National Rail  
Britain's train companies working together



This poster shows details of popular destinations and main, frequent bus routes. Additional services may run, so please check with Traveline or see posters at local bus stops. Whilst considerable care has been taken to ensure the information contained on this poster is correct and accurate, National Rail cannot accept responsibility for any loss or inconvenience caused by any errors or omissions, or for loss, damage, injury or inconvenience relating to the cancellation, alteration, delay or diversion of a service. For any feedback, please e-mail comments@onwardtravelposters.com

Scan this code with your mobile for full station information.