

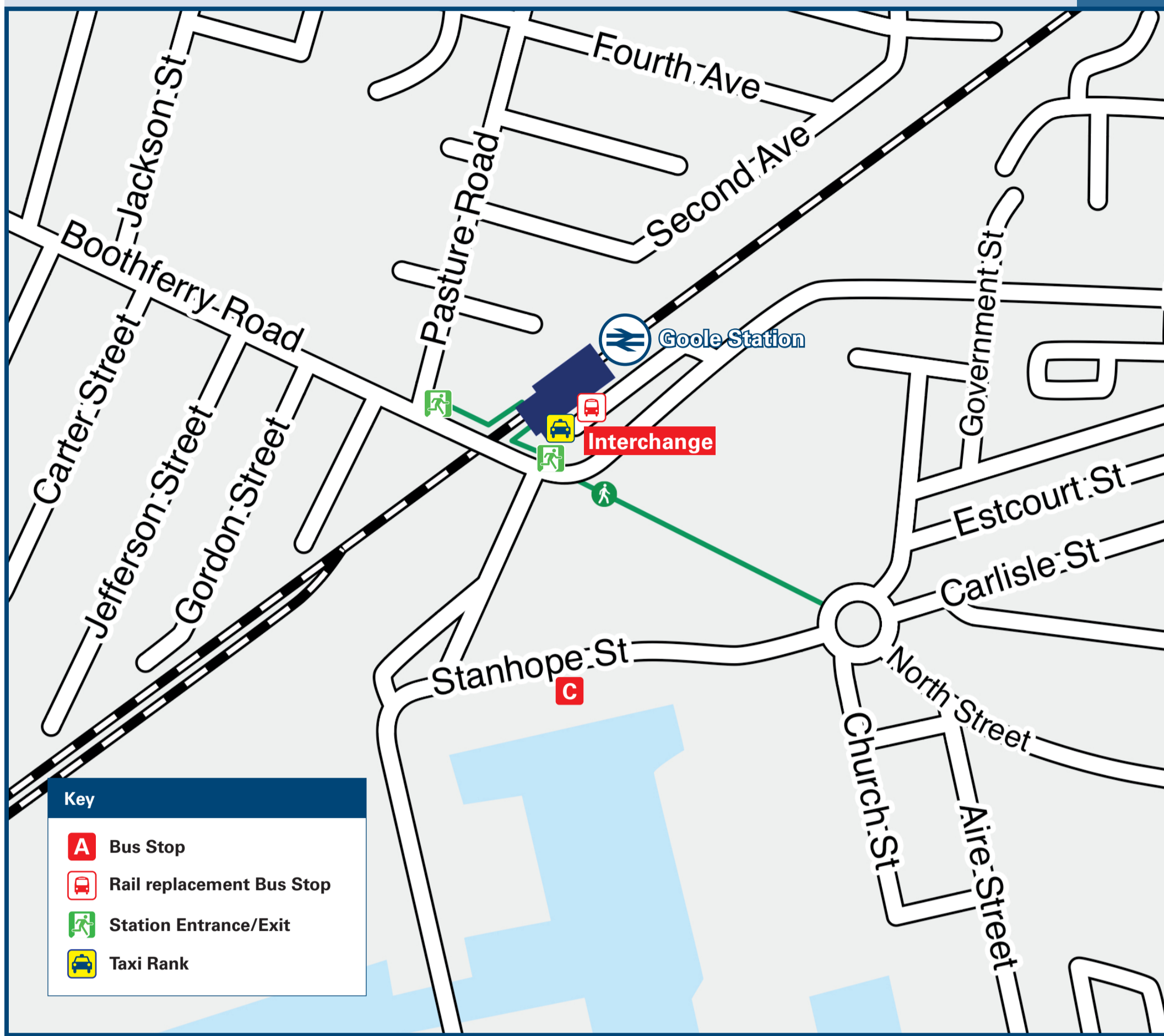

# Goole Station

# Onward Travel Information

## Buses and Taxis



Rail replacement buses pick-up/drop-off at the Station Car Park.

## Local area map

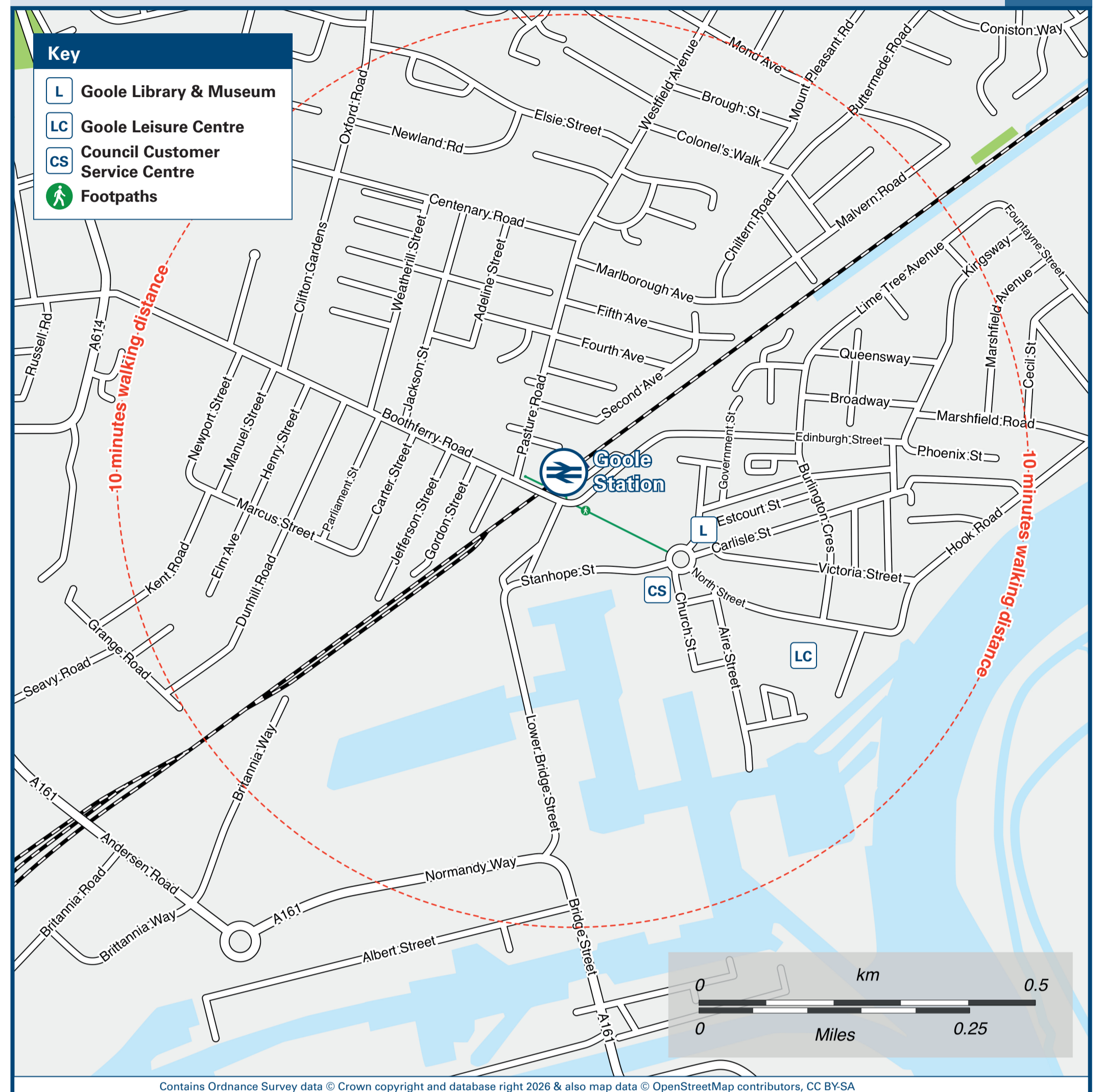

## Main destinations by bus

(Data correct at February 2026)



DESTINATION	BUS ROUTES	BUS STOP
Adlingfleet	360~, 361#	C
Airmyn	88*, 401, J36	Interchange
Barlow	401	Interchange
Brough	55	Interchange
Camblesforth	401	Interchange
Carlton	401	Interchange
Crowle	361#	C
Ealand	361#	C
East Cowick	401	Interchange
Eastoft	361#	C
Eastrington	55	Interchange
Elloughton	55	Interchange
Garthorpe	360~, 361#	C
Gilberdyke	55	Interchange
Goole Town area -		

DESTINATION	BUS ROUTES	BUS STOP
- Goole & District Hospital	55, G3	Interchange
- Old Goole (Cottingham Street)	G1	Interchange
- Rawcliffe Road	360~, 361#	C
Gunness	401	Interchange
HM Prison Everthorpe	360~, 361#	C
Howden	55, J36	Interchange
Luddington	55	Interchange
Newport	360~, 361#	C
North Cave	55	Interchange
Ousefleet	55	Interchange
Rawcliffe	360~, 361#	C
Reedness	88*, 401	Interchange
RSPB Blacktoft Sands	360~, 361#	C
Scunthorpe	360~, 361#	C

DESTINATION	BUS ROUTES	BUS STOP
Selby	401	Interchange
Snaith	401	Interchange
South Cave	55	Interchange
Swinefleet	360~, 361#	C
West Cowick	401	Interchange
Whitgift	360~, 361#	C

**Notes**

Bus routes G3 (G3 is a Goole Town Local Bus Services) & J36 operate Mondays to Saturdays, only. No Sunday services.

Bus routes 55, 401 & G1 (G1 is a Goole Town Local Bus Services) operate daily services.

For bus times and days of operation please contact Traveline on [www.traveline.info](http://www.traveline.info) or call: 0871 200 22 33

Direct trains operate to this destination from this station.

# Bus route 361 operates a limited daily service. This service operates from stop (A) Mondays to Fridays, and from stop (C) on Saturdays.

~ Bus route 360 operates a limited Mondays to Fridays services, only. No Saturday or Sunday service.

\* Bus route 88 operates a limited Mondays to Saturdays services, only. No Sunday service.

**Taxis**

Goole station is served by a taxi rank or cab office. Check availability before travelling, and pre-book if necessary. Please consider using the following local operators: (Inclusion of this number doesn't represent any endorsement of the taxi firm)

**Arrow Cabs**  
01405 765 474

**A-2-B Taxis**  
01405 766 766

**Jimmy's Taxis**  
07849 918 023

**Further information about all onward travel**

<b>Local Cycle Info</b> <a href="http://eastriding.gov.uk">eastriding.gov.uk</a> For more information about cycle routes.	<b>National Cycle Info</b> <a href="http://walkwheelcycletrust.org.uk">walkwheelcycletrust.org.uk</a>	<b>Bus Times</b> See timetable displays at bus stops.  <a href="http://www.traveline.info">www.traveline.info</a> 0871 200 22 33 call cost 12p per minute plus your phone company's access charge	<b>PlusBus</b>  <a href="http://plusbus.info">plusbus.info</a> PlusBus is a discount price 'bus pass' that you buy with your train ticket. It gives you unlimited bus travel around your chosen town, on participating buses. Visit <a href="http://www.plusbus.info">www.plusbus.info</a>
---	--	--	---

**National Rail Enquiries**

<b>Online</b> <a href="http://nationalrail.co.uk">nationalrail.co.uk</a>	<b>NRE App</b> Free National Rail Enquiries app for iOS and Android	<b>Social Media</b> facebook.com/nationalrailenq @nationalrailenq	<b>Alert Me</b> You can sign up to Alert Me messages on the National Rail Enquiries website where you can receive train and platform notifications directly to your smart phone. <a href="http://nationalrail.co.uk/alertme">nationalrail.co.uk/alertme</a>	<b>Contact Centre</b> 03457 48 49 50 Calls cost no more than calls to geographic numbers (01 or 02) and may be recorded.	<b>PlusBike</b> <a href="http://nationalrail.co.uk/plusbike">nationalrail.co.uk/plusbike</a> For more information.
---	--	---	---	--	--



This poster shows details of popular destinations and main, frequent bus routes. Additional services may run, so please check with Traveline or see posters at local bus stops. Whilst considerable care has been taken to ensure the information contained on this poster is correct and accurate, National Rail cannot accept responsibility for any loss or inconvenience caused by any errors or omissions, or for loss, damage, injury or inconvenience relating to the cancellation, alteration, delay or diversion of a service. For any feedback, please e-mail [comments@onwardtravelposters.com](mailto:comments@onwardtravelposters.com)

Scan this code with your mobile for full station information.