

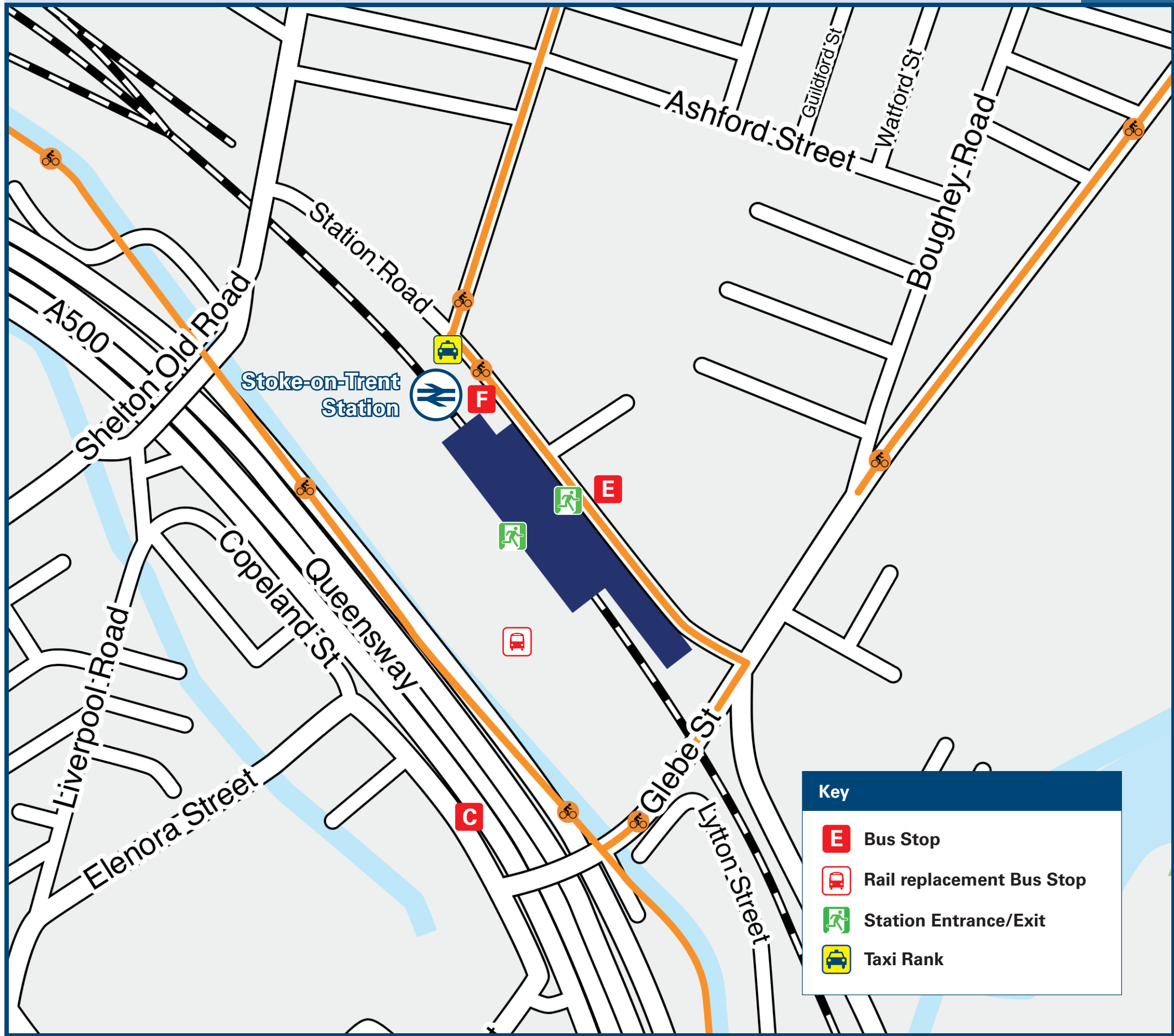

Stoke-On-Trent Station

Onward Travel Information

Buses and Taxis



Rail replacement services operate from Car Park 3.

Local area map

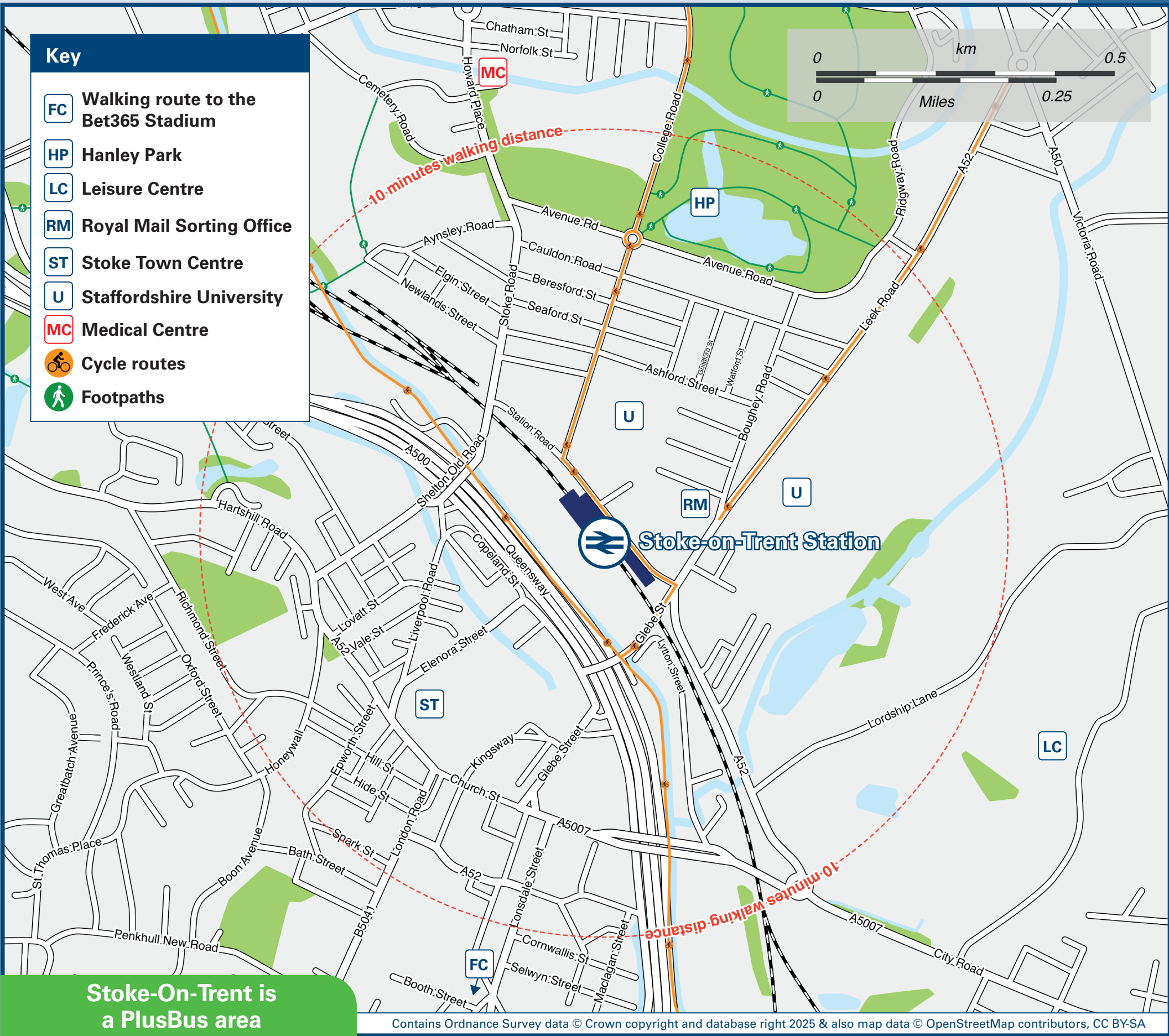

Add **PlusBus** to your train ticket—now available on eTicket from leading rail ticketing apps—for unlimited bus travel in the **PlusBus** zone in your destination town or city. Visit www.plusbus.info

Main destinations by bus

(Data correct at November 2025)



DESTINATION	BUS ROUTES	BUS STOP
Alton Towers Resort	32A## Taxi (35 minute journey)	Station Taxi Rank
● Barlaston	100*	
● bet365 Stadium (Stoke City FC)	24	
Biddulph	9	
● Blurton	23, 40A#	
● Bradeley	9, 24**	
Cheadle	32A##	
● City Centre (Hanley)	9, 23, 24, 25, 40A#, 100*	
● Clayton	9	
● Fenton	23, 40A#	
● Festival Park (For Stoke Ski Centre & Waterworld)	501*	
● Hanford	21	
● Hanley (City Centre Bus Station)	9, 23, 24, 25, 40A#, 100*, 501*	

DESTINATION	BUS ROUTES	BUS STOP
● Hartshill	9, 25	
● Heron Cross	23, 40A#	
● Keele (and Keele University)	25	
● Longton	40A#	
● Newcastle-under-Lyme (Bus Station)	9, 25	
● Newstead	23, 24, 40A#	
● Oakhill	21	
● Penkhull	9, 25	
● Royal Stoke University Hospital	9, 25	
● Sneyd Green (for Central Forest Park)	9	
● Stoke-upon-Trent (Town Centre)	9, 23, 24, 25	
Stone	100*	
● Trentham	24, 21, 40A#, 100*	

DESTINATION	BUS ROUTES	BUS STOP
● Trentham Estate Retail Village	Taxi (15 minute journey) 100*	Station Taxi Rank
● Trentham Monkey Forest	Taxi (20 minute journey)	Station Taxi Rank
● Trent Vale	21	
● Wedgwood Visitor Centre***	Taxi (15 minute journey) 40A#, 100*	Station Taxi Rank

Notes

- **PlusBus** destination, please see below for details. Bus routes 9, 21, 23, 24 & 25 operate daily services. For bus times and days of operation please contact Traveline on www.traveline.info or call: 0871 200 22 33
- 10 minutes walk from this station.
- * Bus routes 100 & 501 operate limited daytime services on Mondays to Saturdays, only. No evenings or Sundays services.
- ** Limited journeys only to this destination, please check the timetable.
- *** Alight bus 100 at Wedgwood Drive - it's a 10 minutes walk from there to the Wedgwood Visitor Centre.
- ~ Additional bus services to other local destinations depart from Hanley and Newcastle-under-Lyme bus stations.
- # Bus route 40A operates a limited daytime service on Saturdays, only. No Mondays to Fridays or Sundays service.
- ## Bus route 32A departs from this station at 08:30 on Mondays to Saturdays, and only operates when Alton Towers is open to the public.
- Direct trains operate to this destination from Stoke-on-Trent station.

Taxis

Stoke-on-Trent is a major station where taxis are usually available on a rank. Advance booking is not normally necessary, unless arriving early in the morning or late at night. Operators who may accept bookings include: (Inclusion of this number doesn't represent any endorsement of the taxi firm)

City Cabs Stoke
01782 888 888

A1 Embassy Taxis
01782 222 222

Lucky Seven Taxis
01782 333 333

Bike Hire

bromptondock.co.uk
020 8232 3931
(text 2323 to hire a bike)

Further information about all onward travel

Local Cycle Info

stoke.gov.uk

For more information about cycle routes.

National Cycle Info

sustrans.org.uk

Sustrans is the UK's leading sustainable transport charity.

Bus Times

See timetable displays at bus stops.

www.traveline.info
0871 200 22 33
calls cost 15p per minute plus your phone company's access charge

PlusBus

plusbus.info

PlusBus is a discount price 'bus pass' that you buy with your train ticket. It gives you unlimited bus travel around your chosen town, on participating buses. Visit www.plusbus.info



National Rail Enquiries

Online	NRE App	Social Media	Alert Me	Contact Centre	PlusBike
nationalrail.co.uk	Free National Rail Enquiries app for iOS and Android	facebook.com/nationalrailenq @nationalrailenq	You can sign up to Alert Me messages on the National Rail Enquiries website where you can receive train and platform notifications directly to your smart phone. nationalrail.co.uk/alertme	03457 48 49 50 Calls cost no more than calls to geographic numbers (01 or 02) and may be recorded.	nationalrail.co.uk/plusbike For more information.

AVANTI
WEST COAST

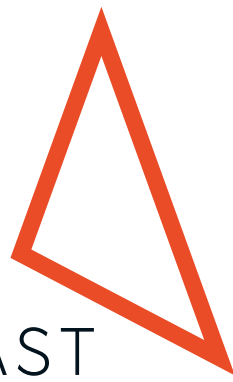

National Rail
Britain's train companies working together

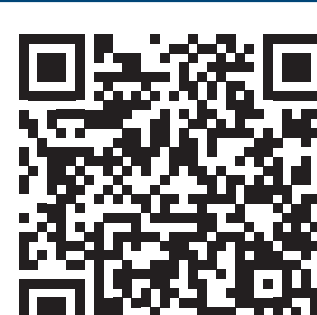

This poster shows details of popular destinations and main, frequent bus routes. Additional services may run, so please check with Traveline or see posters at local bus stops. Whilst considerable care has been taken to ensure the information contained on this poster is correct and accurate, National Rail cannot accept responsibility for any loss or inconvenience caused by any errors or omissions, or for loss, damage, injury or inconvenience relating to the cancellation, alteration, delay or diversion of a service. For any feedback, please e-mail comments@onwardtravelposters.com

Scan this code with your mobile for full station information.