

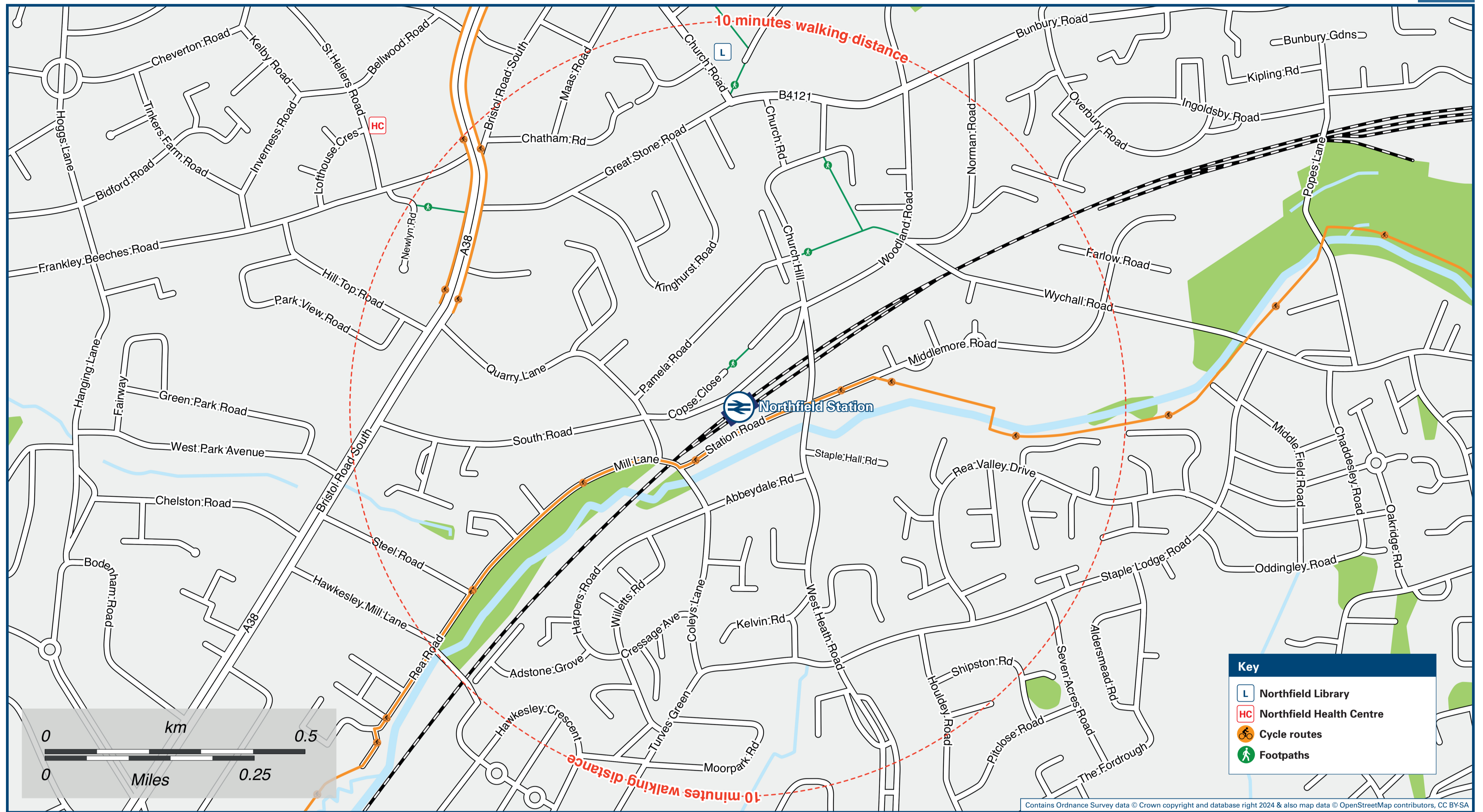

Northfield Station

Onward Travel Information

Local area map



Buses

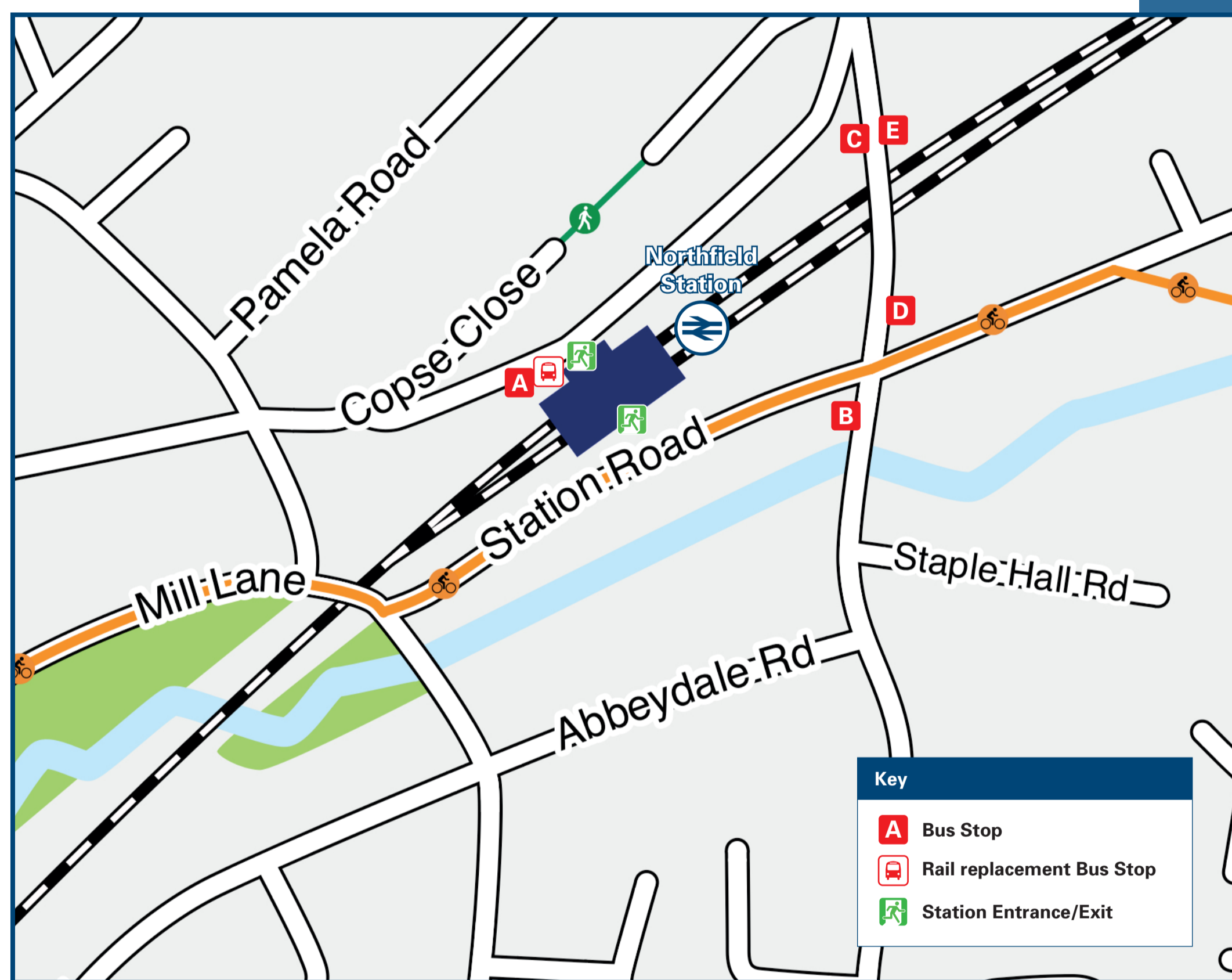

Rail replacement buses/coaches will collect from public service bus stops in the station car park.

Main destinations by bus

(Data correct at July 2024)

DESTINATION	BUS ROUTES	BUS STOP
Boumville (for Cadbury World)	46, 46A	D, E
Cotteridge	19*	A, C
Druids Heath	19*	A, C
Hawkesley	46, 46A	D, E
King's Norton	19*	A, C
Longbridge	46	D, E
Maypole	19*	A, C
Northfield Shopping Centre (Bell Lane)	19*	A, C
Pool Farm (for Cadbury College)	46, 46A	B, C
Queen Elizabeth Hospital (near to University Station)	46, 46A	B, C
Rednal	19*	A, D
Rubery Great Park (Leisure & Retail Park)	19*	A, D
Turves Green	19*	A, D
Weoley Castle	46, 46A	D, E
West Heath	46, 46A	B, C
Wychall	19*	A, D

Notes

Bus route 46 runs everyday, Mondays to Sundays.
 Bus route 46A runs Mondays to Saturdays, only. No Sunday service.
 Direct trains operate to this destination from this Station.
 * Bus route 19 runs Mondays to Saturdays between 0730 and 1700. No Sunday service.

Taxis

Northfield Station has no taxi rank or cab office. Advance booking is essential, please consider using the following local operators: (Inclusion of this number doesn't represent any endorsement of the taxi firm)

Elite
0121 475 5000

Roundabout Cars
0121 453 4321

Steves Private Hire
0121 222 5788

Further information about all onward travel

Local Cycle Info www.tfwm.org.uk/plan-your-journey/ways-to-travel/cycling-and-walking For more information about cycle routes.	National Cycle Info sustrans.org.uk Sustrans is the UK's leading sustainable transport charity.	Bus Times See timetable displays at bus stops. www.traveline.info 0871 200 22 33 call cost 12p per minute plus your phone company's access charge	NextBuses Find the bus times for your stop. Search for a bus stop by entering a postcode, street & town or a stop name & town.	PlusBus plusbus.info A discount price 'bus pass' that you buy with your train ticket. It gives you unlimited bus travel around your chosen town, on participating buses.
---	---	--	--	---

National Rail Enquiries

Online nationalrail.co.uk	NRE App Free National Rail Enquiries app for iOS and Android	Social Media facebook.com/nationalrailenq @nationalrailenq	Alert Me You can sign up to Alert Me messages on the National Rail Enquiries website where you can receive train and platform notifications directly to your smart phone. nationalrail.co.uk/alertme	Contact Centre 03457 48 49 50 Calls cost no more than calls to geographic numbers (01 or 02) and may be recorded.	PlusBike nationalrail.co.uk/plusbike For more information.
---	--	---	---	--	--



This poster shows details of popular destinations and main, frequent bus routes. Additional services may run, so please check with Traveline or see posters at local bus stops. Whilst considerable care has been taken to ensure the information contained on this poster is correct and accurate, National Rail cannot accept responsibility for any loss or inconvenience caused by any errors or omissions, or for loss, damage, injury or inconvenience relating to the cancellation, alteration, delay or diversion of a service. For any feedback, please e-mail comments@onwardtravelposters.com

Scan this code with your mobile for full station information.