

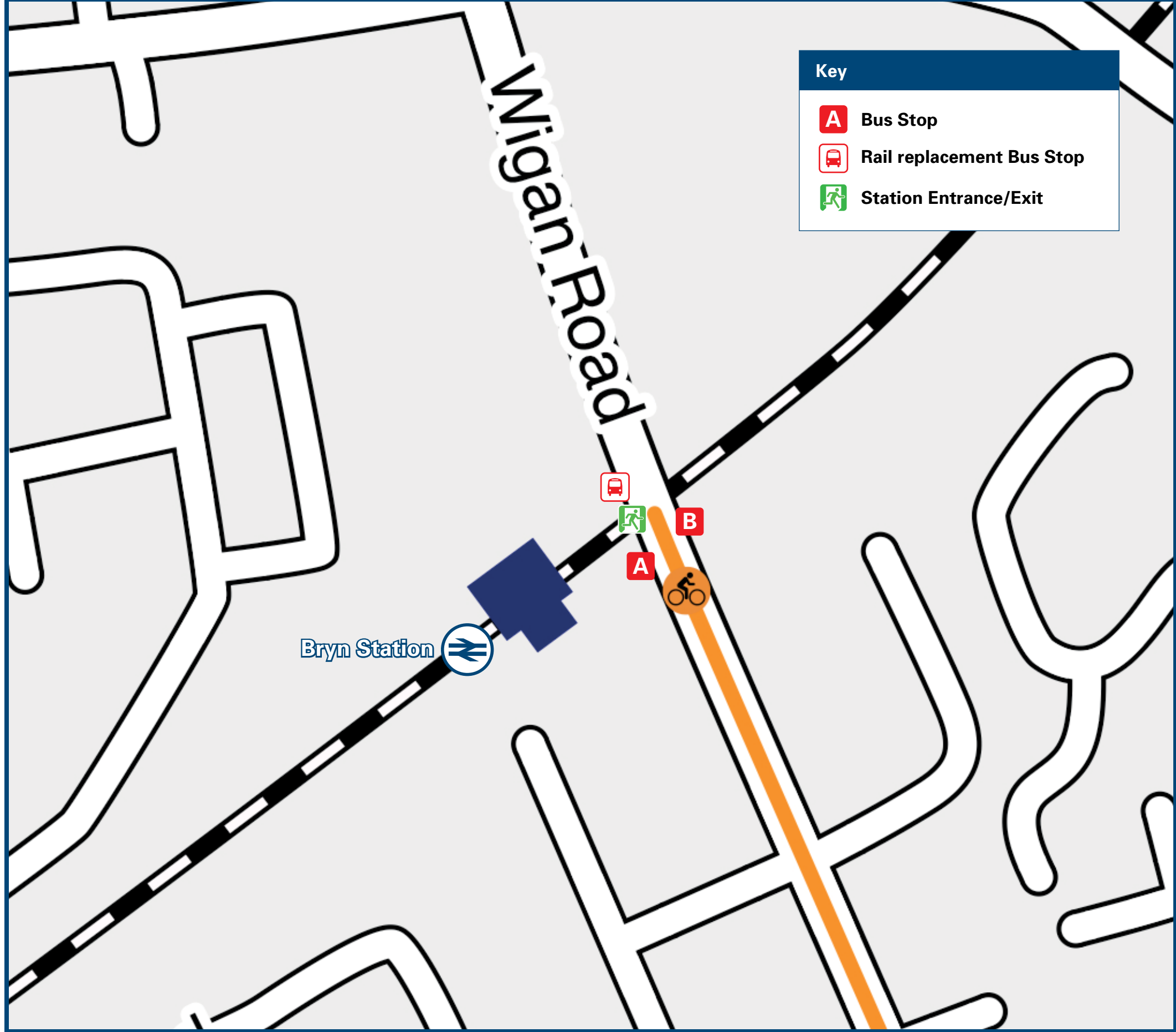

Bryn Station

Onward Travel Information

Buses



Rail replacement services arrive and depart from bus stops on the Wigan Road on the bridge above the station.

Local area map



Main destinations by bus



| DESTINATION | BUS ROUTES | BUS STOP |
|------------------------------------|----------------------------|----------|
| Ashton Cross | 22, 156 | A |
| Ashton-in-Makerfield (Town Centre) | 22, 35, 156, 157, 610, 611 | B |
| Astley | 35 | B |
| Billinge | 157 | A |
| Blackbrook | 156 | A |
| Boothstown | 35 | B |
| Bryn (Chantry Walk) | 157 | A |
| Crank | 157 | A |
| Downall Green | 22, 156, 157 | A |
| Earlestown | 22 | A |
| Edge Green | 35, 610, 611 | B |
| Garswood | 22, 156, 157 | A |
| Golborne | 35, 610, 611 | B |
| Goose Green | 610, 611 | A |

| DESTINATION | BUS ROUTES | BUS STOP |
|----------------------------------|--------------|----------|
| Haydock | 22 | A |
| Kings Moss | 157 | A |
| Land Gate (Wigan Road) | 610, 611 | A |
| Leigh | 35, 610, 611 | B |
| Lowton | 35, 610, 611 | B |
| Manchester City Centre | 35 | B |
| Marus Bridge (For Retail Park) | 610, 611 | A |
| Newton le Willows | 22 | A |
| Newtown (Warrington Road) | 610, 611 | A |
| North Ashton (Booth's Brow Road) | 22, 156, 157 | A |
| Pendleton | 35 | B |
| Pennington | 35, 610, 611 | B |
| Rainford | 157 | A |

| DESTINATION | BUS ROUTES | BUS STOP |
|-----------------------|------------|----------|
| Salford Shopping City | 35 | B |
| St Helens | 156 | A |
| Vulcan Village | 22 | A |
| Warrington | 22 | A |
| Wigan | 610, 611 | A |
| Worsley | 35 | B |

Notes

Bus routes 22 and 157 operate daytime Mondays to Saturdays.
Bus route 35 operates limited early morning journeys only Mondays to Sundays.
Bus routes 156 and 611 operate evenings Mondays to Saturdays and all day on Sundays and public holidays.
Bus route 610 operates all day daily, Mondays to Sundays and public holidays.
For bus times please see bus stop timetables or contact Traveline on 0871 200 22 33.
Direct trains operate to this destination from this station.

Taxis

Bryn station has no taxi rank or cab office. Advance booking is essential, please consider using the following local operators: (Inclusion of this number doesn't represent any endorsement of the taxi firm)

Ashton Private Hire
01942 727 777

1st Class Cabs
01942 729 030

A-2-B Taxis
01942 202 122

Further information about all onward travel

Local Cycle Info

wigan.gov.uk

For more information about cycle routes.

National Cycle Info

sustrans.org.uk

Sustrans is the UK's leading sustainable transport charity.

Bus Times

See timetable displays at bus stops.

www.traveline.info
0871 200 22 33
calls cost 15p per minute plus your phone company's access charge

NextBuses

Find the bus times for your stop.
Search for a bus stop by entering a postcode, street & town or a stop name & town.

PlusBus

plusbus.info

A discount price 'bus pass' that you buy with your train ticket. It gives you unlimited bus travel around your chosen town, on participating buses.

National Rail Enquiries

Online

nationalrail.co.uk

NRE App

Free National Rail Enquiries app for iOS and Android

Social Media

facebook.com/nationalrailenq
@nationalrailenq

Alert Me

You can sign up to Alert Me messages on the National Rail Enquiries website where you can receive train and platform notifications directly to your smart phone.
nationalrail.co.uk/alertme

Contact Centre

03457 48 49 50

Calls cost no more than calls to geographic numbers (01 or 02) and may be recorded.

PlusBike

nationalrail.co.uk/plusbike

For more information.



National Rail
Britain's train companies working together



This poster shows details of popular destinations and main, frequent bus routes. Additional services may run, so please check with Traveline or see posters at local bus stops. Whilst considerable care has been taken to ensure the information contained on this poster is correct and accurate, National Rail cannot accept responsibility for any loss or inconvenience caused by any errors or omissions, or for loss, damage, injury or inconvenience relating to the cancellation, alteration, delay or diversion of a service. For any feedback, please e-mail comments@onwardtravelposters.com

Scan this code with your mobile for full station information.