

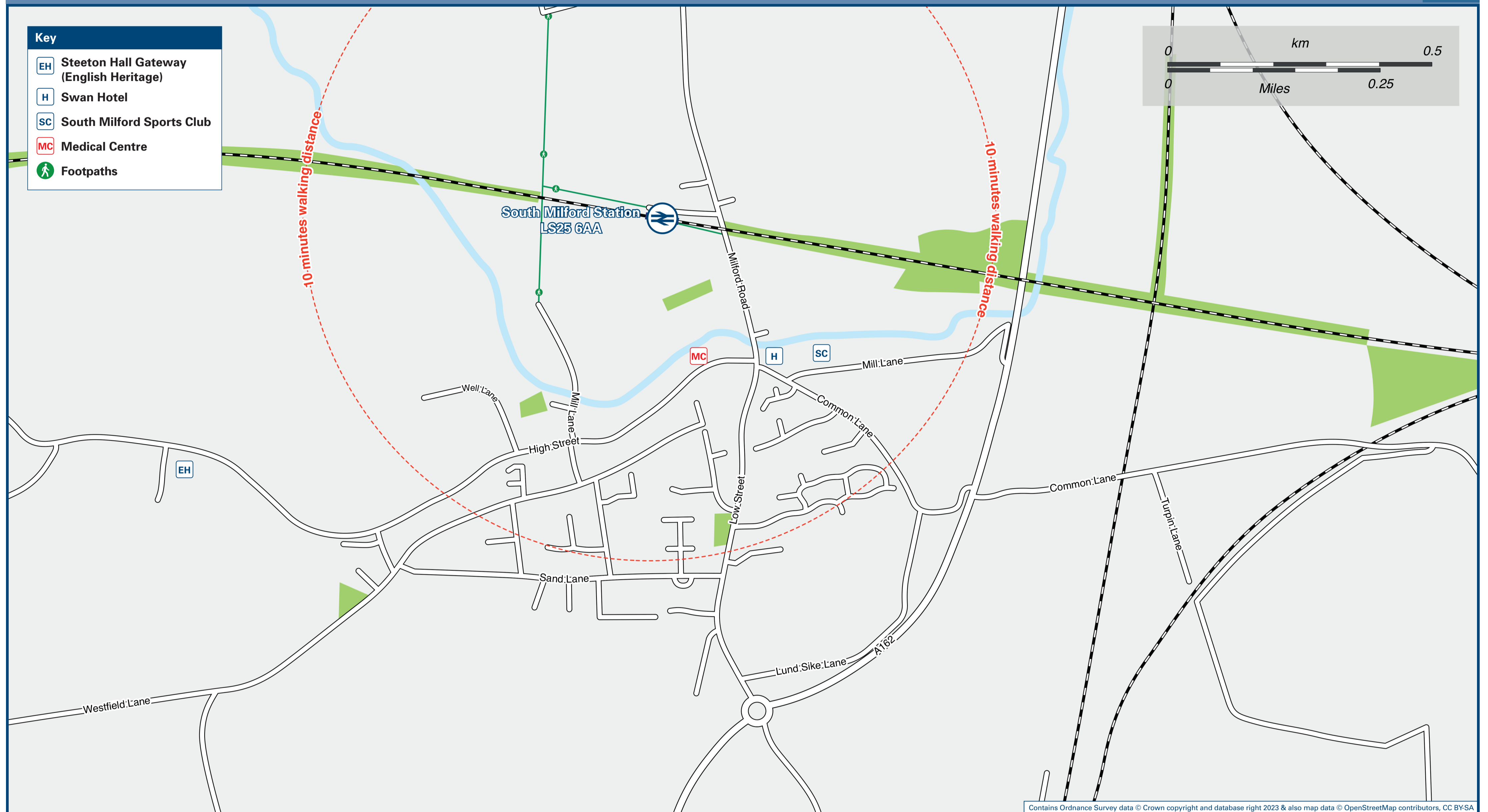

# South Milford Station

# Onward Travel Information

## Local area map



## Buses

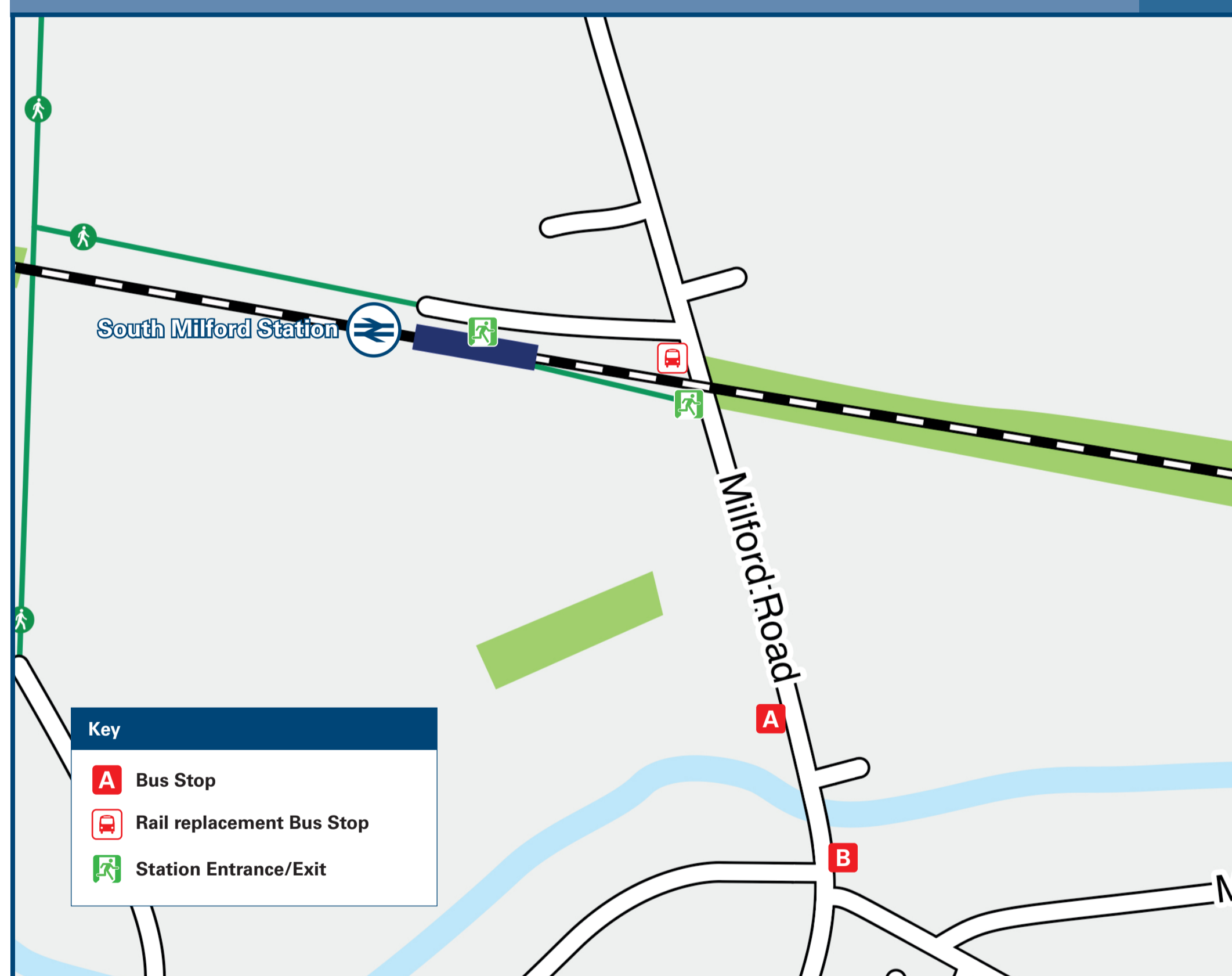

Rail replacement buses from the Bridge on the Main Road under the station where it is possible for the coach to reverse into the Station car park entrance.

## Main destinations by bus

(Data correct at November 2023)

DESTINATION	BUS ROUTES	BUS STOP
Brotherton	493	B
Bryam Park	493	B
Burton Salmon	493	B
Cross Gates (for Shopping Centre)	164	A
Fairburn	493	B
Ferrybridge	493	B
Garforth	164	A
Hambleton	64, 164	B
Hillam	493	B
Knottingley	493	B
Leeds	164	A
Micklefield	164	A
Monk Fryston	64, 164, 493	B
Pontefract	493	B
Selby	64, 164	B
Sherburn in Elmet	64, 164, 493	A
Thorpe Willoughby	64, 164	B

**Notes**  
 Bus routes 64, 164 and 493 operate Mondays to Saturdays. No service on Sundays or Bank Holidays. For bus times please see bus stop timetables or contact Traveline on 0871 200 22 33.  
 Direct trains operate to this destination from this station.

**Taxis**  
 South Milford Station has no taxi rank or cab office. Advance booking is essential, please consider using the following local operators: (Inclusion of this number doesn't represent any endorsement of the taxi firm)

**Elmet Private Hire**  
 07743 498 420

**Oz Travel**  
 01977 683 399

**Rumfords Private Hire**  
 01977 689 040

## Further information about all onward travel

<b>Local Cycle Info</b> <a href="http://www.northyorks.gov.uk/roads-parking-and-travel/roads-and-pavements/cycle-lanes-and-routes">www.northyorks.gov.uk/roads-parking-and-travel/roads-and-pavements/cycle-lanes-and-routes</a> For more information about cycle routes.	<b>National Cycle Info</b> <a href="http://sustrans.org.uk">sustrans.org.uk</a> Sustrans is the UK's leading sustainable transport charity.	<b>Bus Times</b> See timetable displays at bus stops.  <a href="http://www.traveline.info">www.traveline.info</a> 0871 200 22 33 <small>calls cost 13p per minute plus your phone company's access charge</small>	<b>NextBuses</b>  <b>Find the bus times for your stop.</b> Search for a bus stop by entering a postcode, street & town or a stop name & town.	<b>PlusBus</b> <a href="http://plusbus.info">plusbus.info</a> A discount price 'bus pass' that you buy with your train ticket. It gives you unlimited bus travel around your chosen town, on participating buses.
---	---	--	--	---

## National Rail Enquiries

<b>Online</b> <a href="http://nationalrail.co.uk">nationalrail.co.uk</a>	<b>NRE App</b> Free National Rail Enquiries app for iOS and Android	<b>Social Media</b> <a href="https://facebook.com/nationalrailenq">facebook.com/nationalrailenq</a> @nationalrailenq	<b>Alert Me</b> You can sign up to Alert Me messages on the National Rail Enquiries website where you can receive train and platform notifications directly to your smart phone. <a href="http://nationalrail.co.uk/alertme">nationalrail.co.uk/alertme</a>	<b>Contact Centre</b> 03457 48 49 50 Calls cost no more than calls to geographic numbers (01 or 02) and may be recorded.	<b>PlusBike</b> <a href="http://nationalrail.co.uk/plusbike">nationalrail.co.uk/plusbike</a> For more information.
---	--	--	---	--	--



This poster shows details of popular destinations and main, frequent bus routes. Additional services may run, so please check with Traveline or see posters at local bus stops. Whilst considerable care has been taken to ensure the information contained on this poster is correct and accurate, National Rail cannot accept responsibility for any loss or inconvenience caused by any errors or omissions, or for loss, damage, injury or inconvenience relating to the cancellation, alteration, delay or diversion of a service. For any feedback, please e-mail [comments@onwardtravelposters.com](mailto:comments@onwardtravelposters.com)

Scan this code with your mobile for full station information.