

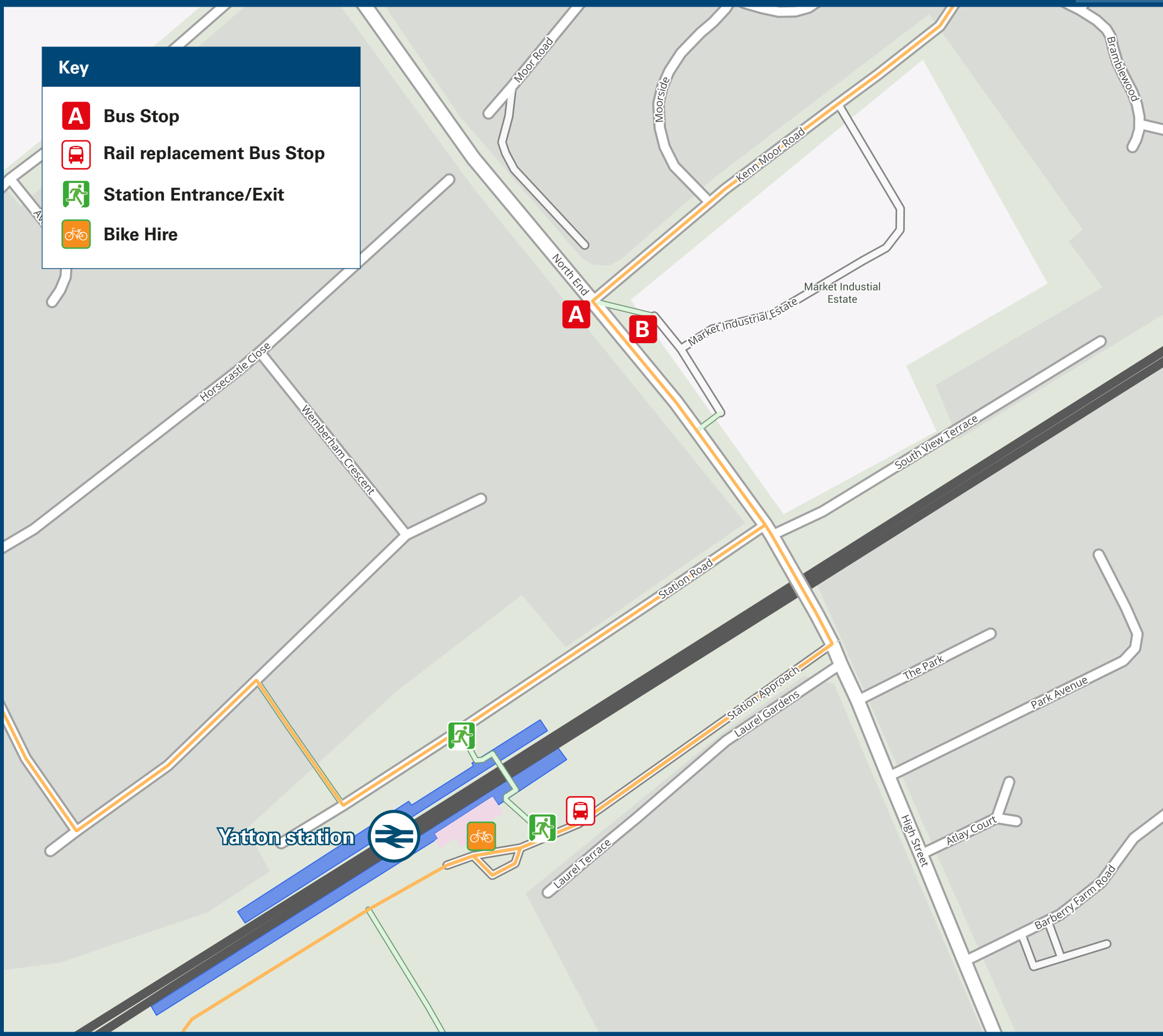

Yatton Station

Onward Travel Information

Buses



Rail replacement services from the station car park located on Platform 1 side of the station. Taxis on Station Road by Gas Meeting House.

Local area map

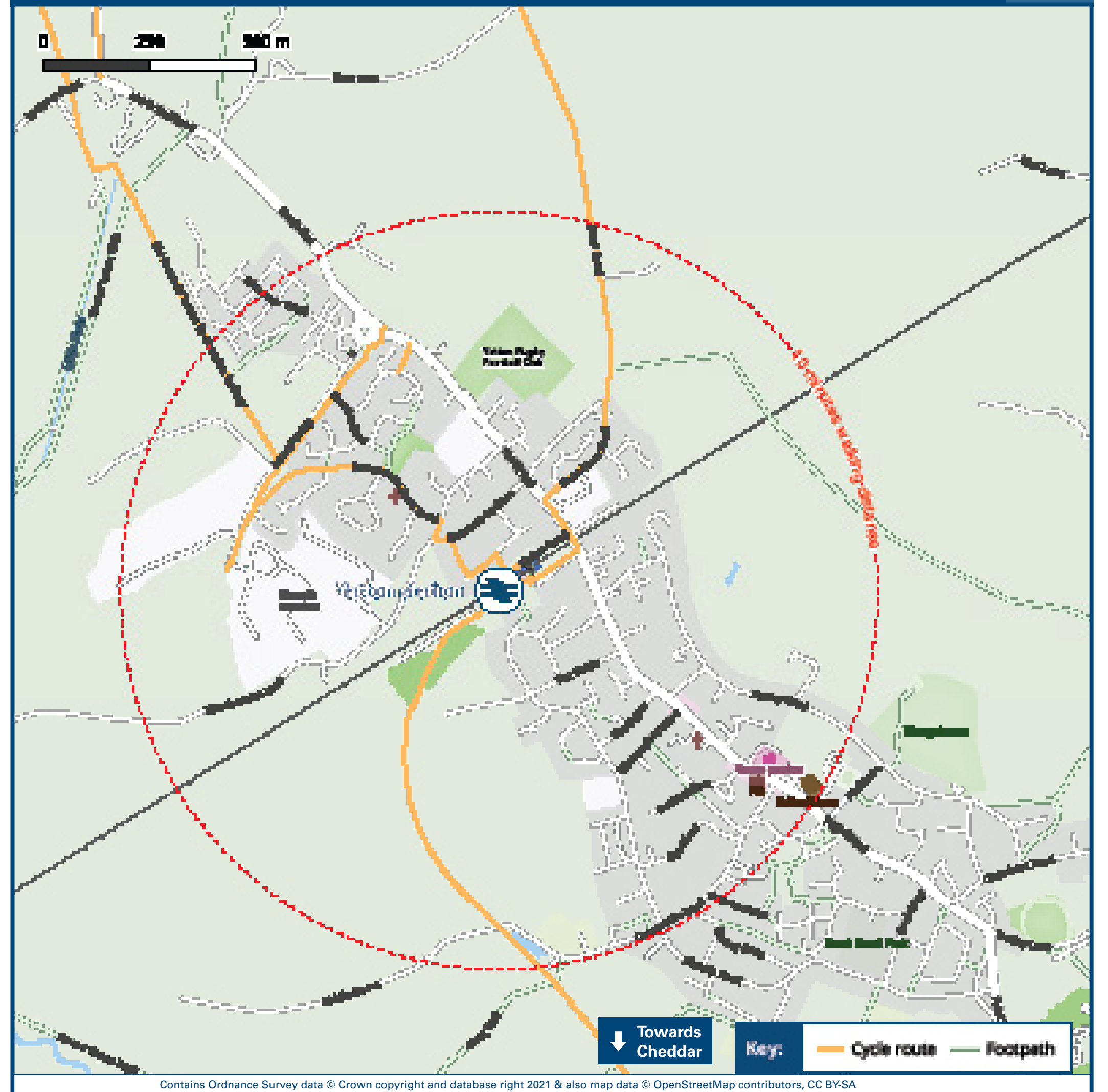

Main destinations by bus

(Data correct at September 2022)



DESTINATION	BUS ROUTES	BUS STOP	DESTINATION	BUS ROUTES	BUS STOP	DESTINATION	BUS ROUTES	BUS STOP
Bristol	X2	B	Claverham	54, X2	B	Long Ashton	X2	B
Backwell	X2	B	Cleeve	54, X2	B	Yatton (North End)	54, X2	A
Bristol Airport	54	B	Clevedon	54	A			
Brockley	54, X2	B	Flax Bourton	X2	B			

Notes

- Bus routes 54 & X2 run Mondays to Saturdays only. No Sunday services.
- ➔ Change here for connecting domestic and international airline flights.
- ⊕ Direct trains run to this destination from Yatton station

Taxis	Yatton Station has no taxi rank or cab office. Advance booking is essential, please consider using the following local operators: (Inclusion of this number doesn't represent any endorsement of the taxi firm)	CPM Taxis 01934 835 119	North Somerset Taxis 01934 550 321
--------------	---	-----------------------------------	--

Further information about all onward travel

Local Cycle Info www.travelwest.info For more information about cycle routes.	National Cycle Info sustrans.org.uk Sustrans is the UK's leading sustainable transport charity.	Bus Times See timetable displays at bus stops. www.traveline.info 0871 200 22 33 calls cost 12p per minute plus your phone company's access charge	NextBuses .mobi Find the bus times for your stop. Search for a bus stop by entering a postcode, street & town or a stop name & town.	PlusBus plusbus.info A discount price 'bus pass' that you buy with your train ticket. It gives you unlimited bus travel around your chosen town, on participating buses.
---	---	---	--	---

National Rail Enquiries

Online nationalrail.co.uk	NRE App Free National Rail Enquiries app for iOS and Android	Social Media facebook.com/nationalrailenq @nationalrailenq	Alert Me You can sign up to Alert Me messages on the National Rail Enquiries website where you can receive train and platform notifications directly to your smart phone. nationalrail.co.uk/alertme	Contact Centre 03457 48 49 50 Calls cost no more than calls to geographic numbers (01 or 02) and may be recorded.	PlusBike nationalrail.co.uk/plusbike For more information.
---	--	---	---	--	--



This poster shows details of popular destinations and main, frequent bus routes. Additional services may run, so please check with Traveline or see posters at local bus stops. Whilst considerable care has been taken to ensure the information contained on this poster is correct and accurate, National Rail cannot accept responsibility for any loss or inconvenience caused by any errors or omissions, or for loss, damage, injury or inconvenience relating to the cancellation, alteration, delay or diversion of a service. For any feedback, please e-mail comments@onwardtravelposters.com. Scan this code with your mobile to take this poster with you.