

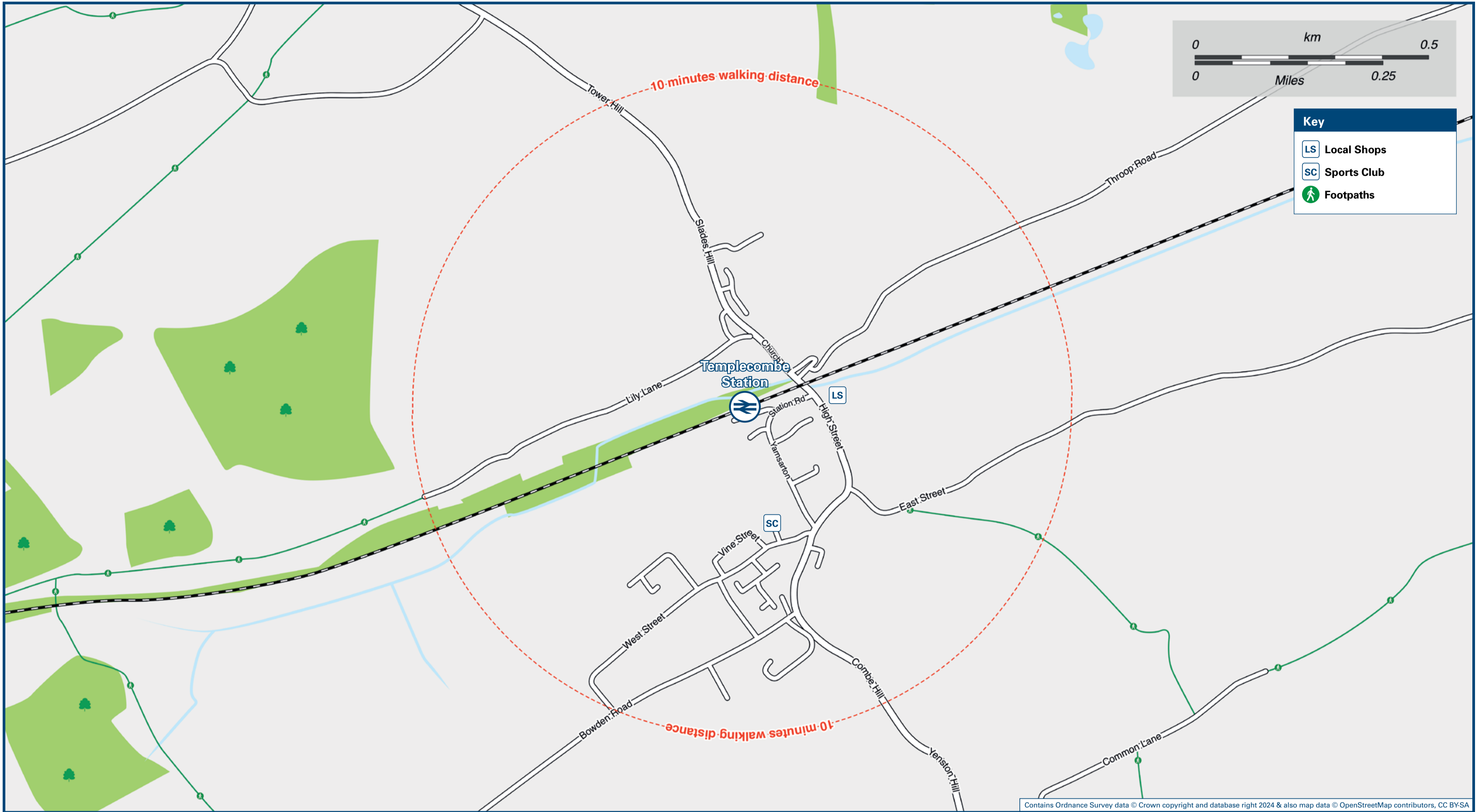

Templecombe Station

Onward Travel Information

Local area map



Buses

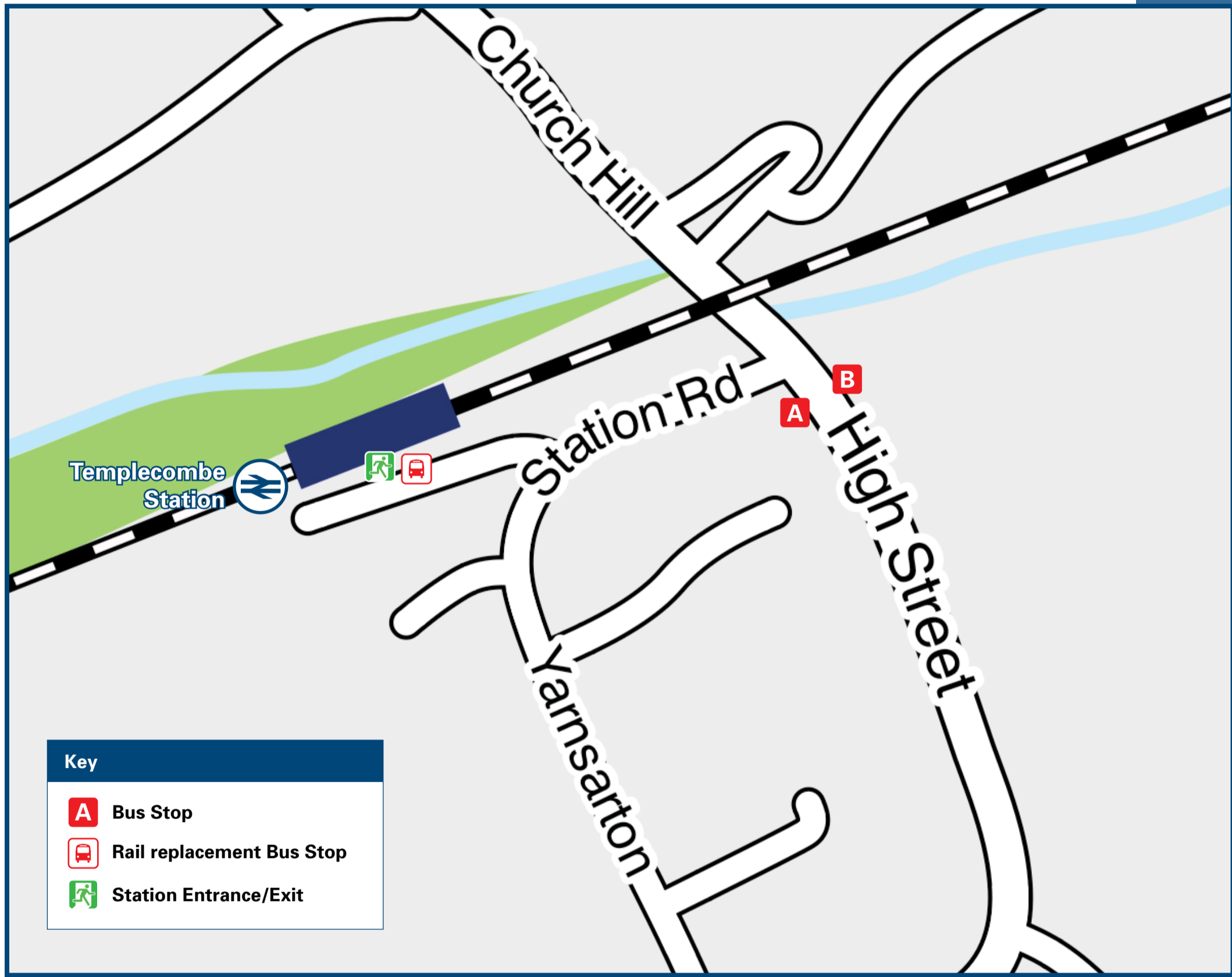

 Rail replacement buses/coaches will depart from for through journeys: Station Car Park Entrance off Station Road; for terminating journeys: Station Car Park off Station Road.

Main destinations by bus

(Data correct at October 2024)

DESTINATION	BUS ROUTES	BUS STOP
Henstridge Ash	58, 58A	B
Horsington	58, 58A	A
Milborne Port	58, 58A	B
Oborne	58, 58A	B
Purse Caundle	58, 58A	B
Sherborne	58, 58A	B
South Cheriton	58, 58A	A
Stalbridge	58A	B
Stallen	58, 58A	B
West Hill	58, 58A	A
Wincanton	58, 58A	A
Yenston	58, 58A	B
Yeovil	58, 58A	B

Notes

Bus routes 58 & 58A run Mondays to Saturdays, only. No Sunday service.
Direct trains operate to this destination from this Station.

Taxis

Templecombe station has no taxi rank or cab office. Advance booking is essential, please consider using the following local operators: (Inclusion of this number doesn't represent any endorsement of the taxi firm)

RAM Cars
07830 482 200

T&M Taxis
01963 202 618

Further information about all onward travel

Local Cycle Info

southsomerset.gov.uk
For more information about cycle routes.

National Cycle Info

sustrans.org.uk
Sustrans is the UK's leading sustainable transport charity.

Bus Times

See timetable displays at bus stops.

 www.traveline.info
0871 200 22 33
calls cost 15p per minute plus your phone company's access charge

NextBuses

Find the bus times for your stop.
Search for a bus stop by entering a postcode, street & town or a stop name & town.

PlusBus

plusbus.info
A discount price 'bus pass' that you buy with your train ticket. It gives you unlimited bus travel around your chosen town, on participating buses.

National Rail Enquiries

Online

nationalrail.co.uk

NRE App

Free National Rail Enquiries app for iOS and Android

Social Media

 facebook.com/nationalrailenq
 [@nationalrailenq](https://twitter.com/nationalrailenq)

Alert Me

You can sign up to Alert Me messages on the National Rail Enquiries website where you can receive train and platform notifications directly to your smart phone.
nationalrail.co.uk/alertme

Contact Centre

03457 48 49 50
Calls cost no more than calls to geographic numbers (01 or 02) and may be recorded.

PlusBike

nationalrail.co.uk/plusbike
For more information.

South Western Railway



National Rail
Britain's train companies working together

